

DISTRICT I
P. O. Box 1980
Hobbs, NM 88241-1980

State of New Mexico
Energy, Minerals, and Natural Resources Department

Form C-102
Revised 02-10-94

Instructions on back

DISTRICT II
P. O. Drawer DD
Artesia, NM 88211-0719

OIL CONSERVATION DIVISION
P. O. Box 2088
Santa Fe, New Mexico 87504-2088

Submit to the Appropriate
District Office
State Lease - 4 copies
Fee Lease - 3 copies

DISTRICT III
1000 Rio Brazos Rd.
Aztec, NM 87410

☐ AMENDED REPORT

DISTRICT IV
P. O. Box 2088
Santa Fe, NM 87507-2088

WELL LOCATION AND ACREAGE DEDICATION PLAT

1 API Number		2 Pool Code		3 Pool Name Indian Basin					
4 Property Code		5 Property Name OLD RANCH CANYON '7' FEDERAL						6 Well Number 5	
7 OGRID No. 20305		8 Operator Name SANTA FE ENERGY RESOURCES, INC.						9 Elevation 3987'	
10 SURFACE LOCATION									
UL or lot no. F	Section 7	Township 22 SOUTH	Range 24 EAST, N.M.P.M.	Lot Ida	Feet from the 1350'	North/South line NORTH	Feet from the 2350	East/West line WEST	County EDDY
11 BOTTOM HOLE LOCATION IF DIFFERENT FROM SURFACE									
UL or lot no.	Section	Township	Range	Lot Ida	Feet from the	North/South line	Feet from the	East/West line	County
12 Dedicated Acres 0		13 Joint or Infill		14 Consolidation Code		15 Order No.			

NO ALLOWABLE WELL BE ASSIGNED TO THIS COMPLETION UNTIL ALL INTERESTS HAVE BEEN
CONSOLIDATED OR A NON-STANDARD UNIT HAS BEEN APPROVED BY THE DIVISION

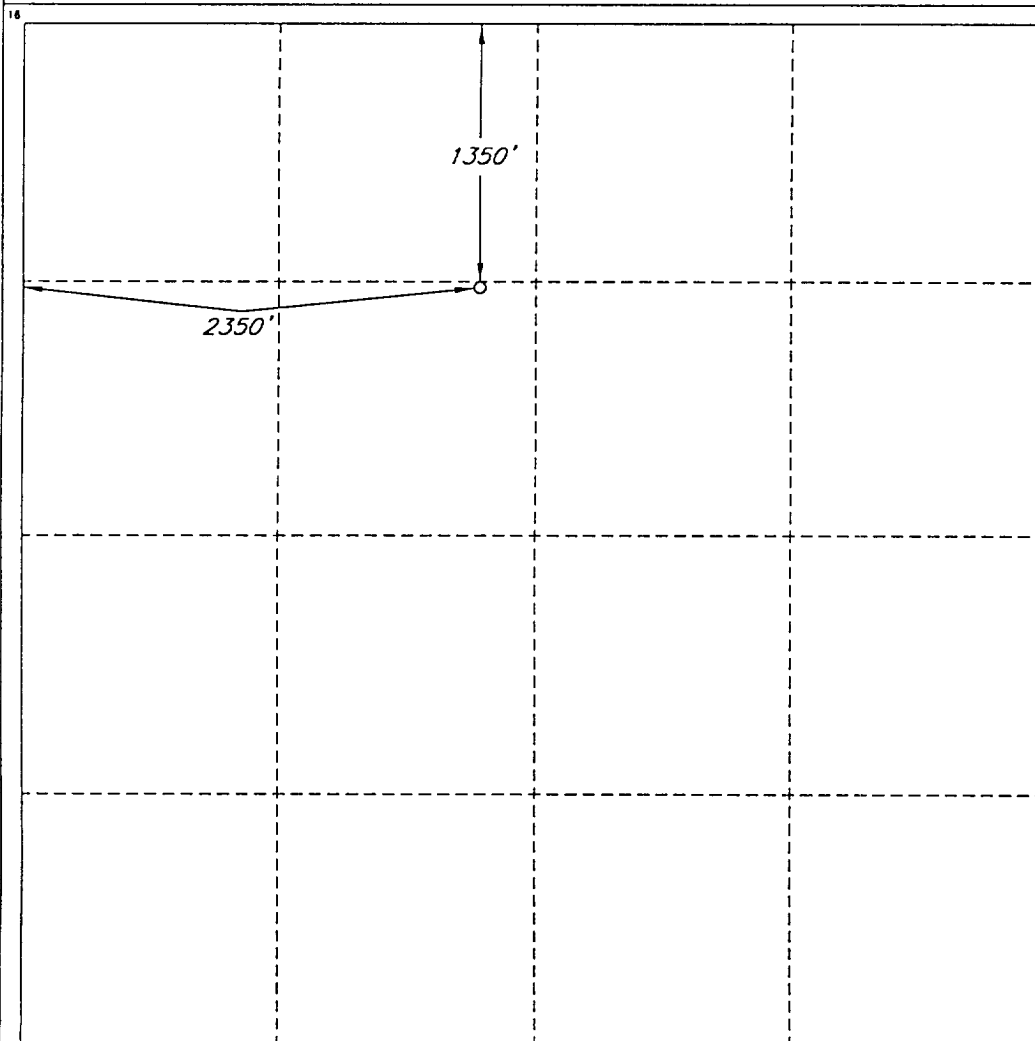

OPERATOR CERTIFICATION

I hereby certify that the information
contained herein is true and complete
to the best of my knowledge and belief.

Signature *James P. Stinson*
Printed Name
James P. "Phil" Stinson
Title
Agent for Santa Fe Energy
Date
12-23-98

SURVEYOR CERTIFICATION

I hereby certify that the well
location shown on this plat was
plotted from field notes of actual
surveys made by me or under
my supervision, and that the
same is true and correct to the
best of my belief.

Date of Survey
DECEMBER 12, 1998

Signature *Roger M. Robbins*
Professional Surveyor
Date
12-23-98
Certificate No. 12128
ROGER M. ROBBINS P.S. #12128

108 #51531 / 51 NE / V.H.P.