

(SUBMIT IN TRIPLICATE)

UNITED STATES
DEPARTMENT OF THE INTERIOR
GEOLOGICAL SURVEYLand Office Las CrucesLease No. 003413Unit Oil and Gas

SUNDRY NOTICES AND REPORTS ON WELLS

NOTICE OF INTENTION TO DRILL	<input checked="" type="checkbox"/>	SUBSEQUENT REPORT OF WATER SHUT-OFF	
NOTICE OF INTENTION TO CHANGE PLANS		SUBSEQUENT REPORT OF SHOOTING OR ACIDIZING	
NOTICE OF INTENTION TO TEST WATER SHUT-OFF		SUBSEQUENT REPORT OF ALTERING CASING	
NOTICE OF INTENTION TO RE-DRILL OR REPAIR WELL		SUBSEQUENT REPORT OF RE-DRILLING OR REPAIR	
NOTICE OF INTENTION TO SHOOT OR ACIDIZE		SUBSEQUENT REPORT OF ABANDONMENT	
NOTICE OF INTENTION TO PULL OR ALTER CASING		SUPPLEMENTARY WELL HISTORY	
NOTICE OF INTENTION TO ABANDON WELL			

(INDICATE ABOVE BY CHECK MARK NATURE OF REPORT, NOTICE, OR OTHER DATA)

El Paso, Texas, August 11, 1956, 19__Well No. 3 is located 600 ft. from N line and 700 ft. from E line of sec. 4.

<u>31</u> Sec. and Sec. No.)	<u>21</u> (Twp.)	<u>1</u> (Range)	<u>1</u> (Meridian)
<u>El Paso</u> (Field)	<u>El Paso</u> (County or Subdivision)	<u>New Mexico</u> (State or Territory)	

The elevation of the derrick floor above sea level is _____ ft.

DETAILS OF WORK

(State names of and expected depths to objective sands; show sizes, weights, and lengths of proposed casings; indicate mudding jobs, cementing points, and all other important proposed work)

Intent to drill with cable tools to top of Delmarre group and possibly to top of Bone Springs lime (with rotary tools) -
Plan to run 10.75 inch casing to top of salt at approx. 600 feet and cement with 50 sacks of cement.
Plan to drill 10" hole to around 2800 ft. and set 8-5/8" casing - 230' and circulate Aquagel to start of water which might be encountered.
If production is obtained in Delmarre or at a lesser depth, 7" casing will be run and cemented. The 8-5/8" casing will be pulled in any event whether it is productive test or a dry hole.

I understand that this plan of work must receive approval in writing by the Geological Survey before operations may be commenced.

Company Iron Oil CompanyAddress 200 Hill BuildingEl Paso, TexasPhone: 2-1321By Max EngingerTitle Engineer

OPERATOR ~~MAX.~~ ZINGER, FREN OIL CO.
LEASE FEDERAL - MAX ENZINGER
LOCATION NO. 3

DATE 8-4-56
SCALE 1" = 1000'

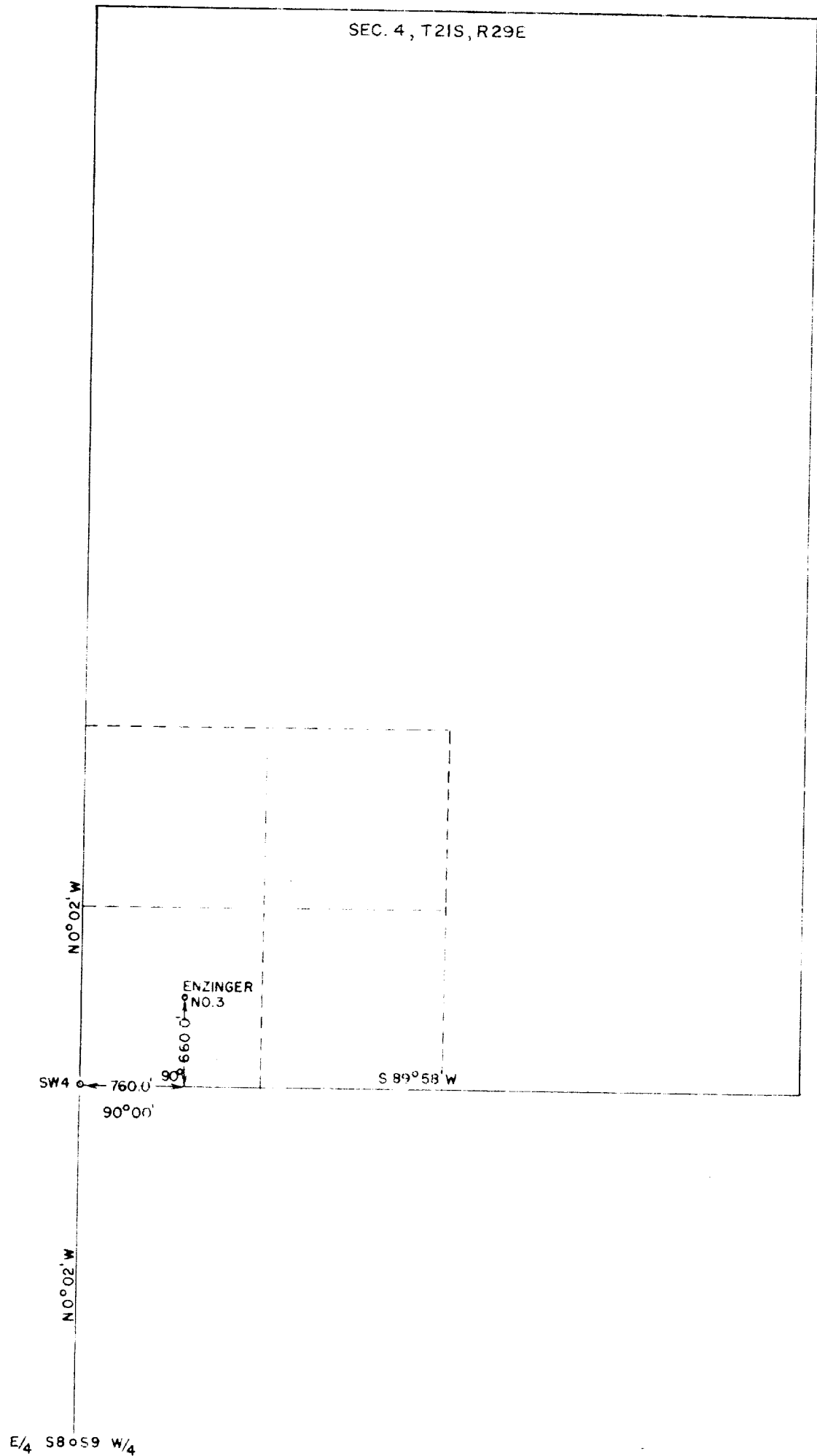

I certify that the above plat was constructed from notes taken by me in the field and is true & correct to the best of my knowledge and belief.

Ben T. Phillips Jr. L.S.