

NEW MEXICO OIL CONSERVATION COMMISSION  
Santa Fe, New Mexico

MISCELLANEOUS REPORTS ON WELLS

Submit this report in TRIPLICATE to the District Office, Oil Conservation Commission, within 10 days after the work specified is completed. It should be signed and filed as a report on Beginning Drilling Operations, Results of test of casing shut-off, result of plugging of well, result of well repair, and other important operations, even though the work was witnessed by an agent of the Commission. See additional instructions in the Rules and Regulations of the Commission.

Indicate Nature of Report by Checking Below

REPORT ON BEGINNING DRILLING OPERATIONS		REPORT ON RESULT OF TEST OF CASING SHUT-OFF		REPORT ON REPAIRING WELL	
REPORT ON RESULT OF PLUGGING WELL		REPORT ON RECOMPLETION OPERATION		REPORT ON (Other) <b>Spudding Well</b>	<b>X</b>

**January 15, 1955** **Artesia, New Mexico**  
(Date) (Place)

Following is a report on the work done and the results obtained under the heading noted above at the

**John A. Yates, Operator** **Certain Teed Products Corporation**  
(Company or Operator) (Lease)

**C. E. Geiser**, Well No. **2** in the **SE**  $\frac{1}{4}$  **SE**  $\frac{1}{4}$  of Sec. **13**  
(Contractor)

T. **20S**, R**26E**, NMPM, **Wildcat** Pool, **Eddy** County.

The Dates of this work were as follows: **January 15, 1955**

Notice of intention to do the work (was) (was not) submitted on Form C-102 on \_\_\_\_\_, 19\_\_\_\_,  
(Cross out incorrect words)

and approval of the proposed plan (was) (was not) obtained.

DETAILED ACCOUNT OF WORK DONE AND RESULTS OBTAINED

**Well spudded January 15, 1955 and drilling operations begun.**

Witnessed by **John A. Yates** **John A. Yates** **Operator**  
(Name) (Company) (Title)

Approved: OIL CONSERVATION COMMISSION

**L. G. Hanson**  
(Name)

(Title) (Date)

I hereby certify that the information given above is true and complete to the best of my knowledge.

Name **John A. Yates**

Position

Representing **John A. Yates**

Address **312 Carper Bldg.**  
**Artesia, New Mexico**



Company John Yates

Lease Certain-Teed Products Well No. 2

Sec. 13 T. 20 S., R. 26 E., N.M.P.M.

Location SE<sup>1</sup>/<sub>4</sub>SE<sup>1</sup>/<sub>4</sub> ( 330' from South & East Lines

County Eddy

New Mexico

**Chained Distances**

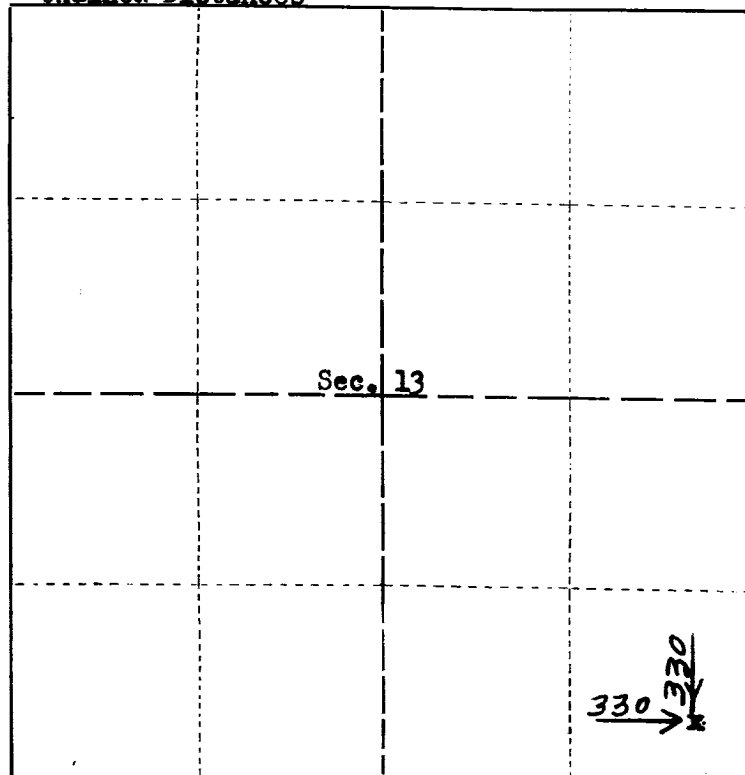

Scale 4" = 1 mile.

This is to certify that the above plat was prepared from field notes of actual surveys made by me or under my supervision and that the same are true and correct to the best of my knowledge and belief.

Seal:

Artesia, New Mexico

*John A. Matthews*  
Registered Professional  
Engineer and Land Surveyor.

Surveyed January 14, 1955



Company \_\_\_\_\_  
 Lease \_\_\_\_\_  
 Sec. 13 T. 20 S. R. 2 E. N.M.P.M.  
 Location \_\_\_\_\_  
 County \_\_\_\_\_  
 New Mexico

Printed distances

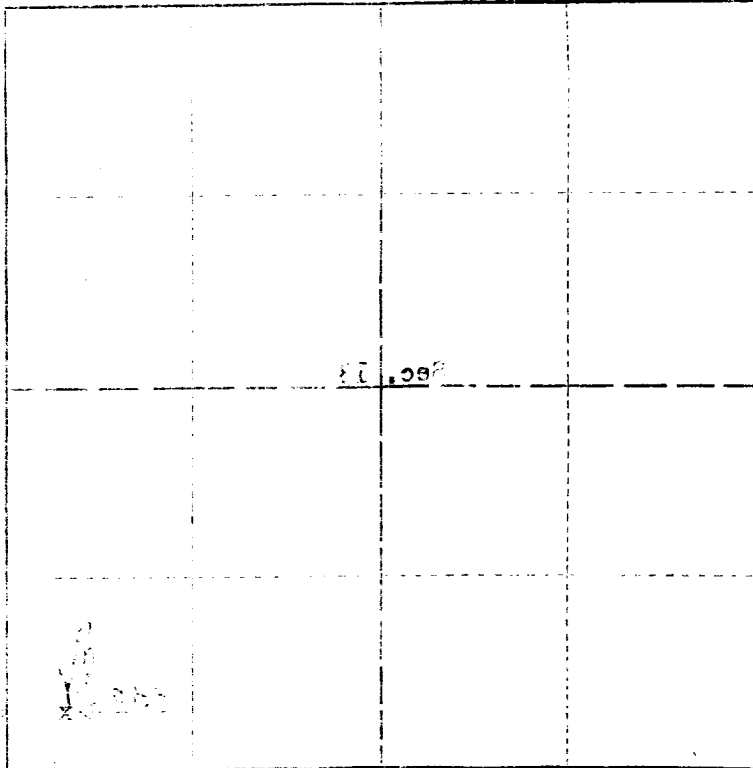

Scale 4" = 1 mile.

This is to certify that the above plat was prepared from field notes of actual surveys made by me or under my supervision and that the same are true and correct to the best of my knowledge and belief.

Registered Professional  
 Engineer and Land Surveyor.

Seal:

Artesia, New Mexico

Surveyed \_\_\_\_\_, 19\_\_

1122 Advocate Print

NEW MEXICO  
 DEPT. OF LAND & MINES  
 DIVISION OF LAND SURVEYING  
 ALBUQUERQUE, N.M.