

NOTICE OF INTENTION TO DRILL

Notice must be given to the District Office of the Oil Conservation Commission and approval obtained before drilling or recompletion begins. If changes in the proposed plan are considered advisable, a copy of this notice showing such changes will be returned to the sender. Submit this notice in QUINTUPPLICATE. One copy will be returned following approval. See additional instructions in Rules and Regulations of the Commission. If State Land submit 6 Copies Attach Form C- 128 in triplicate to first 3 copies of form C-101

Artesia, New Mexico
(Place)

July 17, 1962
(Date)

RECEIVED

JUL 17 1962

OIL CONSERVATION COMMISSION
SANTA FE, NEW MEXICO

Gentlemen:

You are hereby notified that it is our intention to commence the Drilling of a well to be known as

Kincaid & Watson Drilling Company
(Company or Operator)

O. C. C.
ARTESIA, OFFICE

Trigood State
(Lease)

Well No. 1, in E The well is

located 660 feet from the West line and 1980 feet from the

North line of Section 2, T. 20S, R. 29E, NMPM.

(GIVE LOCATION FROM SECTION LINE)

Undesignated Pool, Eddy County

If State Land the Oil and Gas Lease is No. E-7729

If patented land the owner is

Address

We propose to drill well with drilling equipment as follows: Cable Tools

The status of plugging bond is Blanket Bond of Kincaid & Watson Drilling Company

Drilling Contractor Kincaid & Watson Drilling Company

We intend to complete this well in the Yates and Seven Rivers formation at an approximate depth of 1625 feet.

CASING PROGRAM

We propose to use the following strings of Casing and to cement them as indicated:

Size of Hole	Size of Casing	Weight per Foot	New or Second Hand	Depth	Sacks Cement
12 1/2"	10 3/4"	40	Used	175	None
10"	8 5/8"	24	Used	275	None
8"	7"	20	Used	450	50
6"	5 1/2"	14	New	1625	100

If changes in the above plans become advisable we will notify you immediately.

ADDITIONAL INFORMATION (If recompletion give full details of proposed plan of work.)

JUL 17 1962

Approved, 19.....
Except as follows:

OIL CONSERVATION COMMISSION

By M. L. Armstrong

Sincerely yours,

Kincaid & Watson Drilling Company
(Company or Operator)

By Alex Holmes

Position Assistant Secretary
Send Communications regarding well to

Name Kincaid & Watson Drilling Company

Address Box 498, Artesia, New Mexico

OIL CONSERVATION COMMISSION
ARTESIA DISTRICT OFFICE

No. Copies Received

DATE RECEIVED

OPERATION

INITIALS

LOCATION OTHER

STATE LAND OR

J. S. G. S.

TRANSPORTER

FILE

THREAD OF MINES

NUMBER OF COPIES RECEIVED	
DISTRIBUTION	
SANTA FE	
FILE	
U.S.G.S.	
LAND OFFICE	
TRANSPORTER	OIL GAS
PRODUCTION OFFICE	
OPERATOR	

NEW MEXICO OIL CONSERVATION COMMISSION
WELL LOCATION AND ACREAGE DEDICATION PLAT
 SEE INSTRUCTIONS FOR COMPLETING THIS FORM ON THE REVERSE SIDE

FORM C-128
Revised 5/1/57

SECTION A

Operator Kincaid & Watson Drilling Company		Lease Trigood State		Well No. 1
Unit Letter E	Section 2	Township 20 South	Range 29 East	County Eddy
Actual Footage Location of Well: 1980 feet from the North line and 660 feet from the West line				
Ground Level Elev. 3325	Producing Formation Yates and Seven Rivers	Pool Undesignated Wildcat	Dedicated Acreage: 40 Acres	

1. Is the Operator the only owner in the dedicated acreage outlined on the plat below? YES ☒ NO ____ . ("Owner" means the person who has the right to drill into and to produce from any pool and to appropriate the production either for himself or for himself and another. (65-3-29 (e) NMSA 1935 Comp.)
2. If the answer to question one is "no," have the interests of all the owners been consolidated by communitization agreement or otherwise? YES ____ NO ____ . If answer is "yes," Type of Consolidation _____
3. If the answer to question two is "no," list all the owners and their respective interests below:

Owner	Land Description SW1/4 Section 2, T20S-R29E.

SECTION B

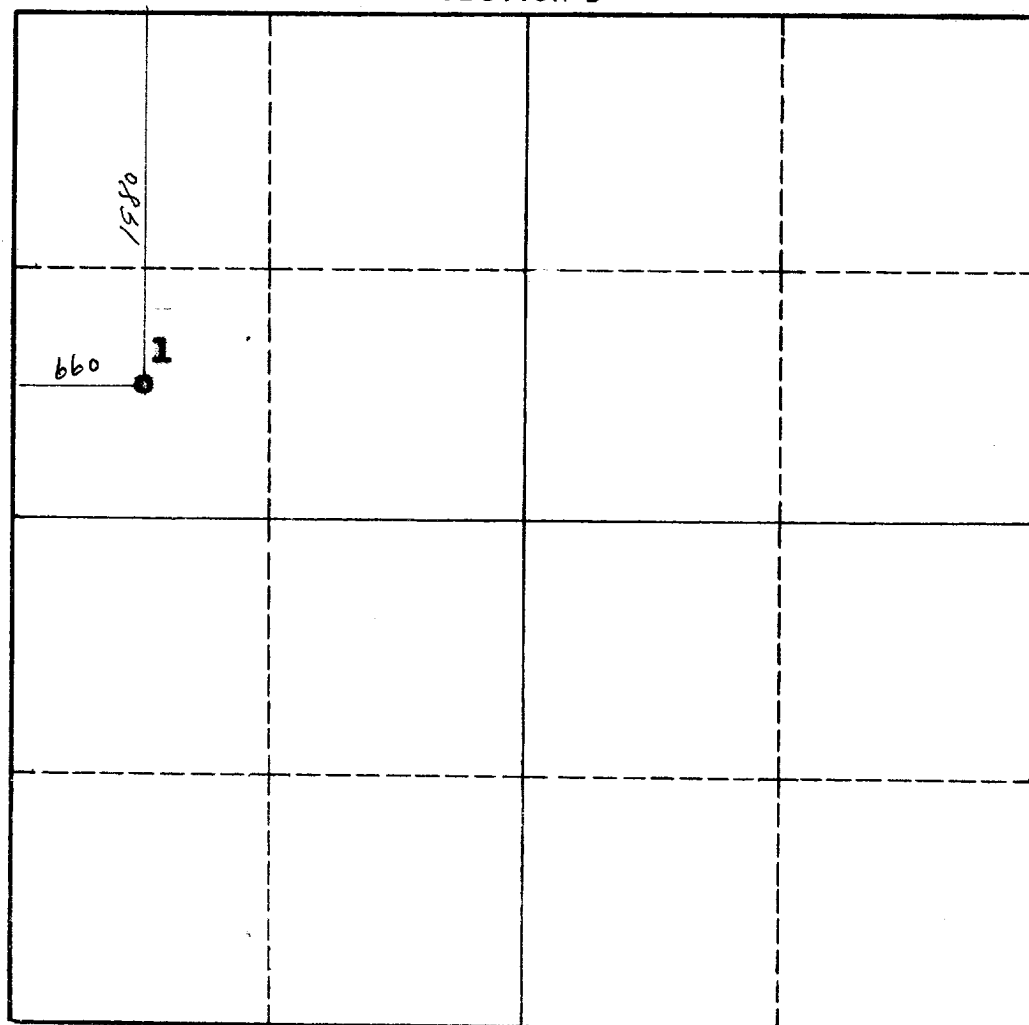

CERTIFICATION

I hereby certify that the information in SECTION A above is true and complete to the best of my knowledge and belief.

Name	<i>E. P. Holman</i>
Position	Assistant Secretary
Company	Kincaid & Watson Drlg. Co.
Date	July 17, 1962

I hereby certify that the well location shown on the plat in SECTION B was plotted from field notes of actual surveys made by me or under my supervision, and that the same is true and correct to the best of my knowledge and belief.

Date Surveyed	July 5, 1962
Registered Professional Engineer and/or Land Surveyor	<i>John A. Mathis</i>
Certificate No.	1502

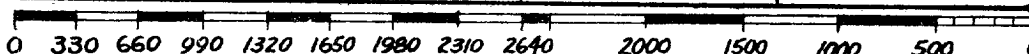

INSTRUCTIONS FOR COMPLETION OF FORM C-128

1. Operator shall furnish and certify to the information called for in Section A.
2. Operator shall outline the dedicated acreage for *both* oil and gas wells on the plat in Section B.
3. A registered professional engineer or land surveyor registered in the State of New Mexico or approved by the Commission shall show on the plat the location of the well and certify this information in the space provided.
4. All distances shown on the plat must be from the outer boundaries of the Section.
5. If additional space is needed for listing owners and their respective interests as required in question 3 of Section A, please use space below.