

NUMBER OF COPIES RECEIVED		8
DISTRIBUTION		
SANTA FE		
FILE		
U.S.G.S		
LAND OFFICE		
TRANSPORTER	OIL	
	GAS	
PROBATION OFFICE		
OPERATOR		

NEW MEXICO OIL CONSERVATION COMMISSION
WELL LOCATION AND ACREAGE DEDICATION PLAT
 SEE INSTRUCTIONS FOR COMPLETING THIS FORM ON THE REVERSE SIDE

FORM C-128
 Revised 5/1/57

SECTION A

Operator Odessa Natural Gasoline Company		Lease Federal Dooley		Well No.
Unit Letter M	Section 24	Township 20 South	Range 29 East	County Eddy
Actual Footage Location of Well: 560 feet from the South line and 560 feet from the West line				
Ground Level Elev. 3310	Producing Formation Morrow	Pool Undesignated	Dedicated Acreage: 160 Acres	

1. Is the Operator the only owner in the dedicated acreage outlined on the plat below? YES XXXX NO . ("Owner" means the person who has the right to drill into and to produce from any pool and to appropriate the production either for himself or for himself and another. (65-3-29 (e) NMSA 1935 Comp.)
2. If the answer to question one is "no," have the interests of all the owners been consolidated by communitization agreement or otherwise? YES NO . If answer is "yes," Type of Consolidation
3. If the answer to question two is "no," list all the owners and their respective interests below:

RECEIVED

Owner	Land Description	OCT 30 1963
		O. C. C.

**ARTESIA, OFFICE
 CERTIFICATION**

SECTION B

R-29-E

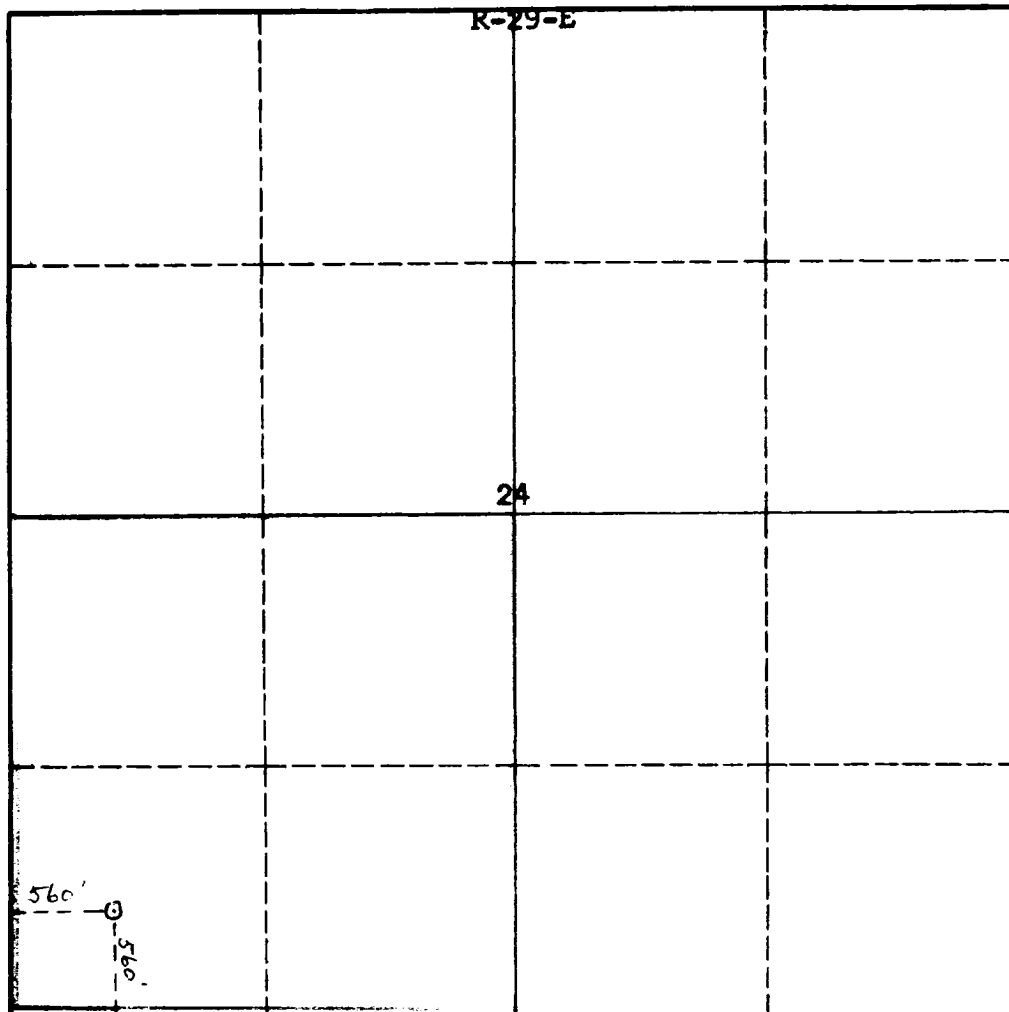

I hereby certify that the information in SECTION A above is true and complete to the best of my knowledge and belief.

Name	L. N. Dunsmuir
Position	Production Superintendent
Company	Odessa Natural Gasoline Co.
Date	October 28, 1963

I hereby certify that the well location shown on the plat in SECTION B was plotted from field notes of actual surveys made by me or under my supervision, and that the same is true and correct to the best of my knowledge and belief.

Date Surveyed	August 30th 1962
Registered Professional Engineer and/or Land Surveyor	James H. Brown
Certificate No.	542

T
20
S

INSTRUCTIONS FOR COMPLETION OF FORM C-128

1. Operator shall furnish and certify to the information called for in Section A.
2. Operator shall outline the dedicated acreage for *both* oil and gas wells on the plat in Section B.
3. A registered professional engineer or land surveyor registered in the State of New Mexico or approved by the Commission shall show on the plat the location of the well and certify this information in the space provided.
4. All distances shown on the plat must be from the outer boundaries of the Section.
5. If additional space is needed for listing owners and their respective interests as required in question 3 of Section A, please use space below.