

NEW MEXICO OIL CONSERVATION COMMISSION  
WELL LOCATION AND ACREAGE DEDICATION PLAT  
SEE INSTRUCTIONS FOR COMPLETING THIS FORM ON THE REVERSE SIDE

FORM C-128  
Revised 5/1/57

NUMBER OF TOP-SEALERS	
DATE OF PLAT	
SANTA FE	
FILE	
UNIT	
LAND OFFICE	
TRANSPORTER	OIL
PRODUCTION OFFICE	GAS
OPERATOR	

SECTION A

Operator <del>Ralph Lowe</del> Maralo, Inc.		Lease <del>Federal Hamner</del>		Well No. 1
Unit Letter R	Section 34	Township T-20-S	Range R-27-E	County Eddy
Actual Footage Location of Well: 650 feet from the South line and 1980 feet from the West line				
Ground Level Elev. 3229	Producing Formation Morrow	Pool Undesignated	Dedicated Acreage: 40-320 Acres	

1. Is the Operator the only owner in the dedicated acreage outlined on the plat below? YES ☒ NO \_\_\_\_ ("Owner" means the person who has the right to drill into and to produce from any pool and to appropriate the production either for himself or for himself and another. (65-3-29 (e) NMSA 1935 Comp.)
2. If the answer to question one is "no," have the interests of all the owners been consolidated by communization agreement or otherwise? YES \_\_\_\_ NO \_\_\_\_ . If answer is "yes," Type of Consolidation \_\_\_\_
3. If the answer to question two is "no," list all the owners and their respective interests below:

Owner	Land Description

SECTION B

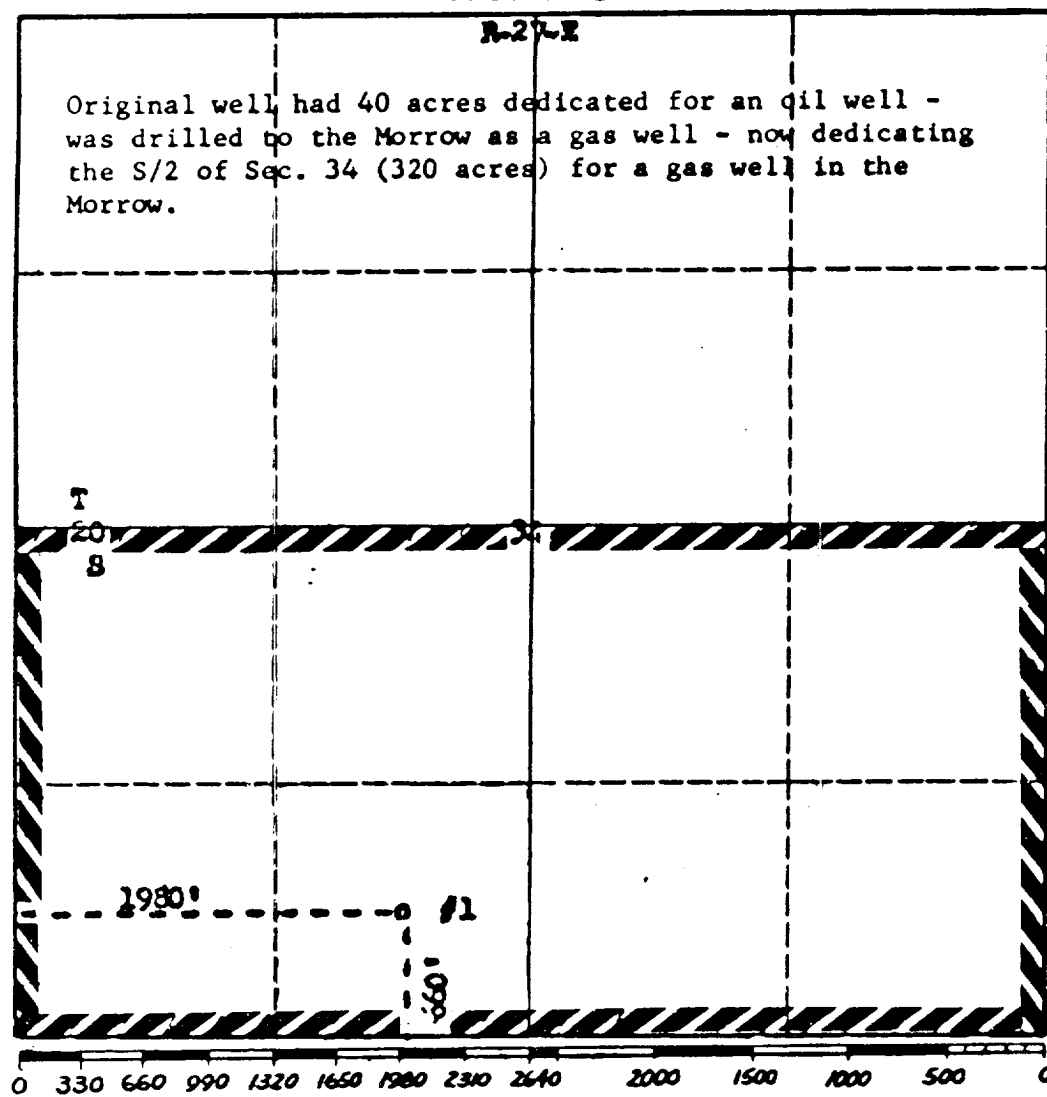

CERTIFICATION

I hereby certify that the information in SECTION A above is true and complete to the best of my knowledge and belief.

Name <i>Ralph Lowe</i>
Position <i>Agent</i>
Company <i>Ralph Lowe</i>
Date 6-20-63

I hereby certify that the well location shown on the plat in SECTION B was plotted from field notes of actual surveys made by me or under my supervision, and that the same is true and correct to the best of my knowledge and belief.

Date Surveyed June 20, 1963
Registered Professional Engineer and/or Land Surveyor <i>Ralph Lowe</i>
Certificate No. 2290