

NEW MEXICO OIL CONSERVATION COMMISSION  
WELL LOCATION AND ACREAGE DEDICATION PLAT  
SEE INSTRUCTIONS FOR COMPLETING THIS FORM ON THE REVERSE SIDE

FORM C-128  
Revised 5/1/57

NUMBER OF COPIES RECEIVED	
DISTRIBUTION	
SANTA FE	
FILE	
US 81	
LAND OFFICE	
TRANSPORTER	OIL
PRODUCTION OFFICE	GAS
OPERATOR	

SECTION A

Operator Ralph Lowe ✓			Lease Indian Basin, Unit "B" NM-04686 "A"		Well No. 1-
Unit Letter K	Section 14	Township 21S	Range 23E	County Eddy	
Actual Footage Location of Well: 1650 feet from the South line and 1650 feet from the West line					
Ground Level Elev. 3814	Producing Formation Upper Penns.		Dedicated Acreage: 640 Acres		

1. Is the Operator the only owner in the dedicated acreage outlined on the plat below? YES ☒ NO \_\_\_\_ . ("Owner" means the person who has the right to drill into and to produce from any pool and to appropriate the production either for himself or for himself and another. (65-3-29 (e) NMSA 1935 Comp.)
2. If the answer to question one is "no," have the interests of all the owners been consolidated by communitization agreement or otherwise? YES \_\_\_\_ NO \_\_\_\_ . If answer is "yes," Type of Consolidation \_\_\_\_
3. If the answer to question two is "no," list all the owners and their respective interests below:

Owner	Land Description

RECEIVED

DEC 2 1966

SECTION B

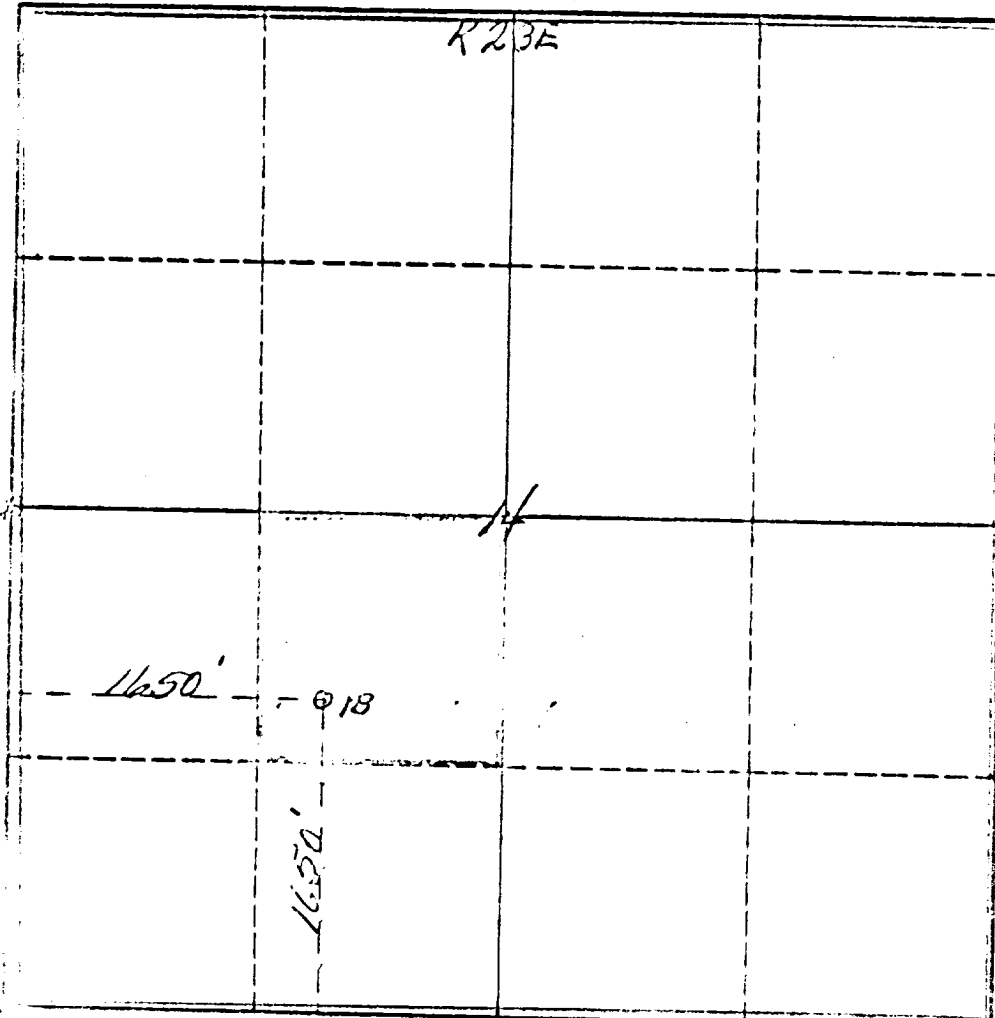

ARTSIA, UTILITY  
CERTIFICATION

I hereby certify that the information in SECTION A above is true and complete to the best of my knowledge and belief.

Name C. W. Murray
Position Agent
Company RALPH LOWE
Date December 13, 1962

I hereby certify that the well location shown on the plat in SECTION B was plotted from field notes of actual surveys made by me or under my supervision, and that the same is true and correct to the best of my knowledge and belief.

Date Surveyed November 13, 1962
Registered Professional Engineer and/or Land Surveyor

Certificate No. 542

0 300 600 900 1200 1500 1800 2100 2400 2700 3000

OIL CONSERVATION COMMISSION	
ARTESIA DISTRICT OFFICE	
No. Copies Received	3
Date Received	
FURNISHED	
OPERATOR	
SANTA FE	
PRORATION OFFICE	
STATE LAND OFFICE	
U. S. G. S.	
TRANSPORTER	
FILE	
BUREAU OF MINES	