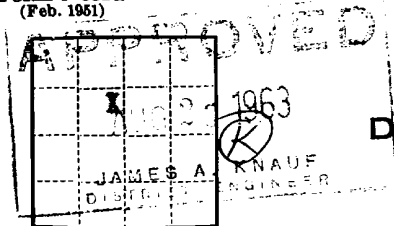

Form 9-381a  
(Feb. 1961)

(SUBMIT IN TRIPLICATE)

 UNITED STATES  
 DEPARTMENT OF THE INTERIOR  
 GEOLOGICAL SURVEY

Land Office \_\_\_\_\_

Lease No. **LC-050797**

Unit \_\_\_\_\_

 RECEIVED  
 AUG 28 1963

## SUNDRY NOTICES AND REPORTS ON WELLS C. C.

NOTICE OF INTENTION TO DRILL	<input checked="" type="checkbox"/>	SUBSEQUENT REPORT OF WATER SHUT-OFF	
NOTICE OF INTENTION TO CHANGE PLANS		SUBSEQUENT REPORT OF SHOOTING OR ACIDIZING	
NOTICE OF INTENTION TO TEST WATER SHUT-OFF		SUBSEQUENT REPORT OF ALTERING CASING	
NOTICE OF INTENTION TO RE-DRILL OR REPAIR WELL		SUBSEQUENT REPORT OF RE-DRILLING OR REPAIR	
NOTICE OF INTENTION TO SHOOT OR ACIDIZE		SUBSEQUENT REPORT OF ABANDONMENT	
NOTICE OF INTENTION TO PULL OR ALTER CASING		SUPPLEMENTARY WELL HISTORY	
NOTICE OF INTENTION TO ABANDON WELL			

(INDICATE ABOVE BY CHECK MARK NATURE OF REPORT, NOTICE, OR OTHER DATA)

8-21, 1963

 Well No. **Wills-35** is located **1930'** ft. from **N** line and **2630'** ft. from **E** line of sec. \_\_\_\_\_
**SWNEP Section 13**

(1/4 Sec. and Sec. No.)

**20 S**

(Twp.)

**20 E**

(Range)

**30**

(Meridian)

**Russell**

(Field)

**Eddy**

(County or Subdivision)

**New Mexico**

(State or Territory)

The elevation of the derrick floor above sea level is **3253** ft.

## DETAILS OF WORK

(State names of and expected depths to objective sands; show sizes, weights, and lengths of proposed casings; indicate mudding jobs, cementing points, and all other important proposed work)

Cement 5 joints 7" OD, 20# casing = 155 ft. w/15 sacks to shut off surface waters. Drill 6 1/2" rotary hole to top of Russell sand expected = depth of 790 ft. Run 4 1/2" casing & ID cemented with 60 sacks (calculated enough to fill 150% through salt section) Will drill 4" rotary hole through Russell sand. Will then decide on producing or injecting into the sand.

I understand that this plan of work must receive approval in writing by the Geological Survey before operations may be commenced.

Company **Neil H. Wills**Address **Drawer W****Carlsbad, N. M.**

By

Title

 RECEIVED  
 AUG 30 1963  
 PHILIP J. LEY

NEW MEXICO OIL CONSERVATION COMMISSION  
WELL LOCATION AND ACREAGE DEDICATION PLAT

FORM C-128  
Revised 5/1/57

SEE INSTRUCTIONS FOR COMPLETING THIS FORM ON THE REVERSE SIDE

SECTION A

Operator <b>Neil H. Wills</b>		Lease <b>LC-050797</b>		Well No. <b>Wills - 35</b>
Unit Letter <b>0</b>	Section <b>13</b>	Township <b>20 S</b>	Range <b>28 E</b>	County <b>Lddy</b>
Actual Footage Location of Well: <b>1980</b> feet from the <b>North</b> line and <b>2630</b> feet from the <b>East</b> line				
Ground Level Elev. <b>3252</b>	Producing Formation <b>Yates sand</b>	Pool <b>Russell</b>	Dedicated Acreage: <b>60</b> Acres	

1. Is the Operator the only owner in the dedicated acreage outlined on the plat below? YES ☒ NO \_\_\_\_ . ("Owner" means the person who has the right to drill into and to produce from any pool and to appropriate the production either for himself or for himself and another. (65-3-29 (e) NMSA 1935 Comp.)
2. If the answer to question one is "no," have the interests of all the owners been consolidated by communitization agreement or otherwise? YES \_\_\_\_ NO \_\_\_\_ . If answer is "yes," Type of Consolidation \_\_\_\_
3. If the answer to question two is "no," list all the owners and their respective interests below:

Owner	Land Description

SECTION B

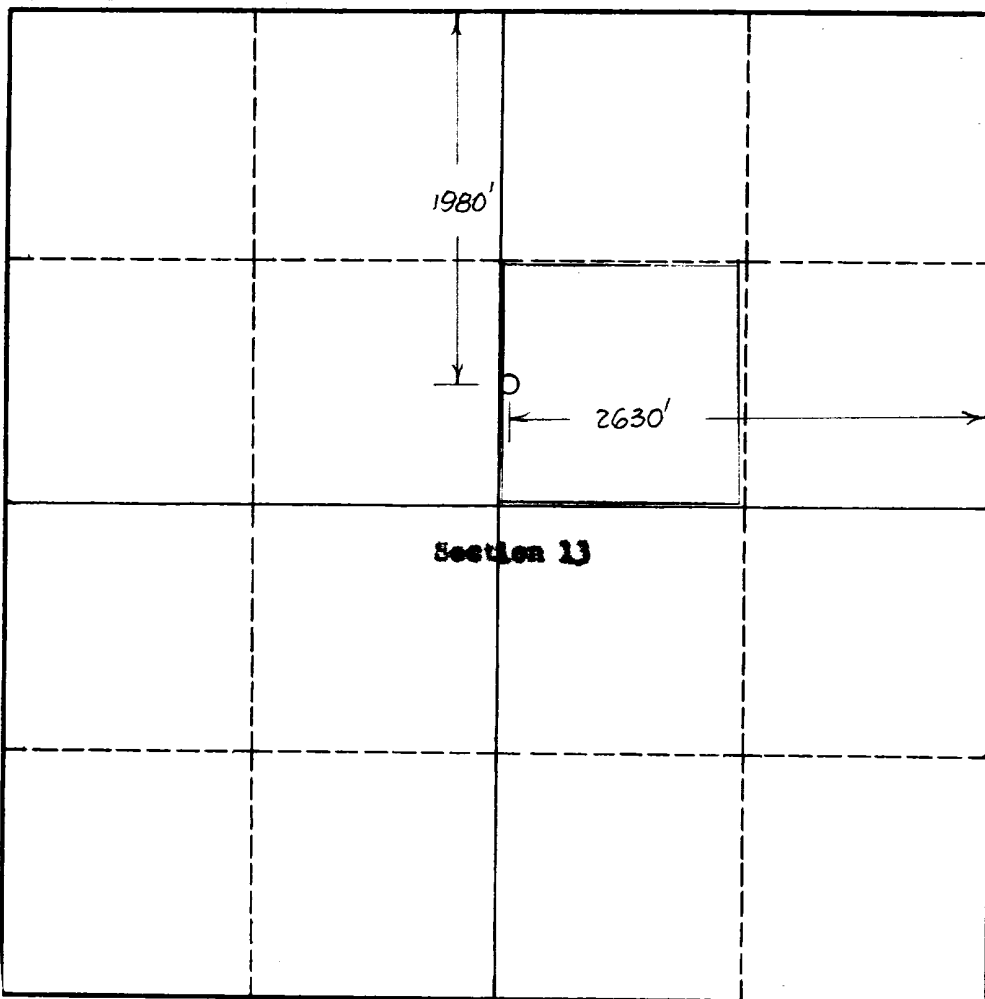

CERTIFICATION

I hereby certify that the information in SECTION A above is true and complete to the best of my knowledge and belief.

Name	<b>Neil H. Wills</b>
Position	<b>Agent</b>
Company	<b>Neil H. Wills</b>
Date	<b>8-21-63</b>

I hereby certify that the well location shown on the plat in SECTION B was plotted from field notes of actual surveys made by me or under my supervision, and that the same is true and correct to the best of my knowledge and belief.

Date Surveyed	<b>8-20-63</b>
Registered Professional Engineer and/or Land Surveyor	<b>Neil H. Wills</b>
Certificate No.	<b>772</b>

330 660 990 1320 1650 1980 2310 2640 2000 1500 1000 500 0

### INSTRUCTIONS FOR COMPLETION OF FORM C-128

1. Operator shall furnish and certify to the information called for in Section A.
2. Operator shall outline the dedicated acreage for *both* oil and gas wells on the plat in Section B.
3. A registered professional engineer or land surveyor registered in the State of New Mexico or approved by the Commission shall show on the plat the location of the well and certify this information in the space provided.
4. All distances shown on the plat must be from the outer boundaries of the Section.
5. If additional space is needed for listing owners and their respective interests as required in question 3 of Section A, please use space below.

30-015-10100

ORIP 153653

PAOP 18883

POO 152820

unorthodox Location approved  
by order # R-2511