

DISTRICT I
P.O. Box 1980, Hobbs, NM 88241-1980

State of New Mexico
Energy, Minerals and Natural Resources Department

Form C-102
Revised February 10, 1994
Submit to Appropriate District Office
State Lease - 4 Copies
Fee Lease - 3 Copies

DISTRICT II
P.O. Drawer DD, Artesia, NM 86211-0719

DISTRICT III
1000 Rio Brazos Rd., Aztec, NM 87410

DISTRICT IV
P.O. BOX 2088, SANTA FE, N.M. 87504-2088

OIL CONSERVATION DIVISION
P.O. Box 2088
Santa Fe, New Mexico 87504-2088

☐ AMENDED REPORT

WELL LOCATION AND ACREAGE DEDICATION PLAT

API Number 30-015-10342	Pool Code 79040	Pool Name INDIAN BASIN 4488ER PENN
Property Code	Property Name LOWE STATE GAS COM	Well Number 1
OGRID No. 02110	Operator Name ORYX ENERGY COMPANY	Elevation 3845

Surface Location

UL or lot No. F	Section 36	Township 21 S	Range 23 E	Lot Idn	Feet from the 1895	North/South line NORTH	Feet from the 1708	East/West line WEST	County EDDY
--------------------	---------------	------------------	---------------	---------	-----------------------	---------------------------	-----------------------	------------------------	----------------

Bottom Hole Location If Different From Surface 1712

UL or lot No.	Section	Township	Range	Lot Idn	Feet from the	North/South line	Feet from the	East/West line	County
Dedicated Acres 640 320					Joint or Infill	Consolidation Code	Order No.		

NO ALLOWABLE WILL BE ASSIGNED TO THIS COMPLETION UNTIL ALL INTERESTS HAVE BEEN CONSOLIDATED
OR A NON-STANDARD UNIT HAS BEEN APPROVED BY THE DIVISION

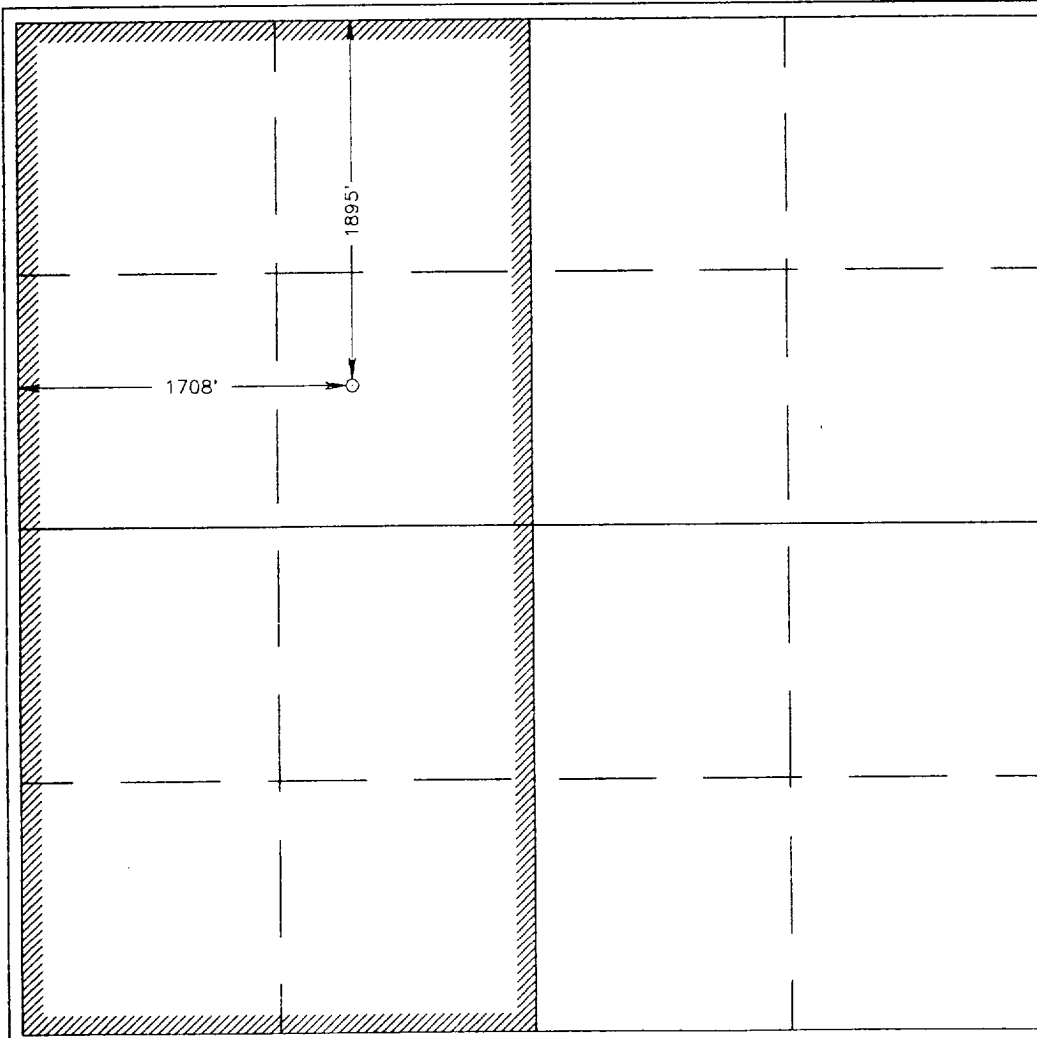

OPERATOR CERTIFICATION

I hereby certify the the information
contained herein is true and complete to the
best of my knowledge and belief.

Edgar L Perez
Signature
Edgar L Perez
Printed Name
Production Analyst
Title
1/22/1999
Date

SURVEYOR CERTIFICATION

I hereby certify that the well location shown
on this plat was plotted from field notes of
actual surveys made by me or under my
supervision, and that the same is true and
correct to the best of my belief.

JANUARY 14, 1999

Date Surveyed
Signature & Seal of
Professional Surveyor

Gary Edson
1/20/99
99-11-0022

Certificate No. RONALD J. EDSON 3239
GARY EDSON 12641
MAGN McDONALD 12185