

DISTRICT I
1625 N. French Dr., Hobbs, NM 88240

DISTRICT II
811 South First, Artesia, NM 88210

DISTRICT III
1000 Rio Brazos Rd., Aztec, NM 87410

DISTRICT IV
2040 South Pacheco, Santa Fe, NM 87501

State of New Mexico
Energy, Minerals and Natural Resources Department

OIL CONSERVATION DIVISION
PO BOX 2088
Santa Fe, NM 87504-2088

Form C-101
Revised March 17, 1999
Instructions on back
Submit to appropriate District Office
State Lease - 6 Copies
Fee Lease - 5 Copies

☐ AMENDED REPORT

APPLICATION FOR PERMIT TO DRILL, RE-ENTER, DEEPEN, PLUGBACK, OR ADD A ZONE

¹ Operator Name and Address Yates Petroleum Corporation 105 South Fourth Street Artesia, New Mexico 88210		² OGRID Number 025575
		³ API Number 30- 30-015-10414
⁴ Property Code 20795	⁵ Property Name Archimedes SWD	⁶ Well No. 1

7 Surface Location

UL or lot no.	Section	Township	Range	Lot Idn	Feet from the	North/South Line	Feet from the	East/West Line	County
J	18	21S	24E		1650'	South	1980'	East	Eddy

8 Proposed Bottom Hole Location If Different From Surface

UL or lot no.	Section	Township	Range	Lot Idn	Feet from the	North/South Line	Feet from the	East/West Line	County
⁹ Proposed Pool 1 Wildcat Devonian					¹⁰ Proposed Pool 2				

¹¹ Work Type Code D	¹² Well Type Code S	¹³ Cable/Rotary R	¹⁴ Lease Type Code S	¹⁵ Ground Level Elevation 3838'
¹⁶ Multiple N	¹⁷ Proposed Depth 11,000'	¹⁸ Formation Devonian	¹⁹ Contractor Not Determined	²⁰ Spud Date ASAP

21 Proposed Casing and Cement Program

Hole Size	Casing Size	Casing weight/feet	Setting Depth	Sacks of Cement	Estimated TOC
17 1/2"	13 3/8"	48#	356'	430 sx	In Place
12 1/4"	9 5/8"	36#	3188'	1450sx	In Place
8 3/4"	7"	26# + 29#	9751'	600sx	In Place
6 1/4"	4.5***	11.6#	11000'	200 sx	TOC 9500'
** Casing is liner					

²² Describe the proposed program. If this application is to DEEPEN or PLUG BACK give the data on the present productive zone and proposed new productive zone. Describe the blowout prevention program, if any. Use additional sheets if necessary.

SEE ATTACHED PAGE 2.

²³ I hereby certify that the information given above is true and complete to the best of my knowledge and belief.
Signature: *Cy Cowan*

Printed name: Cy Cowan

Title: Regulatory Agent

Date: 11/26/02

Phone: (505) 748-1471

OIL CONSERVATION DIVISION

Approved by: **ORIGINAL SIGNED BY TIM W. GUM**
DISTRICT II SUPERVISOR

Title:

Approval Date: **DEC 04 2002**

Conditions of Approval

Attached ☐

Expiration Date: **DEC 04 2003**

YATES PETROLEUM CORPORATION

Archimedes SWD #1

Drilling Prognosis

Page 2

This well was originally drilled by Union Oil Company of California as the State 1-18 on February 3, 1964 and was plugged and abandoned on April 24, 1964.

Yates Petroleum Corporation proposes to deepen this well using a drilling rig to 11,300' for SWD service in the Devonian Formation. The perforations in the 7" casing will be squeezed and a 4 1/2" liner will be set from TD to approximately 9250' and cemented with 250 sacks of cement. The well will then be completed with a pulling unit in the Devonian within the interval of 10,600' to 10,800' (depth to be determined after logs are run). Mud to be used is 9.2 - 9.5 ppg brine water with a viscosity Vis 55 - 70 cp.

Yates Petroleum Corporation has received approval to convert the subject well to saltwater service in the Devonian Formation. Administrative order SWD-814 has been given an extension of 180 days by letter dated September 11, 2002 from Lori Wrotenbery.

MUD PROGRAM: Mud to be used is 9.2-9.5 ppg brine water, Viscosity 55-70cp.

BOPE PROGRAM: 2000 # BOPE will be installed on the 9 5/8 in casing and tested daily for operational.

MEXICO OIL CONSERVATION COMMISSION
WELL LOCATION AND ACREAGE DEDICATION PLAT

FORM C-129
Revised 5/1/57

SEE INSTRUCTIONS FOR COMPLETING THIS FORM ON THE REVERSE SIDE

SECTION A

Operator UNION OIL COMPANY OF CALIFORNIA			Lease STATE		Well No. 1-18
Unit Letter J	Section 18	Township 21 SOUTH	Range 24 EAST	County EDDY	
Actual Footage Location of Well: 1980 feet from the EAST line and 1650 feet from the SOUTH line					
Ground Level Elev. Unknown	Producing Formation Upper Penn. or Morrow		Pool Underlig. Indian Hills Upper Penn. Gas or Wildcat		Dedicated Acreage: 640 Acres

1. Is the Operator the only owner in the dedicated acreage outlined on the plat below? YES _____ NO X ("Owner" means the person who has the right to drill into and to produce from any pool and to appropriate the production either for himself or for himself and another. (65-3-29 (e) NMSA 1935 Comp.)
2. If the answer to question one is "no," have the interests of all the owners been consolidated by communitization agreement or otherwise? YES X NO _____. If answer is "yes," Type of Consolidation Unit operating Agreement
3. If the answer to question two is "no," list all the owners and their respective interests below:

Owner	Land Description

RECEIVED
JAN 27 1964

D. C. C.
CERTIFICATION
EDDYSIA, OFFICE

SECTION B

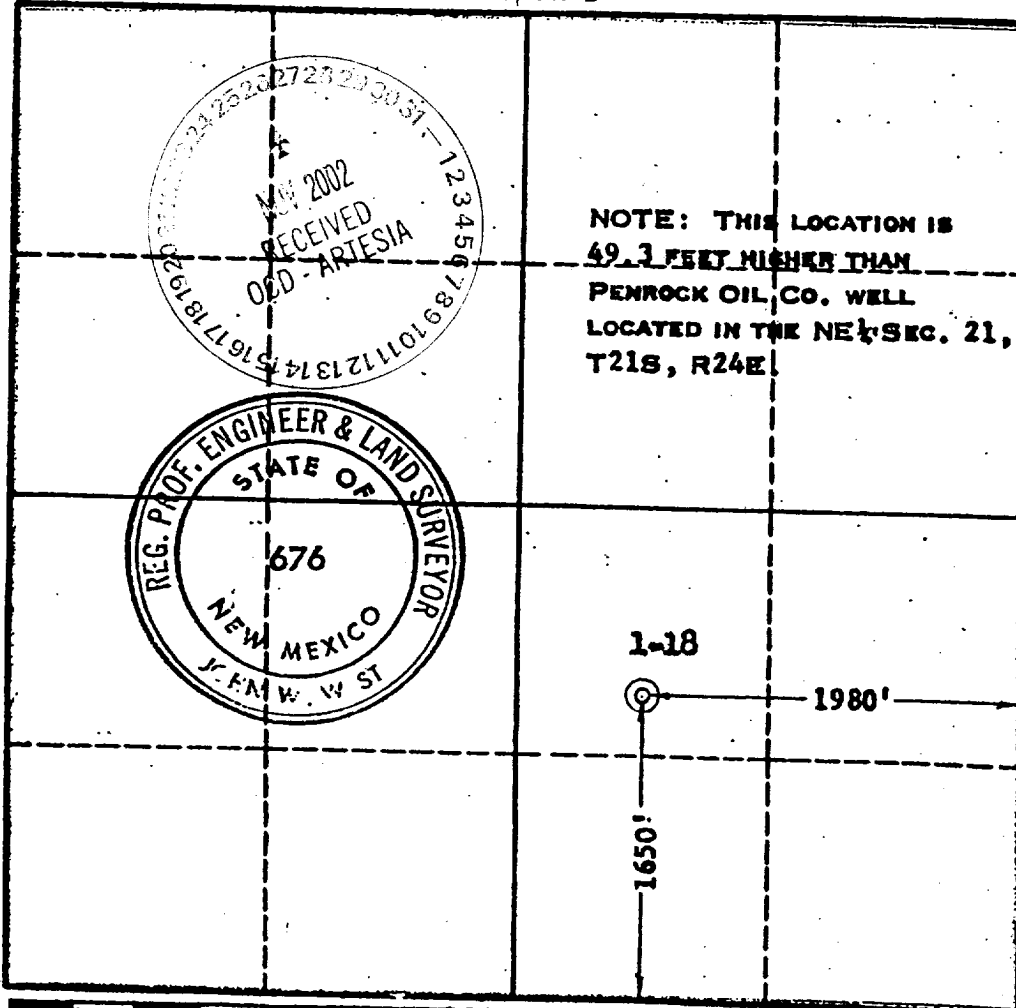

I hereby certify that the information in SECTION A above is true and complete to the best of my knowledge and belief.

Name <u>C. J. Dign</u>
Position <u>Production Clerk</u>
Company <u>Union Oil Company of Calif</u>
Date <u>January 22, 1964</u>

I hereby certify that the well location shown on the plat in SECTION B was plotted from field notes of actual surveys made by me or under my supervision, and that the same is true and correct to the best of my knowledge and belief.

Date Surveyed <u>1-8-1964</u>
Registered Professional Engineer and/or Land Surveyor, <u>JOHN W. WEST</u>
Certificate No. <u>N. M. - P. E. & L. S. NO. 676</u>

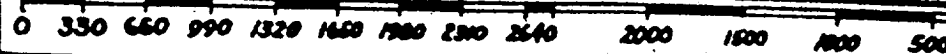

DISTRICT II

811 South First, Artesia, NM 88210

DISTRICT III

1800 Rio Brazos Rd., Aztec, NM 87410

DISTRICT IV

2040 South Pacheco, Santa Fe, NM 87506

OIL CONSERVATION DIVISION

P.O. Box 2088

Santa Fe, New Mexico 87504-2088

☐ AMENDED REPORT

WELL LOCATION AND ACREAGE DEDICATION PLAT

API Number	Pool Code	Pool Name
		Devonian
Property Code	Property Name	Well Number
	Archimedes SWD	1
OGED No.	Operator Name	Elevation
025575	Yates Petroleum Corporation	3838'

Surface Location

UL or lot No.	Section	Township	Range	Lot 1/4	Feet from the	North/South line	Feet from the	East/West line	County
J	18	21S	24E		1650'	South	1980'	East	Eddy

Bottom Hole Location If Different From Surface

UL or lot No.	Section	Township	Range	Lot 1/4	Feet from the	North/South line	Feet from the	East/West line	County

Dedicated Acres	Joint or Infill	Consolidation Code	Order No.
40			

NO ALLOWABLE WILL BE ASSIGNED TO THIS COMPLETION UNTIL ALL INTERESTS HAVE BEEN CONSOLIDATED
OR A NON-STANDARD UNIT HAS BEEN APPROVED BY THE DIVISION

		VA-636	
			1980'

1650'

OPERATOR CERTIFICATION

I hereby certify that the information contained herein is true and complete to the best of my knowledge and belief.

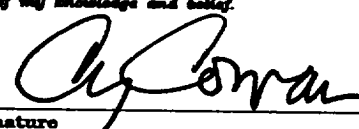

Signature

Cy Cowan

Printed Name

Regulatory Agent

Title

November 26, 2002

Date

SURVEYOR CERTIFICATION

I hereby certify that the well location shown on this plat was plotted from field notes of actual surveys made by me or under my supervision, and that the same is true and correct to the best of my belief.

REFER TO ORIGINAL PLAT.

Date Surveyed

Signature & Seal of Professional Surveyor

Certificate No. Herschel L. Jones RLS 3640

GENERAL SURVEYING COMPANY

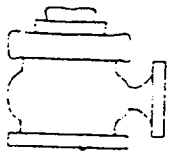

Yates Petroleum Corporation

BOP-2

Typical 2,000 psi Pressure System Schematic Double Ram Preventer Stack

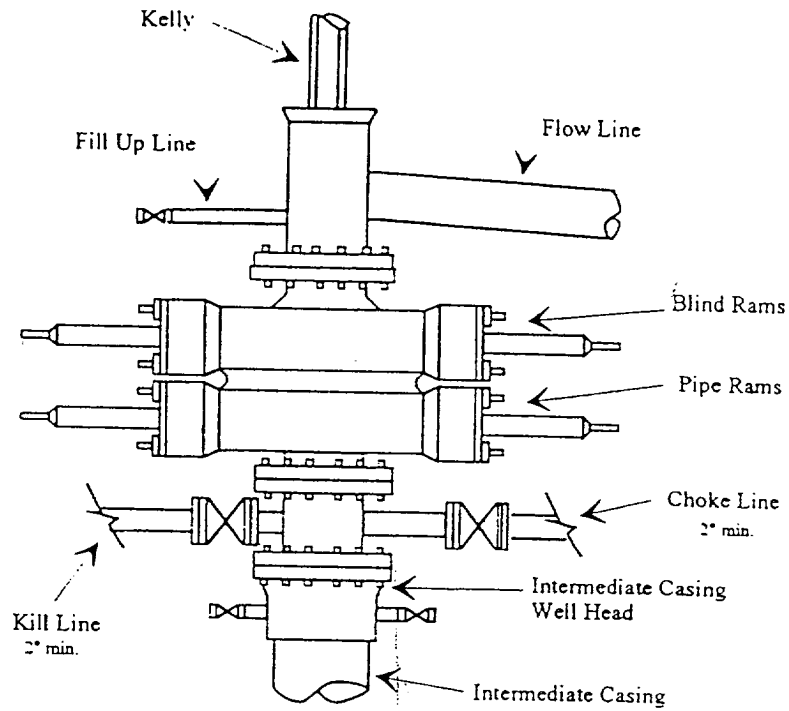

Typical 2,000 psi choke manifold assembly with at least these minimum features

