

(SUBMIT IN TRIPLICATE)

Budget Bureau No. 42-R358.4.
Form Approved.

APPROVED

AUG 27 1964

RONNIE E. SHOOK
ACTING DISTRICT ENGINEER

UNITED STATES
DEPARTMENT OF THE INTERIOR
GEOLOGICAL SURVEY

Land Office

Lease No. **LC-050797**

Unit

RECEIVED

AUG 28 1964

SUNDRY NOTICES AND REPORTS ON WELLS

NOTICE OF INTENTION TO DRILL.....	<input checked="" type="checkbox"/> SUBSEQUENT REPORT OF WATER SHUT-OFF.....
NOTICE OF INTENTION TO CHANGE PLANS.....	SUBSEQUENT REPORT OF SHOOTING OR ACIDIZING.....
NOTICE OF INTENTION TO TEST WATER SHUT-OFF.....	SUBSEQUENT REPORT OF ALTERING CASING.....
NOTICE OF INTENTION TO RE-DRILL OR REPAIR WELL.....	SUBSEQUENT REPORT OF RE-DRILLING OR REPAIR.....
NOTICE OF INTENTION TO SHOOT OR ACIDIZE.....	SUBSEQUENT REPORT OF ABANDONMENT.....
NOTICE OF INTENTION TO PULL OR ALTER CASING.....	SUPPLEMENTARY WELL HISTORY.....
NOTICE OF INTENTION TO ABANDON WELL.....	

(INDICATE ABOVE BY CHECK MARK NATURE OF REPORT, NOTICE, OR OTHER DATA)

8-25, 19 64

Well No. **1111-41** is located **1310** ft. from **[N]** line and **1110** ft. from **[E]** line of sec.

NE 1/4 Sec. 13 **20N** **25E** **100W**
(1/4 Sec. and Sec. No.) (Twp.) (Range) (Meridian)
Russell **Edwy** **New Mexico**
(Field) (County or Subdivision) (State or Territory)

The elevation of the derrick floor above sea level is **3255** ft.

DETAILS OF WORK

(State names of and expected depths to objective sands; show sizes, weights, and lengths of proposed casings; indicate mudding jobs, cementing points, and all other important proposed work)

Plan to cement 150 ft. of 7" casing with 15 sacks portland to shut off surface waters. Drill out with 6 1/8 bit to top of Yates sand approximately 850 ft. will run 5 inch casing cement with 60 sacks (calculated enough to fill 150' through salt section). Will drill Yates sand and then decide on producing or injecting water.

Order # R-2511

I understand that this plan of work must receive approval in writing by the Geological Survey before operations may be commenced.

Company **Neil H. Mills**

Address **Drawer**

Carlsbad, New Mexico

By **[Signature]**

Title **Agent**

NUMBER OF COPIES RECEIVED	
DISTRIBUTION	
SANTA	
FILE	
U.S.G.S.	
LAND OFFICE	
TRANSPORTER	OIL GAS
PRODUCTION OFFICE	
OPERATOR	

NEW MEXICO OIL CONSERVATION COMMISSION
WELL LOCATION AND ACREAGE DEDICATION PLAT
 SEE INSTRUCTIONS FOR COMPLETING THIS FORM ON THE REVERSE SIDE

FORM C-128
Revised 5/1/57

SECTION A

Operator Neil H. Mills		Lease LC-050797		Well No. W1110-41	
Unit Letter A	Section 13	Township 20S	Range 28E	County Eddy	
Actual Footage Location of Well: 1310 feet from the North line and 1310 feet from the East line					
Ground Level Elev. 3291	Producing Formation Yates sand		Pool Russell	Dedicated Acreage: 40 Acres	

1. Is the Operator the only owner in the dedicated acreage outlined on the plat below? YES ☒ NO ____ . ("Owner" means the person who has the right to drill into and to produce from any pool and to appropriate the production either for himself or for himself and another. (65-3-29 (e) NMSA 1935 Comp.)
2. If the answer to question one is "no," have the interests of all the owners been consolidated by communitization agreement or otherwise? YES ____ NO ____ . If answer is "yes," Type of Consolidation _____
3. If the answer to question two is "no," list all the owners and their respective interests below:

Owner	Land Description

RECEIVED
AUG 28 1964

SECTION B

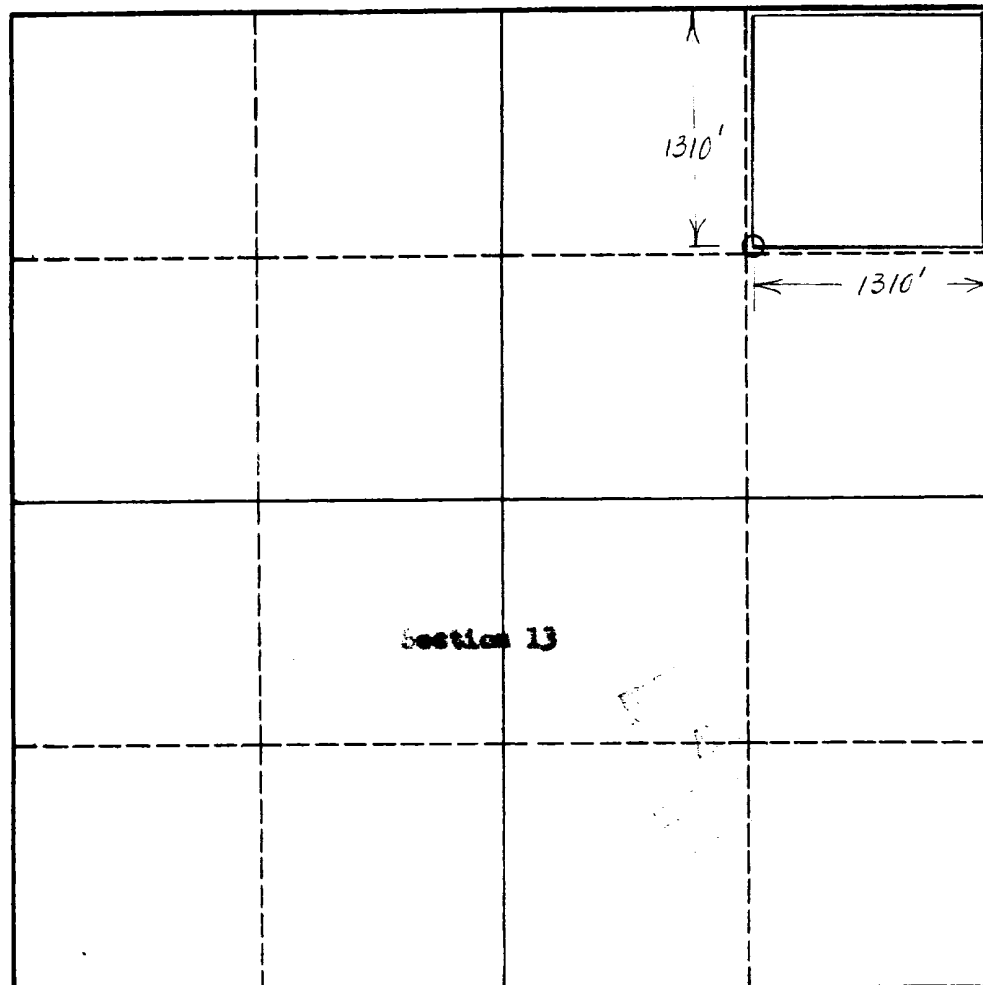

I hereby certify that the information in SECTION A above is true and complete to the best of my knowledge and belief.

Name	Neil H. Mills
Position	Agent
Company	Neil H. Mills
Date	8-25-64

I hereby certify that the well location shown on the plat in SECTION B was plotted from field notes of actual surveys made by me or under my supervision, and that the same is true and correct to the best of my knowledge and belief.

Date Surveyed	8-24-64
Registered Professional Engineer and/or Land Surveyor	Neil H. Mills
Certificate No.	771

0 330 660 990 1320 1650 1980 2310 2640 2000 1500 1000 500 0

INSTRUCTIONS FOR COMPLETION OF FORM C-128

1. Operator shall furnish and certify to the information called for in Section A.
2. Operator shall outline the dedicated acreage for *both* oil and gas wells on the plat in Section B.
3. A registered professional engineer or land surveyor registered in the State of New Mexico or approved by the Commission shall show on the plat the location of the well and certify this information in the space provided.
4. All distances shown on the plat must be from the outer boundaries of the Section.
5. If additional space is needed for listing owners and their respective interests as required in question 3 of Section A, please use space below.

30-015-10423

OARID 153653

PROP 18883

POOI 52820

Non Stand. Lac. Order # R-25-11
11/1/11