

**APPROVED**  
OCT 23 1964  
*Shook*  
ROBERT E. SHOOK  
ACTING DISTRICT ENGINEER

(SUBMIT IN TRIPLICATE)

UNITED STATES  
DEPARTMENT OF THE INTERIOR  
GEOLOGICAL SURVEY

Budget Bureau No. 42-R358.4.  
Form Approved.

Land Office New Mexico

Lease No. RM 08277

Unit \_\_\_\_\_

**RECEIVED**

OCT 27 1964

**SUNDRY NOTICES AND REPORTS ON WELLS**

**D. C. C. ARTESIA, OFFICE**

NOTICE OF INTENTION TO DRILL.....	<input checked="" type="checkbox"/>	SUBSEQUENT REPORT OF WATER SHUT-OFF.....	
NOTICE OF INTENTION TO CHANGE PLANS.....		SUBSEQUENT REPORT OF SHOOTING OR ACIDIZING.....	
NOTICE OF INTENTION TO TEST WATER SHUT-OFF.....		SUBSEQUENT REPORT OF ALTERING CASING.....	
NOTICE OF INTENTION TO RE-DRILL OR REPAIR WELL.....		SUBSEQUENT REPORT OF RE-DRILLING OR REPAIR.....	
NOTICE OF INTENTION TO SHOOT OR ACIDIZE.....		SUBSEQUENT REPORT OF ABANDONMENT.....	
NOTICE OF INTENTION TO PULL OR ALTER CASING.....		SUPPLEMENTARY WELL HISTORY.....	
NOTICE OF INTENTION TO ABANDON WELL.....			

(INDICATE ABOVE BY CHECK MARK NATURE OF REPORT, NOTICE, OR OTHER DATA)

Oct. 19, 1964, 19

Well No. Hughes 7 is located 990 ft. from N line and 1808 ft. from E line of sec. 33

SW 1/4 Sec 33 20N 28E N.M.P.M.  
(1/4 Sec. and 1/2 Sec. No.) (Twp.) (Range) (Meridian)  
Saladar-Yates Eddy New Mexico  
(Field) (County or Subdivision) (State or Territory)

The elevation of the derrick floor above sea level is 3199 ft.

**DETAILS OF WORK**

(State names of and expected depths to objective sands; show sizes, weights, and lengths of proposed casings; indicate mudding jobs, cementing points, and all other important proposed work)

Drill rotary hole into the top of the Tensill formation at about 420 feet.

Set and mud 7" pipe to shut off surface water and red beds.

Drill 6 1/2" rotary hole to about 660 feet to test the Yates sand.

If oil is found 5 1/2" pipe will be run to the top of the sand and cemented back to the surface after pulling the 7" surface pipe.

I understand that this plan of work must receive approval in writing by the Geological Survey before operations may be commenced.

Company Geo. D. Riggs  
Address Box 116  
Carlsbad, New Mexico

By Geo. D. Riggs  
Title operator

**RECEIVED**

OCT 23 1964

U. S. GEOLOGICAL SURVEY  
ROSSELL, NEW MEXICO

35

2

2

2

2

2

NEW MEXICO OIL CONSERVATION COMMISSION

Well Location and Acreage Dedication Plat

Oct 19 1964

Section A. **Geo. D. Riggs**

Date **Oct 27 1964**

Operator **7** **33** Lease **20 south 28 east**  
Well No. **990** Unit Letter **South** Section **1000** Township **west** Range **100** NMPM  
Located **244** Feet From **2199** Line, **Salador** Feet From **100** Line  
County **Salador** G. L. Elevation **Salador** Dedicated Acreage **Salador** Acres  
Name of Producing Formation **Salador** Pool **Salador**

1. Is the Operator the only owner\* in the dedicated acreage outlined on the plat below?  
Yes **Operating Agreement** No **Operating Agreement**
2. If the answer to question one is "no," have the interests of all the owners been consolidated by communitization agreement or otherwise? Yes **Operating Agreement** No **Operating Agreement**. If answer is "yes," Type of Consolidation **Operating Agreement**
3. If the answer to question two is "no," list all the owners and their respective interests below:

Owner

Land Description

RECEIVED

OCT 27 1964

RECEIVED

OCT 23 1964

Section B

U. C. C.  
ARTEBIA, OFFICE

U. S. GEOLOGICAL SURVEY  
ROSWELL, NEW MEXICO

This is to certify that the information in Section A above is true and complete to the best of my knowledge and belief.

**Geo. D. Riggs**  
(Operator)

Box **100** (Representative) **100**

Address

This is to certify that the well location shown on the plat in Section B was plotted from field notes of actual surveys made by me or under my supervision and that the same is true and correct to the best of my knowledge and belief.

Date Surveyed **Oct 27 1964**

**Geo. D. Riggs**  
Registered Professional  
Engineer and/or Land Surveyor.

Certificate No. **107**

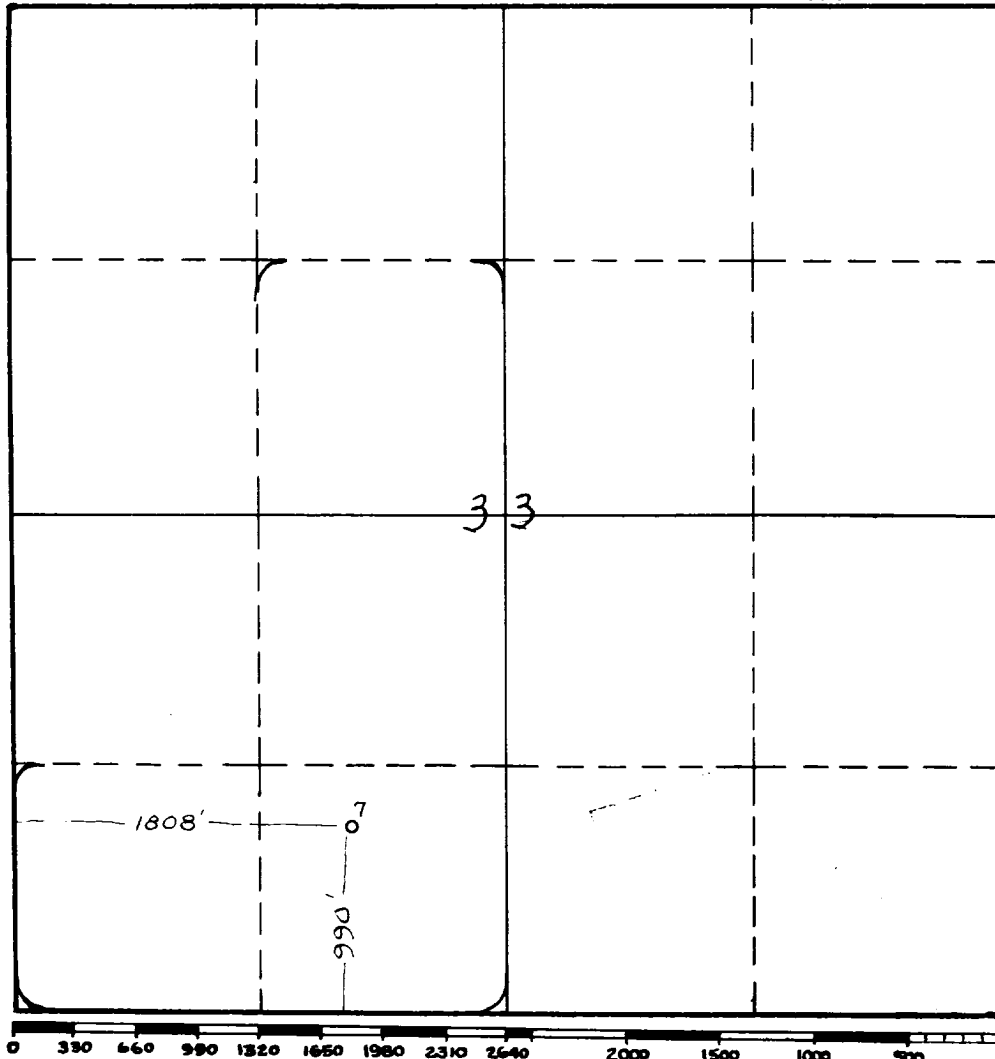

INSTRUCTIONS FOR COMPLETION

1. Operator shall furnish and certify to the information called for in Section A.
2. Operator shall outline the dedicated acreage for both oil and gas wells on the plat in Section B.
3. A registered professional engineer or land surveyor registered in the State of New Mexico or approved by the Commission shall show on the plat the location of the well and certify this information in the space provided.
4. All distances shown on the plat must be from the outer boundaries of Section.
5. If additional space is needed for listing owners and their respective interests as required in question 3, Section A, please use space below

\* "Owner" means the person who has the right to drill into and to produce from any pool and to appropriate the production either for himself or for himself and another. (65-3-29 (e) NMSA 1953 Comp.)