

RECEIVED

NEW MEXICO OIL CONSERVATION COMMISSION
WELL LOCATION AND ACREAGE DEDICATION PLATS - GEOLOGICAL SURVEY

JUN 11 1965
FORM C-128
REVISED 5/1/57

SEE INSTRUCTIONS FOR COMPLETING THIS FORM ON THE REVERSE SIDE

ARTESIA, NEW MEXICO

SECTION A

Operator MARATHON OIL CO.			Lease NORTH INDIAN BASIN UNIT		Well No. 5
Unit Letter J	Section 9	Township 21 SOUTH	Range 23 EAST	County EDDY	
Actual Footage Location of Well: 1815 feet from the SOUTH line and 1752.3 feet from the EAST line					
Ground Level Elev.	Producing Formation UPPER PENNSYLVANIAN		Pool INDIAN BASIN UPPER PENN		Dedicated Acreage: 640 Acres

1. Is the Operator the only owner in the dedicated acreage outlined on the plat below? YES _____ NO **X**. ("Owner" means the person who has the right to drill into and to produce from any pool and to appropriate the production either for himself or for himself and another. (65-3-29 (e) NMSA 1935 Comp.)
2. If the answer to question one is "no," have the interests of all the owners been consolidated by communitization agreement or otherwise? YES **X** NO _____. If answer is "yes," Type of Consolidation **Consolidation Agreement**
3. If the answer to question two is "no," list all the owners and their respective interests below:

Owner	Land Description

SECTION B

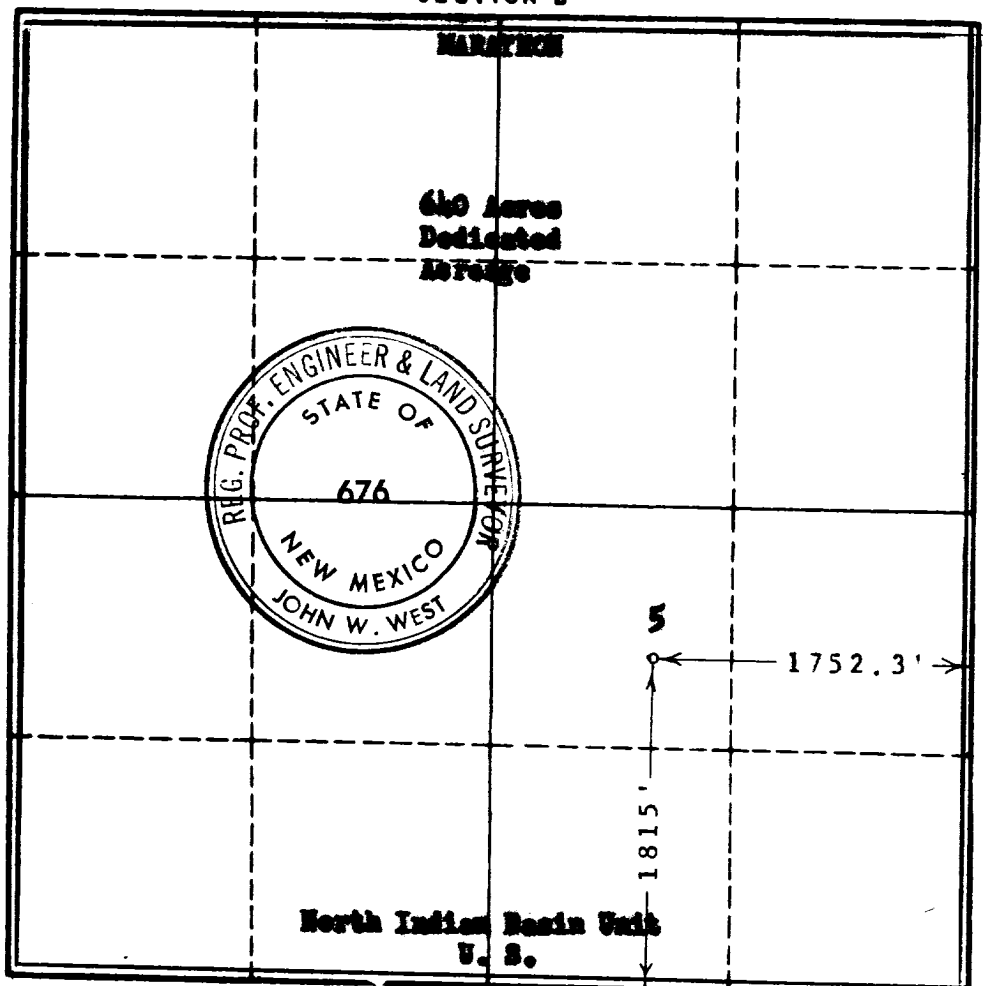

CERTIFICATION

I hereby certify that the information in SECTION A above is true and complete to the best of my knowledge and belief.

John R. Barber
 Name
J. R. Barber
 Position
Area Petroleum Engineer
 Company
Marathon Oil Company
 Date
6-10-65

I hereby certify that the well location shown on the plat in SECTION B was plotted from field notes of actual surveys made by me or under my supervision, and that the same is true and correct to the best of my knowledge and belief.

Date Surveyed
6-4-65
 Registered Professional Engineer and/or Land Surveyor, **JOHN W. WEST**
John W. West
 Certificate No.
N. M. - P. E. & L. S. NO. 676

0 330 660 990 1320 1650 1980 2310 2640 2000 1500 1000 500 0