

Not on book,  
but, <sup>put</sup> on activity report.

RECEIVED

NO. OF COPIES RECEIVED	6
DISTRIBUTION	
SANTA FE	1
FILE	1
U.S.G.S.	2
LAND OFFICE	1
OPERATOR	1

NEW MEXICO OIL CONSERVATION COMMISSION  
**APPROVAL VALID**  
**FOR 90 DAYS UNLESS O. C. C.**  
**DRILLING COMMENCED**

Form C-101  
 Revised 1-1-65

5A. Indicate Type of Lease  
 STATE ☒ FEE ☐  
 5. State Oil & Gas Lease No.  
 OG-5108

EXPIRES 6-5-66

APPLICATION FOR PERMIT TO DRILL, DEEPEN, OR PLUG BACK

1a. Type of Work DRILL <input checked="" type="checkbox"/> DEEPEN <input type="checkbox"/> PLUG BACK <input type="checkbox"/>		7. Unit Agreement Name -----
b. Type of Well OIL WELL <input type="checkbox"/> GAS WELL <input checked="" type="checkbox"/> OTHER <input type="checkbox"/>		8. Farm or Lease Name State "DF" Gas Com.
2. Name of Operator Texaco Inc.		9. Well No. 1-Y
3. Address of Operator P. O. Box 3109, Midland, Texas		10. Field and Pool, or Wildcat Undesignated Indian Basin - Upper Perm.
4. Location of Well UNIT LETTER <u>K X</u> LOCATED <u>1461</u> FEET FROM THE <u>South</u> LINE AND <u>2542</u> FEET FROM THE <u>West</u> LINE OF SEC. <u>32</u> TWP. <u>21S</u> RGE. <u>23E</u> NMPM		12. County Eddy
21. Elevations (Show whether DF, RT, etc.) GR - 4083'		19. Proposed Depth 7475'
21A. Kind & Status Plug. Bond \$10,000 blanket		19A. Formation Cisco
21B. Drilling Contractor Unknown		20. Rotary or C.T. Rotary
22. Approx. Date Work will start At once		

23.

PROPOSED CASING AND CEMENT PROGRAM

SIZE OF HOLE	SIZE OF CASING	WEIGHT PER FOOT	SETTING DEPTH	SACKS OF CEMENT	EST. TOP
17 1/2"	13 3/8"	48#	196'	350*	Circulate
12 1/4"	9 5/8"	36#	2300'	1100**	Circulate
8 3/4"	5 1/2"	14#, 15 1/2#, 17#	7500'	300***	150% to tie-back to 9 5/8"

\*Cement with 350 sx Class C neat cement with 2% calcium chloride. (300% to circulate)  
 \*\*Cement with 900 sx surface TLW cement w/4% Gel plus 200 sx Incor neat cement. (250% to circ.)  
 \*\*\*Cement with 300 sx Incor w/4% Gel. (150% to tie-back to 9 5/8")

FORMATION TOPS EXPECTED

San Andres	415'	Wolfcamp Clastic	5670'
Glorieta	1790'	Cisco	6870'
		Total Depth	7475'

This relief well is being drilled to provide for controlling State of New Mexico "DF" Well No. 1 which blew out and caught fire February 22, 1966, at a total depth of 7095 feet.

IN ABOVE SPACE DESCRIBE PROPOSED PROGRAM: IF PROPOSAL IS TO DEEPEN OR PLUG BACK, GIVE DATA ON PRESENT PRODUCTIVE ZONE AND PROPOSED NEW PRODUCTIVE ZONE. GIVE BLOWOUT PREVENTER PROGRAM, IF ANY.

I hereby certify that the information above is true and complete to the best of my knowledge and belief.

Signed J. J. Velten Title Division Civil Engineer Date 3/2/66  
 (This space for State Use)

APPROVED BY W. A. Gussert TITLE OIL AND GAS INSPECTOR DATE MAR 8 1966

CONDITIONS OF APPROVAL, IF ANY: 1. Notify this office in sufficient time to witness cementing the 9 5/8" csg. 2. TLW cement w/ 4% Gel not acceptable.

N MEXICO OIL CONSERVATION COMMISSION  
WELL LOCATION AND ACREAGE DEDICATION PLAT

Form C-102  
Supersedes C-128  
Effective 1-1-65

All distances must be from the outer boundaries of the Section.

Operator <b>TEXACO Inc.</b>			Lease <b>State "DF" Gas Comm.</b>		Well No. <b>1-Y</b>
Unit Letter <b>K</b>	Section <b>32</b>	Township <b>21 South</b>	Range <b>23 East</b>	County <b>Eddy</b>	
Actual Footage Location of Well: <b>1161</b> feet from the <b>South</b> line and <b>2542</b> feet from the <b>West</b> line <b>Sec. 32</b>					
Ground Level Elev. <b>Not Available</b>	Producing Formation <b>Cisco</b>	Pool <b>Undesignated</b> <b>Indian Basin-Upper Penn.</b>		Dedicated Acreage: <b>640</b> Acres	

- Outline the acreage dedicated to the subject well by colored pencil or hachure marks on the plat below.
- If more than one lease is dedicated to the well, outline each and identify the ownership thereof (both as to working interest and royalty).
- If more than one lease of different ownership is dedicated to the well, have the interests of all owners been consolidated by communitization, unitization, force-pooling, etc?

☒ Yes ☐ No If answer is "yes," type of consolidation Communitization Agreement

If answer is "no," list the owners and tract descriptions which have actually been consolidated. (Use reverse side of this form if necessary.)

No allowable will be assigned to the well until all interests have been consolidated (by communitization, unitization; forced-pooling, or otherwise) or until a non-standard unit, eliminating such interests, has been approved by the Commission.

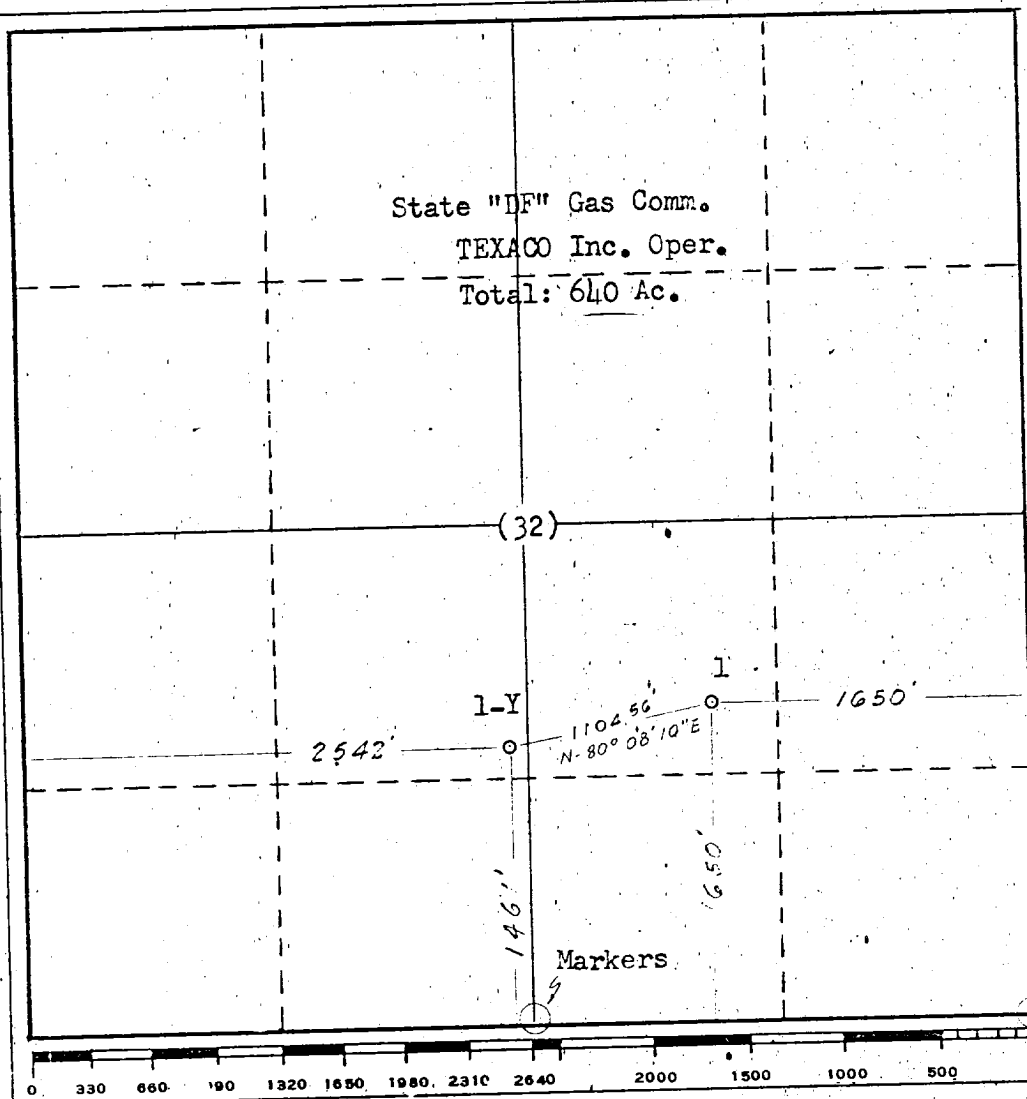

**CERTIFICATION**

I hereby certify that the information contained herein is true and complete to the best of my knowledge and belief.

Name J. J. Velten  
Position  
**Division Civil Engineer**  
Company  
**TEXACO Inc.**

Date **3/2/66**

I hereby certify that the well location shown on this plat was plotted from field notes of actual surveys made by me or under my supervision, and that the same is true and correct to the best of my knowledge and belief.

Date Surveyed **2/23/66**

Registered Professional Engineer and/or Land Surveyor

J. J. Velten  
Certificate No.

**8174**