

All distances must be from the outer boundaries of the Section

UNION OIL COMPANY OF CALIFORNIA		COWDEN FEDERAL		Well No. 1
K	4	21 SOUTH	29 EAST	EDDY
3147.5	NORTH	1980	WEST	
3445 (Est.)	Strawn	Golden Lane Under	320	

- Outline the acreage dedicated to the subject well by colored pencil or hatchure marks on the plat below.
- If more than one lease is dedicated to the well, outline each and identify the ownership thereof (both as to working interest and royalty).
- If more than one lease of different ownership is dedicated to the well, have the interests of all owners been consolidated by communitization, unitization, force-pooling, etc?

☐ Yes ☐ No If answer is "yes," type of consolidation \_\_\_\_\_

If answer is "no," list the owners and tract descriptions which have actually been consolidated. (Use reverse side of this form if necessary.) \_\_\_\_\_

No allowable will be assigned to the well until all interests have been consolidated (by communitization, unitization, forced-pooling, or otherwise) or until a non-standard unit, eliminating such interests, has been approved by the Commission.

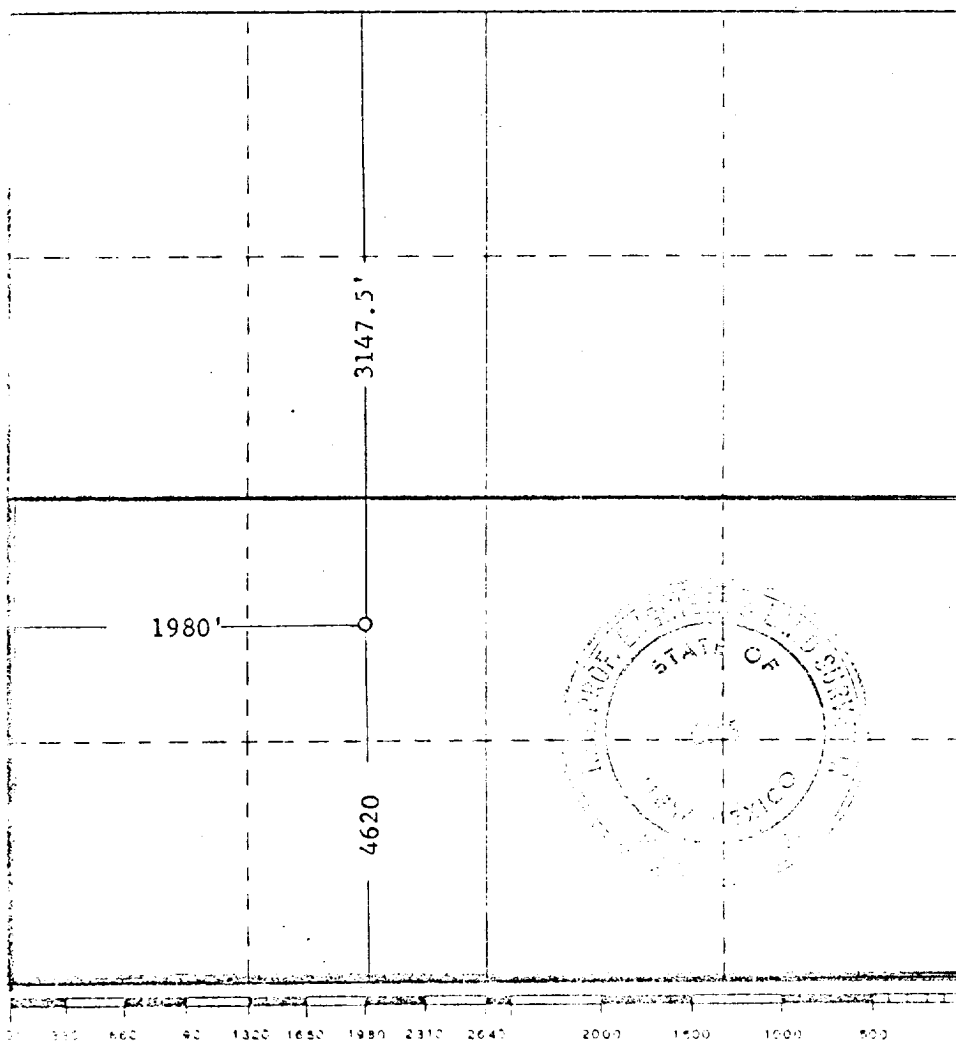

#### CERTIFICATION

I hereby certify that the information contained herein is true and complete to the best of my knowledge and belief.

*J. J. Manning*

Senior Drilling Engineer

Union Oil Company of California

March 6, 1967

I hereby certify that the well location shown on this plat was plotted from field notes of actual survey made by me or under my supervision, and that this line is true and correct to the best of my knowledge and belief.

**RECEIVED**  
OCT 12 1971  
U.S. GEOLOGICAL SURVEY  
ARTESIA, NEW MEXICO

MARCH 4, 1967

*John W. West*