

RECEIVED

NEW MEXICO OIL CONSERVATION COMMISSION
WELL LOCATION AND ACREAGE DEDICATION PLATForm C-102
Supersedes C-128
Effective 1-1-65

MAY 3 1972

All distances must be from the outer boundaries of the Section.

Operator V. H. WESTBROOK		Lease COWDEN FEDERAL		Well No. 1
Unit Letter K	Section 4	Township 21 SOUTH	Range 29 EAST	County EDDY
Actual Footage Location of Well: 3147.5 feet from the NORTH line and 1980 feet from the WEST line				
Ground Level Elev. 3453'	Producing Formation Strawn	Pool Golden Lane Strawn		Dedicated Acreage: 320 Acres

1. Outline the acreage dedicated to the subject well by colored pencil or hachure marks on the plat below.
2. If more than one lease is dedicated to the well, outline each and identify the ownership thereof (both as to working interest and royalty).
3. If more than one lease of different ownership is dedicated to the well, have the interests of all owners been consolidated by communitization, unitization, force-pooling, etc?

☒ Yes ☐ No If answer is "yes," type of consolidation OPERATING AGREEMENT WITH LAWRENCE

C. HARRIS

If answer is "no," list the owners and tract descriptions which have actually been consolidated. (Use reverse side of this form if necessary.)

No allowable will be assigned to the well until all interests have been consolidated (by communitization, unitization, forced-pooling, or otherwise) or until a non-standard unit, eliminating such interests, has been approved by the Commission.

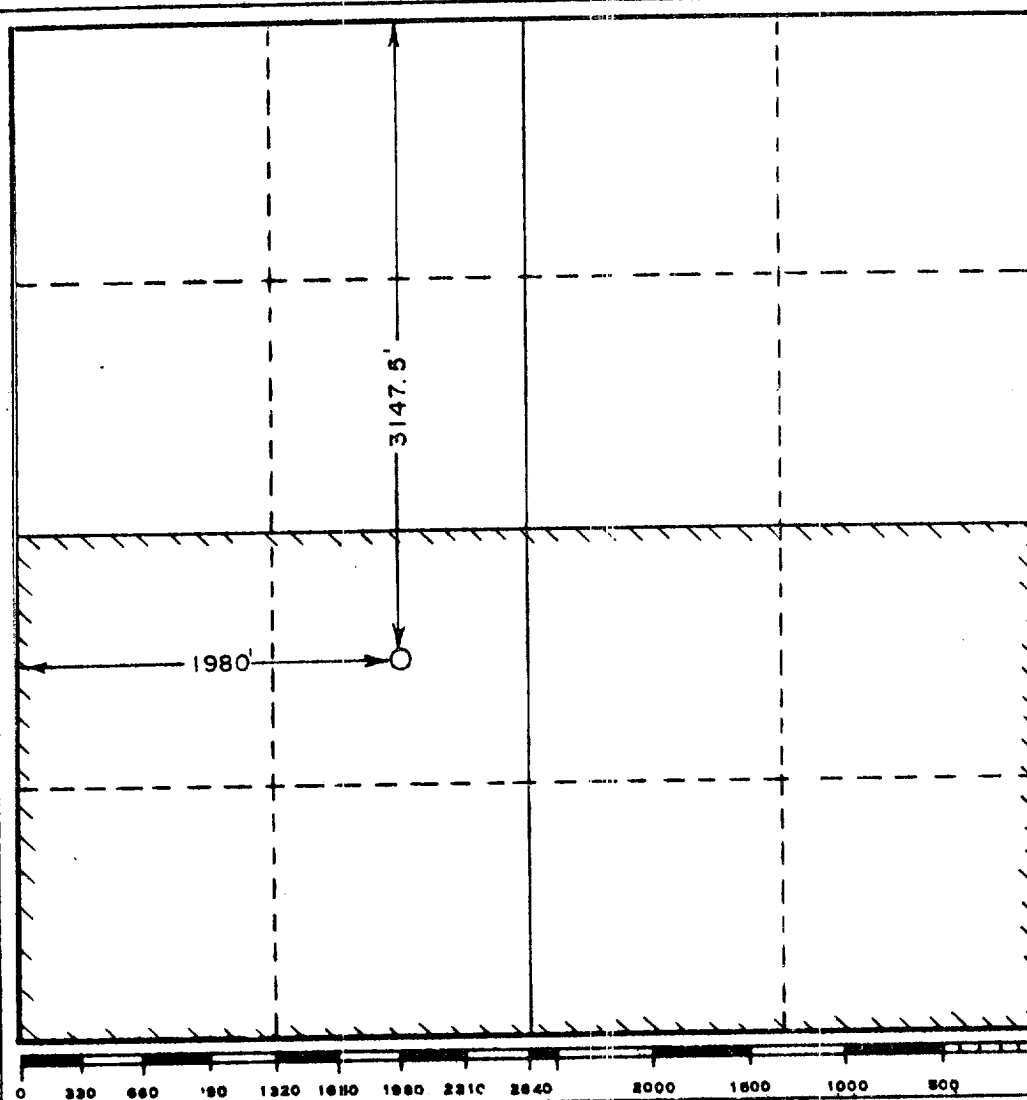

CERTIFICATION

I hereby certify that the information contained herein is true and complete to the best of my knowledge and belief.

V. H. Westbrook
Name

Position

Operator

Company

V. H. Westbrook

Date

5-1-72

I hereby certify that the well location shown on this plat was plotted from field notes of actual surveys made by me or under my supervision, and that the same is true and correct to the best of my knowledge and belief.

Date Surveyed

MARCH 2, 1967

Registered Professional Engineer
and/or Land Surveyor

John W. West

Certificate No.

676