

UNITED STATES
DEPARTMENT OF THE INTERIOR
GEOLOGICAL SURVEY

(Other instruct
reverse side)

Copy

5. LEASE DESIGNATION AND SERIAL NO.

TX-031397-A

6. IF INDIAN, ALLOTTEE OR TRIBE NAME

7. UNIT AGREEMENT NAME

8. FARM OR LEASE NAME

Tex. Pacific "Dr" *Federal*

9. WELL NO.

1

10. FIELD AND POOL, OR WILDCAT

Wildcat

11. SEC., T., R., M., OR BLK.
AND SURVEY OR AREA

14-216-22L 1 MPN

12. COUNTY OR PARISH

Edgy

13. STATE

N. Mex.

APPLICATION FOR PERMIT TO DRILL, DEEPEN, OR PLUG BACK

1a. TYPE OF WORK

DRILL ☒

DEEPEN ☐

PLUG BACK ☐

b. TYPE OF WELL

OIL ☐
WELL ☐

GAS ☐
WELL ☐

OTHER

SINGLE ☐
ZONE ☐

MULTIPLE ☐
ZONE ☐

2. NAME OF OPERATOR

Vitas Petroleum Corporation - H. H. Hilliard

3. ADDRESS OF OPERATOR

1000 Carper Building-Artesia, New Mexico 88210

4. LOCATION OF WELL (Report location clearly and in accordance with any State requirements.)*

At surface

Unit Section II - 1850' - 1860' P.M.
Section 14-216-22L

At proposed prod. zone

14. DISTANCE IN MILES AND DIRECTION FROM NEAREST TOWN OR POST OFFICE*

21 miles Northwest of Carlsbad, New Mexico

15. DISTANCE FROM PROPOSED*

LOCATION TO NEAREST
PROPERTY OR LEASE LINE, FT.
(Also to nearest drlg. unit line, if any)

300 P.M.

16. NO. OF ACRES IN LEASE

17.0

17. NO. OF ACRES ASSIGNED
TO THIS WELL

17.0

18. DISTANCE FROM PROPOSED*

TO NEAREST WELL, DRILLING, COMPLETED,
OR APPLIED FOR, ON THIS LEASE, FT.

Wildcat

19. PROPOSED DEPTH

8000'

20. ROTARY OR CABLE TOOLS

Rotary

21. ELEVATIONS (Show whether DF, RT, GR, etc.)

4139 GL

22. APPROX. DATE WORK WILL START*

Immediately

PROPOSED CASING AND CEMENTING PROGRAM

SIZE OF HOLE	SIZE OF CASING	WEIGHT PER FOOT	SETTING DEPTH	QUANTITY OF CEMENT
17-1/4"	13-5/8"	42#	150'	Circular
12-1/4"	9-5/8"	32#	1000'	Circular

We propose to drill this well to test the Canyon zone to a depth of 8000'.

RECEIVED

MAY 11 1967

*Formerly
Ashmen + Hilliard
#1 T.P. Federal
Amended
Application*

RECEIVED
MAY 12 1967
U. S. GEOLOGICAL SURVEY
ARTESIA, NEW MEXICO

IN ABOVE SPACE DESCRIBE PROPOSED PROGRAM: If proposal is to deepen or plug back, give data on present productive zone and proposed new productive zone. If proposal is to drill or deepen directionally, give pertinent data on subsurface locations and measured and true vertical depths. Give blowout preventer program, if any.

23.

SIGNED

[Signature]

TITLE

Agent

DATE

5-11-67

(This space for Federal or State office use)

PERMIT NO.

APPROVAL DATE

MAY 16 1967

APPROVED BY

[Signature]

TITLE

DISTRICT ENGINEER

DATE

CONDITIONS OF APPROVAL, IF ANY:

*See Instructions On Reverse Side

NE.. MEXICO OIL CONSERVATION COMMISSION
WELL LOCATION AND ACREAGE DEDICATION PLAT

Form C-102
Supersedes C-128
Effective 1-1-65

All distances must be from the outer boundaries of the Section.

Operator Yates Pet. Corp - H. T. Hillard			Lease Texas Pacific "BF" Federal		Well No. 1
Unit Letter H	Section 14	Township 21S	Range 22E	County Eddy	
Actual Footage Location of Well: 1650 feet from the North line and 660 feet from the East line					
Ground Level Elev: 4139	Producing Formation Canyon		Pool Wildcat	Dedicated Acreage: 40 Acres	

1. Outline the acreage dedicated to the subject well by colored pencil or hatchure marks on the plat below.
2. If more than one lease is dedicated to the well, outline each and identify the ownership thereof (both as to working interest and royalty).
3. If more than one lease of different ownership is dedicated to the well, have the interests of all owners been consolidated by communitization, unitization, force-pooling, etc?

☐ Yes ☐ No If answer is "yes," type of consolidation _____

If answer is "no," list the owners and tract descriptions which have actually been consolidated. (Use reverse side of this form if necessary.) _____

No allowable will be assigned to the well until all interests have been consolidated (by communitization, unitization, forced-pooling, or otherwise) or until a non-standard unit, eliminating such interests, has been approved by the Commission.

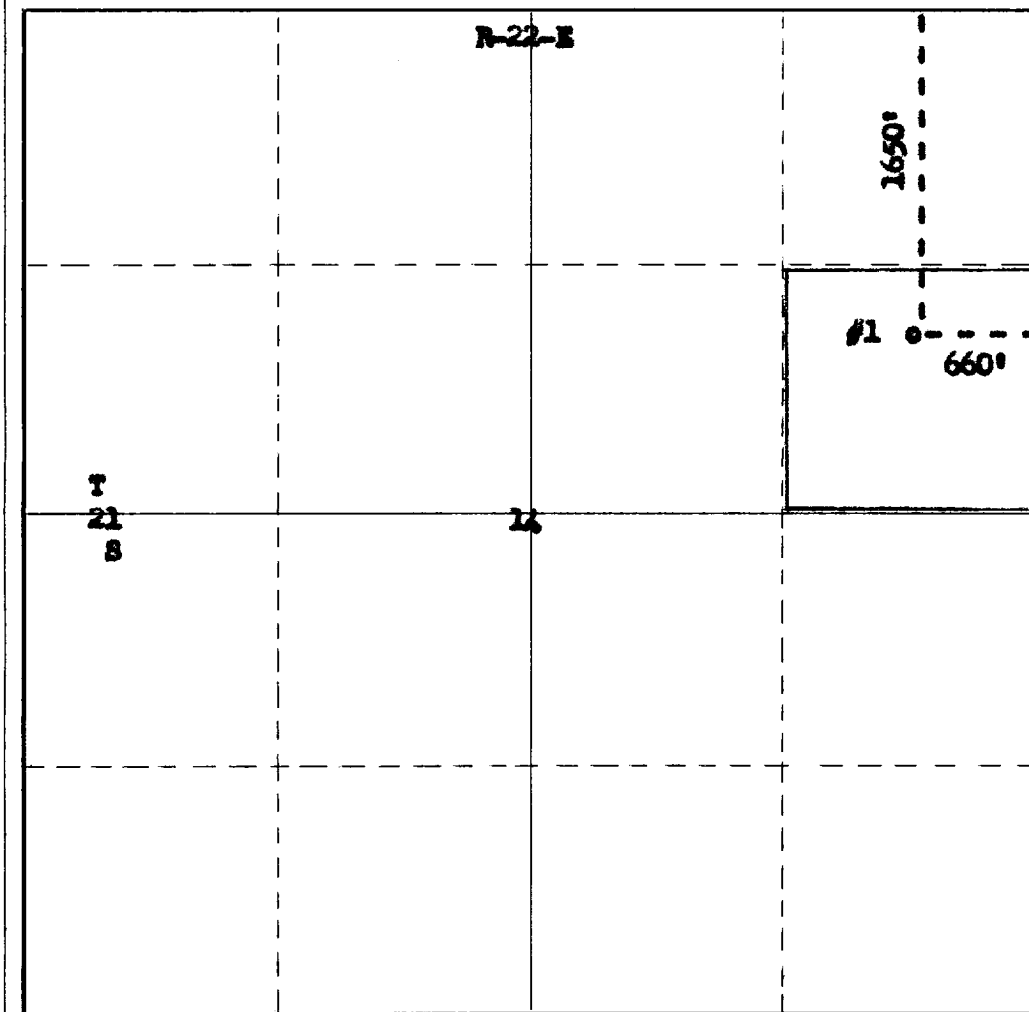

CERTIFICATION

I hereby certify that the information contained herein is true and complete to the best of my knowledge and belief.

Name
Richard C. Norman
Position
Geologist
Company
Yates Pet. Corp
Date
5-11-67

I hereby certify that the well location shown on this plat was based from field notes of actual surveys made by me or under my supervision, and that the same is true and correct to the best of my knowledge and belief.

Date Survey
April 5, 1967
Registered Professional Engineer
and/or Land Surveyor

James H. Brown
Certificate No. **542**

