

**MEXICO OIL CONSERVATION COMMISSION
WELL LOCATION AND ACREAGE DEDICATION PLAT**

Form C-102
Supersedes C-128
Effective 1-1-65

All distances must be from the outer boundaries of the Section.

Operator GETTY OIL COMPANY			Lease WILSON FEDERAL		Well No. 1
Unit Letter H	Section 13	Township 22 SOUTH	Range 24 EAST	County EDDY	
Actual Footage Location of Well: <div style="display: flex; justify-content: space-between;"> 2310 feet from the NORTH line and 990 feet from the EAST line </div>					
Ground Level Elev. 3877.3	Producing Formation Clare Canyon	Pool Wildcat	Dedicated Acreage: 100 Acres		

1. Outline the acreage dedicated to the subject well by colored pencil or hachure marks on the plat below.
2. If more than one lease is dedicated to the well, outline each and identify the ownership thereof (both as to working interest and royalty).
3. If more than one lease of different ownership is dedicated to the well, have the interests of all owners been consolidated by communitization, unitization, force-pooling, etc?

☐ Yes ☐ No If answer is "yes," type of consolidation: _____

NOV 28 1967

O. C. C.

If answer is "no," list the owners and tract descriptions which have actually been consolidated. (Use reverse side of this form if necessary.) _____

No allowable will be assigned to the well until all interests have been consolidated (by communitization, unitization, forced-pooling, or otherwise) or until a non-standard unit, eliminating such interests, has been approved by the Commission.

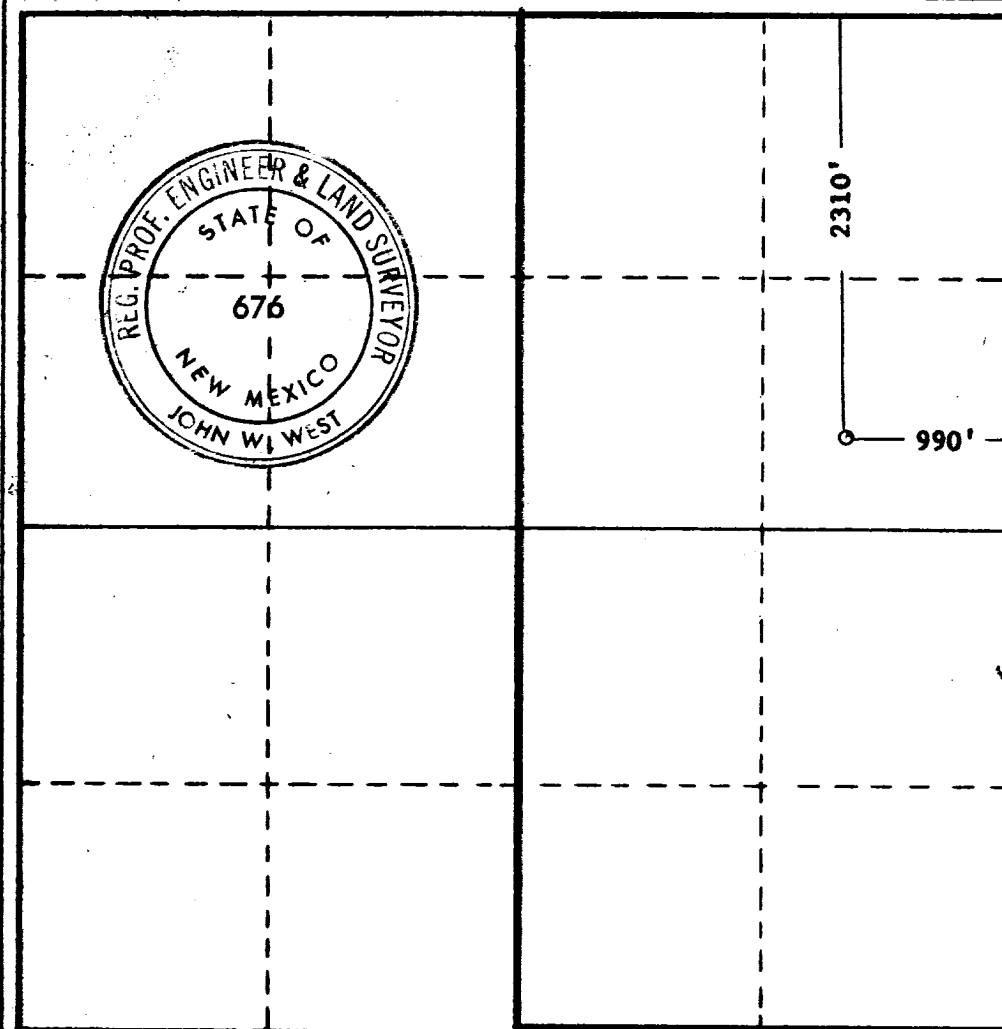

CERTIFICATION

I hereby certify that the information contained herein is true and complete to the best of my knowledge and belief.

C. E. Wade

Name

C. E. Wade

Position

Area Supt.

Company

Getty Oil Company

Date

Nov. 15, 1967

I hereby certify that the well location shown on this plat was determined from field notes of actual survey made by me or under my supervision and that the same is true to the best of my knowledge and belief.

Date Surveyed

OCTOBER 19, 1967

Registered Professional Engineer and/or Land Surveyor

John W. West

Certificate No.

676

0 200 400 600 800 1000 1200 1400 1600 1800 2000 2200 2400