

NEW MEXICO OIL CONSERVATION COMMISSION
WELL LOCATION AND ACREAGE DEDICATION PLAT

RECEIVED
APR 25 1969
Form 102
Supersedes
Effective 1-1-69

All distances must be from the outer boundaries of the Section.

Operator CONTINENTAL OIL COMPANY			Lease LEVERS--FEDERAL		
Unit Letter E	Section 2	Township 21S	Range 25E	County EDDY	
Actual Footage Location of Well: 1594 feet from the North line and 660 feet from the West line					
Ground Level Elev. 3309DF	Producing Formation CISCO CANYON		Pool SPRINGS UPPER PENN		Dedicated Acreage: 296.40 Acres

D. C. C.
ARTESIA, OFFICE
Well No. **1**

1. Outline the acreage dedicated to the subject well by colored pencil or hatchure marks on the plat below.
2. If more than one lease is dedicated to the well, outline each and identify the ownership thereof (both as to working interest and royalty).
3. If more than one lease of different ownership is dedicated to the well, have the interests of all owners been consolidated by communitization, unitization, force-pooling, etc?

☐ Yes ☐ No If answer is "yes," type of consolidation _____

If answer is "no," list the owners and tract descriptions which have actually been consolidated. (Use reverse side of this form if necessary.) _____

No allowable will be assigned to the well until all interests have been consolidated (by communitization, unitization, forced-pooling, or otherwise) or until a non-standard unit, eliminating such interests, has been approved by the Commission.

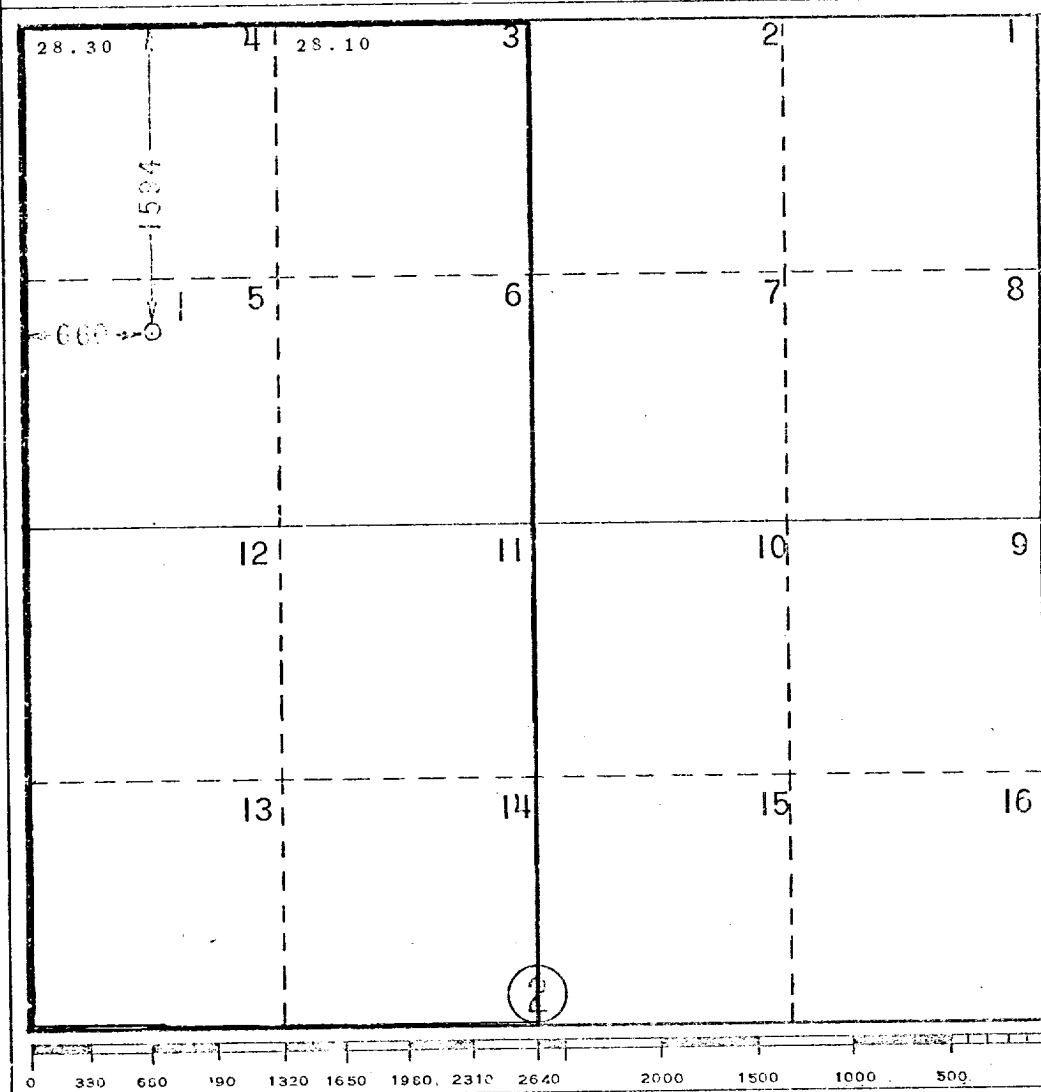

CERTIFICATION

I hereby certify that the information contained herein is true and complete to the best of my knowledge and belief.

Name
M. E. Yeakley
Position
Adm. Sec. Chief
Company
Continental Oil Company
Date
April 24, 1969

I hereby certify that the well location shown on this plat was plotted from field notes of actual surveys made by me or under my supervision, and that the same is true and correct to the best of my knowledge and belief.

Date Surveyed

Registered Professional Engineer and/or Land Surveyor

Certificate No.
