



IN REPLY REFER TO:

UNITED STATES
DEPARTMENT OF THE INTERIOR
GEOLOGICAL SURVEY
P. O. Drawer 1257
Roswell, New Mexico 88201

May 13, 1969

Pennzoil United, Inc.
Post Office Drawer 1200
Midland, Texas 79701

Gentlemen:

Your Notice of Intention to Drill well No. 12 Big Easy Unit in the NE 1/4 sec. 31, T. 20 S., R. 31 E., N.M.P.M., Eddy County, New Mexico, Lease New Mexico 04466, to a depth of 12,000 feet to test the Strawn formation in the Potash Area, is hereby approved.

The copy of the Notice is returned herewith. Please notify the District Engineer, Geological Survey, Post Office Drawer 6, Artesia, New Mexico, 88210 in sufficient time for a representative to witness all cementing operations.

Sincerely yours,

JOHN A. ANDERSON

JOHN A. ANDERSON
Regional Oil and Gas Supervisor

cc:
Washington
Mining Branch (2)
WMOCC-Artesia (2) (w/2 cys Notice)✓
Artesia
Roswell (2)

RECEIVED
MAY 14 1969
G. C. C.
ARTESIA, OFFICE

UNITED STATES
DEPARTMENT OF THE INTERIOR
BUREAU OF LAND MANAGEMENT



RECEIVED
BUREAU OF LAND MANAGEMENT
WASHINGTON, D.C.

UNITED STATES
DEPARTMENT OF THE INTERIOR
GEOLOGICAL SURVEY

APPLICATION FOR PERMIT TO DRILL, DEEPEN, OR PLUG BACK

1a. TYPE OF WORK

DRILL ☒DEEPEN ☐PLUG BACK ☐

b. TYPE OF WELL

OIL
WELL ☒GAS
WELL ☐

OTHER

SINGLE
ZONE ☒MULTIPLE
ZONE ☐

2. NAME OF OPERATOR

Pennzoil United, Inc.

3. ADDRESS OF OPERATOR

P. O. Drawer 1828 - Midland, Texas 79701

4. LOCATION OF WELL (Report location clearly and in accordance with any State requirements.)*

At surface

660 FNL & 660 FWL of Section 21, T-20-S, R-31-E

At proposed prod. zone

Same

14. DISTANCE IN MILES AND DIRECTION FROM NEAREST TOWN OR POST OFFICE*

18 miles SE of Loco Hills, New Mexico

15. DISTANCE FROM PROPOSED*

LOCATION TO NEAREST

PROPERTY OR LEASE LINE, FT.

(Also to nearest drlg. unit line, if any)

660

16. NO. OF ACRES IN LEASE

480

17. NO. OF ACRES ASSIGNED
TO THIS WELL

40

18. DISTANCE FROM PROPOSED LOCATION*

TO NEAREST WELL, DRILLING, COMPLETED,
OR APPLIED FOR, ON THIS LEASE, FT.

1st well

19. PROPOSED DEPTH

12,000' Strawn

20. ROTARY OR CABLE TOOLS

Rotary

21. ELEVATIONS (Show whether DF, RT, GR, etc.)

3530 GL (Est.)

22. APPROX. DATE WORK WILL START*

On approval

23.

PROPOSED CASING AND CEMENTING PROGRAM

SIZE OF HOLE	SIZE OF CASING	WEIGHT PER FOOT	SETTING DEPTH	QUANTITY OF CEMENT
20"	16	65#	750'	750 sx - Circulate *
15"	11 3/4	42#	2,200'	900 sx - " **
11"	8 5/8	32#	4,100'	1200 sx - " ***
7 7/8"	5 1/2"	17# & 20#	11,800'	500 sx

* The 16" casing will be set 100' into the Anhydrite section

** The 11 3/4" casing will be set thru the Salt section

*** The 8 5/8" casing will be set thru the Delaware Sand. A DV tool will be run approximately 2,350' and cement circulated to the surface.

RECEIVED
MAY - 8 1969
U. S. GEOLOGICAL SURVEY
ARTESIA, NEW MEXICO

Operator will comply with New Mexico Oil Conservation Commission Order No. R-111-A

IN ABOVE SPACE DESCRIBE PROPOSED PROGRAM: If proposal is to deepen or plug back, give data on present productive zone and proposed new productive zone. If proposal is to drill or deepen directionally, give pertinent data on subsurface locations and measured and true vertical depths. Give blowout preventer program, if any.

24.

SIGNED

TITLE

Drilling Superintendent

DATE

5-6-69

(This space for Federal or State office use)

PERMIT NO.

APPROVAL DATE

APPROVED BY

TITLE

DATE

CONDITIONS OF APPROVAL, IF ANY:

RECEIVED

*See Instructions On Reverse Side

MAY 14 1969

O. C. C.

Instructions

General: This form is designed for submitting proposals to perform certain well operations, as indicated, on all types of lands and leases for appropriate action by either a Federal or a State agency, or both, pursuant to applicable Federal and/or State laws and regulations. Any necessary special instructions concerning the use of this form and the number of copies to be submitted, particularly with regard to local, area, or regional procedures and practices, either are shown below or will be issued by, or may be obtained from, the local Federal and/or State office.

Item 1: If the proposal is to redrill to the same reservoir at a different subsurface location or to a new reservoir, use this form with appropriate notations. Consult applicable State or Federal regulations concerning subsequent work proposals or reports on the well.

Item 4: If there are no applicable State requirements, locations on Federal or Indian land should be described in accordance with Federal requirements. Consult local State or Federal office for specific instructions.

Item 14: Needed only when location of well cannot readily be found by road from the land or lease description. A plat, or plats, separate or on this reverse side, showing the roads to, and the surveyed location of, the well, and any other required information, should be furnished when required by Federal or State agency offices.

Items 15 and 18: If well is to be, or has been directionally drilled, give distances for subsurface location of hole in any present or objective production zone.

Item 22: Consult applicable Federal or State regulations, or appropriate officials, concerning approval of the proposal before operations are started.

NEW MEXICO OIL CONSERVATION COMMISSION
WELL LOCATION AND ACREAGE DEDICATION PLAT

Form C-102
Supersedes C-128
Effective 1-1-65

All distances must be from the outer boundaries of the Section.

Operator PENNZOIL UNITED, INC.			Lease BIG EDDY UNIT		Well No. 12
Unit Letter D	Section 21	Township 20 SOUTH	Range 31 EAST	County EDDY	
Actual Footage Location of Well: 660 feet from the NORTH line and 660 feet from the WEST line					
Ground Level Elev.	Producing Formation Strawn		Pool Wildcat	Dedicated Acreage: NW/4 NW/4 40 Acres	

1. Outline the acreage dedicated to the subject well by colored pencil or hatchure marks on the plat below.
2. If more than one lease is dedicated to the well, outline each and identify the ownership thereof (both as to working interest and royalty).
3. If more than one lease of different ownership is dedicated to the well, have the interests of all owners been consolidated by communitization, unitization, force-pooling, etc?

☐ Yes ☐ No If answer is "yes," type of consolidation _____

If answer is "no," list the owners and tract descriptions which have actually been consolidated. (Use reverse side of this form if necessary.) _____

No allowable will be assigned to the well until all interests have been consolidated (by communitization, unitization, forced-pooling, or otherwise) or until a non-standard unit, eliminating such interests, has been approved by the Commission.

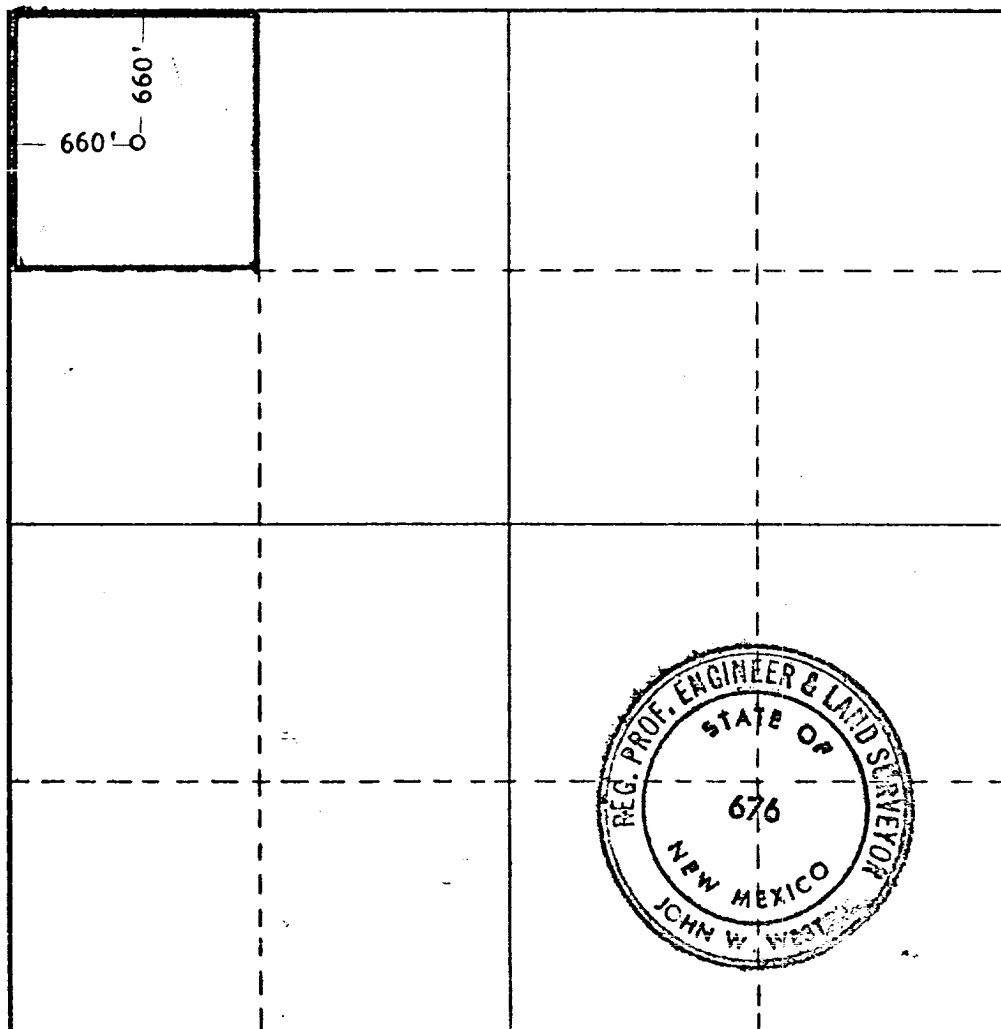

CERTIFICATION

I hereby certify that the information contained herein is true and complete to the best of my knowledge and belief.

Name: *John W. West*
Position: **Drilling Superintendent**
Company: **Pennzoil United, Inc.**
Date: **May 6, 1969**

RECEIVED
MAY 13 1969
I hereby certify that the well location shown on this plat was plotted from field notes of actual surveys made by me or under my supervision, and that the same is true and correct to the best of my knowledge and belief.

Date Surveyed
MAY 7, 1969

Registered Professional Engineer
and/or Land Surveyor

John W. West
Certificate No. **676**

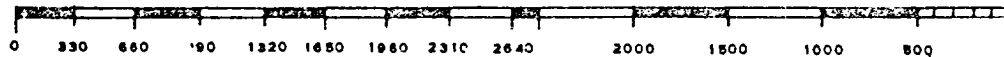

N. M. O. C. C. 000

 **PENNZOIL UNITED, Inc.**

WESTERN DIVISION OFFICE • WALL TOWERS WEST - MIDLAND, TEXAS • PHONE (915) 682-7316

MAILING ADDRESS: P. O. DRAWER 1828

MIDLAND, TEXAS 79701

April 15, 1969

U. S. Potash & Chemical Co.
Box 101
Carlsbad, New Mexico 88220

Attention: Mr. Earl H. Miller

Re: Stetco '69 #3
BIG EDDY UNIT
Eddy County, New Mexico

Gentlemen:

Reference is made to our recent telephone conversation regarding our proposed 11,700' Strawn test located in the NW/4 NW/4 of Section 21, T-20-S, R-31-E, Eddy County, New Mexico.

It is our understanding that you are the holder of potash leases within one mile of the above noted well and we respectfully request that you furnish us a waiver for the drilling of this well, insofar as your above noted leases are concerned, by signing and returning two copies of this letter.

Your assistance in this regard will be very much appreciated and please advise in the event that we might furnish any further information.

Very truly yours,

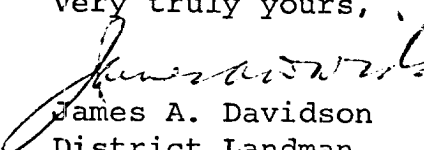
James A. Davidson
District Landman

JAD/mlm

RECEIVED
MAY - 8 1969
U. S. GEOLOGICAL SURVEY
ARTESIA, NEW MEXICO

As holder of potash leases within one mile of the proposed well, the undersigned has no objection to the drilling of above referenced well, provided all drilling is done in accordance with the New Mexico Oil Conservation Commission's Order R-111-A.

U.S. POTASH & CHEMICAL CO.

By: Earl H. Miller
Title: Executive Vice President
Date: April 15, 1969

L

169
3-1

DESIGNATION OF OPERATOR

The undersigned is, on the records of the Bureau of Land Management, holder of lease

DISTRICT LAND OFFICE: Santa Fe, New Mexico
SERIAL No.: NM-04082

and hereby designates

NAME: Pennzoil United, Inc.
ADDRESS: 1007 Midland Savings Building
Midland, Texas 79701

as his operator and local agent, with full authority to act in his behalf in complying with the terms of the lease and regulations applicable thereto and on whom the supervisor or his representative may serve written or oral instructions in securing compliance with the Operating Regulations with respect to (describe acreage to which this designation is applicable):

Township 20 South, Range 31 East, N.M.P.M., Eddy County
Section 21: $W\frac{1}{2}$, $W\frac{1}{2}E\frac{1}{2}$

It is understood that this designation of operator does not relieve the lessee of responsibility for compliance with the terms of the lease and the Operating Regulations. It is also understood that this designation of operator does not constitute an assignment of any interest in the lease.

In case of default on the part of the designated operator, the lessee will make full and prompt compliance with all regulations, lease terms, or orders of the Secretary of the Interior or his representative.

The lessee agrees promptly to notify the supervisor of any change in the designated operator.

Attest:

Marguerite Wright
Secretary

RICHARDSON OILS, INC.

By: E. W. Sampson
President

March 10, 1969

(Date)

Perry R. Bates
PERRY R. BATES

U. S. GOVERNMENT PRINTING OFFICE 16-53508-3

1211 Fort Worth National Bank Bldg.
Fort Worth, Texas 76102

RECEIVED
MAY - 8 1969
U. S. REGIONAL SURVEY
REGIONAL OIL AND GAS
REGIONAL MINING

169
3-1

DESIGNATION OF AGENT

Supervisor, Oil and Gas Operations:

The undersigned is, on the records of the Geological Survey, Unit Operator under the Big Eddy Unit Agreement, Eddy County, New Mexico (state), No. 14-08-001-326 approved October 1, 1952 and hereby designates:

NAME: Pennzoil United, Inc.

ADDRESS: 1007 Midland Savings Building
Midland, Texas 79701

as its agent, with full authority to act in its behalf in complying with the terms of the Unit Agreement and regulations applicable thereto, and on whom the supervisor or his representative may serve written or oral instructions in securing compliance with the Oil and Gas Operating Regulations with respect to drilling, testing and completing Unit Well No. 12, in the NW 1/4 NW 1/4 Sec. 21, T-20S, R-31E, N.M.P.M. Eddy County, New Mexico.

It is understood that this Designation of Agent does not relieve the Unit Operator of responsibility for compliance with the terms of the Unit Agreement and the Oil and Gas Operating Regulations. It is also understood that this Designation of Agent does not constitute an assignment of any interest under the Unit Agreement or any lease committed thereto.

In case of default on the part of the designated agent, the Unit Operator will make full and prompt compliance with all regulations, lease terms, or orders of the Secretary of the Interior or his representative.

The Unit Operator agrees promptly to notify the Oil and Gas Supervisor of any change in the designated agent.

This Designation of Agent is deemed to be temporary and in no manner a permanent arrangement.

This Designation is given only to enable the agent herein designated to drill the above specified Unit Well. Unless sooner terminated, this Designation shall terminate when there is filed in the appropriate district office of the U. S. Geological Survey a completed file of all required Federal reports pertaining to subject well. It is also understood that this Designation of Agent is limited to field operations and does not cover administrative action requiring specific authorization of the Unit Operator.

PERRY R. BASS

Unit Operator

March 10, 1969

By 

RECEIVED
MAY-8 1969
U. S. GEOLOGICAL SURVEY
WASHINGTON, D. C.
NEW MEXICO