

NO. OF COPIES RECEIVED 6  
 DISTRIBUTION  
 SANTA FE 1  
 FILE 1  
 U.S.G.S. 2  
 LAND OFFICE 1  
 OPERATOR 1

NEW MEXICO OIL CONSERVATION COMMISSION

Form C-101  
Revised 1-1-65

5A. Indicate Type of Lease  
 STATE ☒ FEE ☐  
 5. State Oil & Gas Lease No.  
**K-6460**

APPLICATION FOR PERMIT TO DRILL, DEEPEN, OR PLUG BACK

1a. Type of Work  
 b. Type of Well DRILL ☒ DEEPEN ☐ PLUG BACK ☐  
 OIL WELL ☐ GAS WELL ☒ OTHER ☐ SINGLE ZONE ☐ MULTIPLE ZONE ☐  
 2. Name of Operator  
**Cities Service Oil Company**  
 3. Address of Operator  
**Box 69 - Hobbs, New Mexico 88240**  
 4. Location of Well  
 UNIT LETTER J LOCATED 1650 FEET FROM THE South LINE  
 AND 1650 FEET FROM THE East LINE OF SEC. 36 TWP. 22S RGE. 24E NMPM  
 7. Unit Agreement Name  
 8. Farm or Lease Name  
**State CN Corn**  
 9. Well No.  
1  
 10. Field and Pool, or Wildcat  
**Rock Tank Morrow**  
 12. County  
**Eddy**  
 19. Proposed Depth  
10,400  
 19A. Formation  
**Morrow**  
 20. Rotary or C.T.  
**Rotary**  
 21. Elevations (Show whether DF, RT, etc.)  
**3883 GR (Est.)**  
 21A. Kind & Status Plug. Bond  
**Required-Approved**  
 21B. Drilling Contractor  
**Not released**  
 22. Approx. Date Work will start  
**April 1, 1971**

PROPOSED CASING AND CEMENT PROGRAM

* SIZE OF HOLE	SIZE OF CASING	WEIGHT PER FOOT	SETTING DEPTH	SACKS OF CEMENT	EST. TOP
11 1/2"	8 5/8"	24#	2500	Circulate	G.L.
8 3/4"	5 1/2"	17#	10400	400 sacks	8400

It is proposed to drill to a T.D. of 10,400 and test the Morrow formation. The blowout prevention program is as follows:

1. One set blind rams.
2. One set drill pipe rams.
3. One hydrill.
4. One rotating head.

\* One joint of 13 3/8" OD conductor pipe will be set and cemented as surface pipe.

AT NO TIME VALID  
 FOR 30 DAYS UNLESS  
 DRILLING COMMENCED,  
 EXPIRES 6-26-71

IN ABOVE SPACE DESCRIBE PROPOSED PROGRAM: IF PROPOSAL IS TO DEEPEN OR PLUG BACK, GIVE DATA ON PRESENT PRODUCTIVE ZONE AND PROPOSED NEW PRODUCTIVE ZONE. GIVE BLOWOUT PREVENTER PROGRAM, IF ANY.

I hereby certify that the information above is true and complete to the best of my knowledge and belief.

Signed E. J. Claffey Title **District Engineer** Date **3-23-71**

(This space for State Use)

APPROVED BY W. A. Gussitt TITLE **OIL AND GAS INSPECTOR** DATE **MAR 26 1971**

CONDITIONS OF APPROVAL, IF ANY:

Cement will be circulated to  
 surface behind 5 7/8" casing

Notify N.M.O.C. in sufficient  
 time to allow for cementing  
 the 5 7/8" casing

**N. MEXICO OIL CONSERVATION COMMISSION  
WELL LOCATION AND ACREAGE DEDICATION PLAT**

Form C-102  
Supersedes C-128  
Effective 1-1-65

All distances must be from the outer boundaries of the Section.

Operator <b>CITIES SERVICE OIL COMPANY</b>			Lease <b>STATE CN <i>Com</i></b>		Well No. <b>1</b>
Unit Letter <b>J</b>	Section <b>36</b>	Township <b>22 SOUTH</b>	Range <b>24 EAST</b>	County <b>EDDY</b>	
Actual Footage Location of Well: <b>1650</b> feet from the <b>SOUTH</b> line and <b>1650</b> feet from the <b>EAST</b> line					
Ground Level Elev. <b>3882.7</b>	Producing Formation <b>Morrow</b>	Pool <i>under</i> <b>Rock Tank Morrow</b>	Dedicated Acreage: <b>640</b> Acres		

1. Outline the acreage dedicated to the subject well by colored pencil or hatchure marks on the plat below.
2. If more than one lease is dedicated to the well, outline each and identify the ownership thereof (both as to working interest and royalty).
3. If more than one lease of different ownership is dedicated to the well, have the interests of all owners been consolidated by communitization, unitization, force-pooling, etc?

☒ Yes    ☐ No    If answer is "yes," type of consolidation *11-2-70 Unitization Communitization*

If answer is "no," list the owners and tract descriptions which have actually been consolidated. (Use reverse side of this form if necessary.) \_\_\_\_\_

No allowable will be assigned to the well until all interests have been consolidated (by communitization, unitization, forced-pooling, or otherwise) or until a non-standard unit, eliminating such interests, has been approved by the Commission.

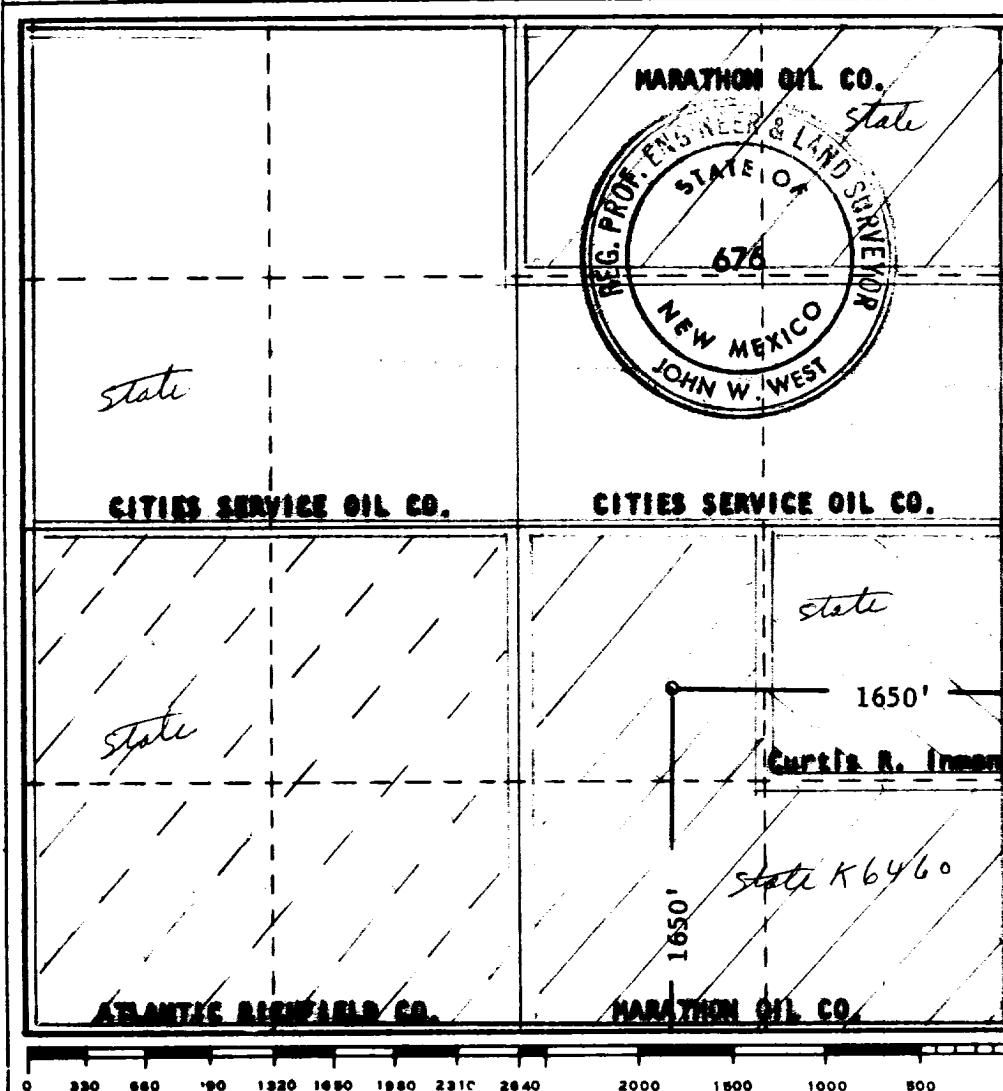

**CERTIFICATION**

I hereby certify that the information contained herein is true and complete to the best of my knowledge and belief.

Name *John W. West*  
Position **District Engineer**  
Company **Cities Service Oil Company**  
Date **March 23, 1971**

I hereby certify that the well location shown on this plat was plotted from field notes of actual surveys made by me or under my supervision, and that the same is true and correct to the best of my knowledge and belief.

Date Surveyed **3-17-1971**  
Registered Professional Engineer and/or Land Surveyor  
*John W. West*  
Certificate No. **676**