

UNITED STATES
DEPARTMENT OF THE INTERIOR
GEOLOGICAL SURVEY

SUBMIT IN TRIPLICATE
(Other instructions on
reverse side.)

Form approved.
Bureau No. 42-B-61

30-115-20409

5. LEASE DESIGNATION AND
NM 029580

6. IF INDIAN, ALLOTTEE OR S. S.

7. UNIT AGREEMENT NAME

8. FARM OR LEASE NAME

HARRIS FEDER

9. WELL NO.

1-Y

10. FIELD AND POOL, OR WILDCAT

WILDCAT

11. SEC., T., R., M., OR BLK.
AND SURVEY OR AREA

SEC. 5-T21S-R29

12. COUNTY OR PARISH 13 STATE

EDDY

APPLICATION FOR PERMIT TO DRILL, DEEPEN, OR PLUG BACK

1a. TYPE OF WORK

DRILL ☒

DEEPEN ☐

PLUG BACK ☐

b. TYPE OF WELL

WELL ☒

GAS WELL ☐

OTHER

SINGLE ZONE ☒

MULTIPLE ZONE ☐

2. NAME OF OPERATOR

L. C. HARRIS

3. ADDRESS OF OPERATOR

P. O. Box 1714, ROSWELL, NEW MEXICO, 88201

4. LOCATION OF WELL (Report location clearly and in accordance with any State requirements.)
At surface

2233' FSL & 2310' FEL

At proposed prod. zone

14. DISTANCE IN MILES AND DIRECTION FROM NEAREST TOWN OR POST OFFICE*

20 MILES SOUTH OF LOCO HILLS

15. DISTANCE FROM PROPOSED*
LOCATION TO NEAREST
PROPERTY OR LEASE LINE, FT.
(Also to nearest drlg. unit line, if any)

18. DISTANCE FROM PROPOSED LOCATION*
TO NEAREST WELL, DRILLING, COMPLETED,
OR APPLIED FOR, ON THIS LEASE, FT.

2000'

16. NO. OF ACRES IN LEASE

1841.52

17. NO. OF ACRES ASSIGNED
TO THIS WELL

40

19. PROPOSED DEPTH

1900'

20. ROTARY OR CABLE TOOLS

CABLE TOOLS

21. ELEVATIONS (Show whether DF, RT, GR, etc.)

3520' G. L.

22. APPROX. DATE WORK WILL START*

MARCH 27, 1971

23. PROPOSED CASING AND CEMENTING PROGRAM

SIZE OF HOLE	SIZE OF CASING	WEIGHT PER FOOT	SETTING DEPTH	QUANTITY OF CEMENT
16"	13-3/8"	30 LB.	250'	150 SX
13-2/8"	10"	27 LB.	650'	50 SX
8"	4-1/2"	11.5 LB.	1900'	150 SX

WILL DRILL TO 1900' TO TEST THE YATES, TANSILL REEF FORMATION.

TEST WILL BE DRILLED WITH CABLE TOOLS.

CORTEZ DRILLING COMPANY, Box 848, ROSWELL, NEW MEXICO, IS THE CONTRACTOR.

RECEIVED

RECEIVED

APR - 2 1971

U. S. GEOLOGICAL SURVEY
ARTESIA, NEW MEXICO

IN ABOVE SPACE DESCRIBE PROPOSED PROGRAM: If proposal is to deepen or plug back, give data on present productive zone and proposed new productive zone. If proposal is to drill or deepen directionally, give pertinent data on subsurface locations and measured and true vertical depths. Give blowout preventer program, if any.

24. SIGNED John J. McColl TITLE AGENT DATE 3/27/71

(This space for Federal or State office use)

PERMIT NO.

APPROVAL DATE

APPROVED BY
CONDITIONS OF APPROVAL, IF ANY

DATE

THIS APPROVAL IS RESCINDED INSPECTION
ARE NOT COMMENCED WITHIN 3 MONTHS.
EXPIRES
JUN 27 1971
*See Instructions On Reverse Side

NEW MEXICO OIL CONSERVATION COMMISSION
WELL LOCATION AND ACREAGE DEDICATION PLAT

Form C-102
Supersedes C-100
Effective 1-1-65

All distances must be from the outer boundaries of the Section.

Operator L. C. HARRIS		Lease HARRIS FEDERAL		Well No. 1-Y	
Unit Letter J	Section 4	Township 21-SOUTH	Range 29-EAST	County EDDY	
Actual Footage Location of Well: 2233 feet from the SOUTH line and 2310 feet from the EAST line					
Ground Level Elev. 3520	Producing Formation YATES--TANSILL		Pool WILDCAT		Dedicated Acreage: 40 Acres

1. Outline the acreage dedicated to the subject well by colored pencil or hatchure marks on the plat below.
2. If more than one lease is dedicated to the well, outline each and identify the ownership thereof (both as to working interest and royalty).
3. If more than one lease of different ownership is dedicated to the well, have the interests of all owners been consolidated by communitization, unitization, force-pooling, etc?

☐ Yes ☐ No If answer is "yes," type of consolidation _____

If answer is "no," list the owners and tract descriptions which have actually been consolidated. (Use reverse side of this form if necessary.) _____

No allowable will be assigned to the well until all interests have been consolidated (by communitization, unitization, forced-pooling, or otherwise) or until a non-standard unit, eliminating such interests, has been approved by the Commission.

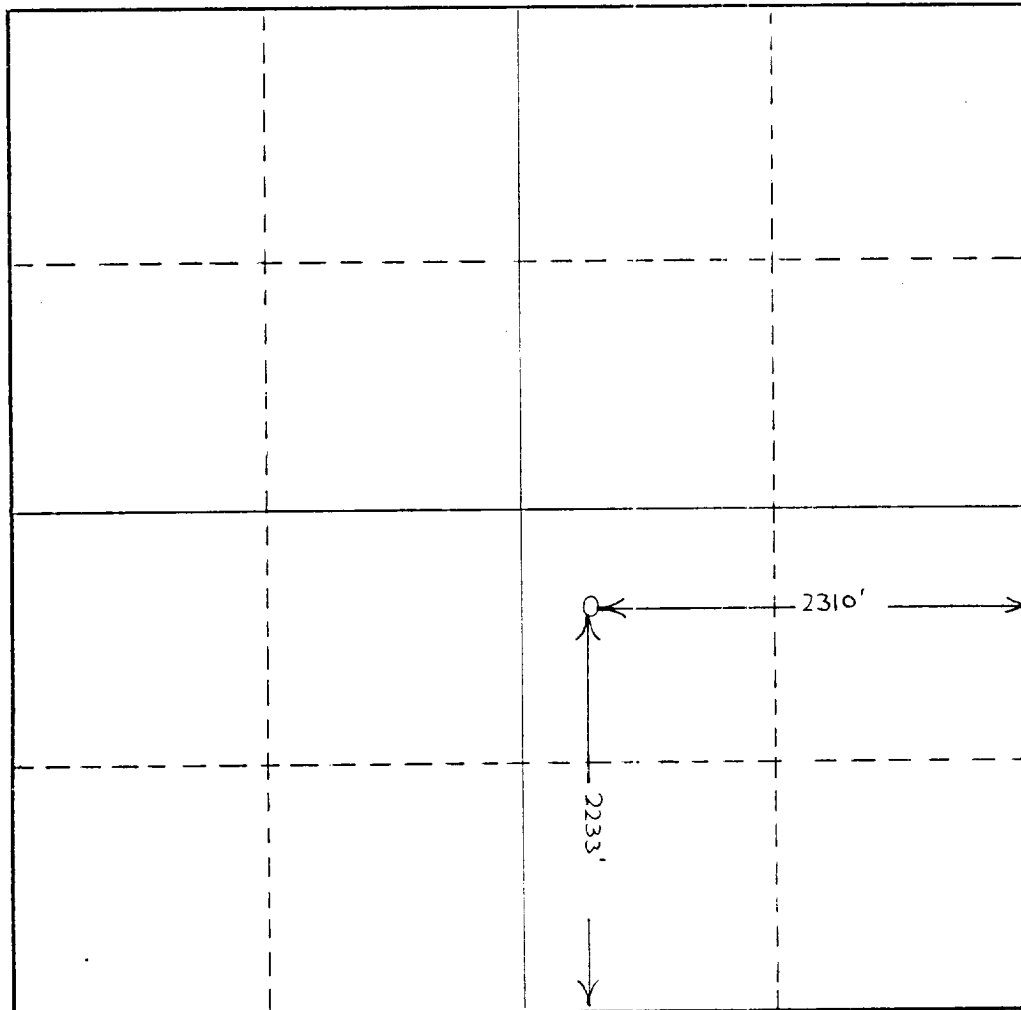

CERTIFICATION

I hereby certify that the information contained herein is true and complete to the best of my knowledge and belief.

Name
JACK L. McCLELLAN

Position
AGENT

Company
L. C. HARRIS

Date
3/27/71

I hereby certify that the well location shown on this plat is the result of field notes of actual surveys made by me or under my supervision, and that the same is true and correct to the best of my knowledge and belief.

RECEIVED
APR - 2 1971
U. S. GEOLOGICAL SURVEY
ARTESIA, NEW MEXICO

Date Surveyed

Registered Professional Engineer and/or Land Surveyor

Certificate No.

0 330 660 990 1320 1650 1980 2310 2640 2000 1500 1000 500 0