

NEW MEXICO OIL CONSERVATION COMMISSION
WELL LOCATION AND ACREAGE DEDICATION PLAT

Form C-102
Supersedes C-128
Effective 1-1-65

All distances must be from the outer boundaries of the Section.

Operator TEXAS OIL & GAS CO.			Lease LOWE FEDERAL		Well No. 1
Unit Letter F	Section 23	Township 22 SOUTH	Range 23 EAST	County EDDY	
Actual Footage Location of Well: 1650 feet from the NORTH line and 2310 feet from the WEST line					
Ground Level Elev. 4105.9	Producing Formation Penn	Pool Indian Basin		Dedicated Acreage: 640 Acres	

1. Outline the acreage dedicated to the subject well by colored pencil or hachure marks on the plat below.
2. If more than one lease is dedicated to the well, outline each and identify the ownership thereof (both as to working interest and royalty).
3. If more than one lease of different ownership is dedicated to the well, have the interests of all owners been consolidated by communitization, unitization, force-pooling, etc?

☐ Yes ☐ No If answer is "yes," type of consolidation _____

If answer is "no," list the owners and tract descriptions which have actually been consolidated. (Use reverse side of this form if necessary.) _____

No allowable will be assigned to the well until all interests have been consolidated (by communitization, unitization, forced-pooling, or otherwise) or until a non-standard unit, eliminating such interests, has been approved by the Commission.

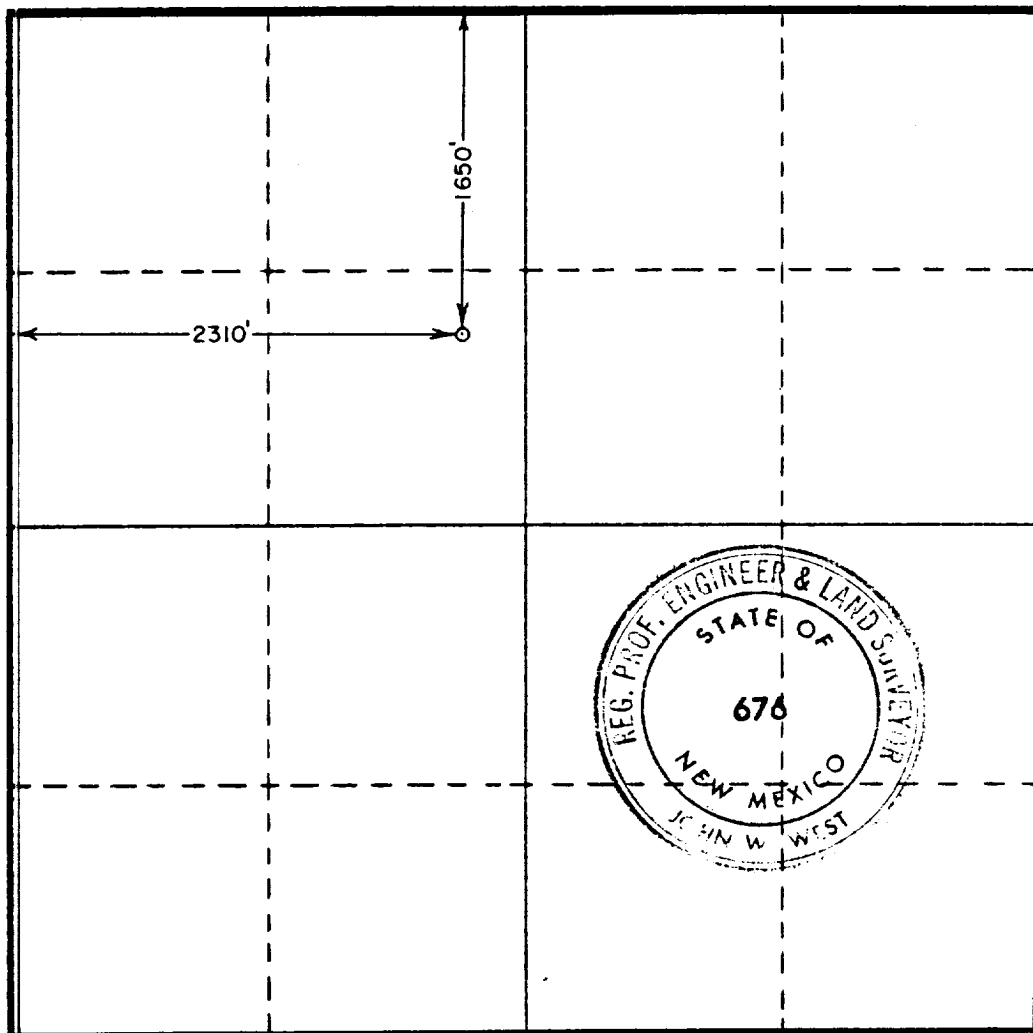

CERTIFICATION

I hereby certify that the information contained herein is true and complete to the best of my knowledge and belief.

Name Joe Colter
Position Petroleum Engineer
Company Texas Oil & Gas Corp.
Date February 8, 1972

I hereby **RECEIVED** that the well location shown on this plat was made by me or notes of actual surveys made by me or under my supervision, and the same is true and correct to the best of my knowledge. **FEB 9 1972**
U.S. GEOLOGICAL SURVEY
ARTERIA, NEW MEXICO

Date Surveyed DECEMBER 28, 1971
Registered Professional Engineer and/or Land Surveyor
John W. West
Certificate No. **676**

