

UNITED STATES
DEPARTMENT OF THE INTERIOR
GEOLOGICAL SURVEY

SUBMIT IN DUPLICATE
(Other instructions on reverse side)

Form approved.
Budget Bureau No. 42-R1425.

RECEIVED
MAY 26 1972
30-015-20651

5. LEASE DESIGNATION AND SERIAL NO.

NM-0265356-A

6. IF INDIAN, ALLOTTEE OR TRIBE NAME

7. UNIT AGREEMENT NAME

8. FARM OR LEASE NAME

North Carlsbad

9. WELL NO.

1

10. FIELD AND POOL, OR WILDCAT

Wildcat

11. SEC., T., R., M., OR BLK.
AND SURVEY OR AREA

Sec. 22-21S-26E

12. COUNTY OR PARISH
Eddy

13. STATE
N.M.

1a. TYPE OF WORK

DRILL ☒

DEEPEN ☐

PLUG BACK ☐

b. TYPE OF WELL

OIL WELL ☒

GAS WELL ☐

OTHER

SINGLE ZONE ☐

MULTIPLE ZONE ☐

2. NAME OF OPERATOR

Hanagan Petroleum Corporation

3. ADDRESS OF OPERATOR

P. O. Box 1737, Roswell, New Mexico 88201

4. LOCATION OF WELL (Report location clearly and in accordance with any State requirements.)*

At surface 330' FSL & 330' FEL

At proposed prod. zone Same

14. DISTANCE IN MILES AND DIRECTION FROM NEAREST TOWN OR POST OFFICE*

2 miles north of Carlsbad, New Mexico

10. DISTANCE FROM PROPOSED*

LOCATION TO NEAREST PROPERTY OR LEASE LINE, FT.
(Also to nearest drig. unit line, if any) 330'

16. NO. OF ACRES IN LEASE

960

17. NO. OF ACRES ASSIGNED TO THIS WELL

40

18. DISTANCE FROM PROPOSED LOCATION* TO NEAREST WELL, DRILLING, COMPLETED, OR APPLIED FOR, ON THIS LEASE, FT.

None

19. PROPOSED DEPTH

700'

20. ROTARY OR CABLE TOOLS

Cable Tools

21. ELEVATIONS (Show whether DF, RT, GR, etc.)

3150' 3330' GR

22. APPROX. DATE WORK WILL START*

5/25/72

PROPOSED CASING AND CEMENTING PROGRAM

SIZE OF HOLE	SIZE OF CASING	WEIGHT PER FOOT	SETTING DEPTH	QUANTITY OF CEMENT
17 1/2"	13-3/8"	54#	30'	Cement circulated
10"	4-1/2"	11.6#	700'	100 sx.

Propose to spud with rat hole machine and set 13-3/8" conductor casing. Cable tools will drill the remaining hole. Propose to test Tansill Reef, Yates and Capitan Reef. Propose TD in Capitan Reef or water in Capitan Reef.

RECEIVED

MAY 16 1972

U.S. GEOLOGICAL SURVEY
ARTESIA, NEW MEXICO

IN ABOVE SPACE DESCRIBE PROPOSED PROGRAM: If proposal is to deepen or plug back, give data on present productive zone and proposed new productive zone. If proposal is to drill or deepen directionally, give pertinent data on subsurface locations and measured and true vertical depths. Give blowout preventer program, if any.

24.

SIGNED

[Signature]

TITLE

President

DATE

5/16/72

(This space for Federal or State office use)

PERMIT NO.

APPROVAL DATE

DISTRICT ENGINEER

APPROVED BY

[Signature]

TITLE

DATE

MAY 25 1972

CONDITIONS OF APPROVAL, IF ANY:

DECLARED WATER BASIN

CEMENT BEHIND THE CASING MUST BE CIRCULATED

*See Instructions On Reverse Side

CASING

NEW MEXICO OIL CONSERVATION COMMISSION
WELL LOCATION AND ACREAGE DEDICATION PLAT

RECEIVED

Form C-102
Supersedes C-128
Effective 1-1-65
MAY 26 1972

All distances must be from the outer boundaries of the Section.

Operator Hanagan Petroleum Corporation		Lease North Carlsbad		O.C. No. AS-101A, OFFICE	
Unit Letter P	Section 22	Township 21 South	Range 26 East	County Eddy	
Actual Footage Location of Well: 330 feet from the South line and 330 feet from the East line					
Ground Level Elev. 3330 GR	Producing Formation Capitan Reef		Pool Wildcat	Dedicated Acreage: 40 Acres	

1. Outline the acreage dedicated to the subject well by colored pencil or hachure marks on the plat below.
2. If more than one lease is dedicated to the well, outline each and identify the ownership thereof (both as to working interest and royalty).
3. If more than one lease of different ownership is dedicated to the well, have the interests of all owners been consolidated by communitization, unitization, force-pooling, etc?

☐ Yes ☐ No If answer is "yes," type of consolidation _____

If answer is "no," list the owners and tract descriptions which have actually been consolidated. (Use reverse side of this form if necessary.) _____

No allowable will be assigned to the well until all interests have been consolidated (by communitization, unitization, forced-pooling, or otherwise) or until a non-standard unit, eliminating such interests, has been approved by the Commission.

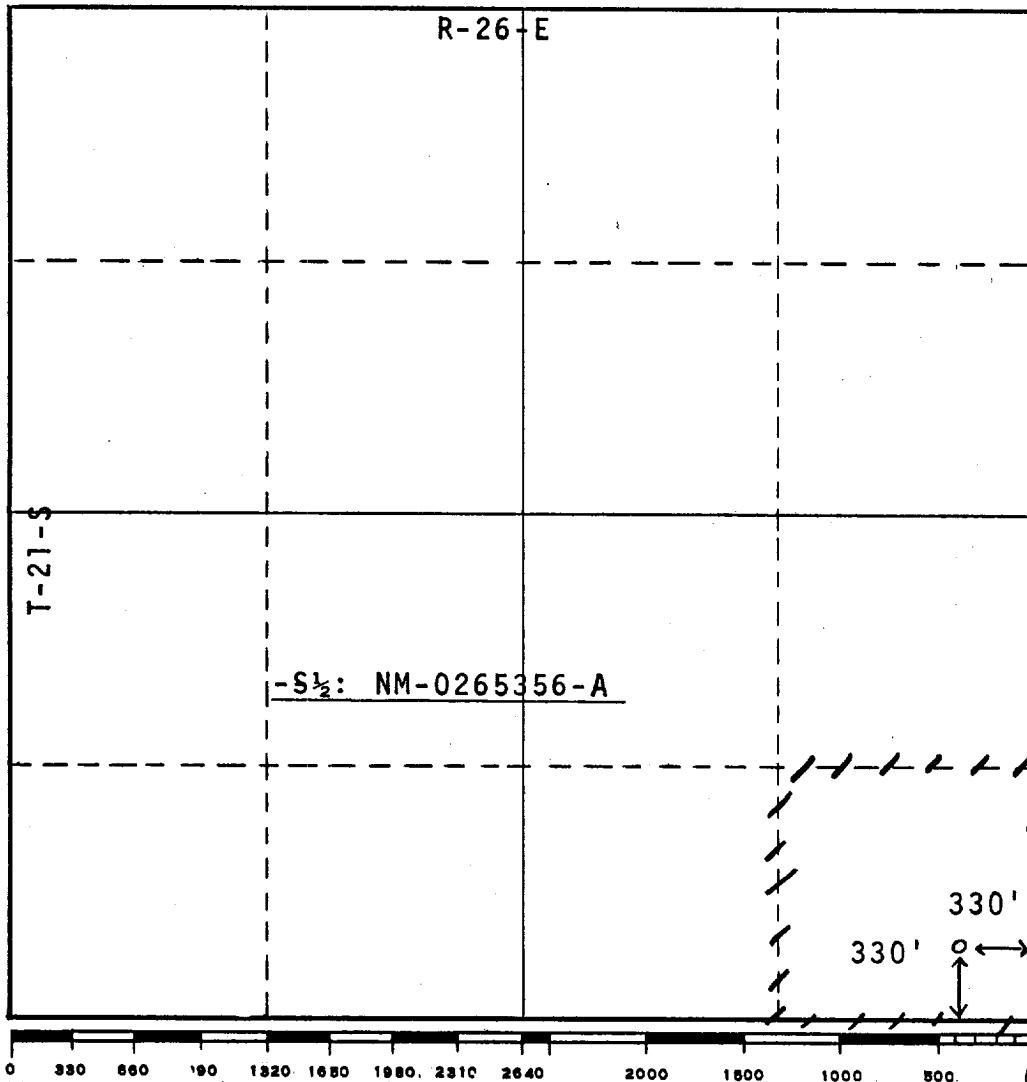

CERTIFICATION

I hereby certify that the information contained herein is true and complete to the best of my knowledge and belief.

Robert G. Hanagan
Name

Robert G. Hanagan

Position

President

Company

Hanagan Petroleum Corp.

Date

5/16/72

RECEIVED
I hereby certify that the well location shown on this plat and from field notes of actual surveys made by me or under my supervision and that the same is true and correct to the best of my knowledge and belief.

James H. Brown
JAMES H. BROWN
LUMBER

Date Surveyed

May 13th 1972

Registered Professional Engineer and/or Land Surveyor

James H. Brown

Certificate No.

542