

MEXICO OIL CONSERVATION COMMISSION
WELL LOCATION AND ACREAGE DEDICATION PLAT

RECEIVED

Supersedees C-128
Effective 1-1-65

NOV 6 1972

All distances must be from the outer boundaries of the Section.

Operator CITIES SERVICE OIL CO.			Lease CRAWLEY "A" O. C. C.		Well No. 1
Unit Letter K	Section 28	Township 21 SOUTH	Range 27 EAST	County ARTESIA, OFFICE	
Actual Footage Location of Well: 1980 feet from the SOUTH line and 1980 feet from the WEST line					
Ground Level Elev. 3200 Est.	Producing Formation Morrow		Pool Undesignated	Dedicated Acreage: 320 Acres	

1. Outline the acreage dedicated to the subject well by colored pencil or hachure marks on the plat below.
2. If more than one lease is dedicated to the well, outline each and identify the ownership thereof (both as to working interest and royalty).
3. If more than one lease of different ownership is dedicated to the well, have the interests of all owners been consolidated by communitization, unitization, force-pooling, etc?

☒ Yes ☐ No If answer is "yes," type of consolidation Unitization & Force-Pooling (Hearing on October 17, 1972)

If answer is "no," list the owners and tract descriptions which have actually been consolidated. (Use reverse side of this form if necessary.)

No allowable will be assigned to the well until all interests have been consolidated (by communitization, unitization, forced-pooling, or otherwise) or until a non-standard unit, eliminating such interests, has been approved by the Commission.

Unit Block consists of 4959.0115 Acres
Working Interest of participating Companies in the proposed well are as follows:

Cities Service Oil Co.	38.10179%
Midwest Oil Corp.	23.28178%
Amarillo Oil	17.46134%
Flag-Redfern Oil	17.46134%
Champlin Petroleum	1.79091%
Patoil Corp.	1.79091%
J. Hiram Moore et al Trustee	.11193%

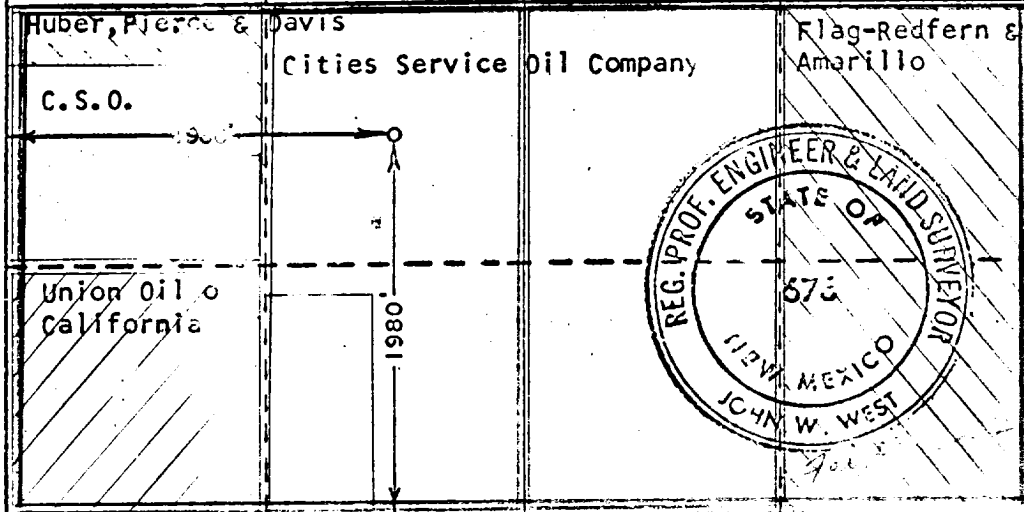

CERTIFICATION

I hereby certify that the information contained herein is true and complete to the best of my knowledge and belief.

Name E. Field

Position
District Manager

Company
Cities Service Oil Company

Date
November 3, 1972

I hereby certify that the well location shown on this plat was plotted from field notes of actual surveys made by me or under my supervision, and that the same is true and correct to the best of my knowledge and belief.

Date Surveyed
OCTOBER 1, 1972
Registered Professional Engineer and/or Land Surveyor

John W. West
Certificate No. 676