



United States Department of the Interior

GEOLOGICAL SURVEY

RECEIVED

NOV 15 1972

P. O. Drawer 1957
Roswell, New Mexico 88201

D. C. C.
ARTESIA, OFFICE

November 14, 1972

Meadco Properties, Ltd.
407 West Wall Street
Midland, Texas 79701

Gentlemen:

Your Notice of Intention to Drill well No. 1-Harris Bell in the SE 1/4 sec. 5, T. 21 S., R. 29 E., N.M.P.M., Eddy County, New Mexico, lease New Mexico 0553014, to a depth of 12,700 feet to test the Pennsylvanian formation in the Potash Area, is hereby approved.

One copy of the Notice is returned herewith. Please notify the District Engineer, Geological Survey, Post Office Drawer U, Artesia, New Mexico, 88210, in sufficient time for a representative to witness all cementing operations. The office phone number is Area Code 505-746-4341.

Sincerely yours,

CARL C. TRAYWICK
Acting Oil and Gas Supervisor

Attachment

cc:

Washington

Mining Branch (2)

✓ RMOC-~~Artesia~~ (2) (w/2 cys Notice)

Artesia (w/cy Notice)

Roswell (2) (w/cy Notice)

RECEIVED

NOV - 1973

D.C.C.
FEDERAL BUREAU OF INVESTIGATION

UNITED STATES
DEPARTMENT OF THE INTERIOR
GEOLOGICAL SURVEY

30-015-20766

5. LEASE DESIGNATION AND SERIAL NO.
NM-0558014 & NM-029588
6. IF INDIAN, ALLOTTEE OR TRIBE NAME
--
7. UNIT AGREEMENT NAME
--
8. FARM OR LEASE NAME
Harris-Bell
9. WELL NO.
1
10. FIELD AND POOL, OR WILDCAT
Golden Lane Field
11. SEC., T., R., M., OR BLK. AND SURVEY OR AREA
Sec. 5-21S-29E
12. COUNTY OR PARISH
Eddy
13. STATE
N.M.

APPLICATION FOR PERMIT TO DRILL, DEEPEN, OR PLUG BACK

1a. TYPE OF WORK

DRILL ☒DEEPEN ☐PLUG BACK ☐

b. TYPE OF WELL

OIL
WELL ☐GAS
WELL ☒

OTHER

SINGLE
WELL ☒MULTIPLE
WELL ☐

2. NAME OF OPERATOR

Meadco Properties, Ltd.

3. ADDRESS OF OPERATOR

407 West Wall St., Midland, Texas 79701

4. LOCATION OF WELL (Report location clearly and in accordance with any State requirements.)

At surface

660' FEL, 1980' FNL, Sec. 5, T-21-S, R-29-E, Eddy County, N.M.

At proposed prod. zone

Same as above

14. DISTANCE IN MILES AND DIRECTION FROM NEAREST TOWN OR POST OFFICE*

14 miles NE of Carlsbad, N.M.

15. DISTANCE FROM PROPOSED*

LOCATION TO NEAREST
PROPERTY OR LEASE LINE, FT.

(Also to nearest drlg. line, if any)

660'

16. NO. OF ACRES IN LEASE

902

17. NO. OF ACRES ASSIGNED
TO THIS WELL

320

18. DISTANCE FROM PROPOSED LOCATION*

TO NEAREST WELL, DRILLING, COMPLETED,
OR APPLIED FOR, ON THIS LEASE, FT.

first well

19. PROPOSED DEPTH

12,700'

20. ROTARY OR CABLE TOOLS

Rotary

21. ELEVATIONS (Show whether DF, RT, GR, etc.)

22. APPROX. DATE WORK WILL START*

23.

PROPOSED CASING AND CEMENTING PROGRAM

SIZE OF HOLE	SIZE OF CASING	WEIGHT PER FOOT	SETTING DEPTH	QUANTITY OF CEMENT
17-1/2"	13-3/8"	48#	625'	650 sacks - circulate
12-1/4"	8-5/8"	24#, 28# & 32#	4,000'	1700 sacks - Circulate
7-7/8"	5-1/2"	17# & 20#	12,700'	350 sacks

13-3/8" casing to be cemented with 500 sacks Halliburton Lite cement with 1/4#/sack Flocele, 5#/sack Gilsonite and 2% Calcium Chloride plus 150 sacks Class "H" cement with 1/4#/sack Flocele and 2% Calcium Chloride. This is sufficient cement to circulate.

8-5/8" casing to be cemented with 1500 sacks Halliburton Lite cement with 1/4# Flocele per sack, 5#/sack Gilsonite and 2% Calcium Chloride plus 200 sacks Class "C" cement with 1/4#/sack Flocele and 2% Calcium Chloride.

5-1/2" casing to be cemented with 350 sacks Class "H" cement with 3/4% CFR-2 and 8#/sack salt.

Mud Program: 0-625' Native mud
625'-TD 10# brine with starch as needed.

IN ABOVE SPACE DESCRIBE PROPOSED PROGRAM: If proposal is to deepen or plug back, give data on present productive zone and proposed productive zone. If proposal is to drill or deepen directionally, give pertinent data on subsurface locations and measured and true vertical depths. Give blowout preventer program, if any.

24.

SIGNED Franklin A. Wise TITLE Petroleum Engineer DATE _____

(This space for Federal or State office use)

PERMIT NO. _____

APPROVAL DATE _____

APPROVED BY _____

TITLE _____

DATE _____

CONDITIONS OF APPROVAL, IF ANY:

*See Instructions On Reverse Side

U. S. GEOLOGICAL SURVEY
ARTESIA, NEW MEXICO

**MEXICO OIL CONSERVATION COMMISSION
WELL LOCATION AND ACREAGE DEDICATION PLAT**

Form C-102
Supersedes C-128
Effective 1-1-65

All distances must be from the outer boundaries of the Section.

Operator MEADCO PROPERTIES, LTD.			Lease HARRIS-BELL		Well No. 1
Unit Letter H	Section 5	Township 21 SOUTH	Range 29 EAST	County EDDY	
Actual Footage Location of Well: 1980 feet from the NORTH line and 660 feet from the EAST line					
Ground Level Elev. 3459.0	Producing Formation Pennsylvanian	Pool Golden Lane Strawn (Gas)	Dedicated Acreage: 320 311.16 Acres		

1. Outline the acreage dedicated to the subject well by colored pencil or hachure marks on the plat below.
2. If more than one lease is dedicated to the well, outline each and identify the ownership thereof (both as to working interest and royalty).
3. If more than one lease of different ownership is dedicated to the well, have the interests of all owners been consolidated by communitization, unitization, force-pooling, etc?

☒ Yes ☐ No If answer is "yes," type of consolidation Communitization papers being circulated at this time.

If answer is "no," list the owners and tract descriptions which have actually been consolidated. (Use reverse side of this form if necessary.) _____

No allowable will be assigned to the well until all interests have been consolidated (by communitization, unitization, forced-pooling, or otherwise) or until a non-standard unit, eliminating such interests, has been approved by the Commission.

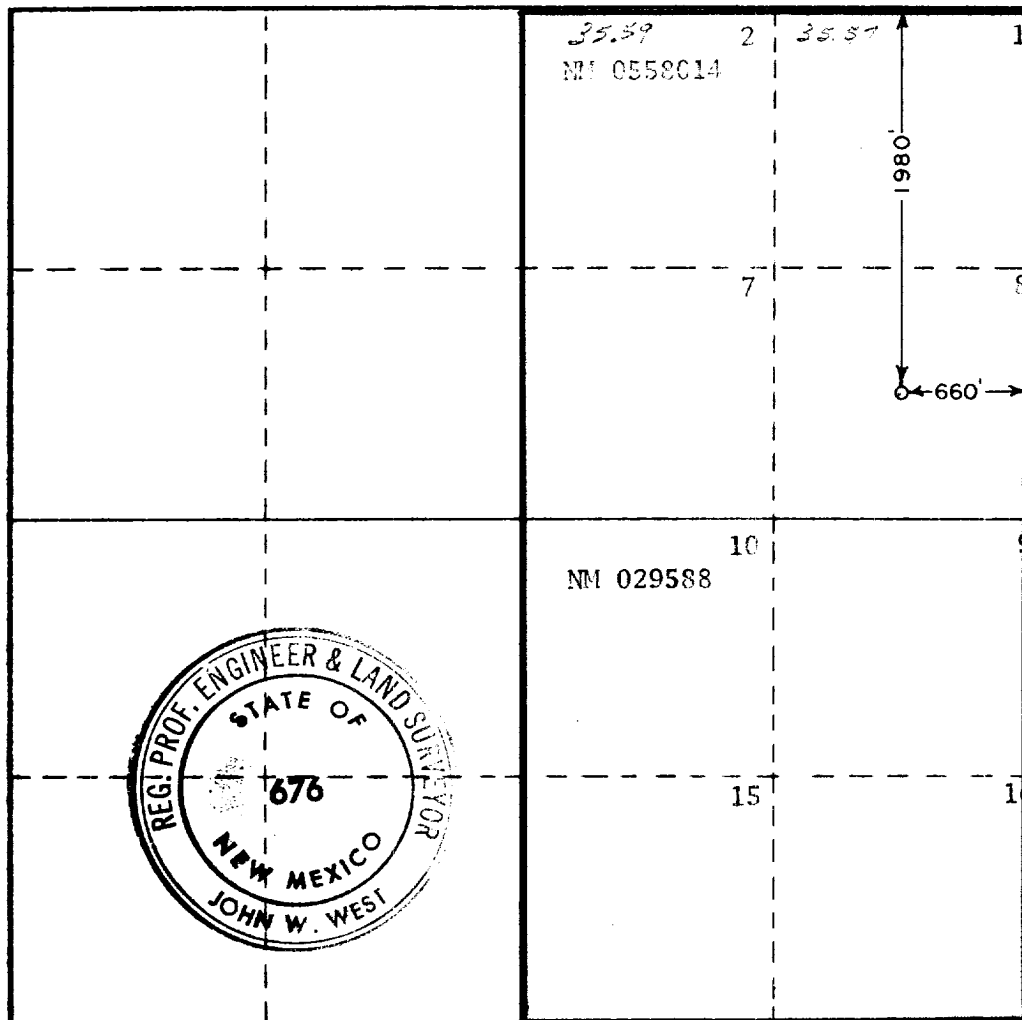

CERTIFICATION

I hereby certify that the information contained herein is true and complete to the best of my knowledge and belief.

Bill C. Cotner

Name **Bill C. Cotner**

Position **Owner**

Company **Meadco Properties, Ltd.**

Date **11/6/72**

I hereby certify that the well location shown on this plat was obtained from field notes of actual surveys made by me or under my supervision, and that the same is true and correct to the best of my knowledge and belief.

Date Surveyed

NOVEMBER 2, 1972

Registered Professional Engineer and/or Land Surveyor

John W. West

Certificate No.

676

0 200 400 600 800 1000 1200 1400 1600 1800 2000 2200 2400 2600 2800 3000

MEADCO PROPERTIES

407 WEST WALL STREET
MIDLAND, TEXAS 79701

682-5671

October 30, 1972

United States Geological Survey
Drawer "U"
Artesia, New Mexico 88210

Dear Sirs:

Re: Application to drill for Meadco Properties #1
Harris-Bell Well in Section 5, T-21-S, R-29-E, Eddy County,
New Mexico, the following supplemental information is submitted:

1. Water for drilling to be hauled in by Commercial water hauler.
2. Waste disposal: Junk iron and trash to be hauled to nearest trash dump for disposal.
3. Produced brine to be disposed of in surface pits, same as other wells in this area.
4. Casing head and/or gas well gas to be sold for best contract price to gas transmission company.

Yours very truly,

MEADCO PROPERTIES

Franklin A. Wise
Franklin A. Wise
Petroleum Engineer

RECEIVED
NOV 7 1972
U. S. GEOLOGICAL SURVEY
ARTESIA, NEW MEXICO

FAW/mr

Rig Plat & Pit Layout
Moran Rig #3
Meadco Properties, Ltd.
Harris Bell #1
660/E 1980/N Section 5-21-29
Eddy County, New Mexico

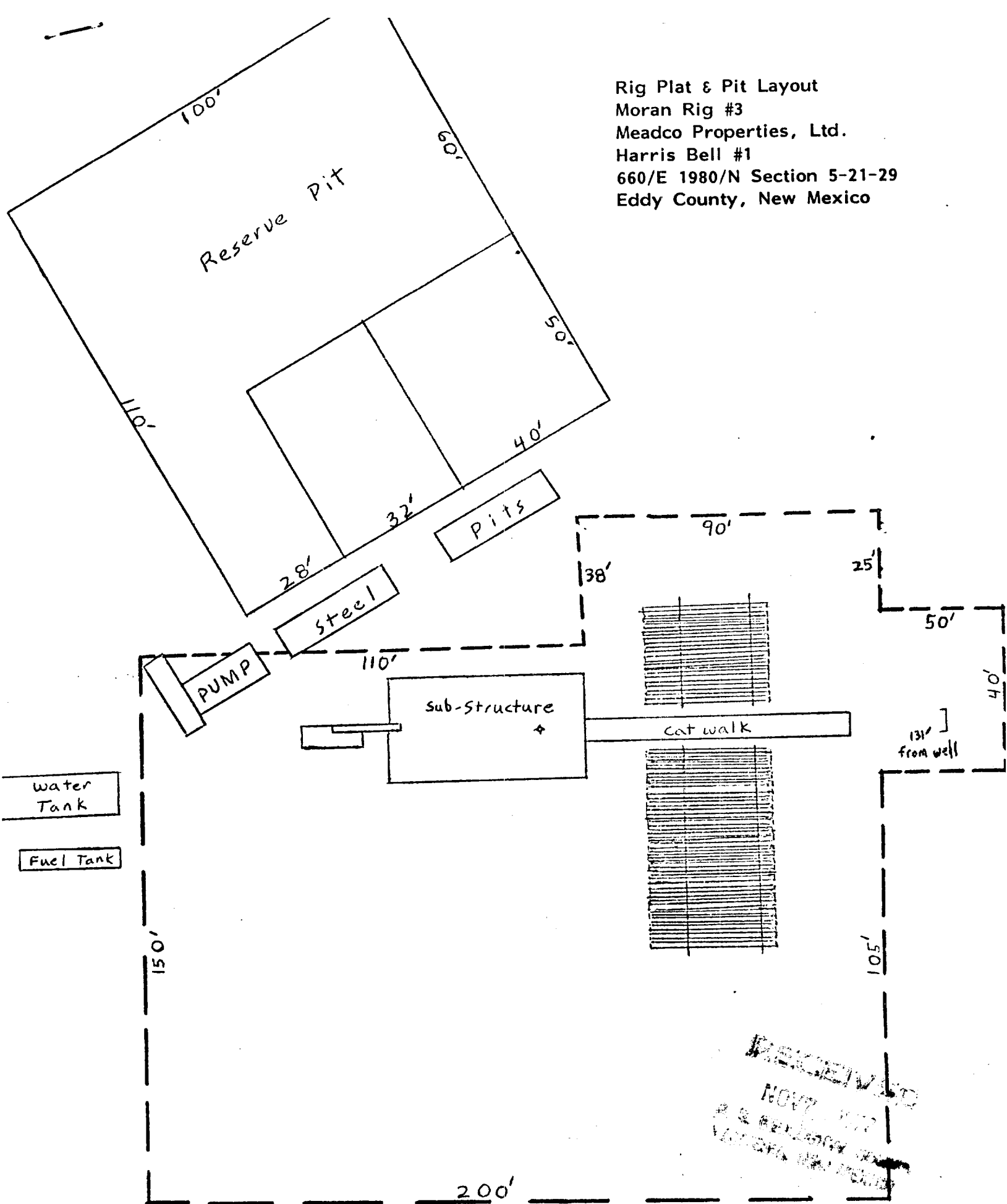

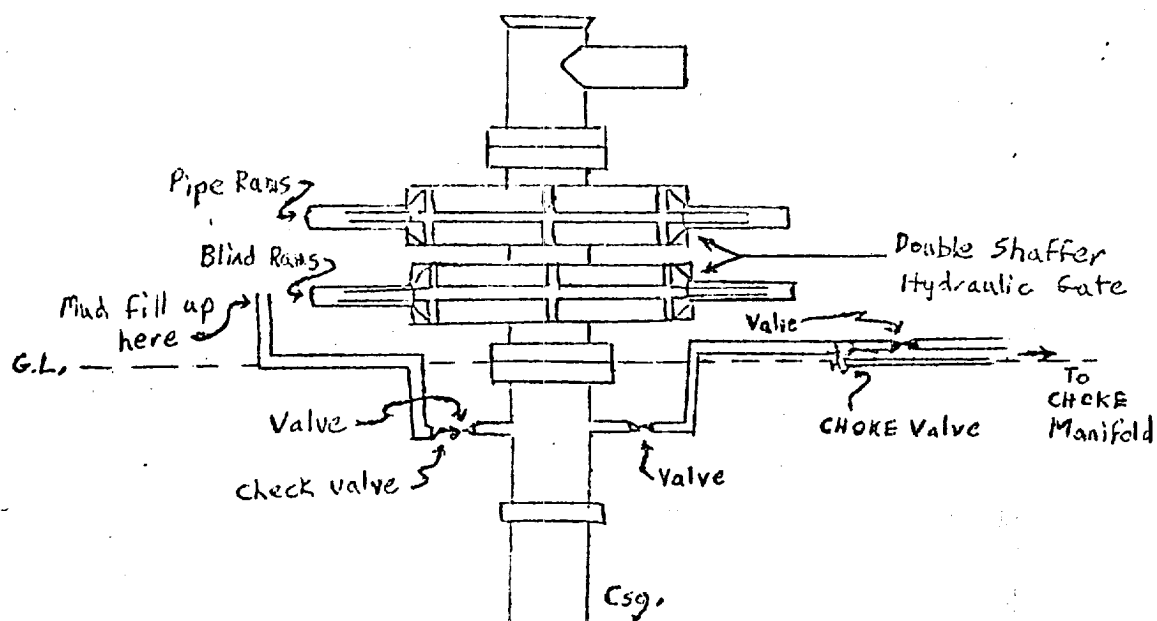
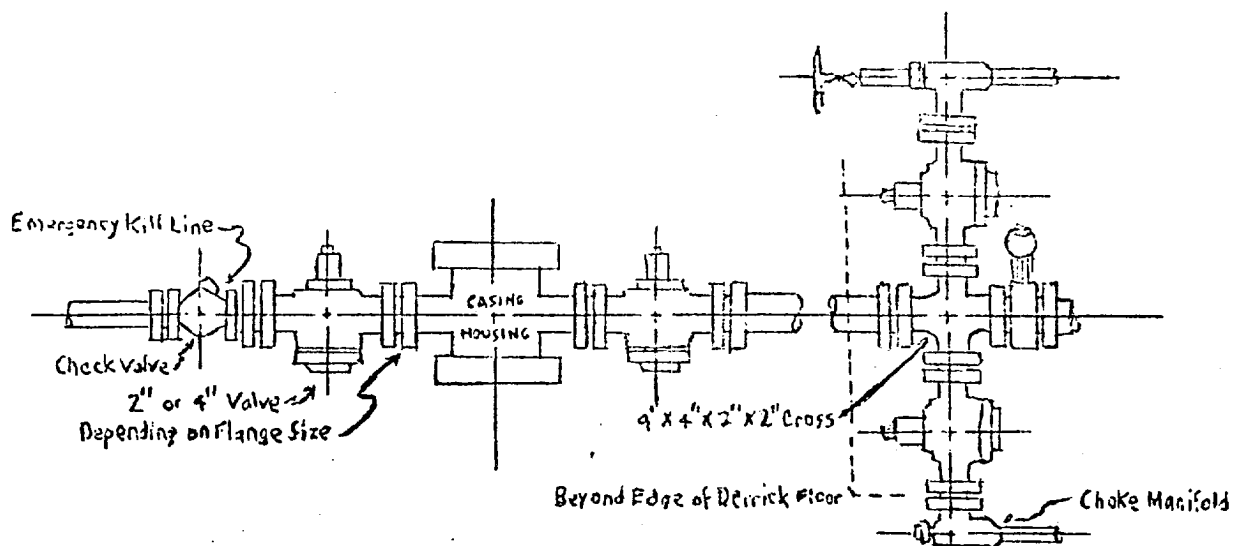

Blowout Preventor - 1500 Series
 Moran Rig #3
 Meadco Properties, Ltd.
 Harris Bell #1
 660/E 1980/N Section 5-21-29
 Eddy County, New Mexico

RECEIVED
 1980
 10/15/80
 10/15/80

RECEIVED

DESIGNATION OF OPERATOR

NOV 10 1972

O. C. C.
ARTESIA, OFFICE

The undersigned is, on the records of the Bureau of Land Management, holder of lease

DISTRICT LAND OFFICE: New Mexico
SERIAL No.: NM 0558014

and hereby designates

NAME: Meadco Properties, Ltd.
ADDRESS: 407 West Wall St.
its Midland, Texas 79701

as ~~its~~ operator and local agent, with full authority to act in ~~its~~ ^{its} behalf in complying with the terms of the lease and regulations applicable thereto and on whom the supervisor or ~~its~~ representative may serve written or oral instructions in securing compliance with the Operating Regulations with respect to (describe acreage to which this designation is applicable):

Township 21 South, Range 29 East, N.M.P.M.
Section 5: Lots 1 thru 8, incl.
Section 6: Lots 1 thru 8, incl.
Eddy County, New Mexico

It is understood that this designation of operator does not relieve the lessee of responsibility for compliance with the terms of the lease and the Operating Regulations. It is also understood that this designation of operator does not constitute an assignment of any interest in the lease.

In case of default on the part of the designated operator, the lessee will make full and prompt compliance with all regulations, lease terms, or orders of the Secretary of the Interior or his representative.

The lessee agrees promptly to notify the supervisor of any change in the designated operator.

BELL PETROLEUM COMPANY

By: 

(Signature of lessee)

16633 Ventura Boulevard, Suite 700
Encino, California 91316

11/3/72

(Date)

(Address)

RECEIVED

NOV 15 1972

ARTESIA, OFFICE