

MEXICO OIL CONSERVATION COMMISSION
WELL LOCATION AND ACREAGE DEDICATION PLAT

Form No. 1
Superseded by
Form No. 2

All distances must be from the outer boundaries of the Section

Operator TXO Production Corp.			Lessee City of Carlsbad		Well No. 1
Plot Letter 0	Section 12	Township 22 South	Range 26 East	County Eddy	
Actual Footage Location of Well: 660 feet from the south line and 1980 feet from the east line					
Ground Level Elev. 3749.4	Producing Formation Morrow		Foot S. Carlsbad, South Morrow	Dedicated Acreage 320	

1. Outline the acreage dedicated to the subject well by colored pencil or hatchure marks on the plat below.
 2. If more than one lease is dedicated to the well, outline each and identify the ownership thereof (both as to working interest and royalty).
 3. If more than one lease of different ownership is dedicated to the well, have the interests of all owners been consolidated by communitization, unitization, force-pooling, etc? **O. C. D.**
- ☒ Yes ☐ No If answer is "yes," type of consolidation **FORCE POOLING**

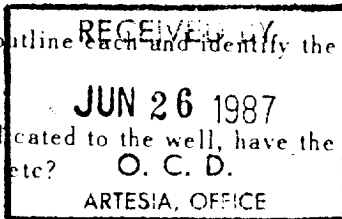

If answer is "no," list the owners and tract descriptions which have actually been consolidated. (Use reverse side of this form if necessary.)

No allowable will be assigned to the well until all interests have been consolidated (by communitization, unitization, forced-pooling, or otherwise) or until a non-standard unit, eliminating such interests, has been approved by the Commission.

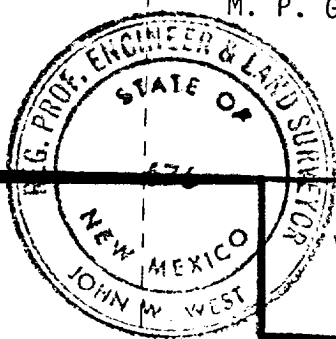
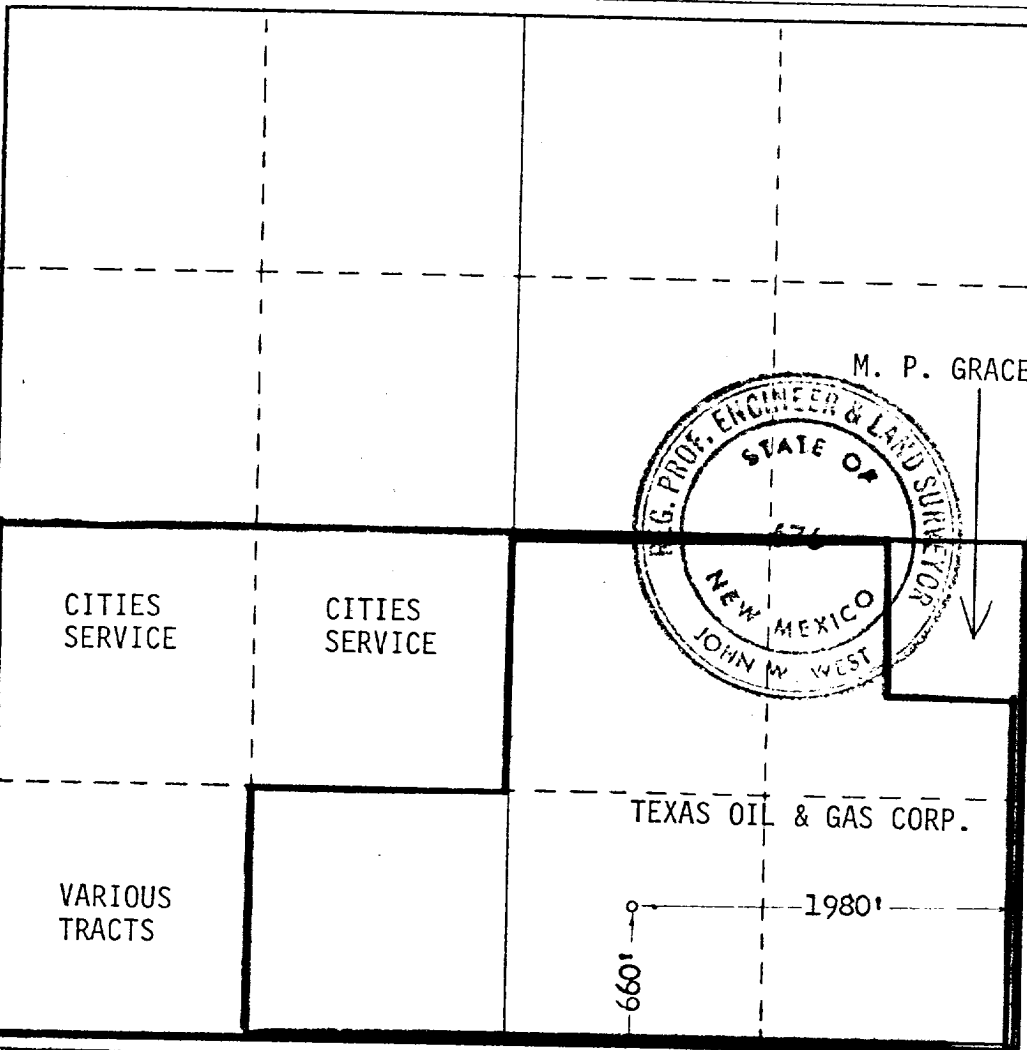

CERTIFICATION

I hereby certify that the information contained herein is true and complete to the best of my knowledge and belief.

Tim Goudeau
Name

Tim Goudeau

Position
Production Engineer

Company
TXO Production Corp.

Date
6-24-87

I hereby certify that the well location shown on this plat was plotted from field notes of actual surveys made by me or under my supervision, and that the same is true and correct to the best of my knowledge and belief.

Date Surveyed
Oct. 20, 1972

Registered Professional Engineer and/or Land Surveyor

John W. West
Certificate No.

676

