

MEXICO OIL CONSERVATION COMMISSION
WELL LOCATION AND ACREAGE DEDICATION PLAT

Form C-102
 Supersedes C-128
 Effective 1-1-65

Copy 0515

All distances must be from the outer boundaries of the Section.

Operator MONSANTO COMPANY			Lease BURTON FLAT UNIT		Well No. 3
Unit Letter	Section 3	Township 21-S	Range 27-E	County EDDY	
Actual Footage Location of Well: 700 feet from the SOUTH line and 1980 feet from the WEST line					
Ground Level Elev.	Producing Formation STRAWN		Pool <i>Wildcat</i> BURTON FLAT - STRAWN		Dedicated Acreage: 320 Acres

1. Outline the acreage dedicated to the subject well by colored pencil or hachure marks on the plat below.
2. If more than one lease is dedicated to the well, outline each and identify the ownership thereof (both as to working interest and royalty).
3. If more than one lease of different ownership is dedicated to the well, have the interests of all owners been consolidated by ~~communitization~~, unitization, ~~force-pooling~~, etc?

☒ Yes ☐ No If answer is "yes," type of consolidation **Monsanto Co-operator**
Burton Flat Deep Unit

If answer is "no," list the owners and tract descriptions which have actually been consolidated. (Use reverse side of this form if necessary.) _____

No allowable will be assigned to the well until all interests have been consolidated (by communitization, unitization, forced-pooling, or otherwise) or until a non-standard unit, eliminating such interests, has been approved by the Commission.

Approx. 14 miles

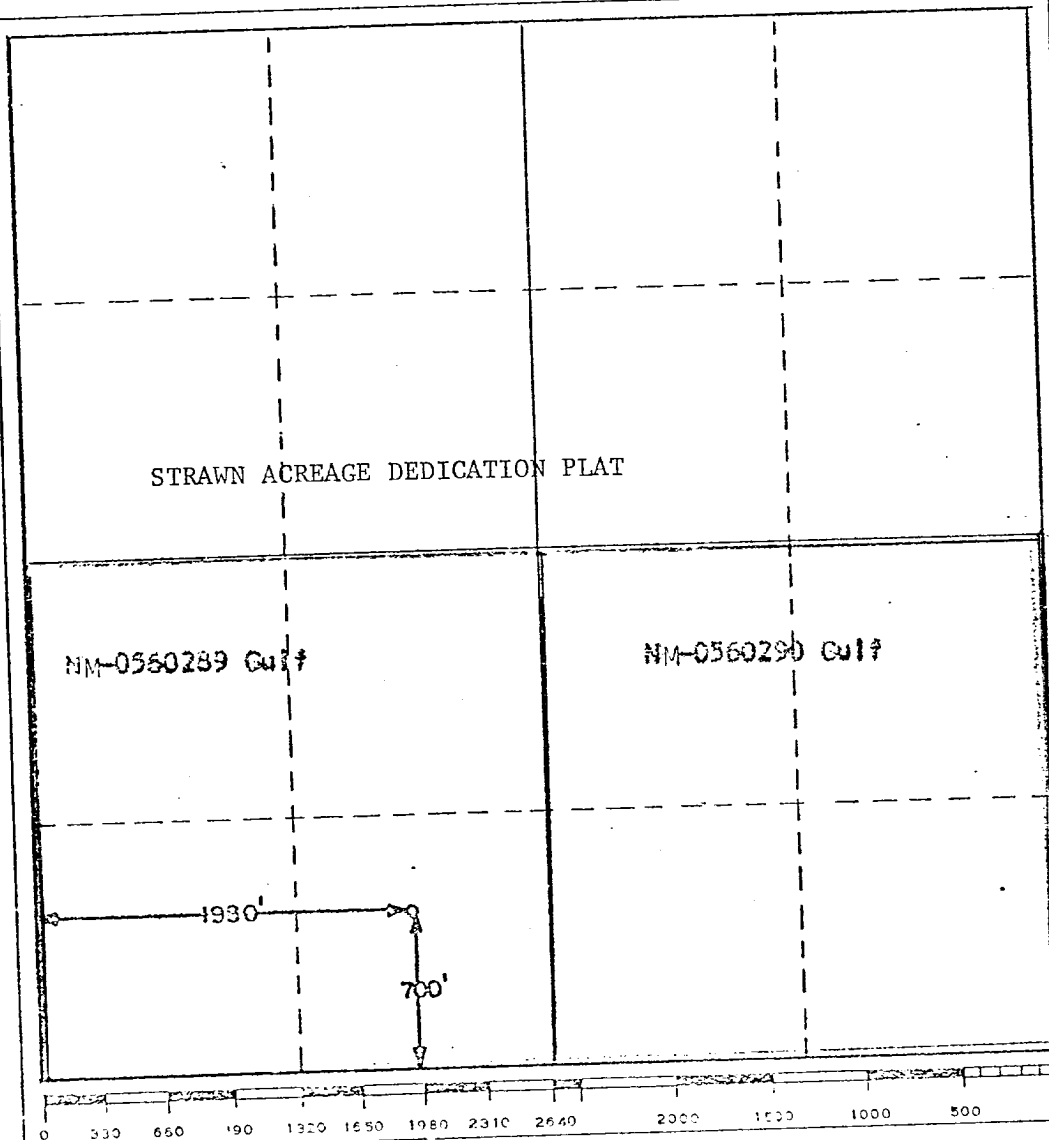

CERTIFICATION

I hereby certify that the information contained herein is true and complete to the best of my knowledge and belief.

Name *W. W. Wood*
 Position **Dist. Prod. Mgr.**
 Company **Monsanto Company**
 Date **6/25/73**

I hereby certify that the well location shown on this plat was plotted from field notes of actual surveys made by me or under my supervision, and that the same is true and correct to the best of my knowledge and belief.

Jan. 15, 1973
 Date Surveyed
Richard B. Duniven
 Registered Professional Engineer
 and/or Land Surveyor
Richard B. Duniven
 Certificate No. **4882**