

**MEXICO OIL CONSERVATION COMMISSION
WE LOCATION AND ACREAGE DEDICATION PLAT**

Form C-102
Supersedes C-128
Effective 1-1-65

All distances must be from the outer boundaries of the Section.

| | | | | | |
|---|--------------------------------------|-----------------------------|---|-----------------------|--|
| Operator THE SUPERIOR OIL COMPANY | | | Lease State "N" Comm. | | Well No. 1 |
| Unit Letter L | Section 34 | Township 21 South | Range 26 East | County Eddy | |
| Actual Footage Location of Well: 2235 feet from the south line and 660 feet from the west line | | | | | |
| Ground Level Elev. 3298 | Producing Formation Morrow | | Pool Undesignated Morrow Wildcat | | Dedicated Acreage: 320 Acres |

1. Outline the acreage dedicated to the subject well by colored pencil or hachure marks on the plat below.
2. If more than one lease is dedicated to the well, outline each and identify the ownership thereof (both as to working interest and royalty).
3. If more than one lease of different ownership is dedicated to the well, have the interests of all owners been consolidated by communitization, unitization, force-pooling, etc?

☒ Yes ☐ No If answer is "yes," type of consolidation Communitization of W/2 Sect. 34 is being processed.

If answer is "no," list the owners and tract descriptions which have actually been consolidated. (Use reverse side of this form if necessary.) _____

No allowable will be assigned to the well until all interests have been consolidated (by communitization, unitization, forced-pooling, or otherwise) or until a non-standard unit, eliminating such interests, has been approved by the Commission.

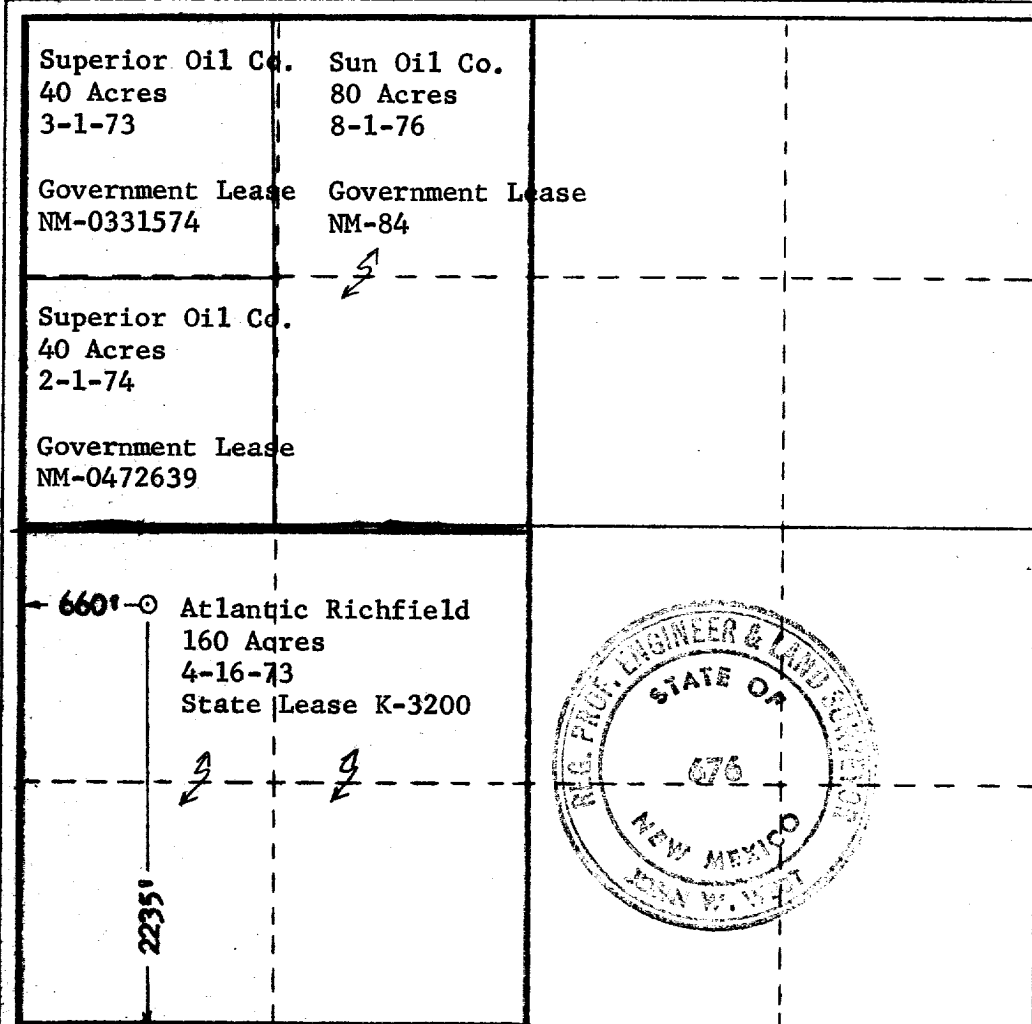

CERTIFICATION

I hereby certify that the information contained herein is true and complete to the best of my knowledge and belief.

Name

T. D. Clay

Position

Petroleum Engineer

Company

The Superior Oil Company

Date

February 2, 1973

I hereby certify that the well location shown on this plat was plotted from field notes of actual surveys made by me or under my supervision, and that the same is true and correct to the best of my knowledge and belief.

Date Surveyed

Jan 16, 1973

Registered Professional Engineer
and/or Land Surveyor

Certificate No.

676