

NEW MEXICO OIL CONSERVATION COMMISSION
WELL LOCATION AND ACREAGE DEDICATION PLAT

Form C-100
Supersedes C-120
Effective 1-1-67

All distances must be from the outer boundaries of the Section.

Operator El Paso Natural Gas Company			Lease Rocky Arroyo		Well No. #C1
Unit Letter F	Section 8	Township 22 South	Range 22 East	County Eddy	

Actual Footage Location of Well:

1980	feet from the	North	line and	1980	feet from the	West	line
Ground Level Elev. 4482	Producing Formation Wolfcamp - Morrow		Pool Rocky Arroyo		Dedicated Acreage: WC-160, MOR 320 acres		

1. Outline the acreage dedicated to the subject well by colored pencil or hachure marks on the plat below.
2. If more than one lease is dedicated to the well, outline each and identify the ownership thereof (both as to working interest and royalty).
3. If more than one lease of different ownership is dedicated to the well, have the interests of all owners been consolidated by communitization, unitization, force-pooling, etc?

☐ Yes ☒ No If answer is "yes," type of consolidation _____

If answer is "no," list the owners and tract descriptions which have actually been consolidated. (Use reverse side of this form if necessary.) _____ Well will be communitized if productive.

No allowable will be assigned to the well until all interests have been consolidated (by communitization, unitization, forced-pooling, or otherwise) or until a non-standard unit, eliminating such interests, has been approved by the Commission.

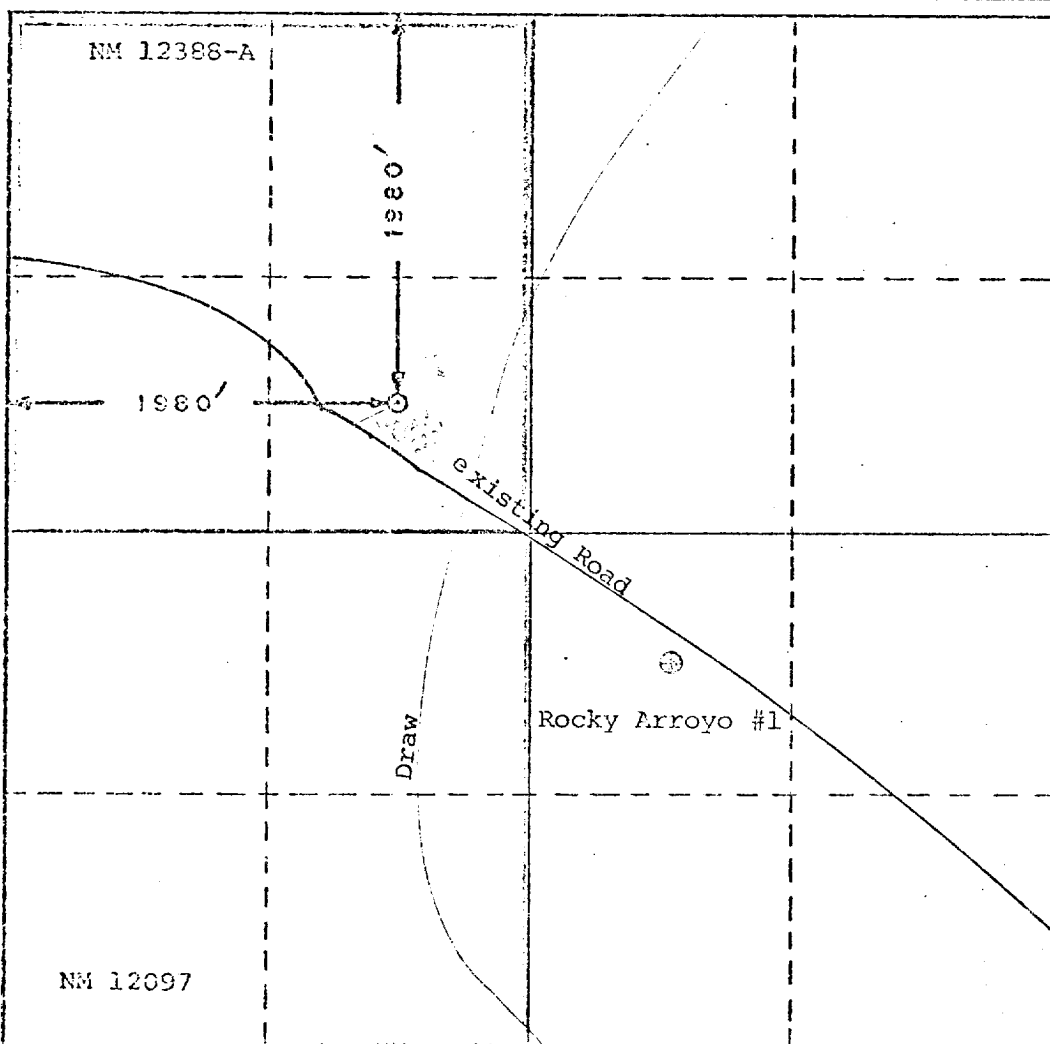

CERTIFICATION

I hereby certify that the information contained herein is true and complete to the best of my knowledge and belief.

C. D. Kysar
Name

Position
Production Clerk

Company
El Paso Natural Gas Co.

Date
June 5, 1973

I hereby certify that the well location shown on this plat was plotted from field notes of actual surveys made by me or under my supervision, and that the same is true and correct to the best of my knowledge and belief.

May 31, 1973

Date Surveyed
Registered Professional Engineer
and/or Land Surveyor

J. D. Carter
Certified by the State

3067

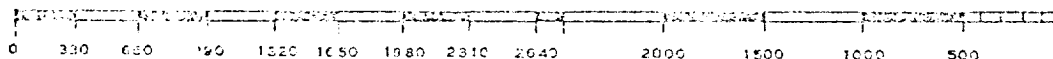



LTR



Job separation sheet

EL PASO NATURAL GAS CO.
ROCKY ARROYO C NO. 1
LOCATION & RIG LAYOUT

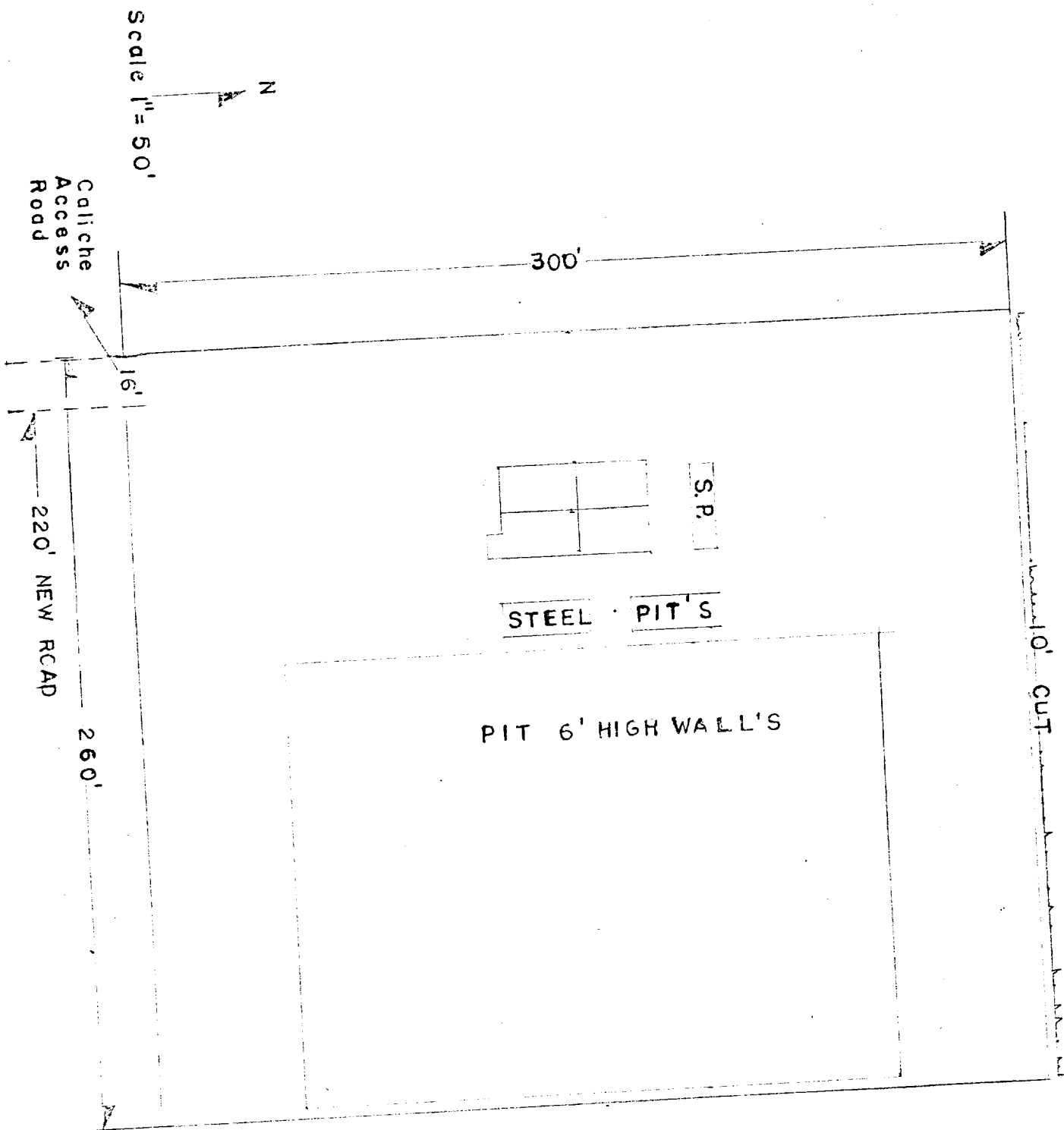

RECEIVED
JUN-8 1973
U. S. GEOLOGICAL SURVEY
ARTESIA, NEW MEXICO