

RECEIVED

Submit to Appropriate
District Office
State Lease - 6 copies
Fee Lease - 5 copies

JUL 20 '89

State of New Mexico
Energy, Minerals and Natural Resources Department

State	1
Land Office	1
Operator	1

Form C-101
Revised 1-1-89

30-015-20923

DISTRICT I
P.O. Box 1980, Hobbs, NM 88240

O. C. SOIL CONSERVATION DIVISION

P.O. Box 2088
Santa Fe, New Mexico 87504-2088

DISTRICT II
P.O. Drawer DD, Artesia, NM 88210

DISTRICT III
1000 Rio Brazos Rd., Aztec, NM 87410

API NO. (assigned by OCD on New Wells)

30-015-21577

5. Indicate Type of Lease

STATE ☒ FEE ☐

6. State Oil & Gas Lease No.

V-2394

APPLICATION FOR PERMIT TO DRILL, DEEPEN, OR PLUG BACK

1a. Type of Work:

DRILL ☐ RE-ENTER ☒ DEEPEN ☐ PLUG BACK ☐

b. Type of Well:

OIL WELL ☐ GAS WELL ☐ OTHER ☐SINGLE ZONE ☐ MULTIPLE ZONE ☐

7. Lease Name or Unit Agreement Name

Allied Comm.

2. Name of Operator

Manzano Oil Corporation 505/623-1996

8. Well No.

1

3. Address of Operator

P.O. Box 2107, Roswell, NM 88202-2107

9. Pool name or Wildcat

Penlon Delaware

4. Well Location

Unit Letter B : 660' Feet From The North Line and 1980 Feet From The East Line

Section 27 Township 20S Range 27E NMPM Eddy County

10. Proposed Depth

2900'

11. Formation

Delaware Sand

12. Rotary or C.T.

Reverse Unit

13. Elevations (Show whether DF, RT, GR, etc.)

3259' GL

14. Kind & Status Plug Bond

Statewide

15. Drilling Contractor

16. Approx. Date Work will start

July 21, 1989

17.

PROPOSED CASING AND CEMENT PROGRAM

SIZE OF HOLE	SIZE OF CASING	WEIGHT PER FOOT	SETTING DEPTH	SACKS OF CEMENT	EST. TOP
17	12 3/4"	31	338	350 sks+5 redimix	Surface
11	8 5/8"	24	2300	975 sks	200
7 7/8	4 1/2"	11.6	2900	200 sks	1750

Manzano plans to reenter the Allied Comm. #1 well which was drilled, completed and plugged by Penroc Oil Corporation, clean out the hole to a total depth of 2900'. A 4 1/2" production casing string will be run to TD and cemented back into the 8 5/8" casing. The Delaware Sand will be perforated from 2740-2820' and tested. The well will be fraced, if necessary, and completed as a Delaware gas producer. A 6"-900 Series Shaffer BOP will be used during reentry operations.

APPROVAL VALID FOR 180 DAYS
PERMIT EXPIRES 1-25-90
UNLESS DRILLING UNDERWAY

IN ABOVE SPACE DESCRIBE PROPOSED PROGRAM: IF PROPOSAL IS TO DEEPEN OR PLUG BACK, GIVE DATA ON PRESENT PRODUCTIVE ZONE AND PROPOSED NEW PRODUCTIVE ZONE. GIVE BLOWOUT PREVENTER PROGRAM, IF ANY.

I hereby certify that the information above is true and complete to the best of my knowledge and belief.

SIGNATURE _____ TITLE V.P. Land DATE 7/19/89

TYPE OR PRINT NAME _____ TELEPHONE NO. _____

(This space for State Use)

ORIGINAL SIGNED BY
MIKE WILLIAMS
SUPERVISOR, DISTRICT II

APPROVED BY _____ TITLE _____ DATE JUL 27 1989

CONDITIONS OF APPROVAL, IF ANY:

Submit to Appropriate
District Office
State Lease - 4 copies
Fee Lease - 3 copies

State of New Mexico
Energy, Minerals and Natural Resources Department

RECEIVED

Form C-102
Revised 1-1-89

OIL CONSERVATION DIVISION

P.O. Box 2088
Santa Fe, New Mexico 87504-2088

JUL 20 '89

DISTRICT I
P.O. Box 1980, Hobbs, NM 88240

DISTRICT II
P.O. Drawer DD, Artesia, NM 88210

DISTRICT III
1000 Rio Brazos Rd., Aztec, NM 87410

WELL LOCATION AND ACREAGE DEDICATION PLAT

All Distances must be from the outer boundaries of the section

O. C. D.
ARTESIA, OFFICE

Operator Manzano Oil Corporation			Lease Allied Comm.		Well No. 1
Unit Letter B	Section 27	Township 20 South	Range 27 East	County Eddy	
Actual Footage Location of Well: 660 feet from the North line and 1980 feet from the East line					
Ground level Elev. 3259'	Producing Formation Delaware Sand		Pool Penlon Delaware	Dedicated Acreage: 160 Acres	

1. Outline the acreage dedicated to the subject well by colored pencil or hatchure marks on the plat below.
2. If more than one lease is dedicated to the well, outline each and identify the ownership thereof (both as to working interest and royalty).
3. If more than one lease of different ownership is dedicated to the well, have the interest of all owners been consolidated by communitization, unitization, force-pooling, etc?
☐ Yes ☒ No If answer is "yes" type of consolidation _____
If answer is "no" list the owners and tract descriptions which have actually been consolidated. (Use reverse side of this form if necessary). _____
No allowable will be assigned to the well until all interests have been consolidated (by communitization, unitization, forced-pooling, or otherwise) or until a non-standard unit, eliminating such interest, has been approved by the Division.

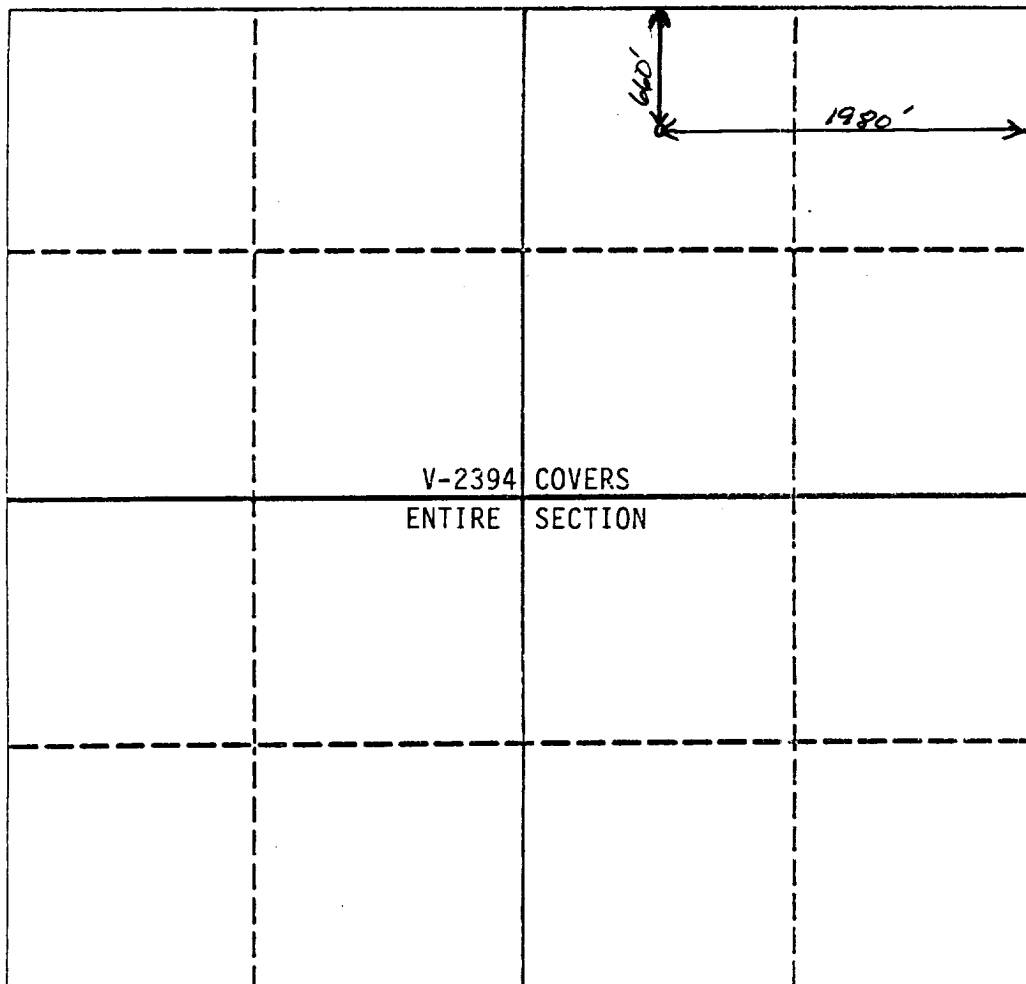

OPERATOR CERTIFICATION

I hereby certify that the information contained herein is true and complete to the best of my knowledge and belief.

Signature

Jim Ball

Printed Name

Vice President of Land

Position

Manzano Oil Corporation

Company

7/19/89

Date

SURVEYOR CERTIFICATION

I hereby certify that the well location shown on this plat was plotted from field notes of actual surveys made by me or under my supervision, and that the same is true and correct to the best of my knowledge and belief.

Date Surveyed

Signature & Seal of
Professional Surveyor

See original plat
for surveyor's signature

Certificate No.

COPIES RECEIVED	
TRIBUTION	
FILE	
U.S.G.S.	
LAND OFFICE	
OPERATOR	

NEW MEXICO OIL CONSERVATION COMMISSION

SEP 3 1980

Form C-103
 Supersedes Old
 C-102 and C-103
 Effective 1-1-85

5a. Indicate Type of Lease State <input checked="" type="checkbox"/> Fee <input type="checkbox"/>
5. State Oil & Gas Lease No. K-4397
7. Unit Agreement Name
8. Farm or Lease Name Allied-Comm.
9. Well No. 1
10. Field and Pool, or Wildcat Avalon Morrow
12. County Eddy

SUNDARY NOTICES AND REPORTS ON WELLS

(DO NOT USE THIS FORM FOR PROPOSALS TO DRILL OR TO DEEPEN OR PLUG BACK TO A DIFFERENT RESERVOIR.
 USE "APPLICATION FOR PERMIT -" (FORM C-101) FOR SUCH PROPOSALS.)

1. OIL WELL <input type="checkbox"/> GAS WELL <input type="checkbox"/> OTHER- Plug and Abandon	7. Unit Agreement Name
2. Name of Operator Penroc Oil Corporation	8. Farm or Lease Name Allied-Comm.
3. Address of Operator P. O. Drawer 831, Midland, Texas 79702	9. Well No. 1
4. Location of Well UNIT LETTER B 1980 FEET FROM THE East LINE AND 660 FEET FROM THE North LINE, SECTION 27 TOWNSHIP 20S RANGE 27 NMPM.	10. Field and Pool, or Wildcat Avalon Morrow
15. Elevation (Show whether DF, RT, GR, etc.) 3259 GR	12. County Eddy

16. Check Appropriate Box To Indicate Nature of Notice, Report or Other Data
 NOTICE OF INTENTION TO: SUBSEQUENT REPORT OF:

PERFORM REMEDIAL WORK <input type="checkbox"/>	PLUG AND ABANDON <input type="checkbox"/>	REMEDIAL WORK <input type="checkbox"/>	ALTERING CASING <input type="checkbox"/>
TEMPORARILY ABANDON <input type="checkbox"/>	CHANGE PLANS <input type="checkbox"/>	COMMENCE DRILLING OPNS. <input type="checkbox"/>	PLUG AND ABANDONMENT <input checked="" type="checkbox"/>
PULL OR ALTER CASING <input type="checkbox"/>	OTHER <input type="checkbox"/>	CASING TEST AND CEMENT JOBS <input type="checkbox"/>	OTHER Final Clean Up of location <input type="checkbox"/>

17. Describe Proposed or Completed Operations (Clearly state all pertinent details, and give pertinent dates, including estimated date of starting any proposed work) SEE RULE 1103.

On 8-20-80 location was leveled, cellar filled and debris removed. Location is ready for final inspection for final approval of plug and abandon.

Refer to Form 103 dated 5-27-80 for plugging information.

18. I hereby certify that the information above is true and complete to the best of my knowledge and belief.

SIGNED B. J. Dally TITLE President DATE 9-2-80
 APPROVED BY Mike Storrfield TITLE OIL AND GAS INSPECTOR DATE SEP 11 1980
 CONDITIONS OF APPROVAL, IF ANY: