

N MEXICO OIL CONSERVATION COMMISS
WELL LOCATION AND ACREAGE DEDICATION PLAT

Form 1-17
 Use under G-128
 5-11-68

All distances must be from the outer boundaries of the Section

| | | | | | |
|---------------------------------------|----------------------|-----------------------------|---------------------------------------|-----------------------|--|
| Lessor AMOCO PRODUCTION CO. | | | Lessee BUBBLING SPRING UNIT | | |
| Map Sheet F | Section 26 | Township 20 SOUTH | Range 26 EAST | County EDDY | |

Actual Footage Location of Well:

| | | | | | | |
|----------------------------------|------------------------------------|--------------|-----------------------|--------------------------|---------------|-------------|
| 1980 | feet from the | NORTH | line and | 1980 | feet from the | WEST |
| Ground Level Elev. NVA | Producing Formation MISS | | For WILDCAT | Well Depth 320 | | |

1. Outline the acreage dedicated to the subject well by colored pencil or hachure marks on the plat below
2. If more than one lease is dedicated to the well, outline each and identify the ownership thereof (both as to working interest and royalty).
3. If more than one lease of different ownership is dedicated to the well, have the interests of all owners been consolidated by communitization, unitization, force-pooling, etc?

☒ Yes ☐ No If answer is "yes," type of consolidation **UNITIZED**

If answer is "no," list the owners and tract descriptions which have actually been consolidated. (Use reverse side of this form if necessary.) _____

No allowable will be assigned to the well until all interests have been consolidated (by communitization, unitization, forced-pooling, or otherwise) or until a non-standard unit, eliminating such interests, has been approved by the Commission.

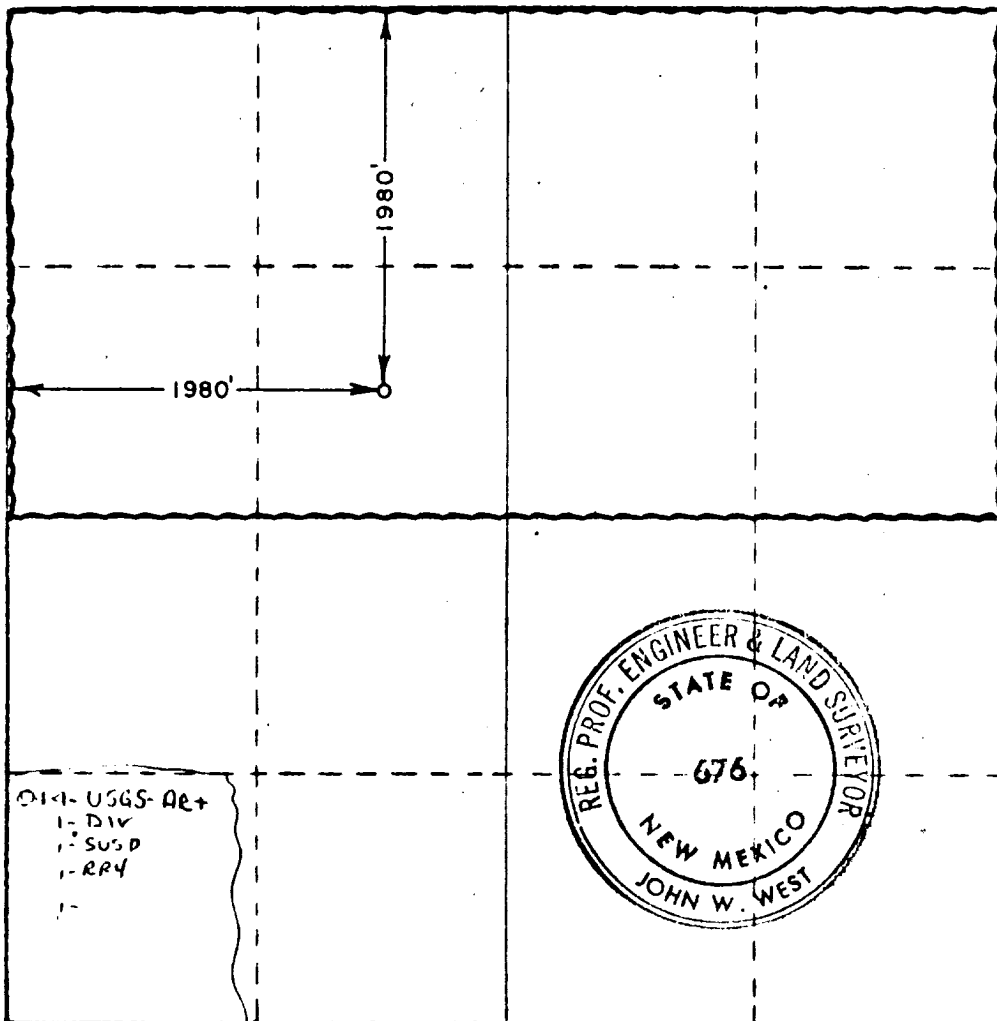

CERTIFICATION

I hereby certify that the information contained herein is true and complete to the best of my knowledge and belief.

AREA ENGINEER

Amoco Production Company

Date
10-1-73

I hereby certify that the location shown _____ was plotted from field notes of actual survey made by me or under my supervision, and that the same is true and correct to the best of my knowledge and belief.

RECEIVED
OCT 15 1973
GEOLOGICAL SURVEY
ARTESIA, NEW MEXICO

Date Surveyed
SEPTEMBER 29, 1973

Registered Professional Engineer and/or Land Surveyor

John W. West
 Certificate No. **676**