

NEW MEXICO OIL CONSERVATION COMMISSION
WELL LOCATION AND ACREAGE DEDICATION PLAT

Form C-122
Supersedes C-122
Effective 1-1-55

All distances must be from the outer boundaries of the Section.

Operator MONSANTO COMPANY		Lease Wilderspin		Well No. I
Unit Letter 3267 F	Section 11	Township 21-S	Range 27-E	County EDDY
Actual Footage Location of Well: 1980 feet from the North line and 1980 feet from the West line				
Ground Level Elev:	Producing Formation STRAWN	Pool Burton Flat Shale UNDESIGNATED	Dedicated Acreage: 320 Acres	

1. Outline the acreage dedicated to the subject well by colored pencil or hachure marks on the plat below.
2. If more than one lease is dedicated to the well, outline each and identify the ownership thereof (both as to working interest and royalty).
3. If more than one lease of different ownership is dedicated to the well, have the interests of all owners been consolidated by communitization, unitization, force-pooling, etc?

RECEIVED

MAR 14 1974

☐ Yes ☐ No If answer is "yes," type of consolidation _____

O. C. C.

If answer is "no," list the owners and tract descriptions which have actually been consolidated (on reverse side of this form if necessary.) _____

No allowable will be assigned to the well until all interests have been consolidated (by communitization, unitization, forced-pooling, or otherwise) or until a non-standard unit, eliminating such interests, has been approved by the Commission.

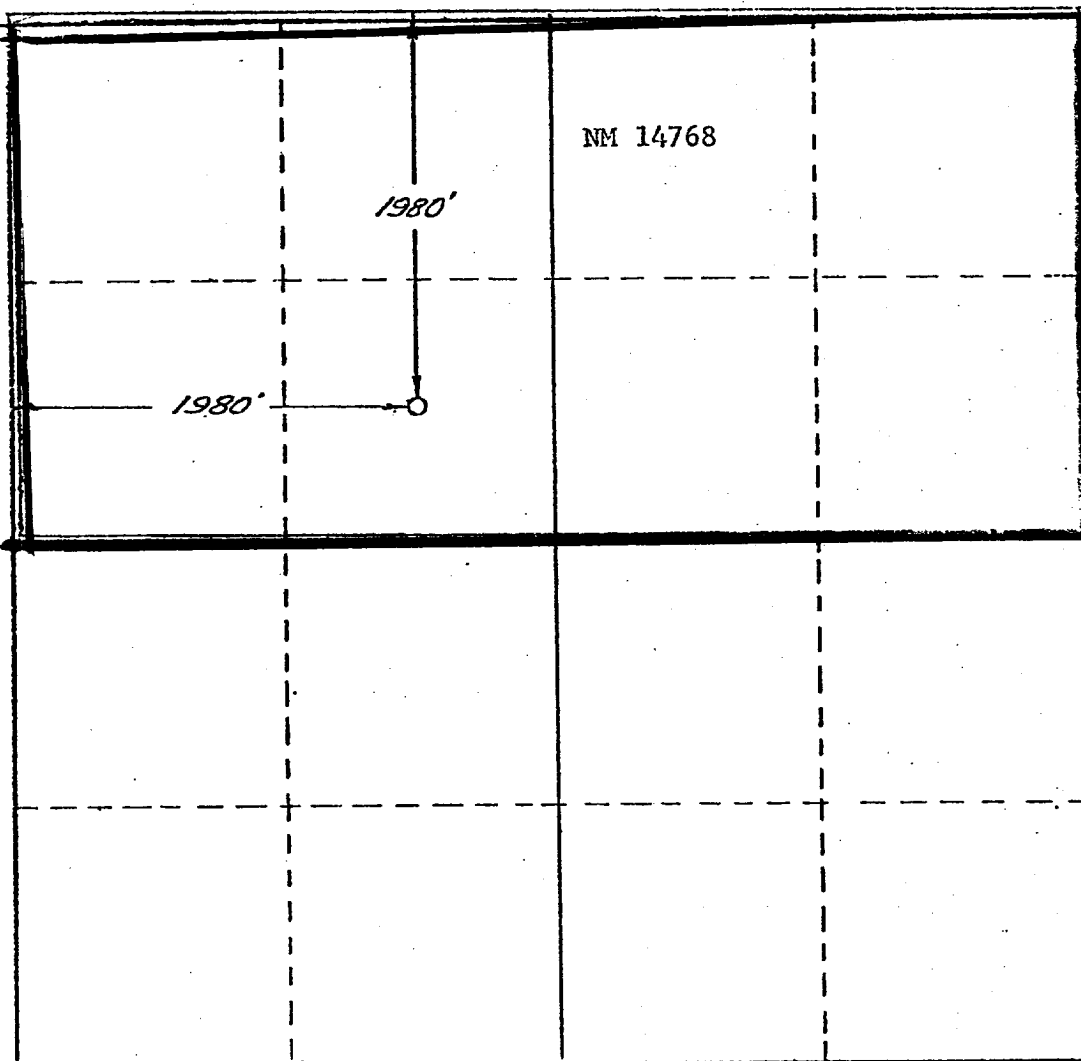

CERTIFICATION

I hereby certify that the information contained herein is true and complete to the best of my knowledge and belief.

A. W. Wood

Name

A. W. Wood

Position

District Production Mgr.

Company

MONSANTO COMPANY

Date

MAR 13 1974

I hereby certify that the well location shown on this plat was plotted from field notes of actual surveys made by me or under my supervision, and that the same is true and correct to the best of my knowledge and belief.

October 26, 1973

Date Surveyed

Richard B. Duniven

Registered Professional Engineer and/or Land Surveyor

Certificate No.