

UNITED STATES
DEPARTMENT OF THE INTERIOR
GEOLOGICAL SURVEY

APPLICATION FOR PERMIT TO DRILL, DEEPEN, OR PLUG BACK

1a. TYPE OF WORK DRILL <input checked="" type="checkbox"/> DEEPEN <input type="checkbox"/> PLUG BACK <input type="checkbox"/>		5. LEASE DESIGNATION AND SERIAL NO. NM - 0489599
b. TYPE OF WELL OIL WELL <input checked="" type="checkbox"/> GAS WELL <input type="checkbox"/> OTHER <input type="checkbox"/> SINGLE ZONE <input type="checkbox"/> MULTIPLE ZONE <input type="checkbox"/>		6. IF INDIAN, ALLOTTEE OR TRIBE NAME
2. NAME OF OPERATOR MONSANTO COMPANY ✓		7. UNIT AGREEMENT NAME
3. ADDRESS OF OPERATOR 101 North Marienfeld, Midland, Texas 79701		8. FARM OR LEASE NAME ARCO
4. LOCATION OF WELL (Report location clearly and in accordance with any State requirements.)* At surface 1980' FS & WL Sec. 13 At proposed prod. zone		9. WELL NO. 1-18
14. DISTANCE IN MILES AND DIRECTION FROM NEAREST TOWN OR POST OFFICE* 5 miles north of Carlsbad, New Mexico		10. FIELD AND POOL, OR WILDCAT + Wildcat
15. DISTANCE FROM PROPOSED* LOCATION TO NEAREST PROPERTY OR LEASE LINE, FT. (Also to nearest drlg. unit line, if any) 1980'	16. NO. OF ACRES IN LEASE 1080	11. SEC., T., R., M., OR BLK. AND SURVEY OR AREA Sec. 13, T-21S, R-26E
18. DISTANCE FROM PROPOSED LOCATION* TO NEAREST WELL, DRILLING, COMPLETED, OR APPLIED FOR, ON THIS LEASE, FT. None	19. PROPOSED DEPTH 700'	12. COUNTY OR PARISH 13. STATE Eddy New Mexico
20. ROTARY OR CABLE TOOLS Cable		17. NO. OF ACRES ASSIGNED TO THIS WELL 40
21. ELEVATIONS (Show whether DF, RT, GR, etc.) Will furnish later		22. APPROX. DATE WORK WILL START* Feb. 25, 1974

23. PROPOSED CASING AND CEMENTING PROGRAM				
SIZE OF HOLE	SIZE OF CASING	WEIGHT PER FOOT	SETTING DEPTH	QUANTITY OF CEMENT
12 1/2"	8 5/8"	24#	250'	150 Sx.

Drill 12 1/2" hole to 250'; Set 8 5/8" 24# Csg & cement to surface.

Drill 7 7/8" hole to 700' & evaluate.
If production is indicated, set 7" Csg & cement.
Perforate and treat if necessary.

RECEIVED

FEB 19 1974

O. C. C.
ARTESIA, OFFICE

RECEIVED

U. S. GEOLOGICAL SURVEY
ARTESIA, NEW MEXICO

IN ABOVE SPACE DESCRIBE PROPOSED PROGRAM: If proposal is to deepen or plug back, give data on present productive zone and proposed new productive zone. If proposal is to drill or deepen directionally, give pertinent data on subsurface locations and measured and true vertical depths. Give blowout preventer program, if any.

24. SIGNED M. Schell TITLE District Engineer DATE 2/5/74

(This space for Federal or State office use)

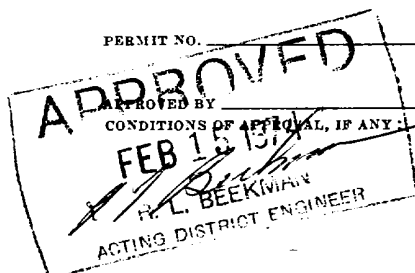

TITLE IN OPERATIONS
ARE NOT COMMENCED WITHIN 3 MONTHS.
DATE _____

THIS APPROVAL
EXPIRES MAY 15 1974

*See Instructions On Reverse Side

NEW MEXICO OIL CONSERVATION COMMISSION
WELL LOCATION AND ACREAGE DEDICATION PLAT

Form C-102
Supersedes C-128
Effective 1-1-65

All distances must be from the outer boundaries of the Section.

Operator MONSANTO COMPANY		Lease ARCO		Well No. 18-1
Unit Letter K	Section 13	Township 21-S	Range 26-E	County EDDY
Actual Footage Location of Well: 1980 feet from the South line and 1980 feet from the West line				
Ground Level Elev: 3267'	Producing Formation Yates	Pool Undesignated	Dedicated Acreage: 40 Acres	

1. Outline the acreage dedicated to the subject well by colored pencil or hachure marks on the plat below.
2. If more than one lease is dedicated to the well, outline each and identify the ownership thereof (both as to working interest and royalty). Only one lease
3. If more than one lease of different ownership is dedicated to the well, have the interests of all owners been consolidated by communitization, unitization, force-pooling, etc?

☐ Yes ☐ No If answer is "yes," type of consolidation _____

If answer is "no," list the owners and tract descriptions which have actually been consolidated. (Use reverse side of this form if necessary.) _____

No allowable will be assigned to the well until all interests have been consolidated (by communitization, unitization, forced-pooling, or otherwise) or until a non-standard unit, eliminating such interests, has been approved by the Commission.

CERTIFICATION

I hereby certify that the information contained herein is true and complete to the best of my knowledge and belief.

E. M. Scholl

Name
E. M. Scholl

Position
District Engineer

Company
Monsanto Company

Date
2/5/74

I hereby certify that the well location shown on this plat was plotted from field notes of actual surveys made by me or under my supervision, and that the same is true and correct to the best of my knowledge and belief.

February 4, 1974

Date Surveyed
Richard B. Duriven

Registered Professional Engineer
and/or Land Surveyor

Richard B. Duriven

Certificate No.
4882

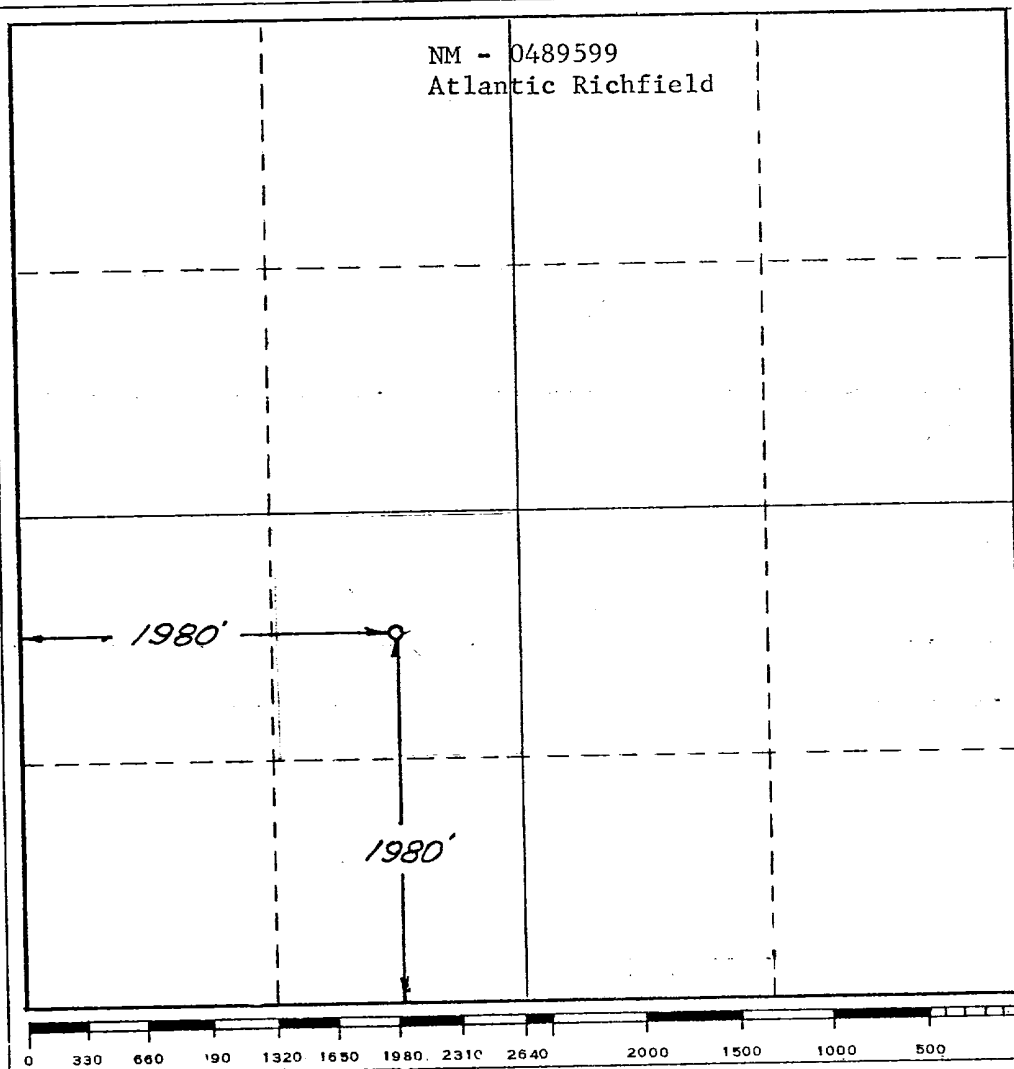

N. M. O. C. G. 60RX
Monsanto

Monsanto Company
317 First Savings & Loan Building
101 North Marienfeld
Midland, Texas 79701
Phone: (915) 683-3306

February 5, 1974

United States Geological Survey
Drawer U
Artesia, New Mexico 88210

Attn: Mr. James Knauf

RE: Arco No. 1-13
Sec. 13, T-21S, R-26E
Eddy County, New Mexico

Gentlemen:

Monsanto Company respectfully submits the following Development Plan for drilling the above captioned well.

Development Plans include the following:

1. Existing roads: See attachment
2. Planned access roads: See attachment
3. Location of well: 1980' FS & WL's Sec. 13, T-21S, R-26E
4. Lateral Road: See attachment
5. Location of Tank Battery:
If well is oil productive an oil and gas separator and two 300 Bbl. tanks will be installed on the southeast corner of the pad. Location of pipelines is unknown at this time.
6. Location and type of water supply:
Water will be purchased as near as possible and trucked to location.
7. Method of waste water disposal:
Cuttings and waste water will be collected in steel tanks and trucked to appropriate disposal facilities.
8. Location of camps: None

RECEIVED

FEB 6 1974

U. S. GEOLOGICAL SURVEY
ARTESIA, NEW MEXICO

February 5, 1974

9. Location of air strips: None
10. Location of rig:
Will be a cable tool rig with steel collection tanks.
11. Plans for restoration:
Land will be leveled and returned as near as possible
to original condition.
12. Other:
Well will be drilled to total depth with spud mud. There
will be no blow out prevention equipment.

Monsanto Company respectfully requests that this plan of development be approved. Please advise if you require any additional information.

Yours very truly,

MONSANTO COMPANY



E. M. Scholl
District Engineer

EMS:HW:mm
Encls.

ROSWELL (JUNC. U.S. 70-300) 7.9 MI.
ALBUQUERQUE 35 MI.

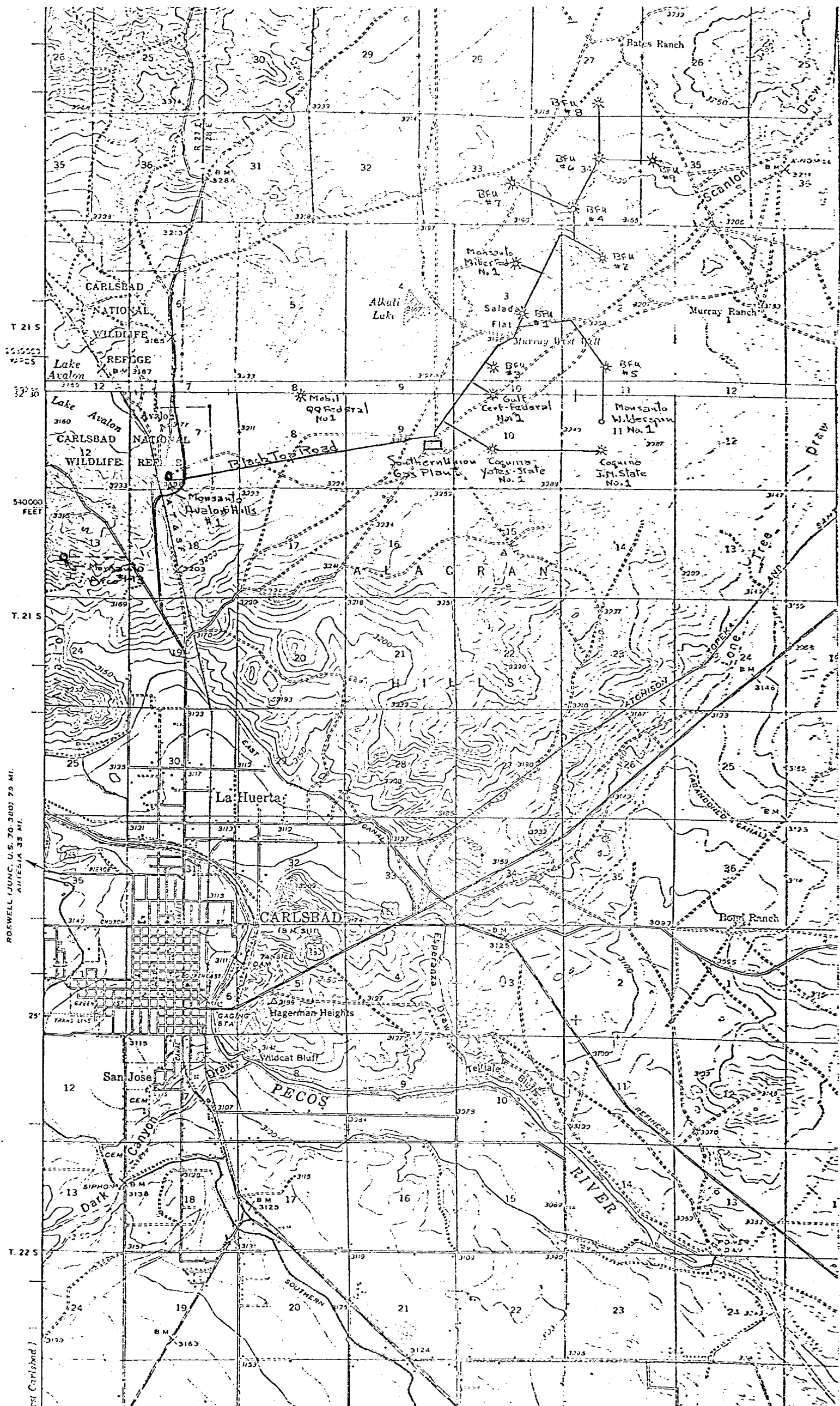

Journal of Management Education 30(6)

100-443887-100