

NE EXICO OIL CONSERVATION COMMISSIO
WELL LOCATION AND ACREAGE DEDICATION PLAT

Form O-122
Supersedes O-128
Effective 1-1-65

All distances must be from the outer boundaries of the Section.

Atlantic Richfield Company			Lease State BQ		Well No. 1
Section F	Section 9	Township 21S	Range 26E	County Eddy	
Actual Portage Location of Well:					
1980 feet from the North line and		1980 feet from the West line			
Ground Elev. Elev.	Producing Formation	Pool wildcat	Dedicated Acreage: 640 Acres		

1. Outline the acreage dedicated to the subject well by colored pencil or hachure marks on the plat below.

2. If more than one lease is dedicated to the well, outline each and identify the ownership thereof (both as to working interest and royalty).

3. If more than one lease of different ownership is dedicated to the well, have the interests of all owners been consolidated by communitization, unitization, force-pooling, etc?

☒ Yes ☐ No If answer is "yes," type of consolidation Communitization O.C.C.

If answer is "no," list the owners and tract descriptions which have actually been consolidated. (Use reverse side of this form if necessary.)

No allowable will be assigned to the well until all interests have been consolidated (by communitization, unitization, forced-pooling, or otherwise) or until a non-standard unit, eliminating such interests, has been approved by the Commission.

R 26 E

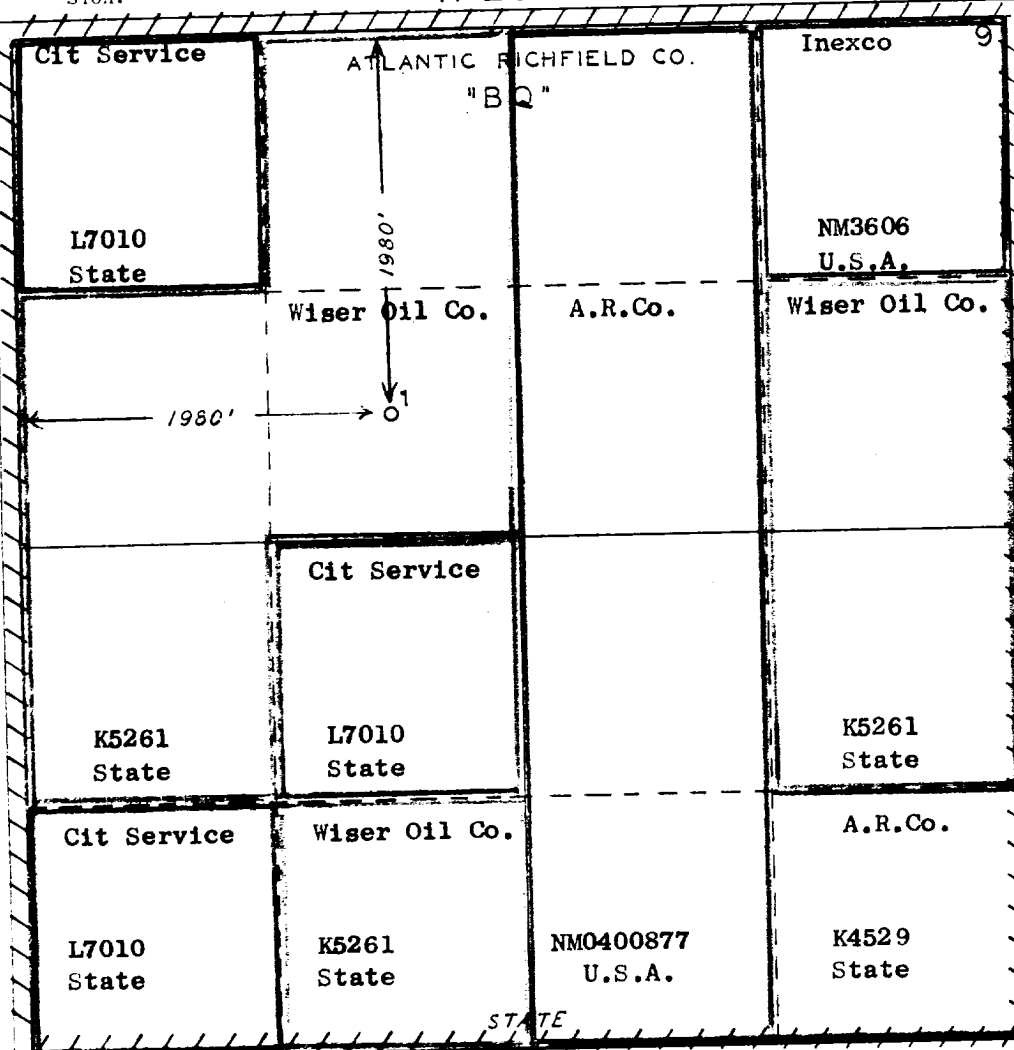

CERTIFICATION

I hereby certify that the information contained herein is true and complete to the best of my knowledge and belief.

Name H. J. Bernard
Position Dist. Drlg. Supv.
Company Atlantic Richfield Company
Date 5/1/74

I hereby certify that the well location shown on this plat was plotted from field notes of actual surveys made by me or under my supervision, and that the same is true and correct to the best of my knowledge and belief.

Date Surveyed APRIL 30, 1974

Registered Professional Engineer and/or Land Surveyor

Certificate No. 648