

NEW MEXICO OIL CONSERVATION COMMISSION
WELL LOCATION AND ACREAGE DEDICATION PLAT

Form C-102
Supersedes C-128
Effective 1-1-65

All distances must be from the outer boundaries of the Section.

Operator MONSANTO COMPANY			Lease FASKEN-FEDERAL		Well No. 2
Unit Letter V	Section 5	Township 21-S	Range 26-E	County EDDY	
Actual Footage Location of Well: 660 feet from the South line and 1980 feet from the West line.					
Ground Level Elev. 3213	Producing Formation Morrow	Pool WILDCAT		Dedicated Acreage: 320 Acres	

1. Outline the acreage dedicated to the subject well by colored pencil or hachure marks on the plat below.
2. If more than one lease is dedicated to the well, outline each and identify the ownership thereof (both as to working interest and royalty).
3. If more than one lease of different ownership is dedicated to the well, have the interests of all owners been consolidated by communitization, unitization, force-pooling, etc?

☐ Yes ☐ No If answer is "yes," type of consolidation _____

If answer is "no," list the owners and tract descriptions which have actually been consolidated. (Use reverse side of this form if necessary.) _____

No allowable will be assigned to the well until all interests have been consolidated (by communitization, unitization, forced-pooling, or otherwise) or until a non-standard unit, eliminating such interests, has been approved by the Commission.

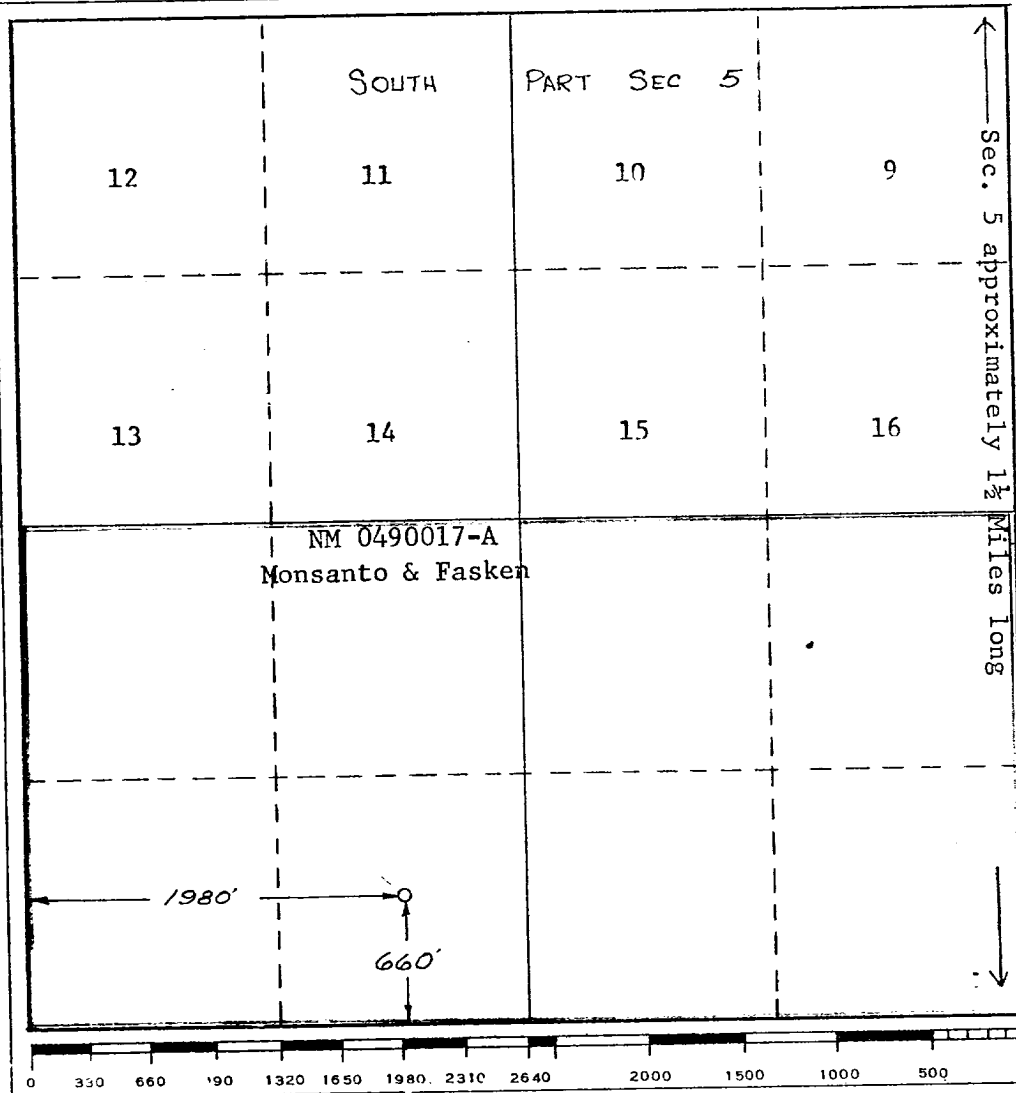

RECEIVED
JUN 4 1974

CERTIFICATION
I hereby certify that the information contained herein is true and complete to the best of my knowledge and belief.

Name *E. M. Scholl*
E. M. Scholl

Position
District Production Mgr.

Company
MONSANTO COMPANY

Date
June 3, 1974

RECEIVED
MAY 3 1974
U.S. GEOLOGICAL SURVEY
ARTESIA, NEW MEXICO

I hereby certify that the well location shown on this plat was plotted from field notes of actual survey made by me or under my supervision and that the same is true and correct to the best of my knowledge and belief.

May 29, 1974

Date Surveyed
Richard B. Duniven
Registered Professional Engineer
and/or Land Surveyor

Richard B. Duniven
Certificate No. **4882**