

NO. OF COPIES RECEIVED	6
DISTRIBUTION	
SANTA FE	1
FILE	1
U.S.G.S.	2
LAND OFFICE	1
OPERATOR	1

NEW MEXICO OIL CONSERVATION COMMISSION
RECEIVED

JUN 24 1974

30-015-21255
Form C-101
Revised 1-1-65

5A. Indicate Type of Lease	
STATE <input checked="" type="checkbox"/>	FEE <input type="checkbox"/>
5. State Oil & Gas Lease No.	

O. C. C.

APPLICATION FOR PERMIT TO DRILL, DEEPEN, OR PLUG BACK

1a. Type of Work		7. Unit Agreement Name	
b. Type of Well DRILL <input checked="" type="checkbox"/> DEEPEN <input type="checkbox"/> PLUG BACK <input type="checkbox"/> OIL WELL <input type="checkbox"/> GAS WELL <input checked="" type="checkbox"/> OTHER <input type="checkbox"/> SINGLE ZONE <input type="checkbox"/> MULTIPLE ZONE <input type="checkbox"/>		8. Farm or Lease Name State BR	
2. Name of Operator Atlantic Richfield Company		9. Well No. 1	
3. Address of Operator P. O. Box 1710, Hobbs, New Mexico 88240		10. Field and Pool, or Wildcat Catclaw Draw	
4. Location of Well UNIT LETTER K LOCATED 1980 FEET FROM THE South LINE AND 1980 FEET FROM THE West LINE OF SEC. 16 TWP. 21S RGE. 26E NMPM		12. County Eddy	
19. Proposed Depth 11,250'		19A. Formation Morrow	
20. Rotary or C.T. Rotary		21. Elevations (Show whether DF, RT, etc.) To be reported	
21A. Kind & Status Plug. Bond GCA #8		21B. Drilling Contractor Delta Drilling Company	
22. Approx. Date Work will start June 20, 1974			

PROPOSED CASING AND CEMENT PROGRAM

SIZE OF HOLE	SIZE OF CASING	WEIGHT PER FOOT	SETTING DEPTH	SACKS OF CEMENT	EST. TOP
26"	20"	94#	20'	Approx 3 yds	Circ to surface
17-1/2"	13-3/8" OD	48#	500'	800	Circ to surface
12-1/4"	8-5/8" OD	24#	2500'	1500	Circ to surface
7-7/8"	5-1/2" OD	15.5 & 17#	At T.D.	600	Circ to surface

Propose to drill development well and test commercial producing capabilities of Morrow gas zone.

Blowout preventer will be installed above surface pipe, 2 ram and 1 annular type will be used (3000 psi W.P.) & tested daily.

APPROVAL VALID
FOR 90 DAYS UNLESS
DRILLING COMMENCED,

9-25-74

IN ABOVE SPACE DESCRIBE PROPOSED PROGRAM: IF PROPOSAL IS TO DEEPEN OR PLUG BACK, GIVE DATA ON PRESENT PRODUCTIVE ZONE AND PROPOSED NEW PRODUCTIVE ZONE. GIVE BLOWOUT PREVENTER PROGRAM, IF ANY.

I hereby certify that the information above is true and complete to the best of my knowledge and belief.

Signed [Signature] Title Dist. Drlg. Supv. Date 6/14/74

(This space for State Use)

APPROVED BY [Signature] TITLE OIL AND GAS INSPECTOR

CONDITIONS OF APPROVAL, IF ANY:

Cement must be circulated to
surface behind 13 7/8" & 8 7/8" casing

DATE JUN 25 1974
Notify N.M.O.C.C. in sufficient
time to witness cementing
the 8 7/8" casing

**NEW MEXICO OIL CONSERVATION COMMISSION
WELL LOCATION AND ACREAGE DEDICATION PLAT**

Form C-102
Supersedes C-128
Effective 1-1-65

All distances must be from the outer boundaries of the Section.

Operator Atlantic Richfield Company			Lease State BR		Well No. 1
Unit Letter K	Section 16	Township 21S	Range 26E	County Eddy	
Actual Footage Location of Well:					
1980 feet from the South line and		1980 feet from the West line			
Ground Level Elev. 3285.4	Producing Formation Morrow (Gas)	Pool Catclaw Draw		Dedicated Acreage: 640 Acres	

1. Outline the acreage dedicated to the subject well by colored pencil or hachure marks on the plat below.
2. If more than one lease is dedicated to the well, outline each and identify the ownership thereof (both as to working interest and royalty).
3. If more than one lease of different ownership is dedicated to the well, have the interests of all owners been consolidated by communitization, unitization, force-pooling, etc?

☐ Yes ☒ No If answer is "yes," type of consolidation **O. C. C.**
ARTESIAN
 If answer is "no," list the owners and tract descriptions which have actually been consolidated. (Use reverse side of this form if necessary.) Over

No allowable will be assigned to the well until all interests have been consolidated (by communitization, unitization, forced-pooling, or otherwise) or until a non-standard unit, eliminating such interests, has been approved by the Commission.

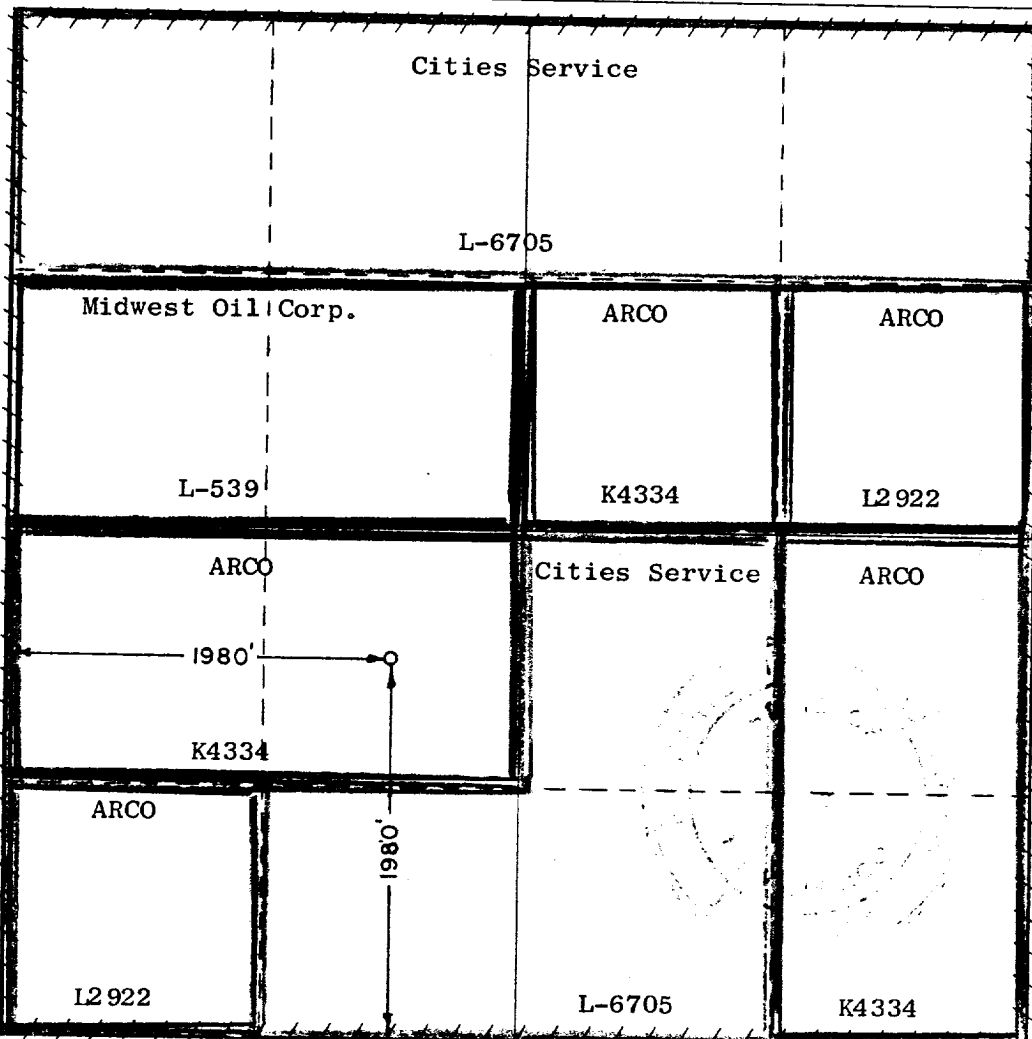

CERTIFICATION

I hereby certify that the information contained herein is true and complete to the best of my knowledge and belief.

Name *H. J. Bernard*
 Position Dist. Drlg. Supv.
 Company Atlantic Richfield Company
 Date 6/13/74

I hereby certify that the well location shown on this plat was plotted from field notes of actual surveys made by me or under my supervision, and that the same is true and correct to the best of my knowledge and belief.

Date Surveyed 6/20/74
 Registered Professional Engineer and/or Land Surveyor

[Signature]
 Certificate No.

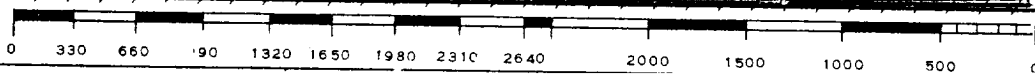

By Operating Agreement, all W.I. Owners in Section 16-T21S-36E, Eddy County, New Mexico have entered into an Operating Agreement w/ARCO named Operator and interest listed as follows:

ARCO	43.75
Cities Service	43.75
Midwest Oil Corp	12.50
	<u>100.00</u>

Upon completion of well, all of Section 16 will be communitized.