

NEW MEXICO OIL CONSERVATION COMMISSION

Form C-101
Revised 1-1-65

NO. OF COPIES RECEIVED	5
DISTRIBUTION	
SANTA FE	1
FILE	1 ✓
U.S.G.S.	2
LAND OFFICE	
OPERATOR	1

RECEIVED

JUL 11 1974

5A. Indicate Type of Lease	STATE <input type="checkbox"/>	FEE <input checked="" type="checkbox"/>
5. State Oil & Gas Lease No.	None	

APPLICATION FOR PERMIT TO DRILL, DEEPEN, OR PLUG BACK

1a. Type of Work		D. C. C. ARTESIA, OFFICE		7. Unit Agreement Name
b. Type of Well		PLUG BACK <input type="checkbox"/>		None
OIL WELL <input type="checkbox"/>	GAS WELL <input checked="" type="checkbox"/>	OTHER <input type="checkbox"/>	SINGLE ZONE <input type="checkbox"/>	MULTIPLE ZONE <input type="checkbox"/>
2. Name of Operator				8. Farm or Lease Name
Southern Union Production Company				Moutray
3. Address of Operator				9. Well No.
1700 Campbell Centre 8350 North Central Expressway Dallas, Texas 75206				1
4. Location of Well				10. Field and Pool, or Wildcat
UNIT LETTER <u>H</u> LOCATED <u>1980</u> FEET FROM THE <u>North</u> LINE				Wildcat
AND <u>660</u> FEET FROM THE <u>East</u> LINE OF SEC. <u>5</u> TWP. <u>20 S</u> RGE. <u>26E</u> NMPM				
				12. County
				Eddy
19. Proposed Depth		19A. Formation		20. Rotary or C.T.
8,000 10,000		Cisco Morrow		Rotary
21. Elevations (Show whether DF, RT, etc.)		21A. Kind & Status Plug. Bond		21B. Drilling Contractor
3269' GL		Blanket		Unknown
		22. Approx. Date Work will start		
		Within 30 days.		

23. PROPOSED CASING AND CEMENT PROGRAM

SIZE OF HOLE	SIZE OF CASING	WEIGHT PER FOOT	SETTING DEPTH	SACKS OF CEMENT	EST. TOP
20"	16"	55#	250'	150	Surface
12 1/4"	8-5/8"	24#	1,550	500	1200' surface
7-7/8"	5-1/2"	17#	10,000	300	7,500

1. Drill to 250'. Set 16" conductor. Circulate cement to surface.
2. Drill to 1,550'. Set 8-5/8" casing. Circulate cmt to 1200'.
3. Drill to 10,000'. Run one drill stem test each in Cisco and Morrow if warranted.
4. If ~~zone~~ one(s) are productive, run 5-1/2" casing, cement as required and complete as per rules and regulations of New Mexico Oil Conservation Commission.

APPROVAL VALID
FOR 90 DAYS UNLESS
DRILLING COMMENCED,

EXPIRES 10-11-74

BOP: Series 900, Double rams, Manifold, and adjustable choke, 3000# WP.

IN ABOVE SPACE DESCRIBE PROPOSED PROGRAM; IF PROPOSAL IS TO DEEPEN OR PLUG BACK, GIVE DATA ON PRESENT PRODUCTIVE ZONE AND PROPOSED NEW PRODUCTIVE ZONE, GIVE SLOWOUT PREVENTER PROGRAM, IF ANY.

I hereby certify that the information above is true and complete to the best of my knowledge and belief.

Signed Neil W. (This space for State Use) Title Manager, Drilling & Production Date June 28, 1974

Neil W. (This space for State Use)

APPROVED BY W. A. Gussert TITLE OIL AND GAS INSPECTOR DATE JUL 11 1974

CONDITIONS OF APPROVAL, IF ANY:

Cement must be circulated to surface behind 16" + 8 5/8" casing

AMENDED COPY

Notify N.M.O.C.C. in sufficient time to witness cementing the 8 5/8" casing

NEW MEXICO OIL CONSERVATION COMMISSION
WELL LOCATION AND ACREAGE DEDICATION PLAT

Form C-102
Supersedes C-128
Effective 1-1-65

All distances must be from the outer boundaries of the Section

Operator SOUTHERN UNION PRODUCTION CO.			Lease MOUTRAY		Well No. 1
Unit Letter H	Section 5	Township 20 SOUTH	Range 26 EAST	County EDDY	
Actual Footage Location of Well: 1980 feet from the NORTH line and 660 feet from the EAST line					
Ground Level Elev. 3269	Producing Formation <i>Penn</i>		Pool <i>Unit 1</i>	Dedicated Acreage: 326.00 Acres	

1. Outline the acreage dedicated to the subject well by colored pencil or hachure marks on the plat below.
2. If more than one lease is dedicated to the well, outline each and identify the ownership thereof (both as to working interest and royalty).
3. If more than one lease of different ownership is dedicated to the well, have the interests of all owners been consolidated by communitization, unitization, force-pooling, etc?

RECEIVED

JUN 20 1974

☐ Yes ☐ No If answer is "yes," type of consolidation _____

If answer is "no," list the owners and tract descriptions which have actually been consolidated (by communitization, unitization, forced-pooling, or otherwise) or until a non-standard unit, eliminating such interests, has been approved by the Commission. **O. C. C. OFFICE**

No allowable will be assigned to the well until all interests have been consolidated (by communitization, unitization, forced-pooling, or otherwise) or until a non-standard unit, eliminating such interests, has been approved by the Commission.

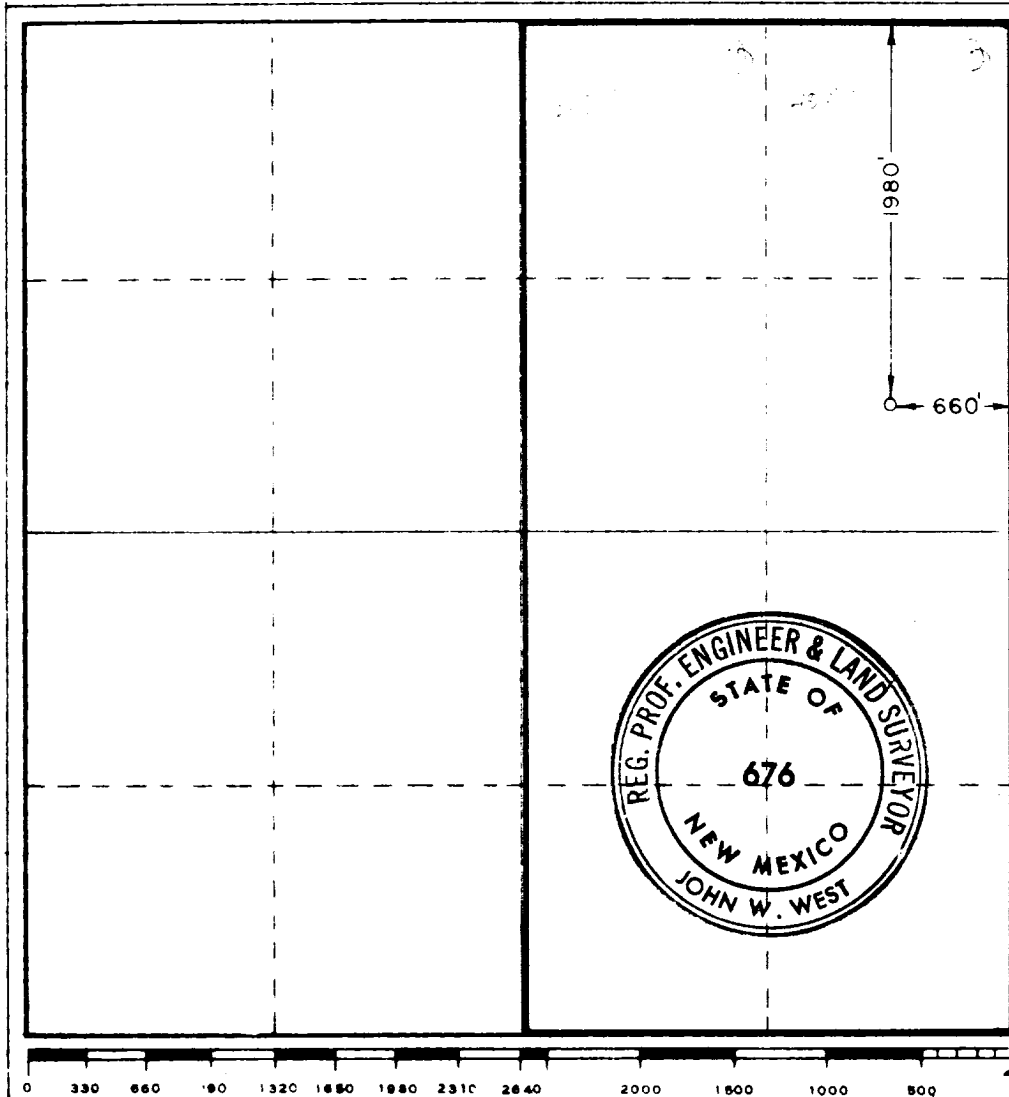

CERTIFICATION

I hereby certify that the information contained herein is true and complete to the best of my knowledge and belief.

Paul H. Hilde
Name
Manager, Drilling & Prod.

Position
Southern Union Production

Company
June 17, 1974

Date

I hereby certify that the well location shown on this plat was plotted from field notes of actual surveys made by me or under my supervision, and that the same is true and correct to the best of my knowledge and belief.

Date Surveyed
JUNE 10, 1974

Registered Professional Engineer and/or Land Surveyor

John W. West
Certificate No. **676**

NO. OF COPIES RECEIVED	
DISTRIBUTION	
SANTA FE	
FILE	
U.S.G.S.	
LAND OFFICE	
OPERATOR	

NEW MEXICO OIL CONSERVATION COMMISSION

RECEIVED

JUN 20 1974

O.C.C.
ARTESIA, OFFICE

30-015-21283

Form C-101
Revised 1-1-65

5A. Indicate Type of Lease	
STATE <input type="checkbox"/>	FEE <input checked="" type="checkbox"/>
5. State Oil & Gas Lease No.	
None	
7. Unit Agreement Name	
None	
8. Farm or Lease Name	
Moutray	
9. Well No.	
1	
10. Field and Pool, or Wildcat	
Wildcat	
12. County	
Eddy	
19. Proposed Depth	19A. Formation
8,000'	Cisco Morrow
10,000'	Rotary
21. Elevations (Show whether DF, RT, etc.)	22. Approx. Date Work will start
3269 GL	Within 30 Days

APPLICATION FOR PERMIT TO DRILL, DEEPEN, OR PLUG BACK

1a. Type of Work	
b. Type of Well	
DRILL <input checked="" type="checkbox"/>	DEEPEN <input type="checkbox"/>
OIL WELL <input type="checkbox"/>	GAS WELL <input type="checkbox"/>
OTHER <input type="checkbox"/>	PLUG BACK <input type="checkbox"/>
New Well	
2. Name of Operator	
Southern Union Production Company	
3. Address of Operator	
1700 Campbell Centre	
8350 North Central Expressway Dallas, Texas 75206	
4. Location of Well	
UNIT LETTER	LOCATED
H	1980
FEET FROM THE	
North	
AND	LINE
660	5
FEET FROM THE	TWP.
East	20S
LINE OF SEC.	RGE.
5	26E
NMPM	
19. Proposed Depth	
8,000'	
10,000'	
19A. Formation	
Cisco Morrow	
20. Rotary or C.T.	
Rotary	
21. Elevations (Show whether DF, RT, etc.)	
3269 GL	
21A. Kind & Status Plug. Bond	
Blanket	
21B. Drilling Contractor	
Unknown	
22. Approx. Date Work will start	
Within 30 Days	

23.

PROPOSED CASING AND CEMENT PROGRAM

SIZE OF HOLE	SIZE OF CASING	WEIGHT PER FOOT	SETTING DEPTH	SACKS OF CEMENT	EST. TOP
12 1/2"	8-5/8"	24#	1,550	500	Surface
7-7/8"	5 1/2"	17#	10,000	300	7,500

1. Drill to 1,550'. Set 8-5/8" casing. Circulate cement to surface.
2. Drill to 10,000'. Run one drill stem test each in Cisco and Morrow if warranted.
3. If zone(s) are productive, run 5 1/2" casing, cement as required, and complete as per rules and regulations of New Mexico Oil Conservation Commission.

BOP: Series 900, Double Rams, Manifold, and Adjustable Choke, 3000# WP.

IN ABOVE SPACE DESCRIBE PROPOSED PROGRAM: IF PROPOSAL IS TO DEEPEN OR PLUG BACK, GIVE DATA ON PRESENT PRODUCTIVE ZONE AND PROPOSED NEW PRODUCTIVE ZONE. GIVE BLOWOUT PREVENTER PROGRAM, IF ANY.

I hereby certify that the information above is true and complete to the best of my knowledge and belief.

Signed Paul H. Hark Title Manager, Drilling & Production Date June 17, 1974
(This space for State Use)

APPROVED BY _____ TITLE _____ DATE JUL 11 1974

CONDITIONS OF APPROVAL, IF ANY:

Cement must be circulated to surface behind 16" 4 5/8" casing

Notify N.M.O.C.C. in sufficient time to witness cementing
" 8 7/8"