

DEPARTMENT OF THE INTERIOR
GEOLOGICAL SURVEY

APPLICATION FOR PERMIT TO DRILL, DEEPEN, OR PLUG BACK

1a. TYPE OF WORK

DRILL ☐

DEEPEN ☐

PLUG BACK ☒

b. TYPE OF WELL

OIL WELL ☐

GAS WELL ☒

OTHER

SINGLE ZONE ☒

MULTIPLE ZONE ☐

2. NAME OF OPERATOR

Cities Service Oil Company

3. ADDRESS OF OPERATOR

Box 1919 - Midland, Texas 79701

MAR 30 1976

4. LOCATION OF WELL (Report location clearly and in accordance with any State requirements.)*

At surface

1980' FNL & 1980' FEL of Sec. 15-T20S-R28E, Eddy Co., New Mexico
At proposed prod. zone
Same as above

14. DISTANCE IN MILES AND DIRECTION FROM NEAREST TOWN OR POST OFFICE*

16 miles NE of Carlsbad, New Mexico

15. DISTANCE FROM PROPOSED*

LOCATION TO NEAREST PROPERTY OR LEASE LINE, FT.
(Also to nearest drlg. unit line, if any)

660' S

16. NO. OF ACRES IN LEASE

320 acres

17. NO. OF ACRES ASSIGNED TO THIS WELL

320 acres

18. DISTANCE FROM PROPOSED LOCATION* TO NEAREST WELL, DRILLING, COMPLETED, OR APPLIED FOR, ON THIS LEASE, FT.

4129' NE

19. PROPOSED DEPTH

9205'

20. ROTARY OR CABLE TOOLS

Workover Unit

21. ELEVATIONS (Show whether DF, RT, GR, etc.)

3265' DF

22. APPROX. DATE WORK WILL START*

March 29, 1976

23.

PROPOSED CASING AND CEMENTING PROGRAM

SIZE OF HOLE	SIZE OF CASING	WEIGHT PER FOOT	SETTING DEPTH	QUANTITY OF CEMENT
12 1/2"	12 1/2"	48	610	625
12 1/2"	12 1/2"	36	3000	1725
12 1/2"	12 1/2"	11420	11486	9000

O.T.D. 11486' Shale OPBTD 11467'. We propose to plug back and recomple in the Wolfcamp formation in the following manner:

1. MIRU completion unit, release Baker Lok-set packer set @ 10865' and pull tubing and packer.
2. Set a CIBP @ approx. 10800' and dump 4 sacks of cement of top of CIBP @ approx. 10800 - 10765'.
3. Perforate the Wolfcamp zone w/2 shot per ft. @ approx. 9123', 9127', 9136', 9138', 9146', 9148', 9176', 9178', 9180', 9203' and 9205'.
4. Run 2-7/8" OD tubing with a Baker Lok-set packer set @ approx. 9000'.
5. Test the well naturally, acidize if necessary and place well on production.

IN ABOVE SPACE DESCRIBE PROPOSED PROGRAM: If proposal is to deepen or plug back, give data on present productive zone and proposed new productive zone. If proposal is to drill or deepen directionally, give pertinent data on subsurface locations and measured and true vertical depths. Give blowout preventer program, if any.

24.

SIGNED

E. Spindler

TITLE

Region Operation Manager

DATE

March 23, 1976

(This space for Federal or State office use)

PERMIT NO.

APPROVAL DATE

MAR 26 1976

APPROVED BY

James R. ...

TITLE

DISTRICT ENGINEER

DATE

CONDITIONS OF APPROVAL, IF ANY:

WELL LOCATION AND ACREAGE DEDICATION PLAT

 FORM C-102
 Supersedes C-128
 Effective 1-1-65

All distances must be from the outer boundaries of the Section

Operator CITIES SERVICE OIL COMPANY			Lease GOVERNMENT T Com.		Well No. 2
Unit Letter G	Section 15	Township 20 SOUTH	Range 28 EAST	County EDDY	
Actual Footage Location of Well:					
1980		feet from the	NORTH	line and	1980
				feet from the	EAST
Ground Level Elev. 3247'		Producing Formation Wolfcamp		Pool Und. N. Burton Flats Wolfcamp	Dedicated Acreage: 320 Acres

1. Outline the acreage dedicated to the subject well by colored pencil or hatchure marks on the plat below.
2. If more than one lease is dedicated to the well, outline each and identify the ownership thereof (both as to working interest and royalty).
3. If more than one lease of different ownership is dedicated to the well, have the interests of all owners been consolidated by communitization, unitization, force-pooling, etc?

☒ Yes ☐ No If answer is "yes," type of consolidation Unitization (see reverse side)

If answer is "no," list the owners and tract descriptions which have actually been consolidated. (Use reverse side of this form if necessary.)

No allowable will be assigned to the well until all interests have been consolidated (by communitization, unitization, forced-pooling, or otherwise) or until a non-standard unit, eliminating such interests, has been approved by the Commission.

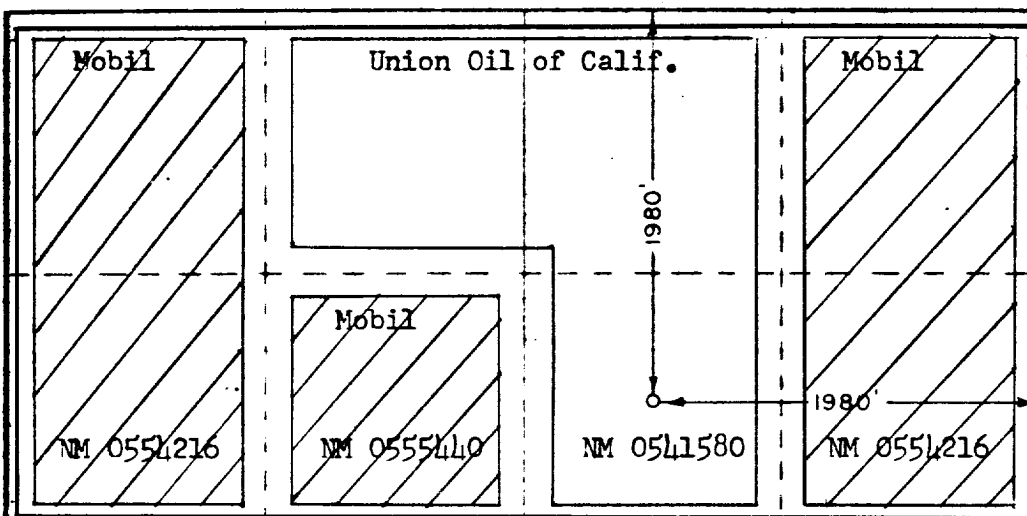

Unit block consists of 2560 acres. Working interests of participating companies are as follows:

Cities Service Oil	37.21767%
Mobil Oil Corp.	22.22222%
Superior Oil	16.29971%
Union Oil of Calif.	6.51990%
Flag-Redfern Oil	4.07492%
Great Western Drlg.	3.25995%
Gulf Oil Corp.	2.44495%
Monsanto Co.	2.44495%
Joseph Dunigan	1.98413%
Ed R. Hudson, Jr.	1.90163%
R.B. & S.A. Johnson	1.62997%
	100.00000%

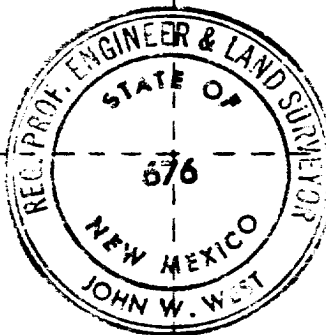

CERTIFICATE RECEIVED

 I hereby certify that the information contained herein is true and complete to the best of my knowledge and belief.
 MAR 24 1976
 U. S. GEOLOGICAL SURVEY
 ARTESIA, NEW MEXICO

 Name E. J. Miller
 Position Region Operation Manager
 Company Cities Service Oil Company
 Date March 23, 1976

I hereby certify that the well location shown on this plat was plotted from field notes of actual surveys made by me or under my supervision, and that the same is true and correct to the best of my knowledge and belief.

 Date Surveyed AUGUST 8, 1974

Registered Professional Engineer and/or Land Surveyor

John W. West
 Certificate No. 676

0 330 660 990 1320 1650 1980 2310 2640 2970 3300 3630 3960 4290 4620 4950 5280 5610 5940 6270 6600

*Howard
Loring
1/8 Interest*

T
20
S

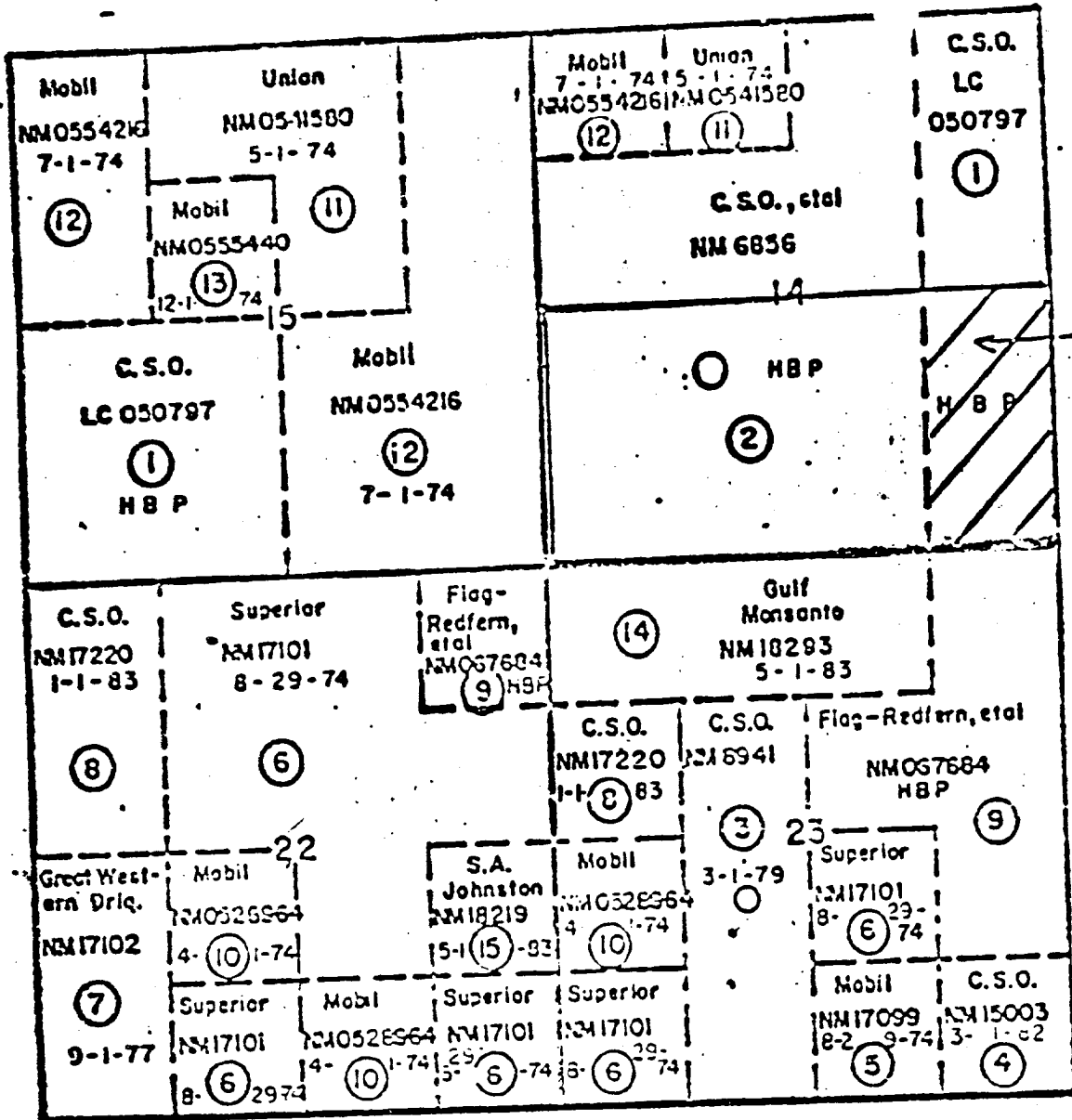

EXHIBIT "A" PART III

O/A DATED JUNE 11, 1973

(2) Tract Number

Eddy County, New Mexico
Scale: 1" = 2000'