

UNITED STATES
DEPARTMENT OF THE INTERIOR
GEOLOGICAL SURVEY(Other instructions on
reverse side)

5. LEASE DESIGNATION AND SERIAL NO.

NM 011234

6. IF INDIAN, ALLOTTEE OR TRIBE NAME

7. UNIT AGREEMENT NAME

8. FARM OR LEASE NAME

ROUND MOUNTAIN

9. WELL NO.

1

10. FIELD AND POOL, OR WILDCAT

WILDCAT

11. SEC., T., R., M., OR BLK.
AND SURVEY OR AREA

Sec. 28, T-21S, R-25E

12. COUNTY OR PARISH

Eddy

13. STATE

New Mexico

APPLICATION FOR PERMIT TO DRILL, DEEPEN, OR PLUG BACK

1a. TYPE OF WORK

DRILL ☒DEEPEN ☐PLUG BACK ☐

b. TYPE OF WELL

OIL
WELL ☐GAS
WELL ☒

OTHER

SINGLE
ZONE ☐MULTIPLE
ZONE ☐

2. NAME OF OPERATOR

MONSANTO COMPANY

3. ADDRESS OF OPERATOR

101 North Marienfeld, Midland, Texas 79701

4. LOCATION OF WELL (Report location clearly and in accordance with any State requirements.)*

At surface

1980' FNL & 1980' FWL Sec. 28

At proposed prod. zone

14. DISTANCE IN MILES AND DIRECTION FROM NEAREST TOWN OR POST OFFICE*

8 Miles West of Carlsbad, New Mexico

15. DISTANCE FROM PROPOSED*

LOCATION TO NEAREST
PROPERTY OR LEASE LINE, FT.
(Also to nearest drlg. unit line, if any)

1980'

16. NO. OF ACRES IN LEASE

1240

17. NO. OF ACRES ASSIGNED
TO THIS WELL

640

18. DISTANCE FROM PROPOSED LOCATION*

TO NEAREST WELL, DRILLING, COMPLETED,
OR APPLIED FOR, ON THIS LEASE, FT.

None

19. PROPOSED DEPTH

10,700'

20. ROTARY OR CABLE TOOLS

Rotary

21. ELEVATIONS (Show whether DF, RT, GR, etc.)

3528 Gr.

22. APPROX. DATE WORK WILL START*

8/6/74

23.

PROPOSED CASING AND CEMENTING PROGRAM

SIZE OF HOLE	SIZE OF CASING	WEIGHT PER FOOT	SETTING DEPTH	QUANTITY OF CEMENT
17 1/2"	13 3/8"	48#	400'	500 Sx. (Circulated)
12 1/4"	9 5/8"	36#	2500'	1000 Sx. (Circulated)

Drill 17 1/2" hole to 400'; Set 13 3/8" Csg & cement to surface.

Drill 12 1/4" hole to 2500'; Set 9 5/8" Csg & cement to surface.

Drill 8 3/4" hole to 10,700' & log.

If production is indicated, set 5 1/2" Csg & cement.

Perforate & treat if necessary.

BOP Series 1500 double hydraulic w/ Series 900 annular preventer.

RECEIVED
JUL 28 1974
U.S. GEOLOGICAL SURVEY
ARTESIA, NEW MEXICO

IN ABOVE SPACE DESCRIBE PROPOSED PROGRAM: If proposal is to deepen or plug back, give data on present productive zone and proposed new productive zone. If proposal is to drill or deepen directionally, give pertinent data on subsurface locations and measured and true vertical depths. Give blowout preventer program, if any.

24.

SIGNED

[Signature]

TITLE Dist. Prod. Mgr.

DATE 7/26/74

(This space for Federal or State office use)

SUBJECT TO ATTACHED DEEP WELL CONTROL

REQUIREMENTS DATED JUN 22 1973

NOTIFY USGS IN SUFFICIENT TIME TO
DATE
WITNESS CEMENTING THE
CASINDECLARED WATER BASIN
CEMENT BEHIND THE
CASING MUST BE CIRCULATEDAPPROVED
AUG 1 1974
R. L. BEEKMAN
ACTING DISTRICT ENGINEERTHIS APPROVAL IS RESCINDED IF OPERATIONS
ARE NOT COMMENCED WITHIN 3 MONTHS
EXPIRES NOV 12 1974

NEW MEXICO OIL CONSERVATION COMMISSION
WELL LOCATION AND ACREAGE DEDICATION PLAT

Form C-102
Supersedes C-128
Effective 1-1-55

All distances must be from the outer boundaries of the Section.

Operator MONSANTO COMPANY			Lease Round Mtn.		Well No. # 1
Unit Letter F	Section 28	Township 21-S	Range 25 E	County EDDY	
Actual Footage Location of Well:					
1980 feet from the NORTH line and		1980 feet from the WEST line			
Ground Level Elev. 3528'	Producing Formation Morrow	Pool Undesignated		Dedicated Acreage: 2.20 640- Acres	

1. Outline the acreage dedicated to the subject well by colored pencil or hachure marks on the plat below.
2. If more than one lease is dedicated to the well, outline each and identify the ownership thereof (both as to working interest and royalty).
3. If more than one lease of different ownership is dedicated to the well, have the interests of all owners been consolidated by communitization, unitization, force-pooling, etc?

☐ Yes ☐ No If answer is "yes," type of consolidation _____

If answer is "no," list the owners and tract descriptions which have actually been consolidated. (Use reverse side of this form if necessary.) _____

No allowable will be assigned to the well until all interests have been consolidated (by communitization, unitization, forced-pooling, or otherwise) or until a non-standard unit, eliminating such interests, has been approved by the Commission.

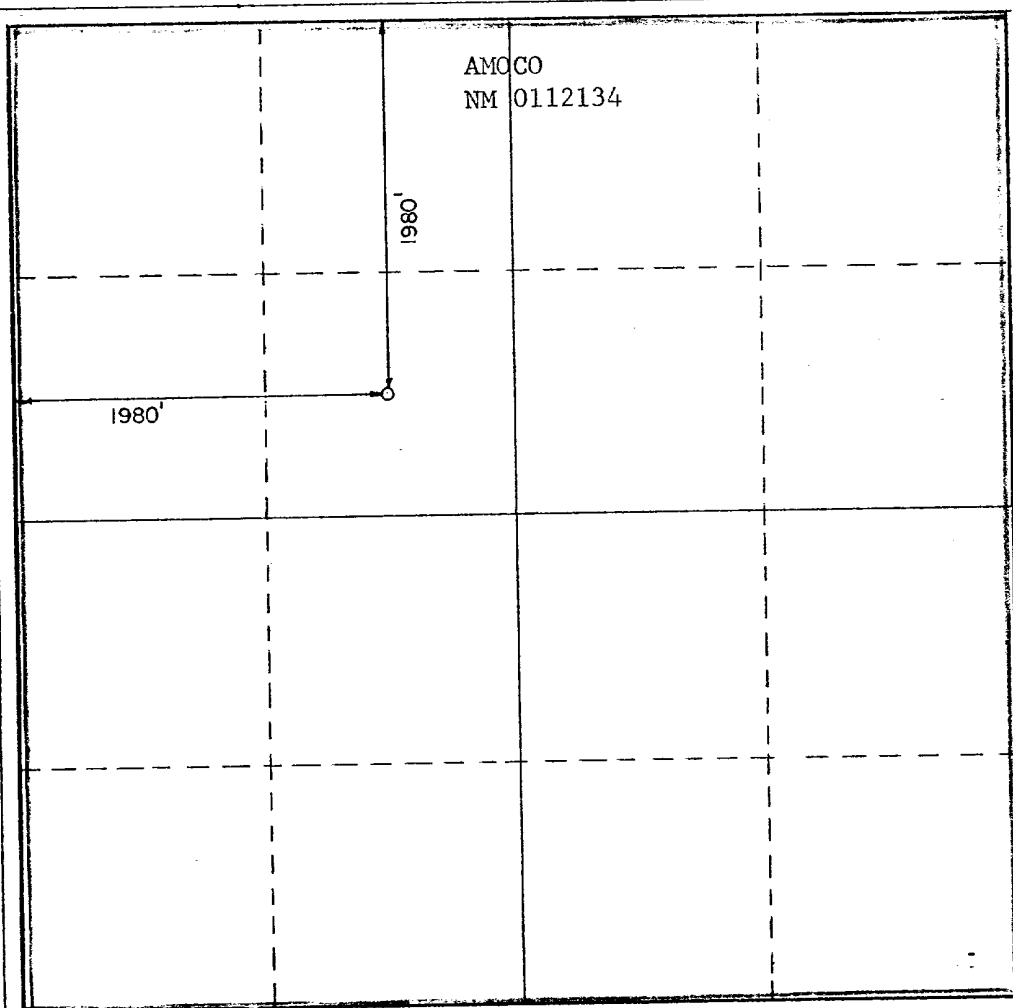

CERTIFICATION

I hereby certify that the information contained herein is true and complete to the best of my knowledge and belief.

Name
E. M. Scholl
Position
Dist. Production Mgr.
Company
MONSANTO COMPANY

Date
July 26, 1974

I hereby certify that the well location shown on this plat was plotted from field notes of actual surveys made by me or under my supervision, and that the same is true and correct to the best of my knowledge and belief.

RECEIVED
U.S. GEOLOGICAL SURVEY
ARTESIA, NEW MEXICO

Date Surveyed
July 24, 1974
Registered Professional Engineer and/or Land Surveyor
Richard B. Quinn

4882

Certificate No.

0 330 660 990 1320 1650 1980 2310 2640 2000 1500 1000 500 0

Monsanto

Monsanto Company
317 First Savings & Loan Building
101 North Marienfeld
Midland, Texas 79701
Phone: (915) 683-3306

July 26, 1974

United States Geological Survey
Drawer U
Artesia, New Mexico 88210

Attn: Mr. James Knauf

RE: Round Mountain Well No. 1
Sec. 28, T-21S, R-28E
Eddy County, New Mexico

Gentlemen:

Monsanto Company respectfully submits the following Development Plan for drilling the above captioned well.

Development Plans include the following:

1. Existing roads: See attachment.
2. Planned access roads: See attachment (20' wide).
3. Location of Well: 1980' FWL, 1980' FNL
Sec. 28, T-21S, R-28E
4. Lateral Road: See attachment.
5. Location of Tank Battery:

If the well is gas productive, a heater and three phase separator will be installed on the southwest corner of the pad with two 200 barrels collection tanks for water and condensate respectively. Pipeline location is not known at this time.

6. Location and type of water supply:

Water will be purchased as near as possible and trucked to location.

RECEIVED
U. S. GEOLOGICAL SURVEY
ARTESIA, NEW MEXICO

July 26, 1974

7. Method of waste disposal:

A burn pit will be used to dispose of combustible materials. Non-combustible materials will be buried at least 24" below the surface of the ground.

8. Location of camps: None

9. Location of air strips: None

10. Location of rig: See attachment

11. Plans for restoration:

Pits will be leveled and land returned as near as possible to original condition.

12. Other - Attached mud program and BOP description. After setting the 9 5/8" casing string and before drilling into the Wolfcamp formation, the blowout preventers and related control equipment will be pressure tested to rated working pressures by an independent service company. Any equipment failing to test satisfactorily shall be repaired or replaced.

Monsanto Company respectfully requests that this plan of development be approved. Please advise if you require any additional information.

Yours very truly,



E. M. Scholl

District Production Manager

EMS:HW:mm

Encl.

ROUND MOUNTAIN WELL NO. 1

MUD PROGRAM

Surface:	<u>0 - 400'</u> Fresh water gel/lime slurry
Intermediate:	<u>400' - 2500'</u> Fresh water with L.C.M. for seepage if required.
Production:	<u>2500' - T.D.</u> Fresh water to 7500'. At 7500' mud up with low solids, non-dispersed fresh water system. Weight and viscosity will be adjusted to contain the forma- tion fluids. The water loss will be decreased to 5 c.c. or less before drilling the Morrow.

20'

R.26 E.

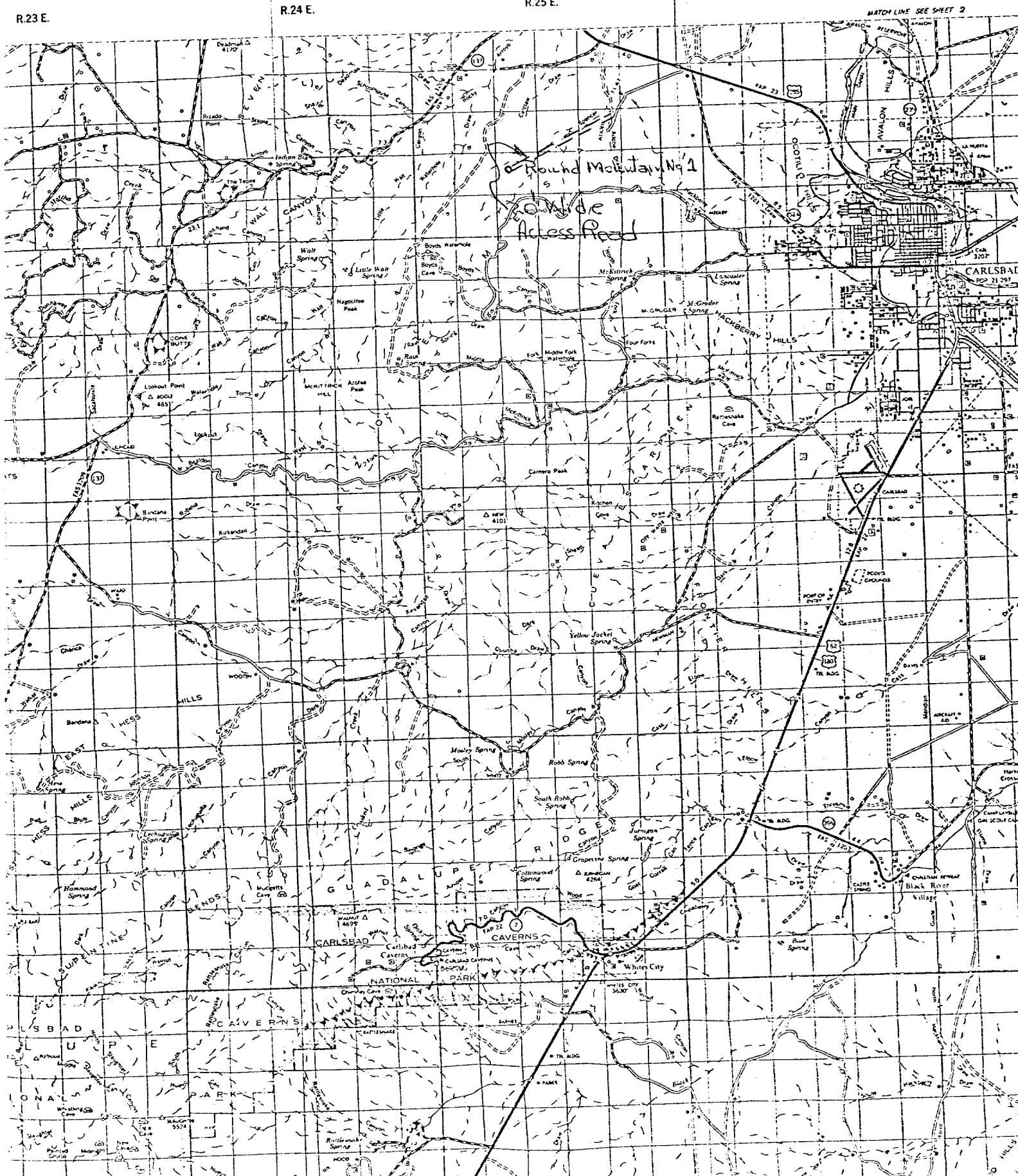

THE BLOWOUT PREVENTER STACK

5,000 psi Working Pressure

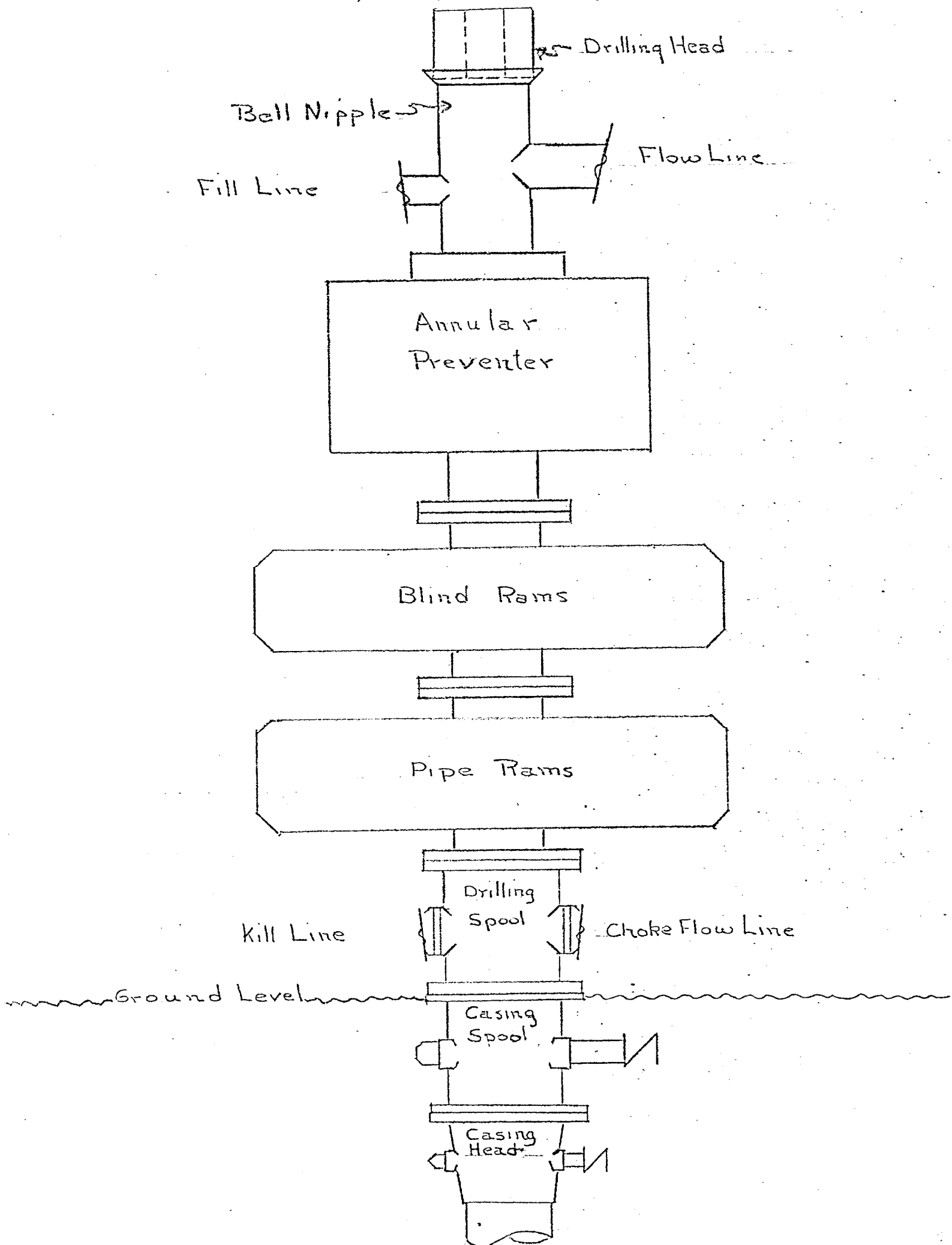

Manifold Diagram

