

UNITED STATES
DEPARTMENT OF THE INTERIOR

BUREAU OF LAND MANAGEMENT 300152133700S01

APPLICATION FOR PERMIT TO DRILL, DEEPEN, OR PLUG BACK

1a. TYPE OF WORK

DRILL ☐

DEEPEN ☐

PLUG BACK ☒

b. TYPE OF WELL

OIL
WELL ☐

GAS
WELL ☒

OTHER ☐

SINGLE
ZONE ☒

MULTIPLE
ZONES ☐

2. NAME OF OPERATOR

OXY USA Inc.

3. ADDRESS OF OPERATOR

P.O. Box 50250 Midland, TX. 79710

4. LOCATION OF WELL (Report location clearly and in accordance with any State requirements.)

At surface

1880 FSL 1780 FWL Sec 21 T21S R27E

At proposed prod. zone

14. DISTANCE IN MILES AND DIRECTION FROM NEAREST TOWN OR POST OFFICE*

2 1/2 mi NE of Carlsbad, NM

16. DISTANCE FROM PROPOSED*

LOCATION TO NEAREST
PROPERTY OR LEASE LINE, FT.
(Also to nearest drlg. unit line, if any)

1780

16. NO. OF ACRES IN LEASE

320

17. NO. OF ACRES ASSIGNED
TO THIS WELL

320

18. DISTANCE FROM PROPOSED LOCATION*

TO NEAREST WELL, DRILLING, COMPLETED,
OR APPLIED FOR, ON THIS LEASE, FT.

N/A

19. PROPOSED DEPTH

10900'

20. ROTARY OR CABLE TOOLS

21. ELEVATIONS (Show whether DF, RT, GR, etc.)

3192'

22. APPROX. DATE WORK WILL START*

ASAP

23.

PROPOSED CASING AND CEMENTING PROGRAM

SIZE OF HOLE	SIZE OF CASING	WEIGHT PER FOOT	SETTING DEPTH	QUANTITY OF CEMENT
26"	20"	94-104#	394'	780
17 1/2"	13 3/8"	48-54.5#	1654'	2675
12 1/4"	9 5/8"	32-36-40#	3005'	1475
8 3/4"	5 1/2"	17-20#	11742'	1100

TD - 11742' PBTD - 11705' Morrow Perfs - 11113'-11684'

It is proposed to plug off the Morrow perfs & test the Atoka in the following manner:

SEE OTHER SIDE

RECEIVED
JAN 11 11 40 AM '92
CARLSBAD AREA

IN ABOVE SPACE DESCRIBE PROPOSED PROGRAM: If proposal is to deepen or plug back, give data on present productive zone and proposed new productive zone. If proposal is to drill or deepen directionally, give pertinent data on subsurface locations and measured and true vertical depths. Give blowout preventer program, if any.

24.

SIGNED

[Signature]

TITLE

Production Accountant

DATE

1/13/92

(This space for Federal or State office use)

PERMIT NO.

APPROVAL DATE

APPROVED BY

[Signature]

TITLE

DATE

3/2/92

CONDITIONS OF APPROVAL, IF ANY:

*See Instructions On Reverse Side

- 1.) MIRU PU. Kill well w/ produced water. ND WH, NU BOP. Release packer and TOOH w/ 2 7/8" tbg and Baker Lok-Set pkr.
- 2.) RU wireline and set 5 1/2" CIBP @ 11080'. Dump 4 sx cmt (42') on top of CIBP. TIH w/ 2 7/8" 6.5# N-80 tbg to 11000'. Circ hole w/ 10# brine water. TOOH w/ tbg.
- 3.) RU perforators, perforate Atoka formation (10560' - 10895') w/ a 4" csg gun using premium shots 2 JSPF at the following depths: 10560', 61', 62', 63', 64', 65', 66', 67', 68', 69', 11709', 10', 11', 81', 82', 83', 84', 85', 86', 87', 88', 89', 90', 10888', 89', 90', 91', 92', 93', 94', 10895'. Total of 62 holes. Depth reference log Schlumberger Compensated Neutron - Formation Density Log dated October 14, 1974.
- 4.) TIH w/ 2 3/8" mule shoed tbg sub, 5 1/2" Baker Lok-Set pkr, on-off tool w/ 1.87" profile nipple, and quick flow disk on the 2 7/8" tbg. Set pkr @ $\pm 10450'$. Drop bar and shear quick flow disk. Test well natural.
- 5.) If necessary, acidize Atoka formation (10560' - 10895') w/ 6000 gals 7.5% Ne Fe HCl containing 1000 SCF N₂ per bbl and 60 - 7/8" RCNBS at 5 BPM (liquid rate). Flush w/ 2% KCl water containing 1000 SCF N₂ per bbl. Flow back and recover load. Test well.
- 6.) SI well for 72 hours. RU wireline and set tandem BHP bombs w/ 6000# elements and 24 day clocks in profile nipple. Run 4-pt test.
- 7.) RU wireline and set blanking plug in profile nipple. Release on-off tool and circ hole w/ 2% KCl water containing 3 gals per thousand Unichem Techni-hib 370 pkr fluid (or equivalent). Latch onto pkr w/ on-off tool. Pressure test tubing to 3000#. RU wireline and retrieve blanking plug. Put well on production.

Submit to Appropriate
District Office
State Lease - 4 copies
Fee Lease - 3 copies

State of New Mexico
Energy, Minerals and Natural Resources Department

Form C-102
Revised 1-1-89

OIL CONSERVATION DIVISION

P.O. Box 2088
Santa Fe, New Mexico 87504-2088

DISTRICT I
P.O. Box 1980, Hobbs, NM 88240

DISTRICT II
P.O. Drawer DD, Artesia, NM 88210

DISTRICT III
1000 Rio Brazos Rd., Aztec, NM 87410

WELL LOCATION AND ACREAGE DEDICATION PLAT

All Distances must be from the outer boundaries of the section

Operator OXY USA Inc.			Lease Elizondo A Federal		Well No. 2Y
Unit Letter K	Section 21	Township 21S	Range 27E	County Eddy	
Actual Footage Location of Well: 1880 feet from the South line and 1780 feet from the West line					
Ground level Elev. 3192'		Producing Formation Atoka		Pool Burton Flat	Dedicated Acreage: 320 Acres

1. Outline the acreage dedicated to the subject well by colored pencil or hatchure marks on the plat below.
2. If more than one lease is dedicated to the well, outline each and identify the ownership thereof (both as to working interest and royalty).
3. If more than one lease of different ownership is dedicated to the well, have the interest of all owners been consolidated by communitization, unitization, force-pooling, etc?
☐ Yes ☐ No If answer is "yes" type of consolidation _____
If answer is "no" list the owners and tract descriptions which have actually been consolidated. (Use reverse side of this form if necessary). _____
No allowable will be assigned to the well until all interests have been consolidated (by communitization, unitization, forced-pooling, or otherwise) or until a non-standard unit, eliminating such interest, has been approved by the Division.

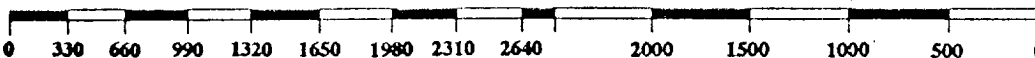
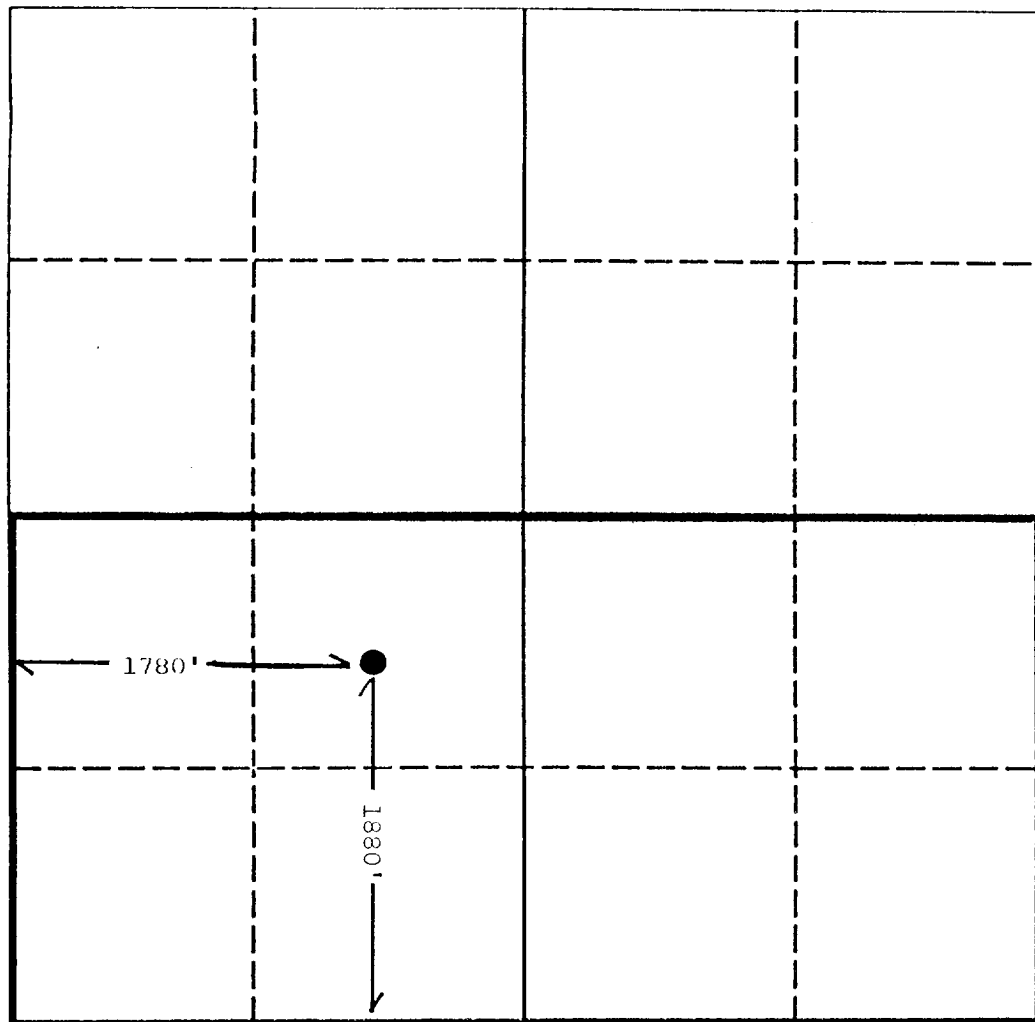

OPERATOR CERTIFICATION

I hereby certify that the information contained herein is true and complete to the best of my knowledge and belief.

Signature
Printed Name
David Stewart
Position
Prod. Acct.
Company
OXY USA Inc.
Date
1/13/92

SURVEYOR CERTIFICATION

I hereby certify that the well location shown on this plat was plotted from field notes of actual surveys made by me or under my supervision, and that the same is true and correct to the best of my knowledge and belief.

Date Surveyed
Signature & Seal of Professional Surveyor
Certificate No.