

UNITED STATES  
DEPARTMENT OF THE INTERIOR  
GEOLOGICAL SURVEY

30-015-21377

## APPLICATION FOR PERMIT TO DRILL, DEEPEN, OR PLUG BACK

## 1a. TYPE OF WORK

DRILL ☒RECEIVED  
OCT 8 1974DEEPEND ☒ PLUG BACK ☐

## b. TYPE OF WELL

OIL WELL ☐GAS WELL ☒OTHER ☐SINGLE ZONE ☐MULTIPLE ZONE ☐

## 2. NAME OF OPERATOR

C &amp; K Petroleum, Inc. ✓

## 3. ADDRESS OF OPERATOR

607 Midland National Bank Bldg., Midland, Texas 79701

## 4. LOCATION OF WELL (Report location clearly and in accordance with any State requirements.)\*

At surface

2250' FN and 990' FE Lines, Sec. 29, T-22-S, R-26-E

At proposed prod. zone  
Eddy County, New Mexico

## 11. DISTANCE IN MILES AND DIRECTION FROM NEAREST TOWN OR POST OFFICE\*

4 miles Southwest, Carlsbad, N.M.

## 13. DISTANCE FROM PROPOSED\*

LOCATION TO NEAREST  
PROPERTY OR LEASE LINE, FT.  
(Also to nearest drlg. unit line, if any)

660'

## 16. NO. OF ACRES IN LEASE

320

## 17. NO. OF ACRES ASSIGNED

TO THIS WELL  
32018. DISTANCE FROM PROPOSED LOCATION\*  
TO NEAREST WELL, DRILLING, COMPLETED,  
OR APPLIED FOR, ON THIS LEASE, FT.

Initial Well

## 19. PROPOSED DEPTH

12000'

## 20. ROTARY OR CABLE TOOLS

Rotary

## 21. ELEVATIONS (Show whether DF, RT, GR, etc.)

3769.7

## 22. APPROX. DATE WORK WILL START\*

Upon Approval

## 23.

## PROPOSED CASING AND CEMENTING PROGRAM

SIZE OF HOLE	SIZE OF CASING	WEIGHT PER FOOT	SETTING DEPTH	QUANTITY OF CEMENT
	20'	Conductor Pipe	30'	4 yd. Remix
17"	13-3/8"	68#	1300'	1200 sx. to be circ.
12-1/4"	9-5/8"	36# & 40#	5400'	1800 sx. to be circ.
7-7/8"	5-1/2"	17# & 20#	12000'	400 sx.

Proposed Program: We will drill well with a spudder to a depth to adequately test the Capitain Reef. Estimated depth 500'. Operations will probably be suspended for a short time at this point. We will then replace the spudder with a Rotary Rig and proceed to drill well to 12,000' or to a depth to adequately test the Morrow formation. A detailed mud program, blowout preventer sketch and location plats are attached. The blowout preventer equipment will be Yellow Jacketed before drilling out of the Permian. In addition the blowout equipment will be tested weekly.

NOTE: This amended application is to replace our amended application dated Sept. 19, 1974.

IN ABOVE SPACE DESCRIBE PROPOSED PROGRAM: If proposal is to deepen or plug back, give data on present productive zone and proposed new productive zone. If proposal is to drill or deepen directionally, give pertinent data on subsurface locations and measured and true vertical depths. Give blowout preventer program, if any.

## 24.

SIGNED

TITLE Administrative Supervisor

DATE 10-3-74

(This space for Federal or State office use)

PERMIT NO.

APPROVAL DATE

TITLE

DATE

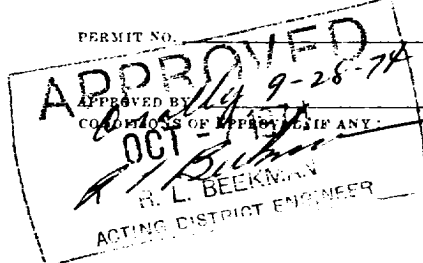

\*See Instructions On Reverse Side

NOTE: This is to amend well location indicated on our Form C-102 dated Sept. 13, 1974

NEW MEXICO OIL CONSERVATION COMMISSION  
WELL LOCATION AND ACREAGE DEDICATION PLAT

Form C-102  
Supersedes C-102A  
Effective 1-1-75

All distances must be from the outer boundaries of the Section

Lessor <b>C&amp;K PETROLEUM, INC.</b>		Lessee <b>WEST AIRPORT FED. COM.</b>		Well No. <b>1</b>
Section <b>H</b>	Section <b>29</b>	Township <b>22 SOUTH</b>	Range <b>26 EAST</b>	County <b>EDDY</b>
Acreage Location of Well: <b>2250</b> feet from the <b>NORTH</b> line and <b>990</b> feet from the <b>EAST</b> line.				
Ground Elev. <b>3709.9</b>	Producing Formation <b>Morrow</b>	Pool <b>Wildcat</b>	Estimated Acreage <b>320</b>	

1. Outline the acreage dedicated to the subject well by colored pencil or hatchure marks on the plat below.
2. If more than one lease is dedicated to the well, outline each and identify the ownership thereof (both as to working interest and royalty).
3. If more than one lease of different ownership is dedicated to the well, have the interests of all owners been consolidated by communitization, unitization, force-pooling, etc?

Yes ☒ No ☐ If answer is "yes," type of consolidation **\*Will be communitized or unitized if productive.**

If answer is "no," list the owners and tract descriptions which have actually been consolidated. (Use reverse side of this form if necessary.) **See reverse side of form.**

No allowable will be assigned to the well until all interests have been consolidated (by communitization, unitization, forced-pooling, or otherwise) or until a non-standard unit, eliminating such interests, has been approved by the Commission.

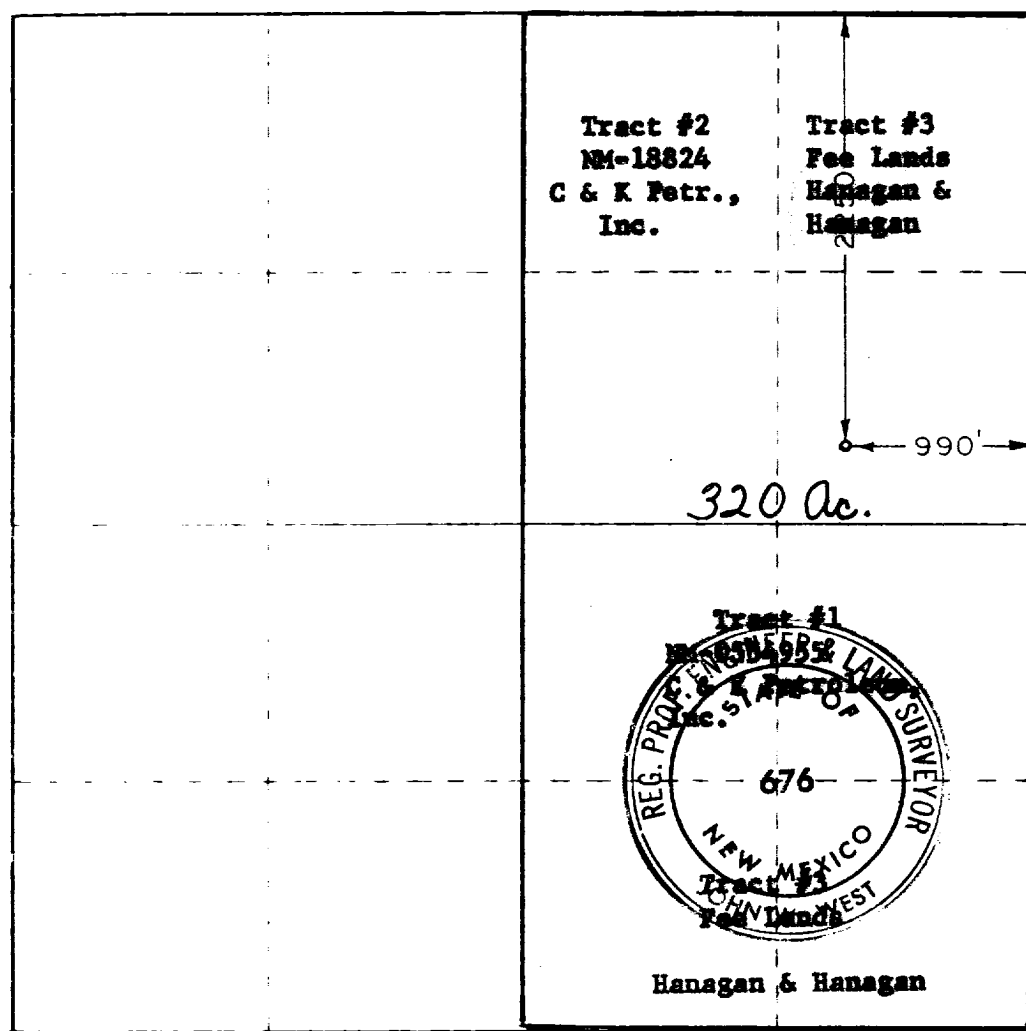

CERTIFICATION

I hereby certify that the information contained herein is true and complete to the best of my knowledge and belief.

Name  
**D. E. Cooper**  
Position  
**Administrative Supervisor**  
Company  
**C & K Petroleum, Inc.**

Date  
**September 26, 1974**

I hereby certify that the well location shown on this plat was plotted from field notes of actual surveys made by me or under my supervision, and the same is true and correct to the best of my knowledge.

Date Surveyed  
**SEPTEMBER 12, 1974**

Registered Professional Engineer and Land Surveyor

*John W. West*  
Certificate No. **676**

• Tract #1 - 37.50%

NM 0554955 - 120 ac. - SE/4 NE/4 & N/2 SE/4, Sec. 29, T-22-S, R-26-E, Eddy Co., N.M.  
WI - 100% C & K Petroleum, Inc.  
RI - Federal Lands

0 Tract #2 - 25.00%

NM 18824 - 80 ac. - W/2 NE/4, Sec. 29, T-22-S, R-26-E, Eddy Co., New Mexico  
WI - C & K Petroleum, Inc.  
RI - Federal Lands

• Tract #3 - 37.50%

R.I. Floyd Fee Land - 120 ac., NE/4 NE/4 & S/2 SE/4, Sec. 29, T-22-S, R-26-E,  
Eddy Co., New Mexico  
WI - Hanagan & Hanagan  
RI - R. I. Floyd