

**NEW MEXICO OIL CONSERVATION COMMISSION
WELL LOCATION AND ACREAGE DEDICATION PLAT**

Form C-107
Supersedes C-128
Effective 1-1-65

All distances must be from the outer boundaries of the Section

| | | | | | |
|---|----|-------------------------------|----------------------|------------------------------|------------|
| City Service Oil Company | | | Lease Tracy "C" Com. | | Well No. 1 |
| Section H | 32 | 21 South | Range 27 East | County Eddy | |
| 1980 feet from the North line and 660 feet from the East line | | | | | |
| Ground, Lease, Pool 3150' GR(Est) Morrow | | Pool Undesignated Land Morrow | | Dedicated Acreage: 320 Acres | |

- Outline the acreage dedicated to the subject well by colored pencil or hatchure marks on the plat below.
- If more than one lease is dedicated to the well, outline each and identify the ownership thereof (both as to working interest and royalty).
- If more than one lease of different ownership is dedicated to the well, have the interests of all owners been consolidated by communitization, unitization, force-pooling, etc?

R. 4885 10-22-74

☐ Yes ☐ No If answer is "yes," type of consolidation Unitization & Force pooling

If answer is "no," list the owners and tract descriptions which have actually been consolidated: (Use reverse side of this form if necessary.) See reverse side

No allowable will be assigned to the well until all interests have been consolidated (by communitization, unitization, forced-pooling, or otherwise) or until a non-standard unit, eliminating such interests, has been approved by the Commission.

Unit block consists of 5120 acres. Participating companies in this well are as follows:

| | |
|---------------------|------------|
| Cities Service Oil | 36.187704% |
| Midwest Oil Corp. | 21.881036% |
| Amarillo Oil Co. | 16.410775% |
| Flag-Redfern Oil | 16.410775% |
| Union Oil of Calif. | 4.369388% |
| Champlin Petr. | 1.683161% |
| Patoil Corp. | 1.683161% |
| M. P. Grace | .796530% |
| Bit Grinding Ret. | .577470% |
| <u>100.000000%</u> | |

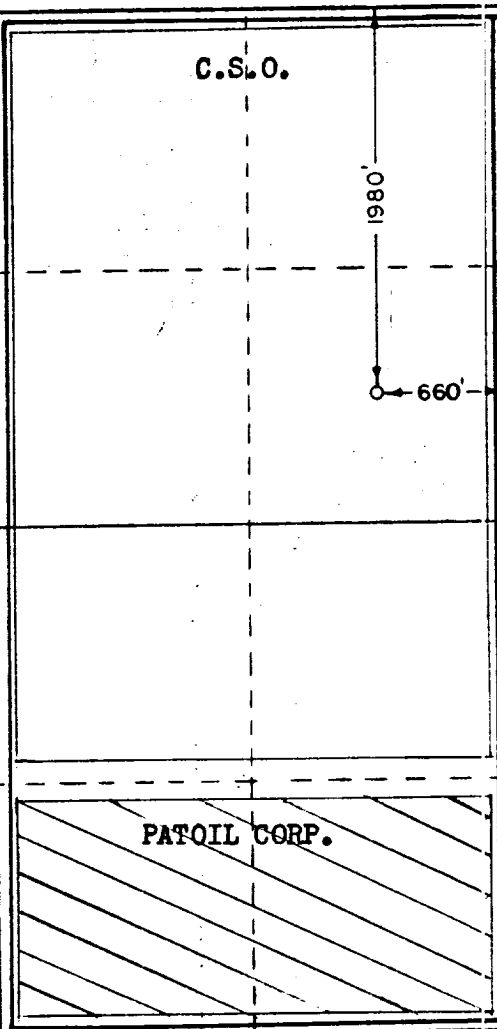
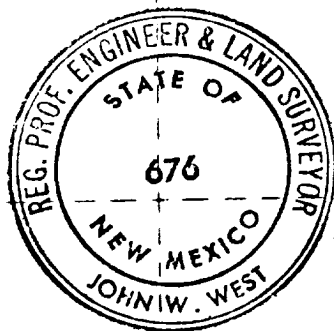

CERTIFICATION

I hereby certify that the information contained herein is true and complete to the best of my knowledge and belief.

Name E. Schilder
 Position Region Operation Manager
 Company Cities Service Oil Company
 Date October 10, 1974

I hereby certify that the well location shown on this plat was plotted from field notes of actual surveys made by me or under my supervision, and that the same is true and correct to the best of my knowledge and belief.

Date Surveyed October 4, 1974
 Registered Professional Engineer and/or Land Surveyor

John W. West
 Certificate No. 676

0 330 660 990 1320 1650 1980 2310 2640 2970 3300 3630 3960 4290 4620 4950 5280 5610 5940 6270 6600

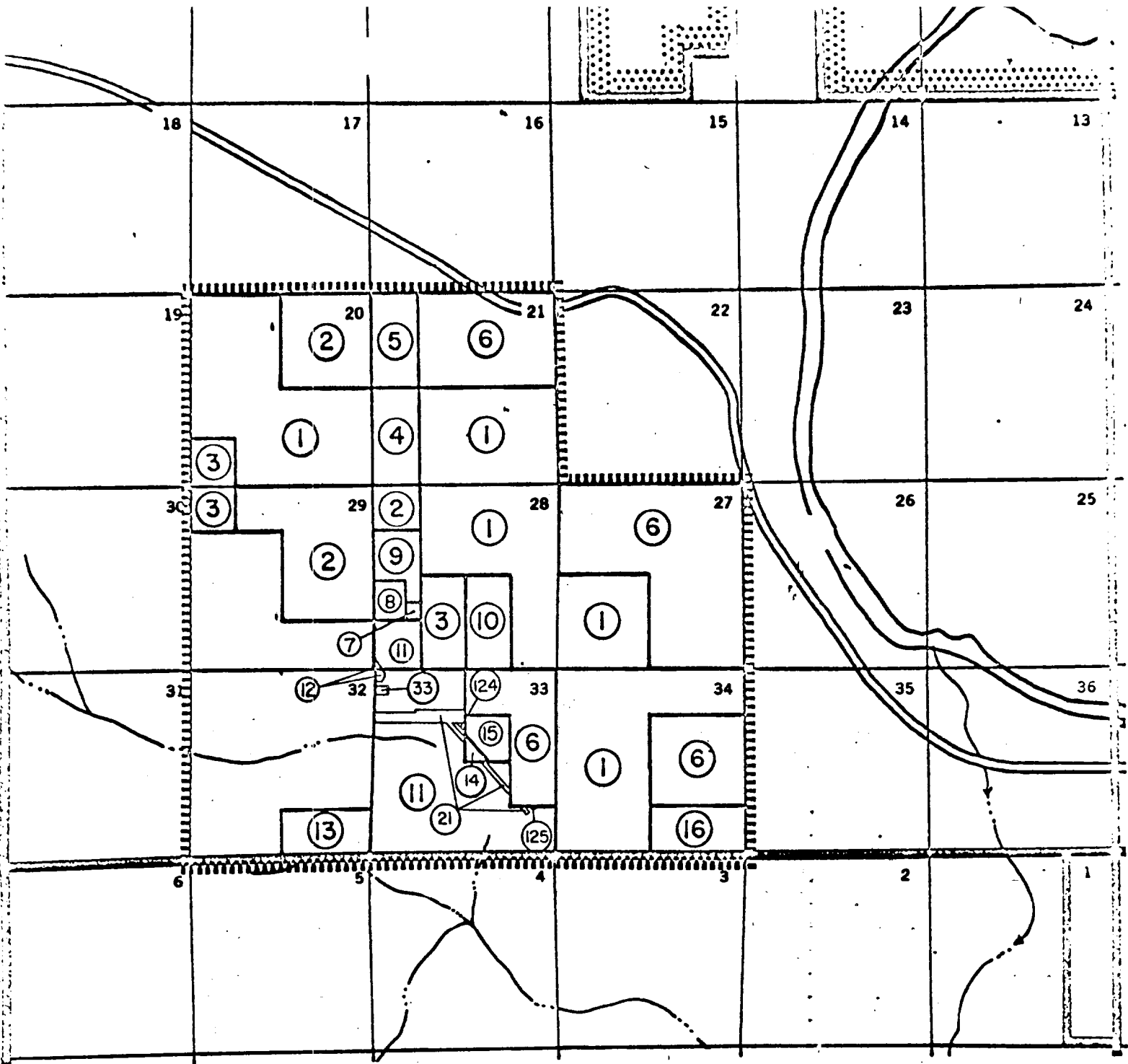

R-27-E

| TRACT NO. | WORKING INTEREST OWNER |
|-----------------------------|--|
| 1 | Amarillo Oil Co., Flag-Redfern Oil Co. |
| 2,3,4,5,7, 10,14,21 & 33 | Cities Service Oil Co. |
| 6 | Midwest Oil Corp. |
| 9 | J.M. Huber, Pierce & Davis |
| 11 | Union Oil Co. of Calif. |
| 13 | Patoil Corp. |
| 16 | Champlin Petro. Co. |
| 12,15,124 & 125 | Unleased Acreage |

EXHIBIT "A" PART IV

OPERATING AGREEMENT DATED SEPT. 22 1972
EDDY COUNTY, NEW MEXICO

PLAT OF UNIT AREA

..... UNIT AREA

② TRACT NUMBERS

SCALE: 1" = 4000'