

NEW MEXICO OIL CONSERVATION COMMISSION  
WELL LOCATION AND ACREAGE DEDICATION PLAT

Form C-102  
Supersedes C-128  
Effective 1-1-65

All distances must be from the outer boundaries of the Section

City: <b>Cities Service</b>		Company: <b>Tracy "C"</b>		Well No.: <b>1</b>	
Section: <b>H</b>	Section: <b>32</b>	Township: <b>21 South</b>	Range: <b>27 East</b>	County: <b>Eddy</b>	
Actual Well Location of Well:					
<b>1980</b>		feet from the <b>North</b> line and <b>660</b> feet from the <b>East</b> line			
Ground Level Elev.: <b>3150' GR</b>	Existing Formation: <b>Morrow</b>		Foot: <b>Undesignated Morrow</b>	Dedicated Acreage: <b>320</b>	

- Outline the acreage dedicated to the subject well by colored pencil or hatchure marks on the plat below.
- If more than one lease is dedicated to the well, outline each and identify the ownership thereof (both as to working interest and royalty)
- If more than one lease of different ownership is dedicated to the well, have the interests of all owners been consolidated by communitization, unitization, force-pooling, etc?

☒ Yes ☐ No If answer is "yes," type of consolidation Unitization & Force pooling

If answer is "no," list the owners and tract descriptions which have actually been consolidated. (Use reverse side of this form if necessary.) See reverse side

No allowable will be assigned to the well until all interests have been consolidated (by communitization, unitization, forced-pooling, or otherwise) or until a non-standard unit, eliminating such interests, has been approved by the Commission.

Unit block consists of 5120 C.S.C. acres. Participating companies in this well are as follows:

Cities Service Co.	36.69185%
Amoco Prod. Co.	22.18587%
Pioneer Prod. Co.	16.63940%
Flag-Redfern, Oil Co	8.02056%
John <sup>J</sup> Redfern, Jr & Rosalind Redfern	7.78687%
Champlin Petro Corp.	1.70661%
Patoil Corp	1.70661%
Union Oil of CA.	4.43026%
Claremont Corp.	0.83197%
	<u>100.00000%</u>

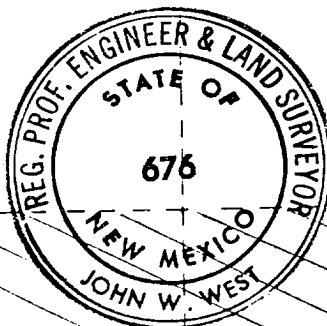

PATOIL CORP.

CERTIFICATION

I hereby certify that the information contained herein is true and complete to the best of my knowledge and belief

Name: E. Spiller  
Position: Region Oper. Mgr.  
Company: Cities Service Company  
Date: 3/3/81

I hereby certify that the well location shown on this plat was plotted from field notes of actual surveys made by me or under my supervision, and that the same is true and correct to the best of my knowledge and belief.

Date Surveyed: October 4, 1974

Registered Professional Engineer and/or Land Surveyor

John W. West

Certificate No. 676

0 330 660 990 1320 1650 1980 2310 2640 2970 3300 3630 3960 4290 4620 4950 5280 5610 5940 6270 6600

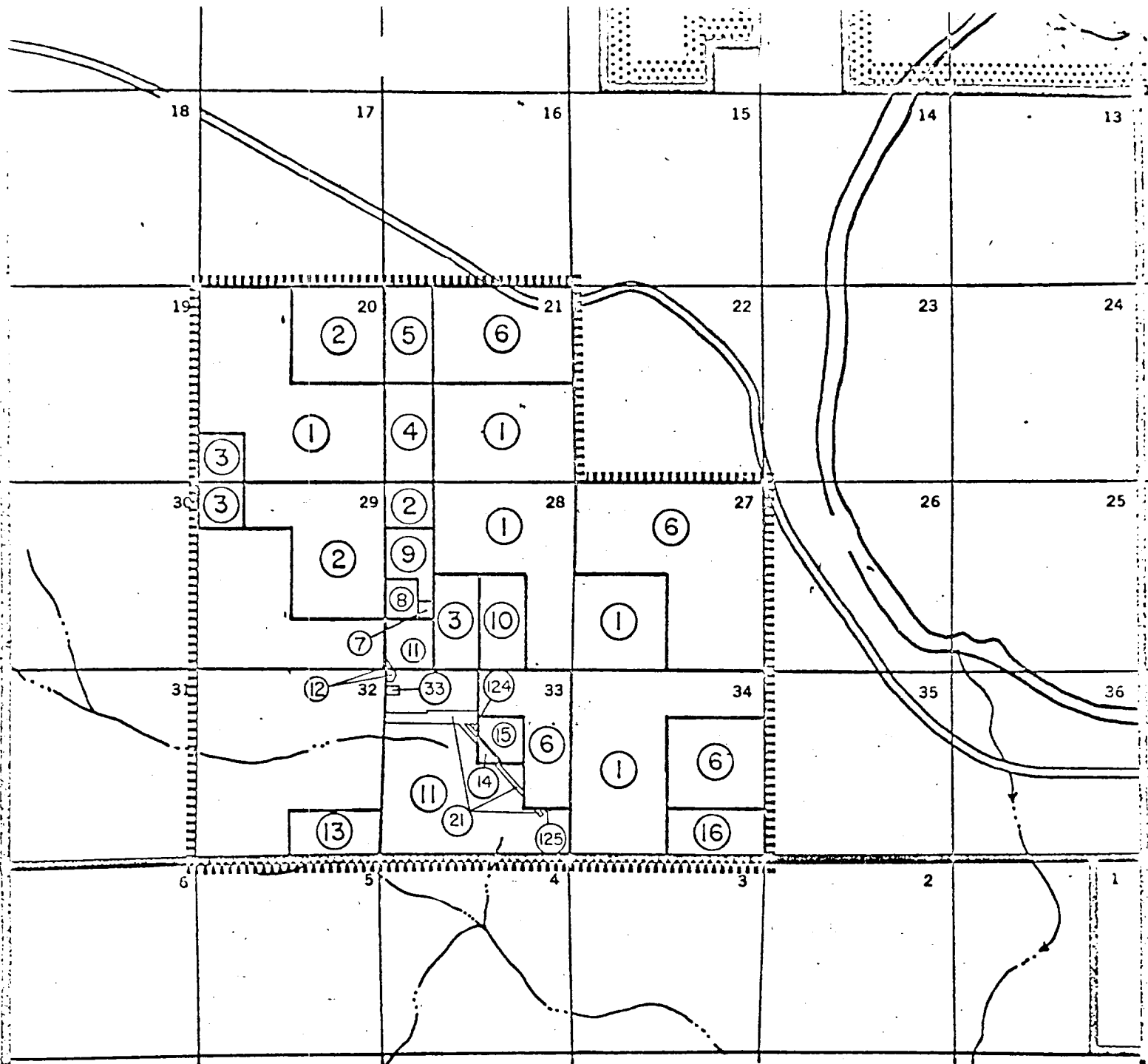

R-27-E

TRACT NO.

WORKING INTEREST OWNER

1  
2,3,4,5,7,  
10,14,21 & 33 Cities Service Co.  
6 Midwest Oil Corp.  
9 J.M. Huber, Pierce & Davis  
11 Union Oil Co. of Calif  
13 Patoil Corp.  
16 Champlin Petro. Co.  
12,15,124  
125

~~Amarillo Oil Co.~~ Flag-Redfern Oil Co.

Co.

## EXHIBIT "A" PART IV

OPERATING AGREEMENT DATED SEPT. 22 1972

EDDY COUNTY, NEW MEXICO

Unleased Acreage

PLAT OF UNIT AREA

UNIT AREA

② TRACT NUMBERS

SCALE: 1" = 1000'