

UNITED STATES
DEPARTMENT OF THE INTERIOR
GEOLOGICAL SURVEY

APPLICATION FOR PERMIT TO DRILL, DEEPEN, OR PLUG BACK

1a. TYPE OF WORK

DRILL ☒RECEIVED
DEEPEN ☒PLUG BACK ☐

5. LEASE DESIGNATION AND SERIAL NO.

0556290

6. IF INDIAN, ALLOTTEE OR TRIBE NAME

7. UNIT AGREEMENT NAME

8. FARM OR LEASE NAME

Williamson Federal

9. WELL NO.

10. FIELD AND POOL, OR WILDCAT

Burton Flat (Morrow)

11. SEC., T., R., M., OR BLK.
AND SURVEY OR AREA

Sec. 15-20S-29E

12. COUNTY OR PARISH

Eddy

13. STATE

New Mex.

b. TYPE OF WELL

OIL
WELL ☐GAS
WELL ☒

OTHER

SINGLE
ZONE ☐MULTIPLE
ZONE ☐

2. NAME OF OPERATOR

Texas Oil & Gas Corp.

3. ADDRESS OF OPERATOR

P. O. Box 591, Midland, Texas 79701

4. LOCATION OF WELL (Report location clearly and in accordance with any State requirements*)

At surface

1980' FWL, 1980' FNL

At proposed prod. zone

14. DISTANCE IN MILES AND DIRECTION FROM NEAREST TOWN OR POST OFFICE*

10 miles NE of Carlsbad, New Mexico

15. DISTANCE FROM PROPOSED*

LOCATION TO NEAREST
PROPERTY OR LEASE LINE, FT.
(Also to nearest drig. unit line, if any)

1980

16. NO. OF ACRES IN LEASE

640

17. NO. OF ACRES ASSIGNED

320

18. DISTANCE FROM PROPOSED LOCATION*
TO NEAREST WELL, DRILLING, COMPLETED,
OR APPLIED FOR, ON THIS LEASE, FT.

None

19. PROPOSED DEPTH

12,000

20. ROTARY OR CABLE TOOLS

Rotary

21. ELEVATIONS (Show whether DF, RT, GR, etc.)

NA

22. APPROX. DATE WORK WILL START*

Dec. 2, 1974

23.

PROPOSED CASING AND CEMENTING PROGRAM

SIZE OF HOLE	SIZE OF CASING	WEIGHT PER FOOT	SETTING DEPTH	QUANTITY OF CEMENT
15"	13 3/8"	48	550	500
12 1/4"	8 5/8"	32	3200	2000
7 7/8"	4 1/2"	11.6 & 13.5	12,000	500

1. Drill to 550' and set 13 3/8" casing
2. Drill 12 1/4" hole to 3200' and set 8 5/8" casing using BOP
3. Drill out with 7 7/8" bit and drill to TD using BOP and hydрил. Mud up at 8800' with 10# weight. Well control equipment to be in compliance with U. S. Dept. of Interior regulations

IN ABOVE SPACE DESCRIBE PROPOSED PROGRAM: If proposal is to deepen or plug back, give data on present productive zone and proposed productive zone. If proposal is to drill or deepen directionally, give pertinent data on subsurface locations and measured and true vertical depths. Give blowout preventer program, if any.

24.

SIGNED

J. R. Colter

TITLE

Staff Engineer

DATE

11-14-74

(This space for Federal or State office use)

PERMIT NO.

APPROVAL DATE

NOV 27 1974

APPROVED BY

TITLE

DISTRICT ENGINEER

DATE

CONDITIONS OF APPROVAL, IF ANY:

SUBJECT TO ATTACHED DEEP WELL CONTROL

REQUIREMENTS DATED

JUN 22 1973

*See Instructions on Reverse Side

THIS APPROVAL IS RESCINDED IF OPERATIONS
NOT COMMENCED WITHIN 3 MONTHS.

DECLARED WATER BASIN

CEMENT BEHIND

C. G. MUST BE CIRCULATED.

NOTIFY USGS IN SUFFICIENT TIME TO

WITNESS CEMENTING THE CASING.

NEW MEXICO OIL CONSERVATION COMMISSION
WELL LOCATION AND ACREAGE DEDICATION PLAT

Form O-102
Supersedes O-28
Effective 1-1-65

All distances must be from the outer boundaries of the Section

Operator TEXAS OIL & GAS CORPORATION			Lease WILLIAMSON FEDERAL "B"		Well No. 4
Tract Letter F	Section 15	Township 20 SOUTH	Range 29 EAST	County EDDY	
Actual Wellbore Location of Well					
1980 feet from the WEST line and		1980 feet from the NORTH line			
Ground Level Elev. NA	Producing Formation Morrow	From Burton Flat	Estimated Acreage 320		

- Outline the acreage dedicated to the subject well by colored pencil or hachure marks on the plat below.
- If more than one lease is dedicated to the well, outline each and identify the ownership thereof (both as to working interest and royalty)
- If more than one lease of different ownership is dedicated to the well, have the interests of all owners been consolidated by communitization, unitization, force-pooling, etc?

RECEIVED

NOV 19 1974

☐ Yes ☐ No If answer is "yes," type of consolidation _____
If answer is "no," list the owners and tract descriptions which have actually been consolidated (by communitization, unitization, forced-pooling, or otherwise) or until a non-standard unit, eliminating such interests, has been approved by the Commission. **O.C.C. ARTESIA, OFFICE**

No allowable will be assigned to the well until all interests have been consolidated (by communitization, unitization, forced-pooling, or otherwise) or until a non-standard unit, eliminating such interests, has been approved by the Commission.

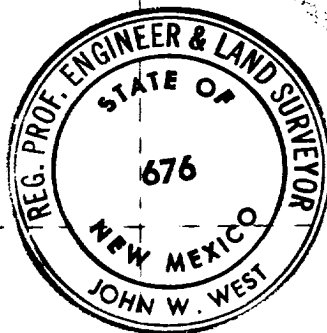
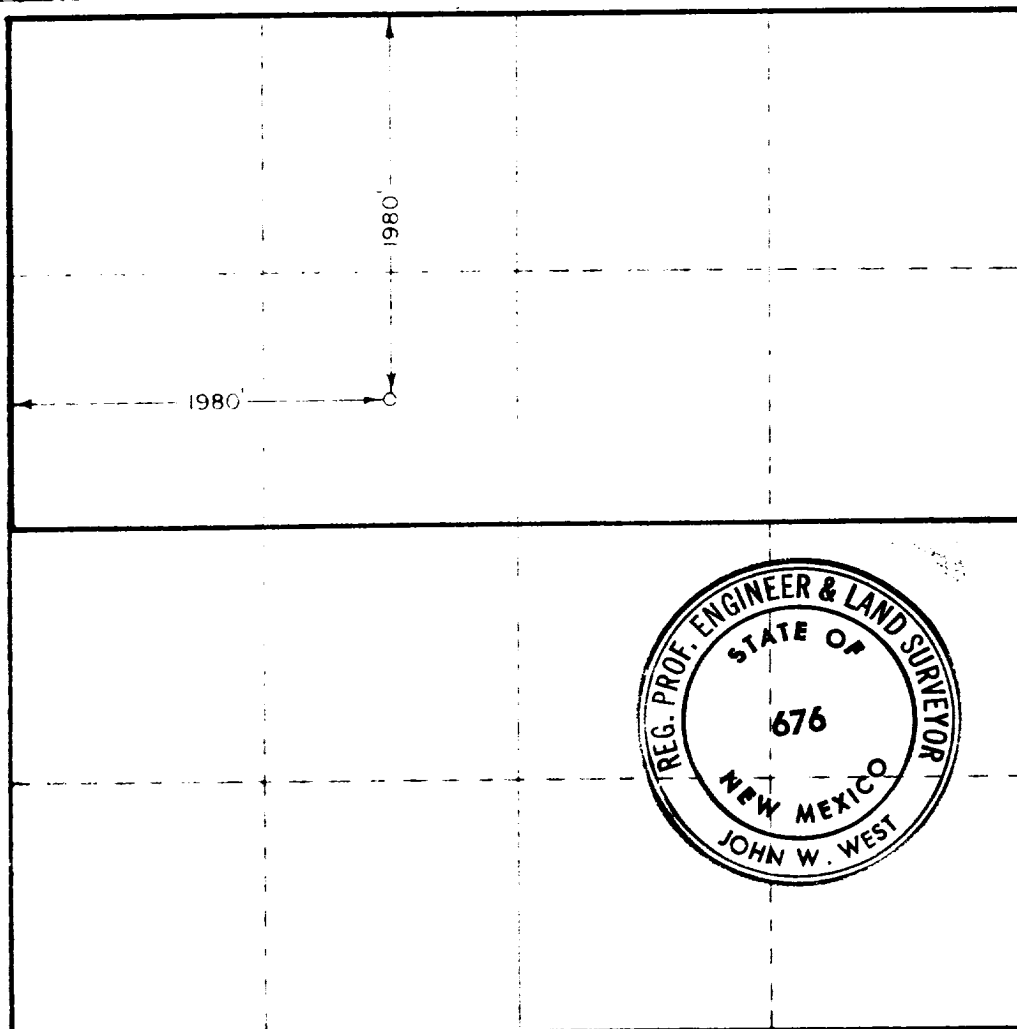

CERTIFICATION

I hereby certify that the information contained herein is true and complete to the best of my knowledge and belief

J. R. Colter
and

J. R. Colter

Position

Staff Engineer

Company

Texas Oil & Gas Corp.

Date

November 15, 1974

I hereby certify that the well location shown on this plat was plotted from field notes of actual surveys made by me or under my supervision and that the same is true and correct to the best of my knowledge and belief

Date surveyed

NOVEMBER 15, 1974

Registered Professional Engineer and/or Land Surveyor

John W. West
Certificate No. **676**

0 330 660 990 1320 1650 1980 2310 2640 2970 3300 3630 3960 4290 4620 4950 5280 5610 5940 6270 6600