

NEW MEXICO OIL CONSERVATION COMMISSION  
WELL LOCATION AND ACREAGE DEDICATION PLAT

Form O-192  
Supersedes O-128  
Effective 1-1-64

All distances must be from the outer boundaries of the Section

Section		CORINNE GRACE		Range		21 SOUTH		Twp		30 EAST		County		EDDY		Well No.		#1 - Y	
Section		L		36		21 SOUTH		30 EAST		EDDY									
Year		1980		Direction		South		Distance		990		Direction		West		Distance		320	
Acres		3238.7		Morrow				Undes. Cabin Lake Morrow Gas											

1. Outline the acreage dedicated to the subject well by colored pencil or hatchure marks on the plat below.
  2. If more than one lease is dedicated to the well, outline each and identify the ownership thereof (both as to working interest and royalty).
  3. If more than one lease of different ownership is dedicated to the well, have the interests of all owners been consolidated by communitization, unitization, forced-pooling, etc?
- ☐ Yes ☐ No If answer is "yes," type of consolidation \_\_\_\_\_

If answer is "no," list the owners and tract descriptions which have actually been consolidated. (Use reverse side of this form if necessary.) \_\_\_\_\_

No allowable will be assigned to the well until all interests have been consolidated (by communitization, unitization, forced-pooling, or otherwise) or until a non-standard unit eliminating such interests, has been approved by the Commission.

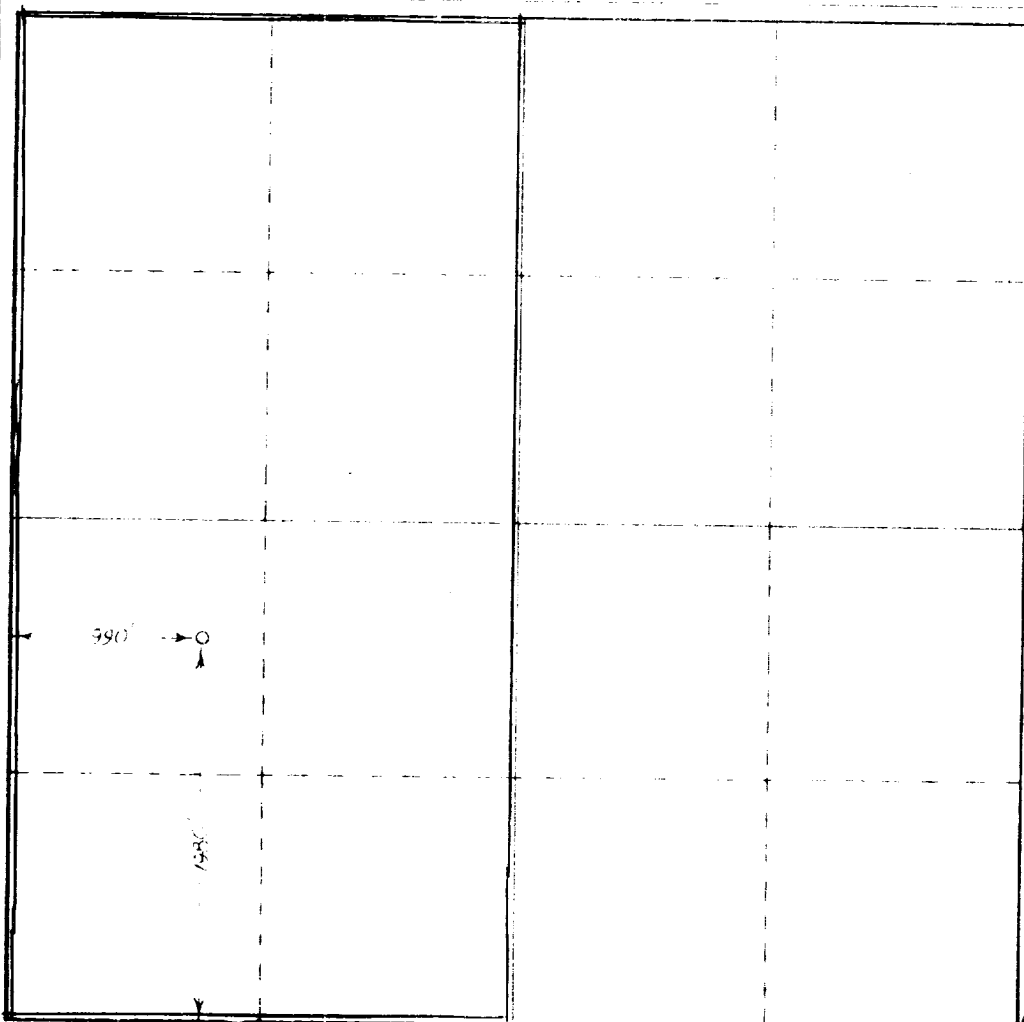

CERTIFICATION

I hereby certify that the information contained herein is true and complete to the best of my knowledge and belief.

*Corinne Grace*  
Agent

Corinne Grace

3/24/75

I hereby certify that the well location shown on this plat was plotted from field notes of actual surveys made by me or under my supervision, and that the same is true and correct to the best of my knowledge and belief.

Date: March 24, 1975  
Herschel L. Jones  
3640  
Certified  
STATE OF NEW MEXICO  
Herschel L. Jones  
3640