

UNITED STATES
DEPARTMENT OF THE INTERIOR
GEOLOGICAL SURVEY

30-015-21507

5. LEASE DESIGNATION AND SERIAL NO.

M 0556001

6. * INDIAN, ALLOTTEE OR TRIBE NAME

7. DEED AGREEMENT NAME

8. LEASE OR AGREEMENT NO.

9. LEASE CHEROKEE

10. WELL NO.

11. FIELD AND POOL, OR WILDCAT

12. SEC. T. R. M. OR BLK.

13. AND SURVEY OR AREA

14. Sec. 25, T21S, R24E

15. COUNTY OR PARISH

16. STATE

17. ADDY

18. New Mexico

19. NO. OF ACRES ASSEMBLED

20. TO THIS WELL

21. ROTARY OR CABLE TOOLS

22. C.T. & Rotary

23. APPROX. DATE WORK WILL START

24. as soon as possible

25. PROPOSED CASING AND CEMENTING PROGRAM

APPLICATION FOR PERMIT TO DRILL, DEEPEN, OR PLUG BACK

1a. TYPE OF WORK

DRILL ☒ DEEPEN ☐ PLUG BACK ☐

b. TYPE OF WELL

OIL WELL ☒ GAS WELL ☐ MULTIPLE ZONE ☐

c. NAME OF OPERATOR

Corinne Grace

3. ADDRESS OF OPERATOR

P. O. Box 1418, Carlsbad, New Mexico 38220

4. LOCATION OF WELL (Report location clearly and in accordance with any State requirements.)*

At surface

1970' FSL & 660' FEL Section 25, T21S, R24E

At proposed prod. zone

Glorieta

14. DISTANCE IN MILES AND DIRECTION FROM NEAREST TOWN OR POST OFFICE*

12 miles West-Northwest of Carlsbad, New Mexico

15. DISTANCE FROM PROPOSED*

LOCATION TO NEAREST

PROPERTY OR LEASE LINE, FT.

(Also to nearest drlg. unit line, if any)

18. DISTANCE FROM PROPOSED LOCATION*

TO NEAREST WELL, DRILLING, COMPLETED,

OR APPLIED FOR, ON THIS LEASE, FT.

21. ELEVATIONS (Show whether DF, RT, GR, etc.)

3722.3

23. PROPOSED CASING AND CEMENTING PROGRAM

SIZE OF HOLE	SIZE OF CASING	WEIGHT PER FOOT	SETTING DEPTH	QUANTITY OF CEMENT
15 1/2"	13 3/8"	54#	350	400 circulate
12 1/4"	9 5/8"	36#	1800	800 circulate
8 3/4"	7"	26#, 29#, 32#		

Propose to drill 15 1/2" hole to approximately 350' and cement 13 3/8" casing with 400 sacks. Continue drilling 12 1/4" inch hole to approximately 1800' where 9 5/8" casing will be cemented with 800 sacks cement. Then drill 8 3/4" hole to T.D. of approx. 3500' to test the Glorieta formation.

Blow out preventers will be used.

RECEIVED

MAR 26 1975

O. C. C.
ARTESIA, OFFICE

IN ABOVE SPACE DESCRIBE PROPOSED PROGRAM: If proposal is to deepen or plug back, give data on present productive zone and proposed new productive zone. If proposal is to drill or deepen directionally, give pertinent data on subsurface locations and measured and true vertical depths. Give blowout preventer program, if any.

24.

SIGNED

Agent

TITLE

DATE

3/25/75

(This space for Federal or State office use)

PERMIT NO.

APPROVAL DATE

TITLE

DATE

APPROVED

CONDITIONS OF APPROVAL, IF ANY:

MAR 25 1975

H. L. BEEKMAN

ACTING DISTRICT ENGINEER

NEW MEXICO OIL CONSERVATION COMMISSION
WELL LOCATION AND ACREAGE DEDICATION PLAT

Form O-105
Supersedes O-104
Effective 1-1-55

All distances must be from the outer boundaries of the Section.

Operator Corinne Grace			Lease Yates Cherokee		Well No. 1-Y
Unit Letter I	Section 25	Township 21 South	Range 24 East	County Eddy	
Actual Footage Location of Well: 1970 feet from the South line and 660 feet from the East line					
Ground Level Elev. 3722.3	Producing Formation Glorieta		Pool Wildcat	Dedicated Acreage 40	

1. Outline the acreage dedicated to the subject well by colored pencil or hatchure marks on the plat below.
2. If more than one lease is dedicated to the well, outline each and identify the ownership thereof (both as to working interest and royalty).
3. If more than one lease of different ownership is dedicated to the well, have the interests of all owners been consolidated by communitization, unitization, force-pooling, etc?

☐ Yes ☐ No If answer is "yes," type of consolidation _____

If answer is "no," list the owners and tract descriptions which have actually been consolidated. (Use reverse side of this form if necessary.) _____

No allowable will be assigned to the well until all interests have been consolidated (by communitization, unitization, forced-pooling, or otherwise) or until a non-standard unit, eliminating such interests, has been approved by the Commission.

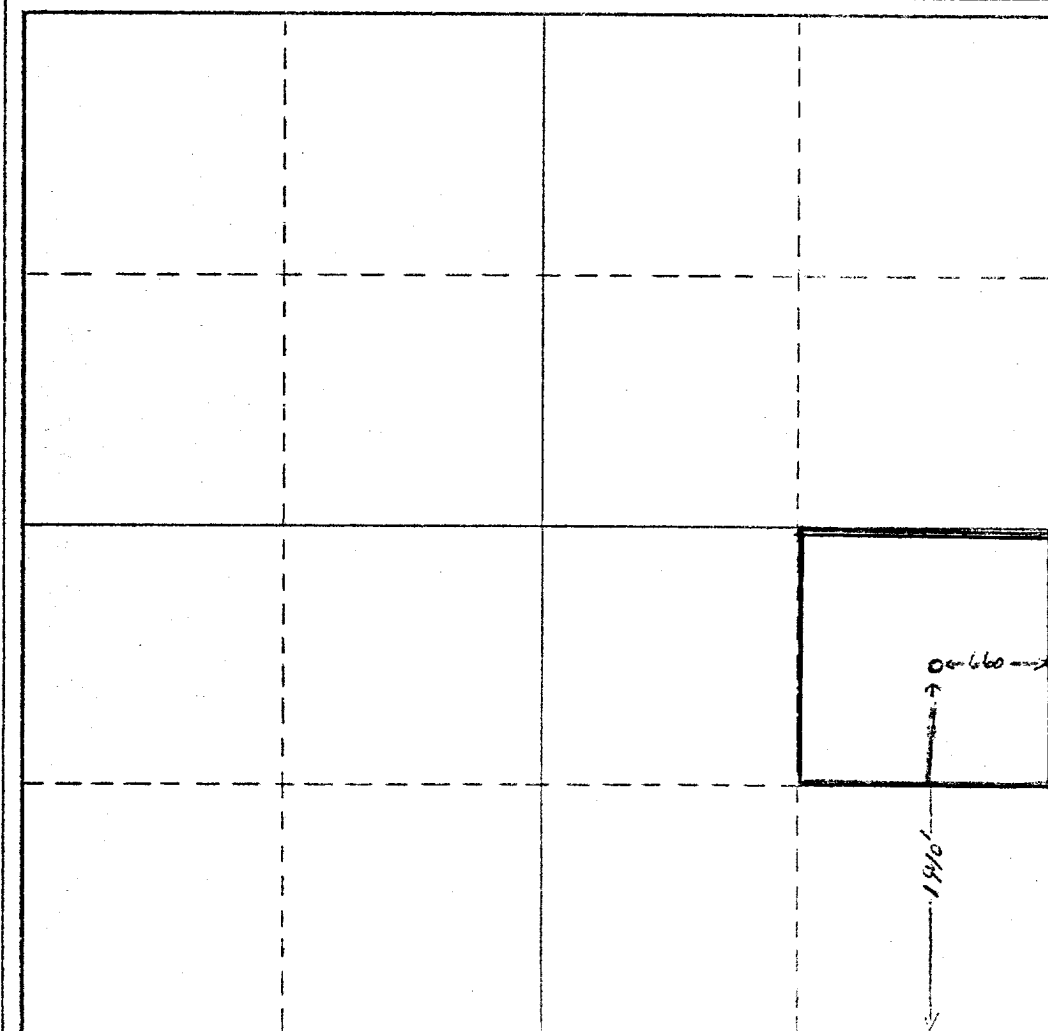

CERTIFICATION

I hereby certify that the information contained herein is true and complete to the best of my knowledge and belief.

Name
Christa R. Jones
Position
Agent

Company
Corinne Grace

Date
3/25/75

I hereby certify that the well location shown on this plat was plotted from field notes of actual surveys made by me or under my supervision, and that the same is true and correct to the best of my knowledge and belief.

Date Surveyed

Registered Professional Engineer
and/or Land Surveyor
Original Plat and Survey made
by Herschel Jones, Registered
Land Surveyor, State of New Mexico
3640

0 330 660 990 1320 1650 1980 2310 2640 2970 3300 3630 3960 4290 4620 4950 5280 5610 5940 6270 6600

BILL:

I. CHECKED THIS
WELL ON 2-26-72. THE CREW
WAS MAKING BIG 15' TO
THE EAST INSTEAD OF 10'
SOUTH AS INDICATED ON
FED FORM 9-331