

NO. OF COPIES RECEIVED	
DISTRIBUTION	
SANTA FE	
FILE	
U.S.G.S.	
LAND OFFICE	
OPERATOR	

NEW MEXICO OIL CONSERVATION COMMISSION

RECEIVED

SEP 18 1975

30-015-21634

Form C-101  
Revised 1-1-65

5A. Indicate Type of Lease STATE <input checked="" type="checkbox"/> FEE <input type="checkbox"/>
5. State Oil & Gas Lease No. L-3356
7. Unit Agreement Name
8. Farm or Lease Name Little Indian Basin St. ES
9. Well No. 1
10. Field and Pool, or Wildcat Undesignated
12. County Eddy
19. Proposed Depth 9500
19A. Formation Morrow
20. Rotary or C.T. Rotary
21. Elevations (Show whether DF, RT, etc.) 4068' GR
21A. Kind & Status Plug. Bond Blanket
21B. Drilling Contractor Ard Drilling Co.
22. Approx. Date Work will start 9-22-75

APPLICATION FOR PERMIT TO DRILL, DEEPEN, OR PLUG BACK

1a. Type of Work DRILL <input checked="" type="checkbox"/> DEEPEN <input type="checkbox"/> PLUG BACK <input type="checkbox"/>
b. Type of Well OIL WELL <input type="checkbox"/> GAS WELL <input checked="" type="checkbox"/> OTHER <input type="checkbox"/> SINGLE ZONE <input type="checkbox"/> MULTIPLE ZONE <input type="checkbox"/>
2. Name of Operator Yates Petroleum Corporation
3. Address of Operator 207 South 4th Street - Artesia, NM
4. Location of Well UNIT LETTER 0 LOCATED 660 FEET FROM THE South LINE AND 1980 FEET FROM THE East LINE OF SEC. 36 TWP. 21S RGE. 22E NMPM
19. Proposed Depth 9500
19A. Formation Morrow
20. Rotary or C.T. Rotary
21. Elevations (Show whether DF, RT, etc.) 4068' GR
21A. Kind & Status Plug. Bond Blanket
21B. Drilling Contractor Ard Drilling Co.
22. Approx. Date Work will start 9-22-75

PROPOSED CASING AND CEMENT PROGRAM

SIZE OF HOLE	SIZE OF CASING	WEIGHT PER FOOT	SETTING DEPTH	SACKS OF CEMENT	EST. TOP
17 1/2"	13-3/8"	48#	200'	Circulate	
12 1/4"	8-5/8"	24#	2100'	Circulate	
7-7/8"	4 1/2 or 5 1/2"	10.5-11.6# or 15.5-17#	TD	250	

Propose to drill and test the Morrow and intermediate horizons. Approx. 200' of surface casing will be run to shut off gravel and surface caving. Intermediate casing will be set below the Glorietta at approx. 2100'. If commercial, 5 1/2 or 4 1/2" oil string will be set and cemented.

Mud Program: - Mist drill to 2100', FW to 6500', Flosal-Drispak mud to Total Depth.

BOP Program: - Rotating head to 2100', BOP's and hydril on 8-5/8" casing and tested, pipe rams tested daily, blind rams on trips. Yellow Jacket prior to drilling Wolfcamp.

APPROVAL VALID  
FOR 90 DAYS UNLESS  
DRILLING COMMENCED,

IN ABOVE SPACE DESCRIBE PROPOSED PROGRAM: IF PROPOSAL IS TO DEEPEN OR PLUG BACK, GIVE DATA ON PRESENT PRODUCTION ZONE AND PROPOSED NEW PRODUCTION ZONE. GIVE BLOWOUT PREVENTER PROGRAM, IF ANY.

I hereby certify that the information above is true and complete to the best of my knowledge and belief.

Signed Eddie M. Hays Title Engineer Date 9-17-75

(This space for State Use)

APPROVED BY W. A. Gressett TITLE SUPERVISOR, DISTRICT II DATE SEP 22 1975

CONDITIONS OF APPROVAL, IF ANY:

Cement must be circulated to  
surface behind 13 3/8" & 8 5/8" casing

Notify N.M.O.C.C. in sufficient  
time to witness cementing  
the 8 5/8" casing

NEW MEXICO OIL CONSERVATION COMMISSION  
WELL LOCATION AND ACREAGE DEDICATION PLAT

Form O-102  
Supersedes C-128  
Effective 1-1-50

All distances must be from the outer boundaries of the Section.

Operator <b>Yates Petroleum Corporation</b>		Lease <b>Little Indian Basin State "ES"</b>		Well No. <b>1</b>
Unit Letter <b>'O'</b>	Section <b>36</b>	Township <b>21 South</b>	Range <b>22 East</b>	County <b>Eddy</b>
Actual Footage Location of Well:				
<b>1980</b>	feet from the <b>East</b>	line and <b>660</b>	feet from the <b>South</b>	line
Ground Level Elev. <b>4068</b>	Producing Formation <b>Morrow</b>	Pool <i>Will not produce</i> <b>Undesignated</b>	Dedicated Acreage: <b>320</b> Acres	

1. Outline the acreage dedicated to the subject well by colored pencil or hachure marks on the plat below.
2. If more than one lease is dedicated to the well, outline each and identify the ownership thereof (both as to working interest and royalty).
3. If more than one lease of different ownership is dedicated to the well, have the interests of all owners been consolidated by communitization, unitization, force-pooling, etc?

☒ Yes    ☐ No    If answer is "yes," type of consolidation **To be Communitized**

If answer is "no," list the owners and tract descriptions which have actually been consolidated. (Use reverse side of this form if necessary.) \_\_\_\_\_

No allowable will be assigned to the well until all interests have been consolidated (by communitization, unitization, forced-pooling, or otherwise) or until a non-standard unit, eliminating such interests, has been approved by the Commission.

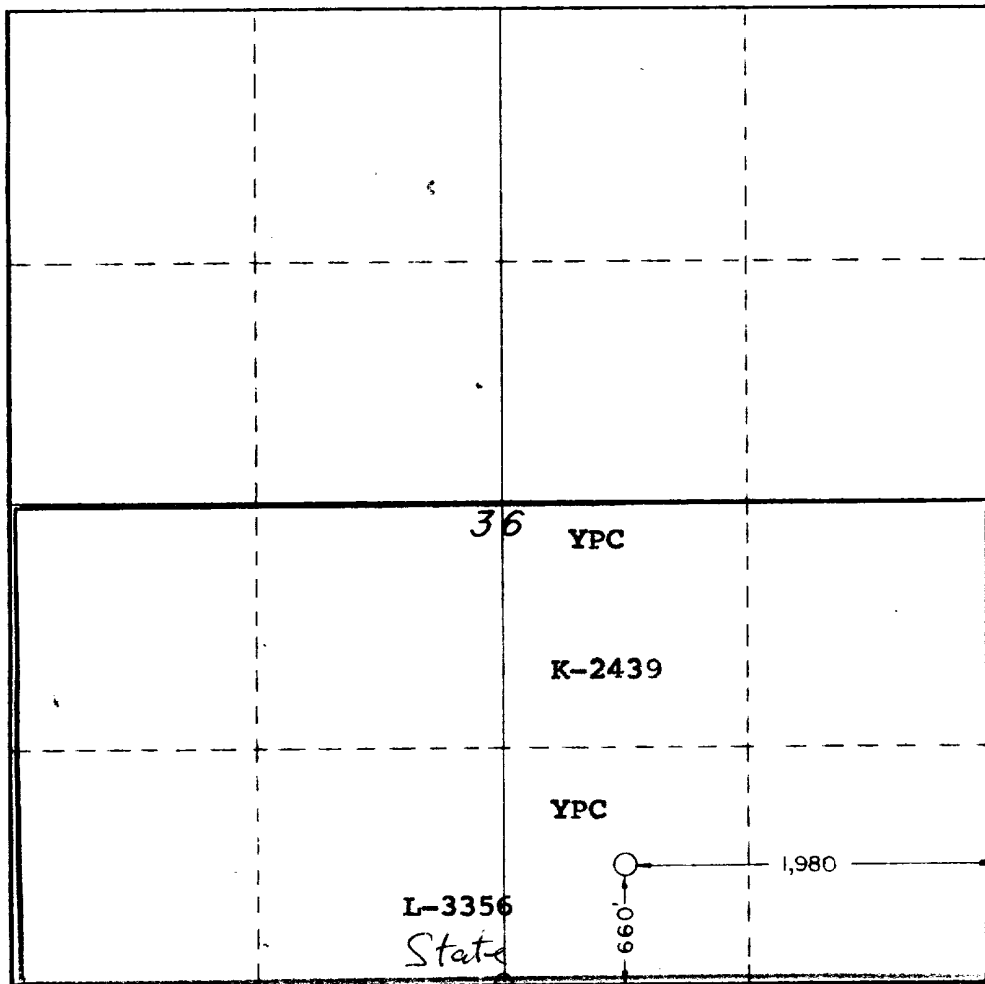

**CERTIFICATION**

I hereby certify that the information contained herein is true and complete to the best of my knowledge and belief.

*Eddie M. Mahfood*

Name

**Eddie M. Mahfood**

Position

**Engineer**

Company

**Yates Petroleum Corp.**

Date

**9-17-75**

I hereby certify that the well location shown on this plat was plotted from field notes of actual surveys made by me or under my supervision, and that the same is true and correct to the best of my knowledge and belief.

Date Surveyed

**July**

Registered Professional Engineer and/or Land Surveyor

*[Signature]*

Certificate No.

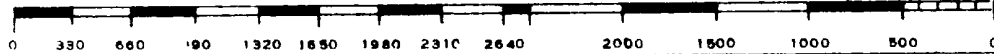
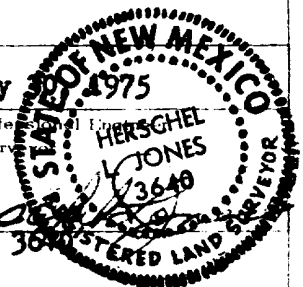

Yates Petroleum Corporation  
 Little Indian Basin State "ES" Com No. 1  
 1980' FEL and 660' FSL of Sec. 36-21S-22E  
 Eddy County, New Mexico

BOP SKETCH

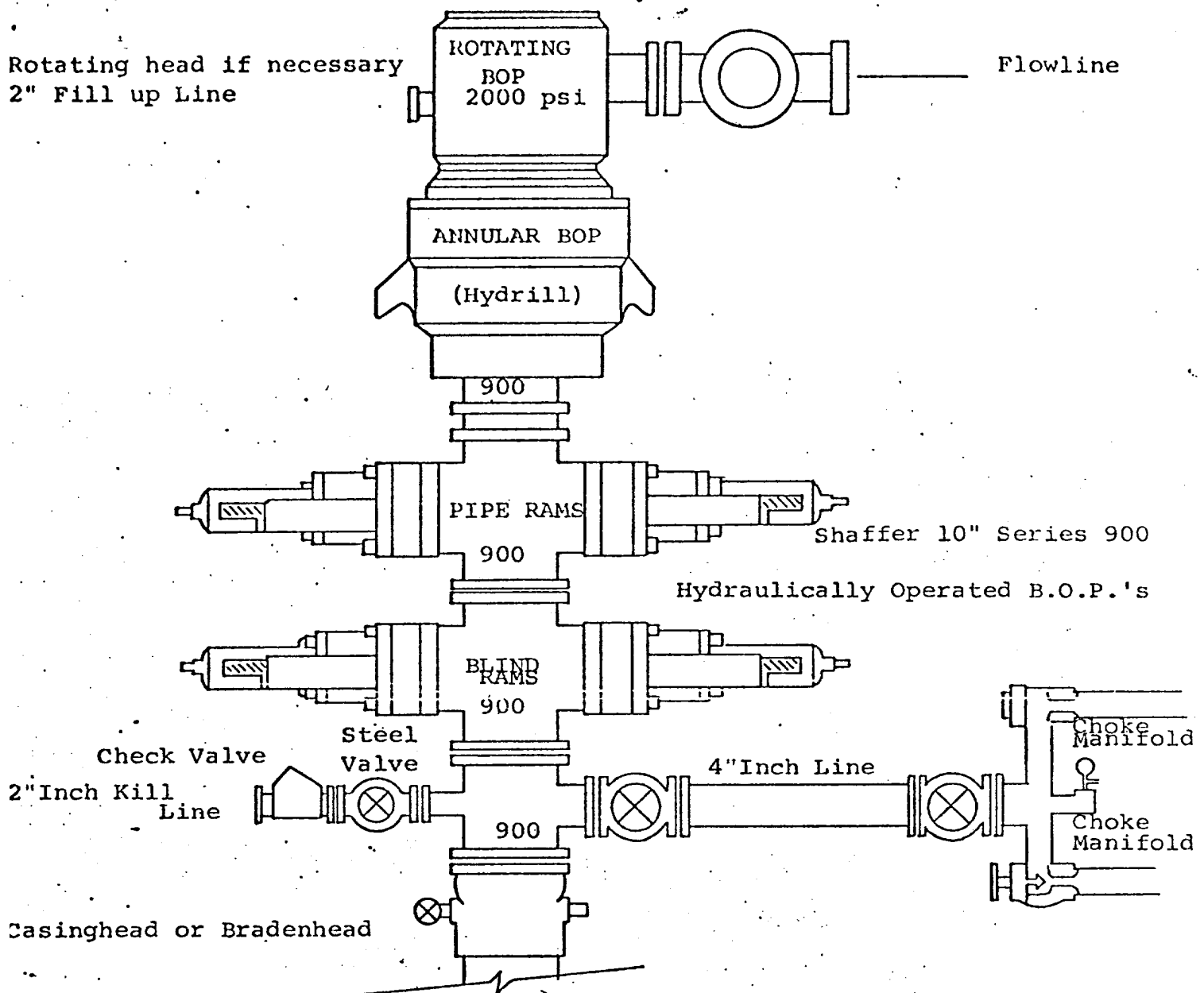

THE FOLLOWING CONSTITUTE MINIMUM BLOWOUT PREVENTER REQUIREMENTS

1. All preventers to be hydraulically operated with secondary manual controls installed prior to drilling out from under casing.
2. Choke outlet to be a minimum of 4" diameter.
3. Kill line to be of all steel construction of 2" minimum diameter.
4. All connections from operating manifolds to preventers to be all steel hole or tube a minimum of one inch in diameter.
5. The available closing pressure shall be at least 15% in excess of that required with sufficient volume to operate the B.O.P.'s.
6. All connections to and from preventer to have a pressure rating equivalent to that of the B.O.P.'s.
7. Inside blowout preventer to be available on rig floor.
8. Operating controls located a safe distance from the rig floor.
9. Hole must be kept filled on trips below intermediate casing. Operator not responsible for blowouts resulting from not keeping hole full.
10. D. P. float must be installed and used below zone of first gas intrusion.