

UNITED STATES
DEPARTMENT OF THE INTERIOR
GEOLOGICAL SURVEY

APPLICATION FOR PERMIT TO DRILL, DEEPEN, OR PLUG BACK

1a. TYPE OF WORK

DRILL ☐DEEPEN ☐PLUG BACK ☒

b. TYPE OF WELL

OIL
WELL ☐GAS
WELL ☒

OTHER

SINGLE
ZONE ☒MULTIPLE
ZONE ☐

2. NAME OF OPERATOR

Yates Petroleum Corporation

3. ADDRESS OF OPERATOR

207 South 4th St., Artesia, NM 88210

4. LOCATION OF WELL (Report location clearly and in accordance with any State requirements)

At surface

1980' FSL 1980' FEL, Sec. 29

At proposed prod. zone

14. DISTANCE IN MILES AND DIRECTION FROM NEAREST TOWN OR POST OFFICE

15. DISTANCE FROM PROPOSED*

LOCATION TO NEAREST
PROPERTY OR LEASE LINE, FT.
(Also to nearest drlg. unit line, if any)18. DISTANCE FROM PROPOSED LOCATION*
TO NEAREST WELL, DRILLING, COMPLETED,
OR APPLIED FOR, ON THIS LEASE, FT.

21. ELEVATIONS (Show whether DF, RT, GR, etc.)

3244' KB

23.

PROPOSED CASING AND CEMENTING PROGRAM

SIZE OF HOLE	SIZE OF CASING	WEIGHT PER FOOT	SETTING DEPTH	QUANTITY OF CEMENT
17-1/2	13-3/8	48#	556	550 sx
12-1/4	8-5/8	24 & 32 #	2820	1525 sx
7-7/8	5-1/2"	17 & 20#	115	550 sx

This well is presently completed in Strawn perforations 10243-10361 and is no longer commercial. Propose to pull tubing and packers, set CIBP's at 10400 and 10150' with 30' cement on top, perforate Wolfcamp at 9546-9559 and stimulate for production.

Set 50' cm t. on top of CIBPs @ 10400' & 10150'.

IN ABOVE SPACE DESCRIBE PROPOSED PROGRAM: If proposal is to deepen or plug back, give data on present productive zone and proposed new productive zone. If proposal is to drill or deepen directionally, give pertinent data on subsurface locations and measured and true vertical depths. Give blowout preventer program, if any.

24.

SIGNED

Eddie M. [unclear]

TITLE

Engineer

DATE

5-18-81

(This space for Federal or State office use)

PERMIT NO.

APPROVAL DATE

APPROVED BY

TITLE

CONDITIONS OF APPROVAL, IF ANY:

APPROVED AS AMENDED

(ORIG. SGD.) KAREN E. SAYLES

MAY 21 1981

JAMES A. GILLHAM
DISTRICT SUPERVISOR

RECEIVED

NEW MEXICO OIL CONSERVATION COMMISSION
WELL LOCATION AND ACREAGE DEDICATION PLAT

MAY 20 1981 Form O-10
Supersedes O-128
Effective 1-1-77

All distances must be from the outer boundaries of the Section

O. C. D.

Operator: <u>Yates Petroleum Corp</u>		Location: <u>Stonewall Dist Com Bldg</u>		ARTESIA OFFICE <u>2</u>	
Unit Letter: <u>J</u>	Section: <u>29</u>	Township: <u>20-S</u>	Range: <u>32-E</u>	County: <u>Eddy</u>	
Actual Footage Location of Well: <u>1980</u> feet from the <u>South</u> corner of <u>1930</u> <u>Section</u> <u>Last</u>					
Ground Level Elev.: <u>3229</u>	Producing Formation: <u>Wolfcamp</u>		Well: <u>W.A. Burton State Wellcamp</u>	Section: <u>320</u>	Acres: <u>1.00</u>

1. Outline the acreage dedicated to the subject well by colored pencil or hatchure marks on the plat below.
2. If more than one lease is dedicated to the well, outline each and identify the ownership thereof (both as to working interest and royalty).
3. If more than one lease of different ownership is dedicated to the well, have the interests of all owners been consolidated by communitization, unitization, force-pooling, etc?

☒ Yes ☐ No If answer is "yes," type of consolidation Communitization

If answer is "no," list the owners and tract descriptions which have actually been consolidated. (Use reverse side of this form if necessary.) _____

No allowable will be assigned to the well until all interests have been consolidated (by communitization, unitization, forced-pooling, or otherwise) or until a non-standard unit, eliminating such interests, has been approved by the Commission.

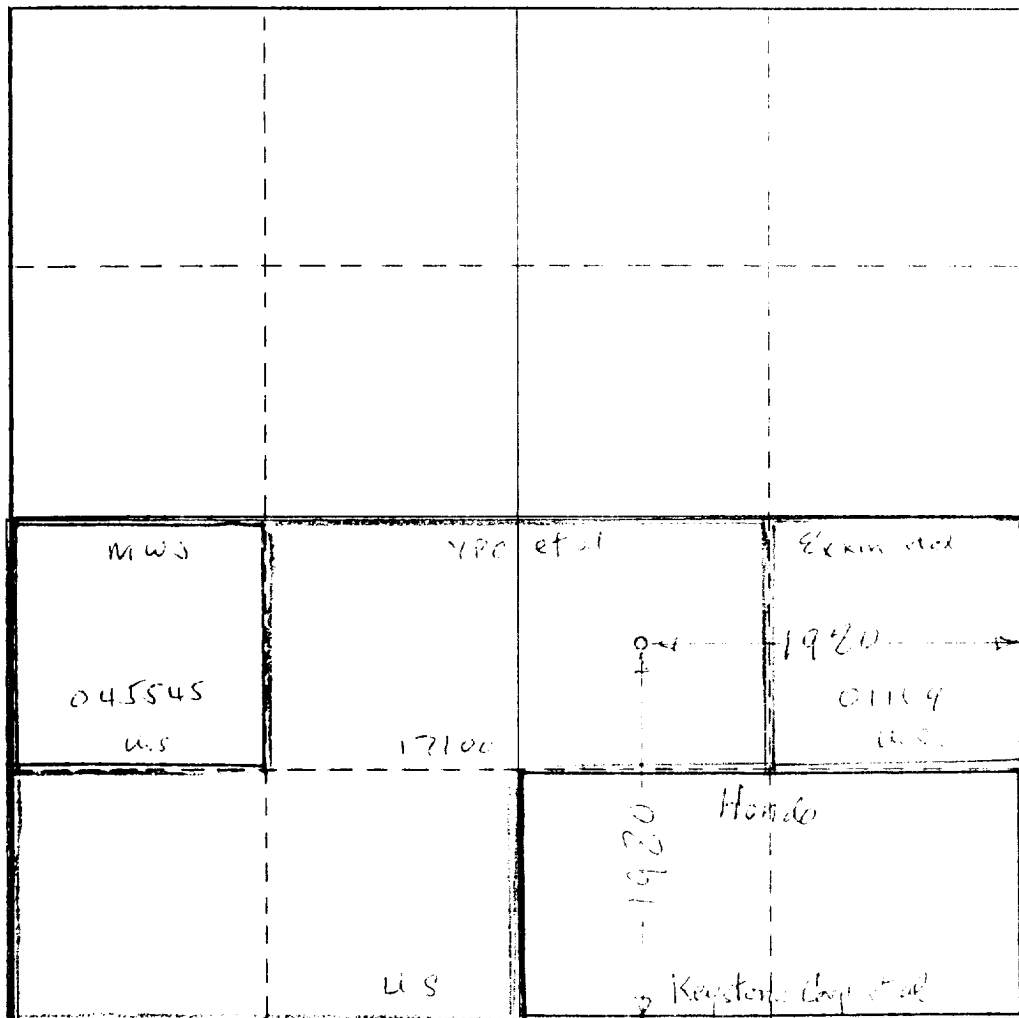

CERTIFICATION

I hereby certify that the information contained herein is true and complete to the best of my knowledge and belief.

Edgar M. McElroy

Edgar M. McElroy

Engineer

Yates Petroleum Corp

5-16-81

I hereby certify that the well location shown on this plat was plotted from field notes of actual surveys made by me or under my supervision, and that the same is true and correct to the best of my knowledge and belief.

Refer to original plat

State Engineer

County Engineer

County Engineer

0 330 660 990 1320 1650 1980 2310 2640 2970 3300 3630 3960 4290 4620 4950 5280 5610 5940