

NO. OF COPIES RECEIVED	
DISTRIBUTION	
DATE	
FILE	
U.S.G.S.	
LAND OFFICE	
OPERATOR	

NEW MEXICO OIL CONSERVATION COMMISSION

3170 PM 11-12-75  
 RECEIVED

30-015-21677

Form C-101  
 Revised 1-1-65

5A. Indicate Type of Lease  
 STATE ☐ FEE ☒  
 5. State Oil & Gas Lease No.

APPLICATION FOR PERMIT TO DRILL, DEEPEN, OR PLUG BACK

1a. Type of Work b. Type of Well OIL WELL <input type="checkbox"/> GAS WELL <input checked="" type="checkbox"/> OTHER <input type="checkbox"/> DRILL <input checked="" type="checkbox"/> DEEPEN <input type="checkbox"/> PLUG BACK <input type="checkbox"/> ARTESIA, OFFICE SINGLE ZONE <input checked="" type="checkbox"/> MULTIPLE ZONE <input type="checkbox"/>		7. Unit Agreement Name
2. Name of Operator Corinne Grace		8. Farm or Lease Name W. A. Spindler-Grace #1
3. Address of Operator P. O. Box 1418, Carlsbad, New Mexico 88220		9. Well No. #1
4. Location of Well UNIT LETTER F LOCATED 1980 FEET FROM THE North LINE AND 1980 FEET FROM THE West LINE OF SEC. 11 TWP. 22S RGE. 26E NMPM		10. Field and Pool, or Wildcat Wildcat
12. County Eddy		
19. Proposed Depth 11,700		19A. Formation Morrow
20. Rotary or C.T. Rotary & C.T.		
21. Elevations (Show whether DF, RT, etc.) 3151.7	21A. Kind & Status Plug. Bond Blanket	21B. Drilling Contractor Abbott Bros. Drilling Co.
22. Approx. Date Work will start as soon as possible		

PROPOSED CASING AND CEMENT PROGRAM

SIZE OF HOLE	SIZE OF CASING	WEIGHT PER FOOT	SETTING DEPTH	SACKS OF CEMENT	EST. TOP
17 1/2"	13 3/8"	68#	450	450 sks	circ1
12 1/4"	9 5/8"	40#	2700	1600 sks	circ1.
8 3/4"	7"	32# & 29#	8700	300 sks	

Plan to drill 17 1/2" hole to 450'. Set 13 3/8 casing with 450 sks of cement and circulate, then drill 12 1/4 hole to 2700' and set 9 5/8" casing and cement with 1600 sks cement (circulate). 7" casing will be set at 8700' and cemented with 300 sks and if productive will run 5 1/2" to T.D. and cemented as needed.

Blow out preventor: Remote control, Triple ram.

The nearest dwelling is over 660' from this location.

APPROVAL VALID  
 FOR 90 DAYS UNLESS  
 DRILLING COMMENCED,

EXPIRES 2-14-76

IN ABOVE SPACE DESCRIBE PROPOSED PROGRAM: IF PROPOSAL IS TO DEEPEN OR PLUG BACK, GIVE DATA ON PRESENT PRODUCTIVE ZONE AND PROPOSED NEW PRODUCTIVE ZONE. GIVE BLOWOUT PREVENTER PROGRAM, IF ANY.

I hereby certify that the information above is true and complete to the best of my knowledge and belief.

Signed Janita L. Jones Title Agent Date 11/11/75

(This space for State Use)

APPROVED BY W. A. Gussert TITLE SUPERVISOR, DISTRICT II DATE NOV 14 1975

CONDITIONS OF APPROVAL, IF ANY:

Cement must be circulated to surface behind 13 3/8" casing

Notify N.M.O.C.C. in sufficient time to witness cementing the 9 5/8" casing

NEW MEXICO OIL CONSERVATION COMMISSION  
WELL LOCATION AND ACREAGE DEDICATION PLAT

Form No. 1  
Superintendent of  
Oil and Gas

All distances must be from the outer boundaries of the section.

Corrine Grace		Wash Spinnler Grace		1
F	11	22 South	26 East	Eddy
1980	North	1980	West	
3151.7	Morrow	Wildcat	320	

- Outline the acreage dedicated to the subject well by colored pencil or hatchure marks on the plat below.
- If more than one lease is dedicated to the well, outline each and identify the ownership thereof (both as to working interest and royalty).
- If more than one lease of different ownership is dedicated to the well, have the interests of all owners been consolidated by communitization, unitization, force-pooling, etc?

RECEIVED

NOV 12 1975

O. C. C.  
ARTESIA, OFFICE

☐ Yes ☒ No If answer is "yes," type of consolidation \_\_\_\_\_

If answer is "no," list the owners and tract descriptions which have actually been consolidated (on reverse side of this form if necessary.) Pooling clause of leases will be utilized; unleased interests will be force pooled.  
No allowable will be assigned to the well until all interests have been consolidated (by communitization, unitization, forced-pooling, or otherwise) or until a non-standard unit, eliminating such interests, has been approved by the Commission.

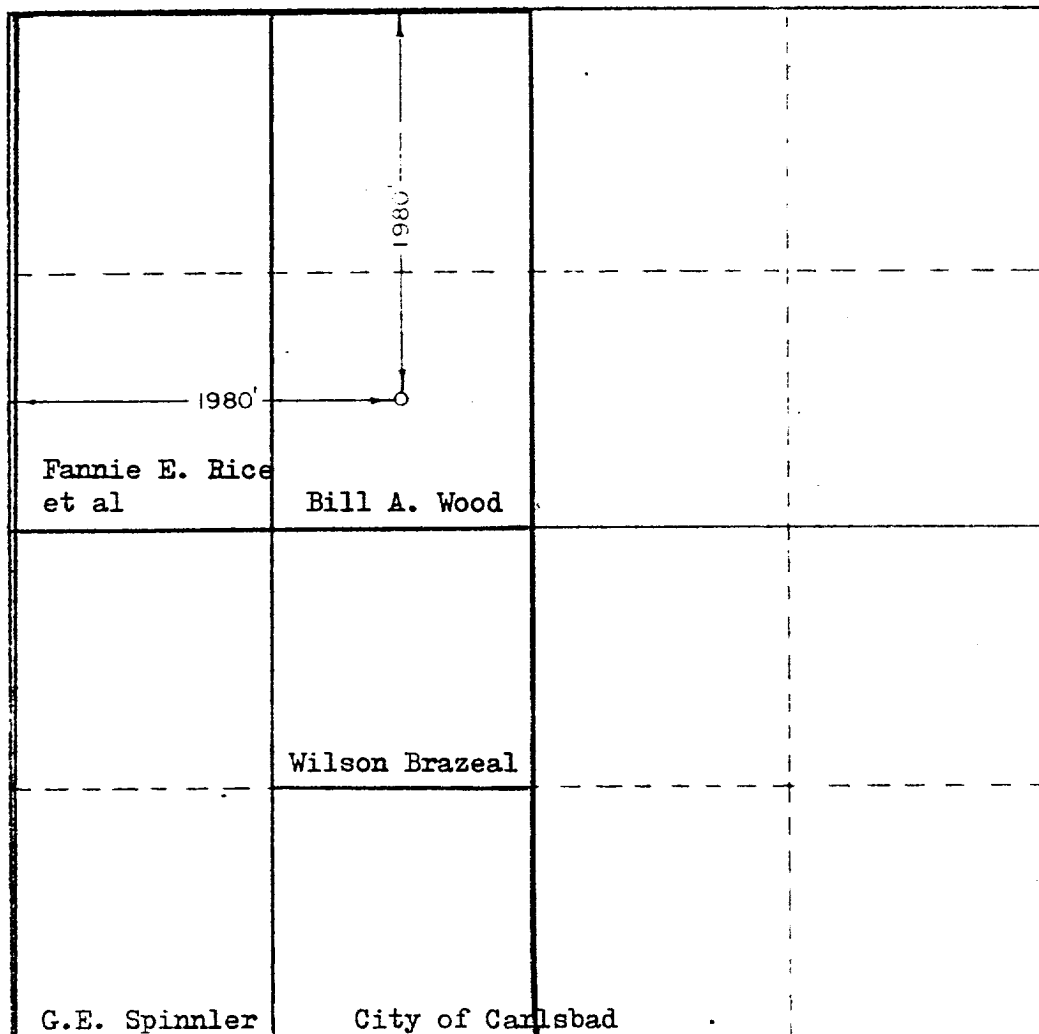

CERTIFICATION

I hereby certify that the information contained herein is true and complete to the best of my knowledge and belief.

*Juanita L. Jones*  
Agent

Company  
Corinne Grace

Date  
11/11/75

I hereby certify that the well location shown on this plat was plotted from field notes of actual surveys made by me or under my supervision, and that the same is true and correct to the best of my knowledge and belief.

Date Surveyed  
November 6, 1975  
Registered Professional Engineer  
No. 676  
JOHN W. WEST  
MEXICO

Michael P. Grace II  
Corinne Grace  
P. O. BOX 1418  
CARLSBAD, NEW MEXICO 88220  
November 12, 1975

RECEIVED

NOV 14 1975

O. C. C.  
ARTESIA, OFFICE

Mr. Bill Gressett  
New Mexico Oil Conservation Commission  
P. O. Drawer DD  
Artesia, New Mexico

Dear Mr. Gressett:

With reference to the application submitted for approval to drill a well in Section 11, T22S, R26E, Eddy County, New Mexico please change the name of the well from: Spinnler-Grace to: Wood-Grace #1.

We will be using a double ram 1500 series Shaffer manual operated blow-out preventer with 5000# working pressure.

Thank you for your assistance in this matter.

Sincerely yours,

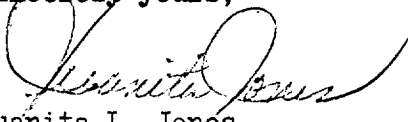
  
Juanita L. Jones

jlj